

NOTES:

1. MATERIALS:

- B CABLE JACKET - PVC, BLACK
- CONDUCTORS - 26 AWG, CENTER COND. W/ COPPER SPIRAL SHIELD
- OVERMOLD - PVC, BLACK
- PLUG - BRASS, NICKEL PLATED WITH STEEL PIN, NICKEL PLATED

2. LEAD FREE SOLDER.

3. THIS PRODUCT IS RoHS COMPLIANT.

<span style="border: 1px solid black; border-radius: 50%; padding: 2px;">D</span>	PART NUMBER	DIM "X"
	33HR00384X	3.0" ±0.4"
<span style="border: 1px solid black; border-radius: 50%; padding: 2px;">C</span>	33HR05584X	55.0" ±2.0"
	33HR05984X	59.0" ±2.0"
	33HR07284X	72.0" ±2.0"
	33HR07884X	78.0" ±2.0"
	33HR11884X	118.0" ±4.0"
	33HR14484X	144.0" ±4.0"

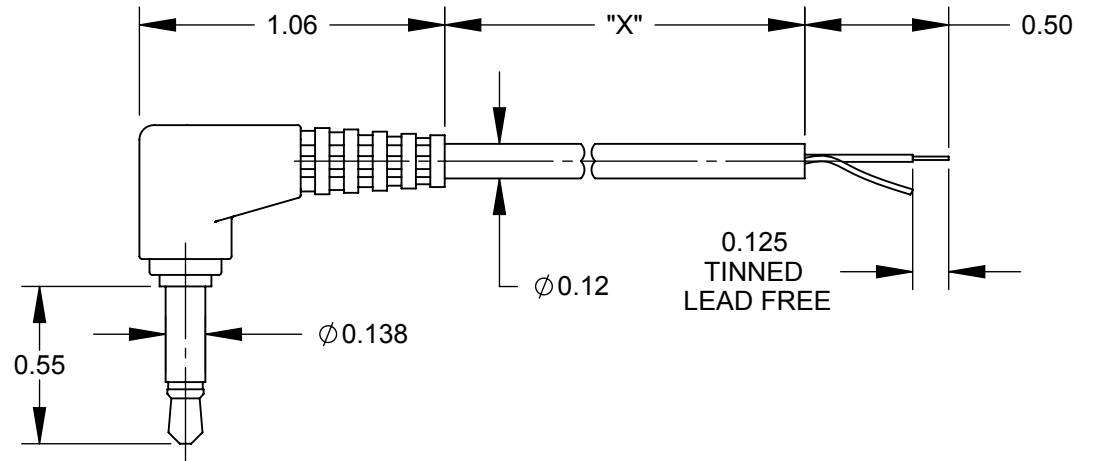
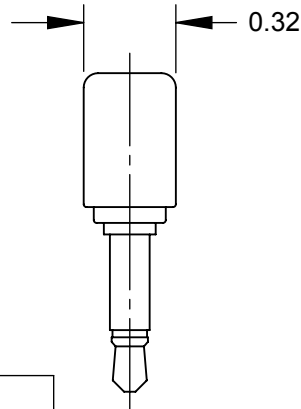

**3.5MM MONO PLUG**

RIGHT ANGLE

S & T

**CUSTOMER DRAWING**

B

WIRE CHART	
TIP	CENTER COND
SLEEVE	SHIELD

THIS DRAWING DESCRIBES A DESIGN CONSIDERED PROPRIETARY IN NATURE, DEVELOPED AND MANUFACTURED BY SWITCHCRAFT INC. AND IS RELEASED ON A CONFIDENTIAL BASIS FOR IDENTIFICATION PURPOSES ONLY.

					UNLESS OTHERWISE SPECIFIED	SIZE	WIDTH	MULT	LBS/M	TEMPER
					1. ALL DIMENSIONS IN INCHES	FINISH		MATERIAL		
					- TWO PLACE DECIMALS ±0.02	SPEC No.		SPEC No.		
					- THREE PLACE DECIMALS ±0.005	FIRST USED ON		SCALE		<b>Switchcraft®</b>
D	27142	5-7-13	TO	TJK				1.5:1		
C	26368	3-30-09	JEB	TJK		DATE DRAWN	BY	CHKD	APVD	
B	25790	01-07-08	AH	TJK		6/20/06	RF	RF	TJK	SHEET 1 OF 1
A	26004	6/20/06	RF	TJK				6/20/06	6/26/06	
REV	ECO NUMBER	DATE	BY	APVD	DO NOT SCALE DRAWING	NAME			PART No.	REV
						3.5MM MONO TO S & T, RoHS			33HR__84X	D

