

Industrial & Electrical Components

# Automotive Relay

Part No. **NRA04**

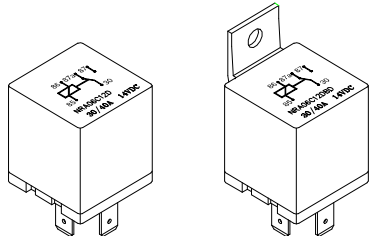

- Fasten connection pins
- Stable function in high or low temp.
- With or without flanger hook
- 40A starting load capacity

## CONTACT

Arrangement	1A / 1C / 1U
Contact Material	Silver Alloy
Contact Resistance	
(By voltage drop 6V 1A)	Max. 100mΩ
Rating	
Resistive load	Contact N.O. 40A 14VDC
(Cos.Φ=1)	Contact N.C. 30A 14VDC
Motor Inrush	
Max. Allowable Voltage	30VDC
Max. Allowable Current	40A
Max. Allowable Power	560W
Service life	
Electrical	1 X 10 <sup>5</sup>
Machanical	1 X 10 <sup>6</sup>

## CHARACTERISTICS

Operate Time	10ms
Release Time	10ms
Initial breakdown voltage	
Between coil & contact	750VAC for 1 Min.
Between open contacts	500VAC for 1 Min.
Insulation Resistance	Min.100MΩ (500 VDC)
Ambient temperature	-40°C~+70°C
Humidity	40~85%
Shock	Functional 20G
Resistance	Destruction 100G
Vibration	Functional 10 to 55 Hz D.A. of 2mm
Resistance	Destruction 10 to 55 Hz D.A. of 2mm
Unit weight	40g Max.

## ORDERING INFORMATION

e.g

**NRA - 04 - A - 12D - B**

- ①      ②      ③      ④      ⑤

- ① Series:            NCR Automotive Relay Series
- ② Part No.
- ③ Contact Form: C=1C/O; A = N/O; B= N/C; U= 2 N/O
- ④ Coil Voltage:    3, 5, 6, 9, 12, 24 dc
- ⑤ Nil= No flanger bracket  
B= With flanger bracket

**COIL DATA (at 20 )**

Nominal Voltage (VDC)	Pick-up Voltage VDC(Max)	Drop-out Voltage VDC(Min)	Coil Resistance ( $\Omega$ ) $\pm 10\%$		Max. Allowable Voltage
			1.6W	1.9W	
3	1.95	0.3	5.6	4.75	130% apply to nominal Voltage
6	3.9	0.6	22.5	19	
9	5.85	0.9	51	43	
12	7.8	1.2	90	76	
24	15.6	2.4	360	303	

**DIMENSIONS (Unit: mm)**

**NRA04C12D**

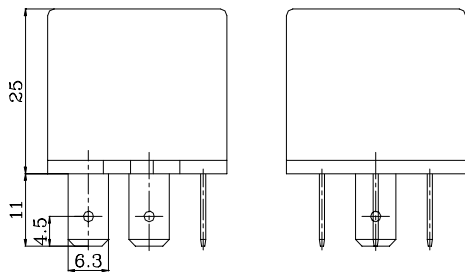

**NRA04C12DB**

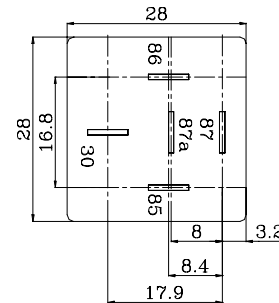
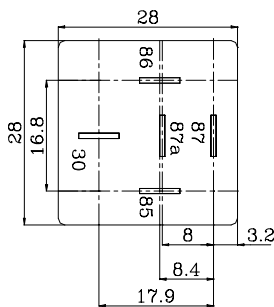
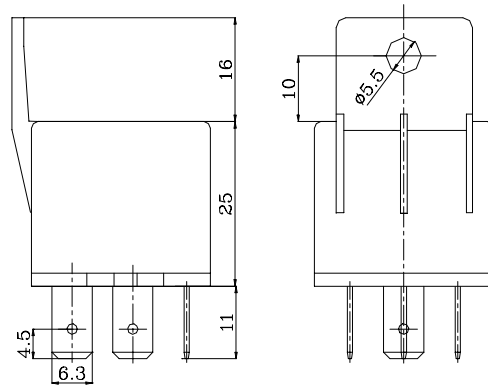

(BOTTOM VIEW)

**NRA04A**

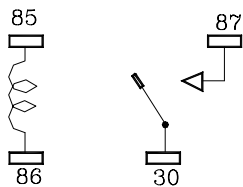

**NRA04C**

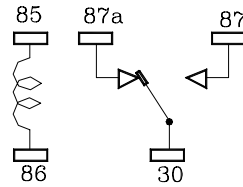

**NRA04U**

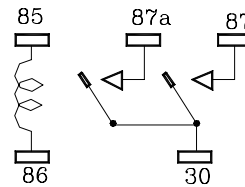

Industrial & Electrical Components