

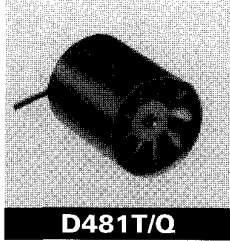

**Axiallüfter  
Axial Fans  
Ventilateurs Axial**

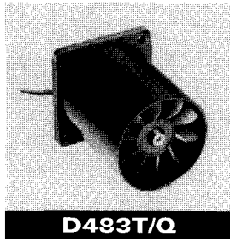

**D481T/Q**

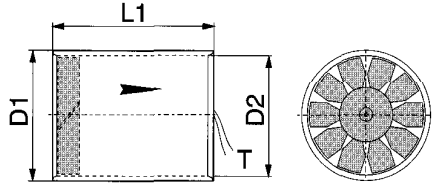

**D483T/Q**

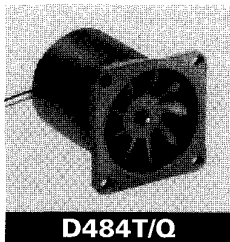
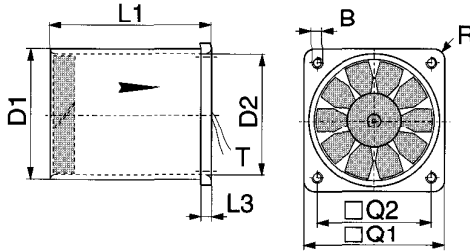

**D484T/Q**

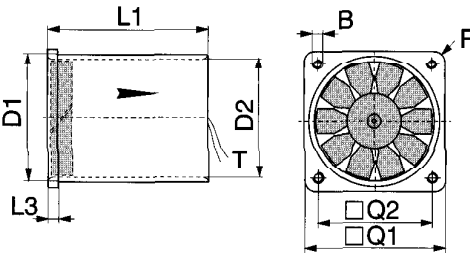

**D481T, 483T, 484T 12 VDC**

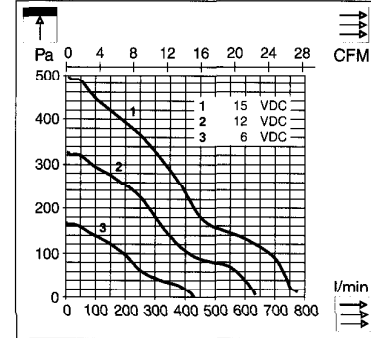

**D481T, 483T, 484T 24 VDC**

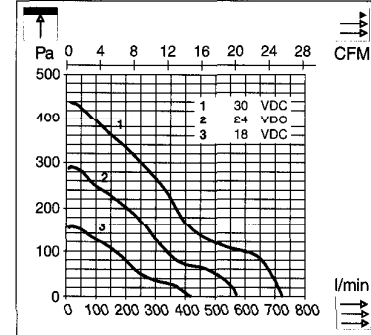

**D481Q, 483Q, 484Q 12 VDC**

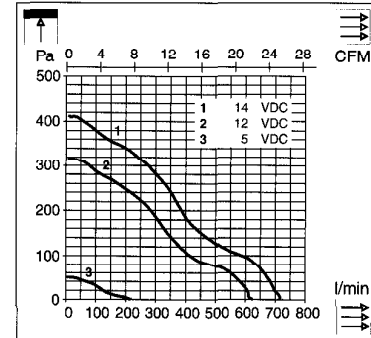

D480	mm	inch
D1	48	1.900
D2	44.4	1.748
L1	60	2.362
L2		
L3	4	0.157
B	M3	
Q1	52	2.047
Q2	42	1.653
R	4	0.157



MICRONEL AG  
CH-8317 Tagelswangen  
www.micronel.ch

Tel. +41 52 - 355 16 16  
Fax +41 52 - 355 16 20  
E-mail: info@micronel.com

D480

## Technische Daten

## Technical data

## Caractéristiques techniques

Die D480Q-Baureihe ist mit elektronisch kommutiertem Motor ausgerüstet.

- gleiche Abmessung wie Standardreihe
- sehr hohe Laufzeit, wegen berührungsloser Kommutierung **++plus**
- integrierter Temperaturschutz (Motor)
- Tachosignal (Drehzahlrückmeldung)

$F_{(Hz)} = n_{(min^{-1})}/20$  **Warnung:** Falschpolung kann den Motor zerstören

The D480Q-series is equipped with an electronically commutated motor.

- same dimensions as standard series
- very long operation time due to brushless commutation **++plus**
- integrated temperature monitoring
- tachometer signal (speed indicator)

$F_{(Hz)} = n_{(min^{-1})}/20$  **Warning:** wrong connection may lead to motor damage

La série D480Q est équipée avec un moteur à commutation électronique.

- mêmes dimensions que les séries standards
- très long temps d'usinage à cause de commutation sans contact **++plus**
- surveillance de température intégrée
- signal tacho (tachomètre)

$F_{(Hz)} = n_{(min^{-1})}/20$  **Attention:** fausse connection peut détruire le moteur

Types -1 -3 -4			D4811/D4831/D4841		D4810/D4830/D4840	
	$U_N$	V	<b>12</b>	<b>24</b>	<b>12</b>	
	U	V	9...15	18...30	4.8...13.8	
	$I_N$	mA	295	119	491	
	$I_{max}$	mA	354	143	570	
	$I_{block}$	A	5.6	4.3	2.3	
	$P_N$	W	3.5	2.9	5.9	
	n	min <sup>-1</sup>	11520	10660	11650	
	$\dot{V}$	l/min; CFM	634/22.38	570/20.12	626/22	
	p	Pa	325	285	315	
	LpA	dB(A)	53	51	53	
	MTTF	hr	12000		<b>++plus</b>	30000
	T	°C/F	-20...+65 / -5...+150		-20...+65 / -5...+150	
	m	g/oz.	164/5.785		137/4.83	
	L/M	mm/inch	220/8.66		225/8.858	
	PPO	UL-94V-1	-		-	
	Aluminium		o.k.		o.k.	
			-		-	
			o.k.		o.k.	
	CLL		-		-	
			-		o.k.	
			o.k.		o.k.	
			o.k.		o.k.	

D480Q-Baureihe ist immer mit Twist-Technologie ausgerüstet.

D480Q serie includes the Twist technology.

D480Q série est toujours avec Twist technologie.

