

This document is the property of Amphenol Corporation and is delivered on the express condition that it is to be used for the specific application or use, in accordance with the drawings and specifications of Amphenol Corporation, and that no part of it is to be reproduced, stored in a retrieval system, or transmitted in any form or by any means, electronic, mechanical, photocopying, recording, or by any information storage and retrieval system, without the prior consent, & that no right is granted to disclose or to use any information in this document.

Customer drawing

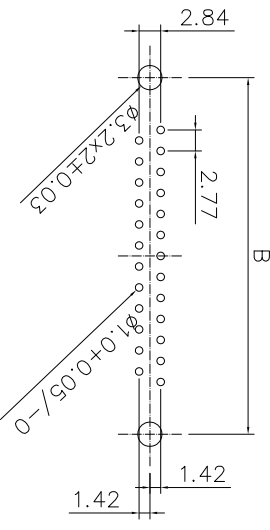
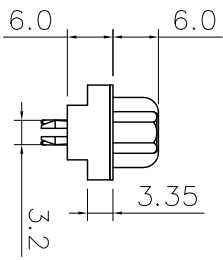
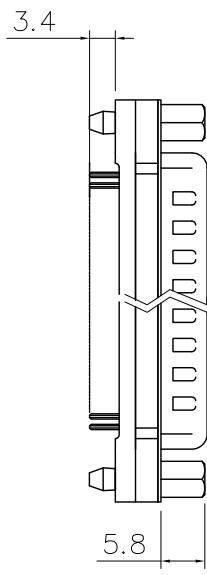
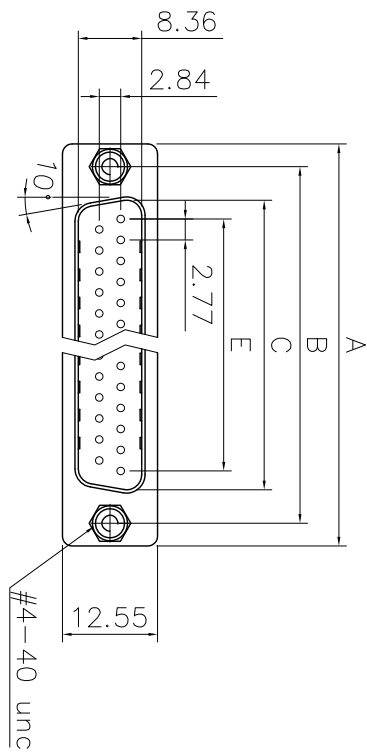

Recommended PCB Layout
Tolerance: ±0.05mm

Positions	A	B	C	E
9	30.81	24.99	16.92	11.08
15	39.20	33.30	25.25	19.39
25	53.05	47.04	38.96	33.24
37	69.40	63.50	55.42	49.86

REVISIONS				
SN	EN	DESCRIPTION	DATE	APPROVED
1	HK--	First Release Drawing	05/27/08	IP
2	HK--	Update the Drawing	04/23/13	IP
3	HK--	Update the Drawing	06/12/14	IP

D-SUB TECHNICAL DATA

SHELL : Steel, 100u" Tin over 50u" min nickel over 50u" min Copper
BODY : PBT, UL 94V-0, Color:Black.
CONTACTS : Copper Alloy.
 gold flash over 50u" nickel on mating area
 100u" tin over 50u" nickel on solder area
SCREW: Copper Alloy, Nickel Plated
BOARDLOCK: Copper Alloy, Tin Plated.
ELECTRICAL: Voltage rating 250 V RMS
 Current Rating 3 AMP
 Withstanding Voltage >1000 V RMS
 Insulation resistance >1000 M Ohms
 Contact resistance 20 mOhms max.

MARKING: Amphenol...(Series No.)
 Commercial reference
 Manufacturing date

PRODUCT CODE

L717 TSX HXX P OL2 RM8

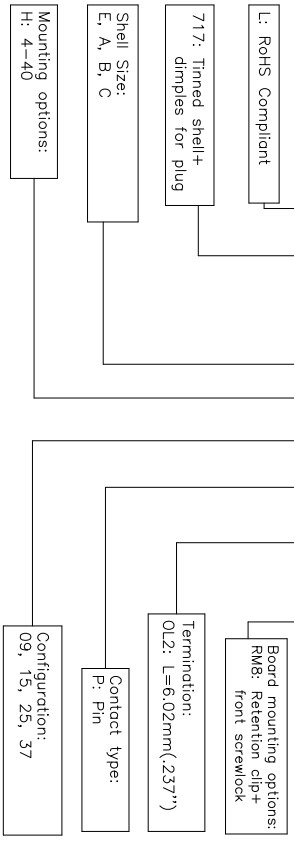

UNLESS OTHERWISE SPECIFIED		APPROVAL		DATE	
TOLERANCES	D.S.	APPROVAL	DATE	APPROVAL	DATE
METRIC		DRWN	06/12/14	CHKD	06/12/14
.X	+/-	CHKD		CHKD	
.XX	+/-				
.XXX	+/-				
FRACTIONS	+/-				
ANGLES	+/-				
5					
FOR MATERIALS AND FINISHES REMOVE SHARP EDGES					
SEE NOTES					
DRAWING FILE :					
ANGLE OF PROJECTION					
DIMENSIONS					
TENSILE					
MATERIAL					
SIZE DRAWING NO					
A4 L717TSXHXXPOL2RM8					
SCALE NONE					
SHEET 1 OF 1					
REV. 3					
D-sub connector, TS series					
Amphenol East Asia Limited					