



Model Number

IA6-12GM50-IU-V1

Features

- Inductive analog
- 0...6 mm quasi flush
- Analog output 0 V ... 10 V/4 mA ... 20 mA

Accessories

- BF 12**
Mounting flange, 12 mm
- V1-W**
Female connector, M12, 4-pin, field attachable
- V1-G-2M-PUR**
Female cordset, M12, 4-pin, PUR cable
- V1-W-2M-PUR**
Female cordset, M12, 4-pin, PUR cable

Technical Data

General specifications	
Output type	Analog current output or analog voltage output
Installation	quasi flush
Output polarity	DC
Measurement range	0 ... 6 mm
Output type	4-wire
Nominal ratings	
Installation conditions	
A	2 mm
B	6 mm
C	18 mm
F	30 mm
Operating voltage	U_B 15 ... 30 V , residual ripple 20 % U_B
Limit frequency (3dB)	1000 Hz
Reverse polarity protection	yes
Short-circuit protection	yes
Repeat accuracy	0 ... 10 μ m
No-load supply current	I_0 \leq 10 mA
Functional safety related parameters	
MTTF _d	464 a
Mission Time (T _M)	20 a
Diagnostic Coverage (DC)	0 %
Analog output	
Output type	0 ... 10 V / 4 ... 20 mA
Load resistor	voltage output: \geq 500 Ω current output: \leq 500 Ω
Recovery time	1 ... 10 ms , typ. 5 ms
Adjustment tolerance zero point	\leq \pm 10 % of full-scale value
Temperature drift	\pm 5 % (0 ... 70 °C) \pm 10 % (-25 ... 0 °C)
Ambient conditions	
Ambient temperature	-25 ... 70 °C (-13 ... 158 °F)
Mechanical specifications	
Connection type	Connector plug M12 x 1 , 4-pin
Housing material	chromium plated brass
Sensing face	PBT
Degree of protection	IP67
Compliance with standards and directives	
Standard conformity	
Standards	EN 60947-5-2:2007 IEC 60947-5-2:2007 EN 60947-5-7:2003 IEC 60947-5-7:2003
Approvals and certificates	
UL approval	cULus Listed, General Purpose
CSA approval	cCSAus Listed, General Purpose
CCC approval	CCC approval / marking not required for products rated \leq 36 V

Dimensions

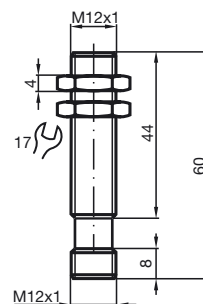

Electrical Connection

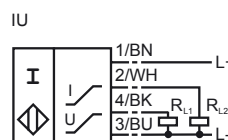

Release date: 2018-06-20 08:29 Date of issue: 2018-06-20 123391_eng.xml

Pinout

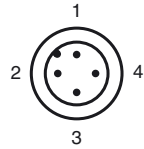

Wire colors in accordance with EN 60947-5-2

1	BN	(brown)
2	WH	(white)
3	BU	(blue)
4	BK	(black)

Installation Conditions

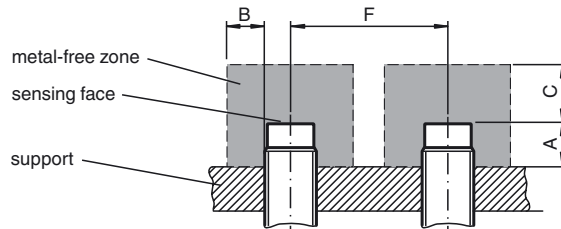

Characteristic Curves

Output characteristics

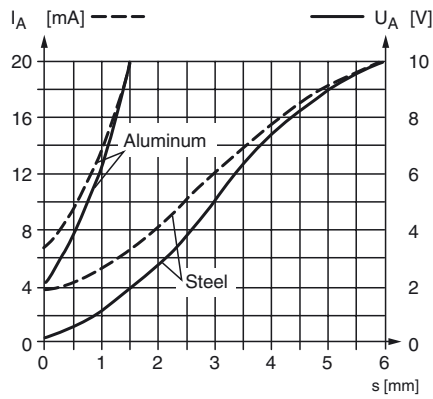

Release date: 2018-06-20 08:29 Date of issue: 2018-06-20 12:39 |_eng.xml