

How to use the RS Emergency Stop Digital Product Selector

The new DPS for Emergency Stops is an intuitive online tool that helps engineers easily specify a fully certified Emergency Stop approved to EN 18350 and EN 60947-5-5 and for use in machinery and other applications.

Go to the EAO landing page [here](#) to access the DPS.

The DPS allows engineers to enter each of the technical attributes needed for their equipment using pull down dialogue boxes to narrow down the product selection and to see photorealistic images at each stage in the selection. At each stage attributes can be updated and changed and matching accessories can be added.

Once the selection is finalised datasheets, technical specification and 3D drawing step files can be downloaded and the products can be added to the RS shopping basket.

Entry Screen

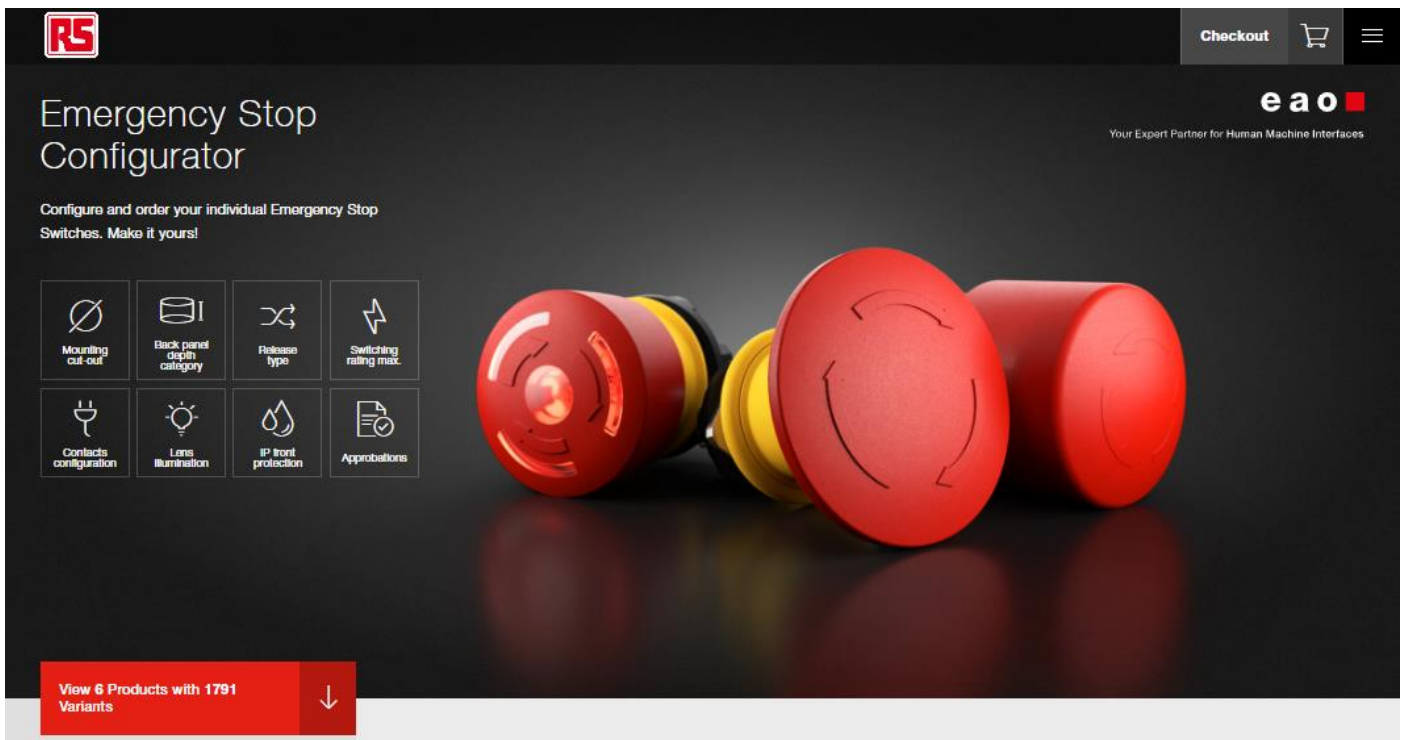

This entry screen shows there are 6 product ranges and 1791 product combinations in the E Stop range before any attributes are entered.

Clicking on each technical attribute icon allows a selection and narrows down the number of available combinations. The attributes can be selected in any order and are then added to the filters section.

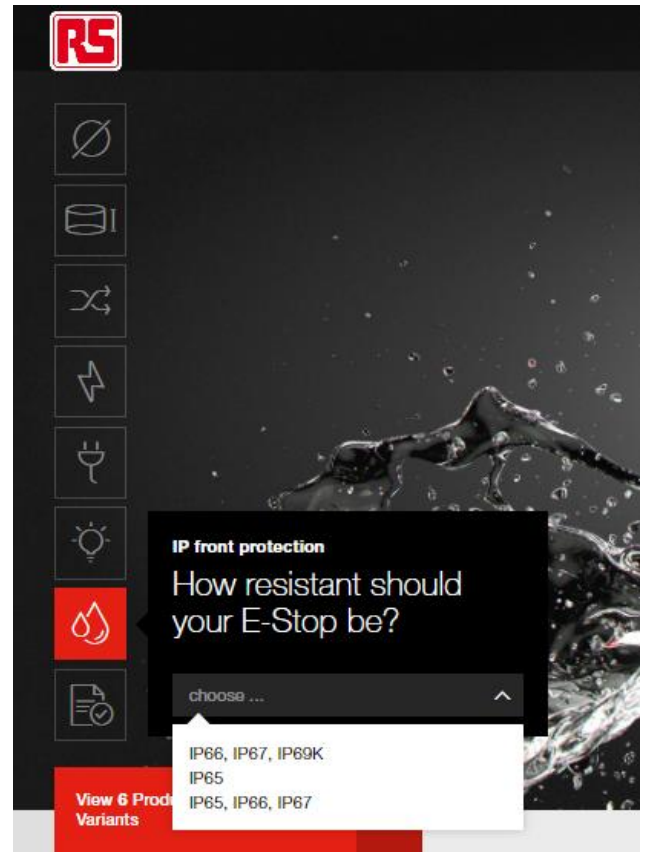
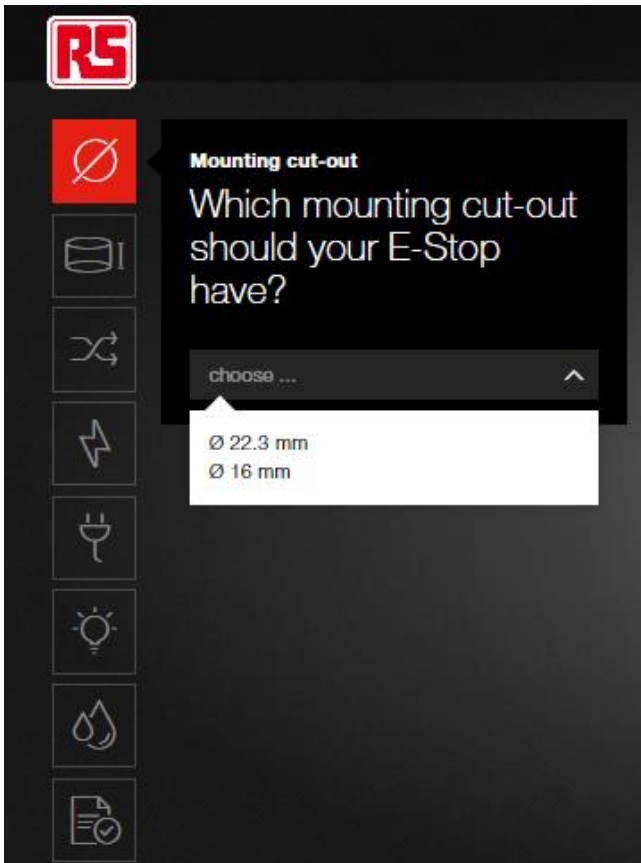

As each attribute is added, the range of matching products ranges with photorealistic images is shown along with the attribute filters already selected and the “clear filter” attributes option

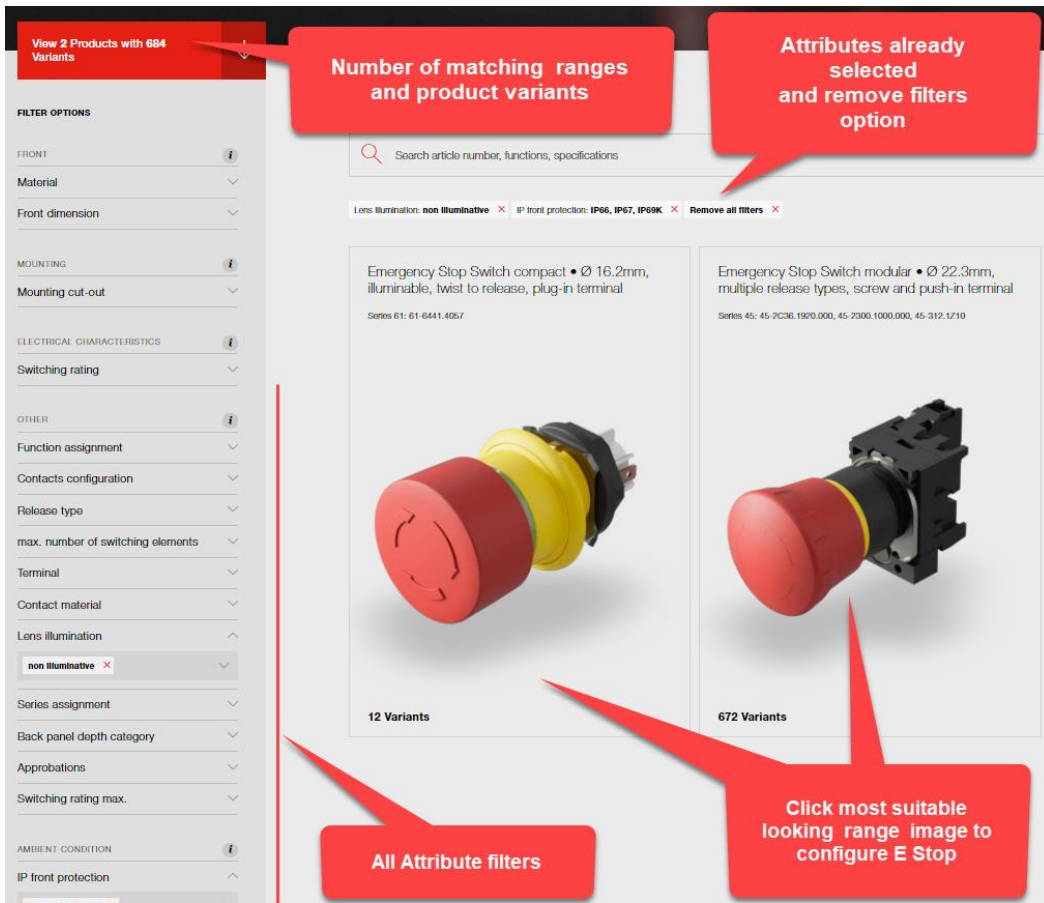

Add as many technical attributes as needed to find the product range that looks best from the visualisation and then click on the image of the chosen product range to narrow down the correct range and continue the configuration.

The configurator will add in the minimum number of E Stop components needed to create a complete working switch and generate a preliminary Bill of Materials then highlight using a pencil icon the parts that can be changed or configured.

The top of the page shows the simulated product image,

Emergency stop switch, Series 45, Ø 40 mm, 1 NC, IP66, IP67, IP69K, Screw terminal

45-2C36.100.000
45-2300.1000.000
45-312.1210

FRONT
Material Plastic
Front dimension Ø 40 mm

MOUNTING
Mounting cut-out Ø 22.3 mm

ELECTRICAL CHARACTERISTICS
Switching rating 500 V AC @ 10 A

OTHER
Function assignment Emergency stop switch
Contacts configuration 1 NC
Release type Twist to unlock
max. number of switching elements 6
Terminal Screw terminal
Contact material Silver
Lens illumination non illuminative

AMBIENT CONDITION
IP front protection IP66, IP67, IP69K

Preliminary BoM needed for a complete working E Stop

Attributes selected to make preliminary BoM
Attributes can be updated here or using pencil

Click on pencil to configure or change chosen options

Show different product Views (front , back, with ruler etc)

View detailed product overview

1 Add to Cart

The five product views show; a live rotatable 3D rendering, an image on a dimensioned grid, a front and back view in a simulated metal panel, the view in the dark (for illuminated switches) and the augmented reality view (Android OS has been implemented first with other OS to follow).

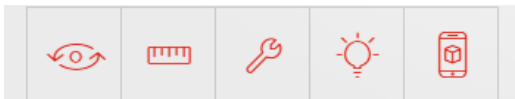

Further detailed configuration can be made by selecting the attributes on the left column or by clicking on the pencil icons on the switch body

Terminal
Contact material
Contacts configuration

CONTACT MATERIAL
Gold 336 options
Silver 336 options

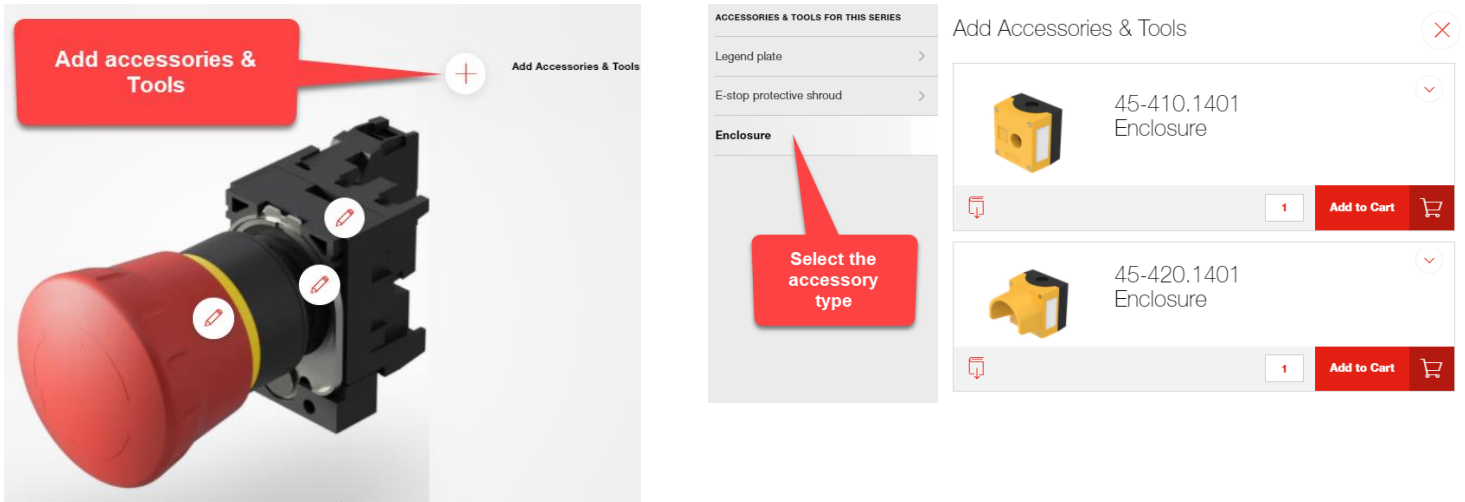

Once the basic E Stop is specified, you can add Accessories and Tools for the E Stop such as marking plates, enclosures, crimp tools etc. using the **Add accessories** link above the switch in the configuration window.

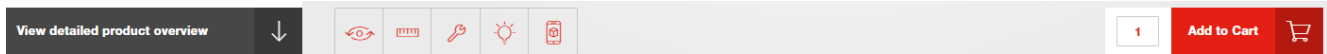

The detailed product overview with technical specification for the configured switch is shown below the image, along with all the BoM components.



Your product:

	45-2C36.1920.000~45-2300.1000.000~45-312.1Z10 Emergency stop switch, Series 45, Ø 40 mm, 1 NC, IP66, IP67, IP69K, Screw terminal																																																																																						
FRONT	Front form:	round																																																																																					
	Front dimension:	Ø 40 mm																																																																																					
	Front bezel colour:	Black																																																																																					
	Front bezel material:	Plastic																																																																																					
	Material:	Plastic																																																																																					
MOUNTING	Mounting cut-out:	Ø 22.3 mm																																																																																					
ELECTRICAL CHARACTERISTICS	Switching voltage and switching current:	<table border="1"> <tr> <td>at AC-12</td> <td></td> <td></td> <td></td> <td></td> <td></td> <td></td> </tr> <tr> <td>Voltage</td> <td>24 V</td> <td>48 V</td> <td>110 V</td> <td>230 V</td> <td>400 V</td> <td>500 V</td> </tr> <tr> <td>Current</td> <td>10 A</td> <td>10 A</td> <td>10 A</td> <td>8 A</td> <td>6 A</td> <td>10 A</td> </tr> <tr> <td>at AC-15</td> <td></td> <td></td> <td></td> <td></td> <td></td> <td></td> </tr> <tr> <td>Voltage</td> <td>24 V</td> <td>48 V</td> <td>110 V</td> <td>230 V</td> <td>400 V</td> <td>500 V</td> </tr> <tr> <td>Current</td> <td>6 A</td> <td>6 A</td> <td>6 A</td> <td>4 A</td> <td>3 A</td> <td>1,4 A</td> </tr> <tr> <td>at DC-12</td> <td></td> <td></td> <td></td> <td></td> <td></td> <td></td> </tr> <tr> <td>Voltage</td> <td>24 V</td> <td>48 V</td> <td>110 V</td> <td>230 V</td> <td>400 V</td> <td>500 V</td> </tr> <tr> <td>Current</td> <td>10 A</td> <td>5 A</td> <td>2,5 A</td> <td>1 A</td> <td>0,3 A</td> <td>0,2 A</td> </tr> <tr> <td>at DC-13</td> <td></td> <td></td> <td></td> <td></td> <td></td> <td></td> </tr> <tr> <td>Voltage</td> <td>24 V</td> <td>48 V</td> <td>110 V</td> <td>230 V</td> <td>400 V</td> <td>500 V</td> </tr> <tr> <td>Current</td> <td>3 A</td> <td>1,5 A</td> <td>0,7 A</td> <td>0,3 A</td> <td>0,1 A</td> <td>0,07 A</td> </tr> </table>	at AC-12							Voltage	24 V	48 V	110 V	230 V	400 V	500 V	Current	10 A	10 A	10 A	8 A	6 A	10 A	at AC-15							Voltage	24 V	48 V	110 V	230 V	400 V	500 V	Current	6 A	6 A	6 A	4 A	3 A	1,4 A	at DC-12							Voltage	24 V	48 V	110 V	230 V	400 V	500 V	Current	10 A	5 A	2,5 A	1 A	0,3 A	0,2 A	at DC-13							Voltage	24 V	48 V	110 V	230 V	400 V	500 V	Current	3 A	1,5 A	0,7 A	0,3 A	0,1 A	0,07 A	
at AC-12																																																																																							
Voltage	24 V	48 V	110 V	230 V	400 V	500 V																																																																																	
Current	10 A	10 A	10 A	8 A	6 A	10 A																																																																																	
at AC-15																																																																																							
Voltage	24 V	48 V	110 V	230 V	400 V	500 V																																																																																	
Current	6 A	6 A	6 A	4 A	3 A	1,4 A																																																																																	
at DC-12																																																																																							
Voltage	24 V	48 V	110 V	230 V	400 V	500 V																																																																																	
Current	10 A	5 A	2,5 A	1 A	0,3 A	0,2 A																																																																																	
at DC-13																																																																																							
Voltage	24 V	48 V	110 V	230 V	400 V	500 V																																																																																	
Current	3 A	1,5 A	0,7 A	0,3 A	0,1 A	0,07 A																																																																																	
	Switching rating:	500 V AC @ 10 A																																																																																					

At any point in your configuration it is possible to add product to the RS shopping basket, and to check out back to the main RS page to show your complete product basket

Below the configured product you can share and save your work in progress using a web link or a QR code or download specifications and 3D step files

Your product:



45-2C36.1920.000~45-2300.1000.000~45-312.1Z10
Emergency stop switch, Series 45, Ø 40 mm, 1 NC, IP66,
IP67, IP69K, Screw terminal

 Share and save this product

 Download 3D and specification files of product

1 **Add to Cart** 

Using these links the full data package and drawings can be used to finalise the specifications

SHARE AND SAVE THIS PRODUCT

Use the QR code to share this product or bookmark the link to save it.



or

COPY LINK

<https://direct.eao.com/product/45-2C36.192...> 

or

SEND TO MAIL

Enter email address... 

DOWNLOAD FILES

Please pick the required files from the list below

- Datasheet
- 3d model
- Assembly instruction
- All files

Download



Shopping Basket and Check-out

The complete certified E Stop and all the necessary accessories have now been specified and all data is available, the E Stop is ready to purchase, or a link can be sent to a third party to place the order.

The products you add to your Digital Product Selector configuration basket will be visible in your main RS Components basket ready for purchase.

RS Shopping Basket with all the necessary components.



Log In Register

4 £45.87

- All Products
- Our Brands
- New Products
- My Account
- Our Services

My basket

Checkout securely

Place your order before 8.30pm for next working day delivery for online orders.

Quick order

If you already know the RS stock numbers for the part you want, save time using our quick order add product to basket. [Enter stock number](#)





Please select delivery or branch collection

Delivery
 Branch collection

Please select your delivery method

Next working day (despatch Tue,23 Feb 2021) – applies to stocked products only Free

Forward orders Free

<p>✓ 1 in stock - FREE next working day delivery available</p>			
	<p>EAO Panel Mount E-Stop - Twist to Reset, 22.3mm Cutout Diameter Mushroom Head</p> <p>RS Stock No. 16S-7070</p> <p>Brand EAO</p> <p>Mfr. Part No. 45-2C36.1920.000</p> <p>RoHS status: Compliant</p>	<p>1 Update Remove</p>	<p>£23.77 Each £23.77</p>
<p>✓ 1 in stock - FREE next working day delivery available</p>			
	<p>EAO Series 45 Actuator</p> <p>RS Stock No. 16S-7053</p> <p>Brand EAO</p> <p>Mfr. Part No. 45-2300.1000.000</p> <p>RoHS status: Compliant</p>	<p>1 Update Remove</p>	<p>£2.52 Each £2.52</p>
<p>✓ 1 in stock - FREE next working day delivery available</p>			
	<p>EAO Series 45 Contact Block - NC 5 -> 500 V</p> <p>RS Stock No. 16S-7087</p> <p>Brand EAO</p> <p>Mfr. Part No. 45-312.1Z10</p> <p>RoHS status: Compliant</p>	<p>1 Update Remove</p>	<p>£6.28 Each £6.28</p>
<p>✓ 1 in stock - FREE next working day delivery available</p>			
	<p>EAO Yellow Plastic 45 Enclosure - 1 Hole 22.3mm Diameter</p> <p>RS Stock No. 210-0780</p> <p>Brand EAO</p> <p>Mfr. Part No. 45-410.1401</p> <p>RoHS status: Compliant</p>	<p>1 Update Remove</p>	<p>£13.30 Each £13.30</p>
<p>Clear all Products</p>		<p>Update</p>	