



CSH-SGFB-ccc-UFFR

SMA Bulkhead Jack to U.FL Plug Cable Assembly

Linx offers cable assemblies selected for high quality, durability and wide bandwidth operation. Connectors and coaxial cable meet RoHS lead free standards and have been tested to meet requirements for corrosion resistance, vibration, mechanical and thermal shock.

The CSH-SGFB-ccc-UFFR cable assembly provides an SMA bulkhead jack (female socket) and U.FL-type plug (female socket) on 100 mm or 200 mm length of 1.32 mm coaxial cable. The SMA connector is supplied with a washer and 1/4"-36UNS hex nut for bulkhead mounting.

FEATURES

- 1.32 mm double-shielded 50 Ω coaxial cable
- SMA jack (female socket)
 - Gold plated
 - Gold plated brass washer and 1/4"-36UNS hex nut provided
- U.FL-type plug (female socket) compatible with:
 - MHF1
 - AMC
 - UMCC

TABLE 1. ELECTRICAL SPECIFICATIONS

Parameter	Value
Impedance	50 Ω
VSWR	≤ 1.3 @ 6 GHz
Insulation Resistance	500 M Ω min.
Withstanding Voltage	200 V AC
Operating Temperature Range	-40 $^{\circ}$ C to +90 $^{\circ}$ C

ORDERING INFORMATION

Part Number	Description
CSH-SGFB-100-UFFR	SMA bulkhead jack (female socket) to U.FL-type plug (female socket) on 100 mm of 1.32 mm coaxial cable
CSH-SGFB-200-UFFR	SMA bulkhead jack (female socket) to U.FL-type plug (female socket) on 200 mm of 1.32 mm coaxial cable

Available from Linx Technologies and select distributors and representatives.

PRODUCT DIMENSIONS

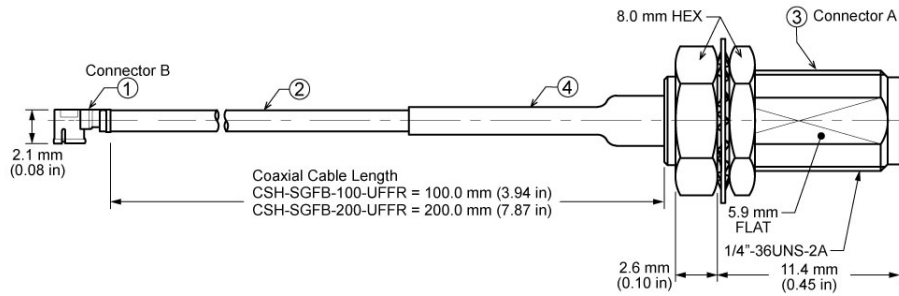

Figure 1. Product Dimensions for the CSH-SGFB-ccc-UFFR Cable Assembly

CABLE ASSEMBLY COMPONENTS

Item #	Description	Material	Finish
1	Connector, U.FL-type plug (female socket)	Brass	Gold
2	1.32 mm double-shielded coaxial cable	1.32 mm coaxial	Black
3	Connector, SMA bulkhead jack (female socket) hex nut and washer	Brass	Gold
4	Heat Shrink Tubing	PTFE	Black
		Connector A	Connector B
Fastening Type		1/4\"-36 UNS-2A threaded coupling	Snap-on coupling
Recommended Torque		0.9 N m (8.0 in lbs)	-
Coupling Nut Retention		60 lbs. min.	-
Connector Durability		500 cycles min.	500 cycles min.
Weight		CSH-SGFB-100-UFFR, 3.9 g (0.14 oz) CSH-SGFB-200-UFFR, 4.3 g (0.15 oz)	

TABLE 3. CABLE ASSEMBLY MECHANICAL SPECIFICATIONS

Parameter	Connector A Unterminated, trimmed coax	Connection B SMA bulkhead jack (female socket)
Fastening Type	Solder	1/4\"-36 UNS-2A threaded coupling
Recommended Torque	-	0.9 N m (8.0 in lbs)
Coupling Nut Retention	-	60 lbs. min.
Connector Durability	-	500 cycles min.
Weight	3.6 g (0.13 oz)	

RECOMMENDED MOUNTING

Figure 2 shows the recommended mounting hole dimensions for the SMA connector (bulkhead) end of the cable assembly.

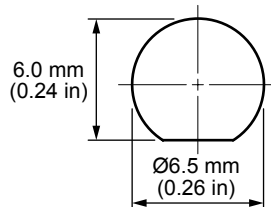
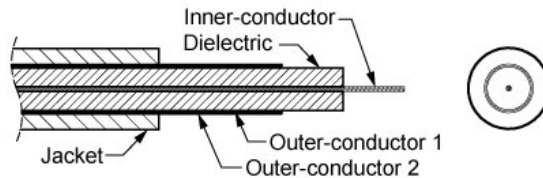

Figure 2. Recommended Mounting Hole Dimensions for the CSH-SGFB-ccc-UFFR Cable Assembly

COAXIAL CABLE SPECIFICATIONS



Parameter	Material	Dimensions
Inner-Conductor	Silver plated copper, 7 strand, 32 AWG	Ø0.085 mm (0.003 in)
Dielectric	FEP, clear	Ø0.70 mm (0.028 in)
Outer-Conductor 1	Silver plated copper braid, 16/4/0.050, coverage 89.4%	Ø0.75 mm (0.030 in)
Outer-Conductor 2	Silver plated copper braid, 16/4/0.050, coverage 78.4%	Ø0.80 mm (0.031 in)
Jacket	FEP, black	Ø1.32 mm (0.05 in) ±0.05 mm

1.32 mm Coaxial Cable Electrical and Physical Specifications						
Rated Temp Voltage	105 °C 30 V					
Conductor Resistance	497 Ω/km 20 °C					
Insulation Resistance	3000 M Ω-km min.					
Dielectric Strength	AC 500 V/Minute					
Spark Test	2.5 kV					
Insulation	Unaged	Tensile Strength		2500 psi min. (1.76 kg/mm ²)		
		Elongation		200% min.		
	Aged	Tensile Strength		Unaged min. 75% (168 hrs x 232 °C)		
		Elongation		Unaged min. 75% (168 hrs x 232 °C)		
Jacket	Unaged	Tensile Strength		2500 psi min. (1.76 kg/mm ²)		
		Elongation		200% min.		
	Aged	Tensile Strength		Unaged min. 75% (168 hrs x 232 °C)		
		Elongation		Unaged min. 75% (168 hrs x 232 °C)		
Nominal Impedance	50 ± 3 Ω					
Nominal Capacitance	96 ± 3 pF/m					
Nominal Velocity of Propagation	69%					
VSWR (0 to 6 GHz)	≤ 1.3					
Flame Test	VW-1 OK					
Attenuation (dB/1M)	2.0 GHz	2.4 GHz	2.5 GHz	5.0 GHz	6.0 GHz	
	2.80	3.10	3.15	4.85	5.20	
Minimum Inside Bend radius	4.0 mm (0.16 in)					

PACKAGING INFORMATION

The CSH-SGFB-ccc-UFFR cable assembly is packaged in a clear plastic bag, in quantities of 100. Distribution channels may offer alternative packaging options.

INSERTION LOSS

Figure 3 shows the Insertion Loss for CSH-SGFB-100-UFFR & CSH-SGFB-200-UFFR cable assemblies. Insertion loss is the loss of signal power (gain) resulting from the insertion of a device in a transmission line.

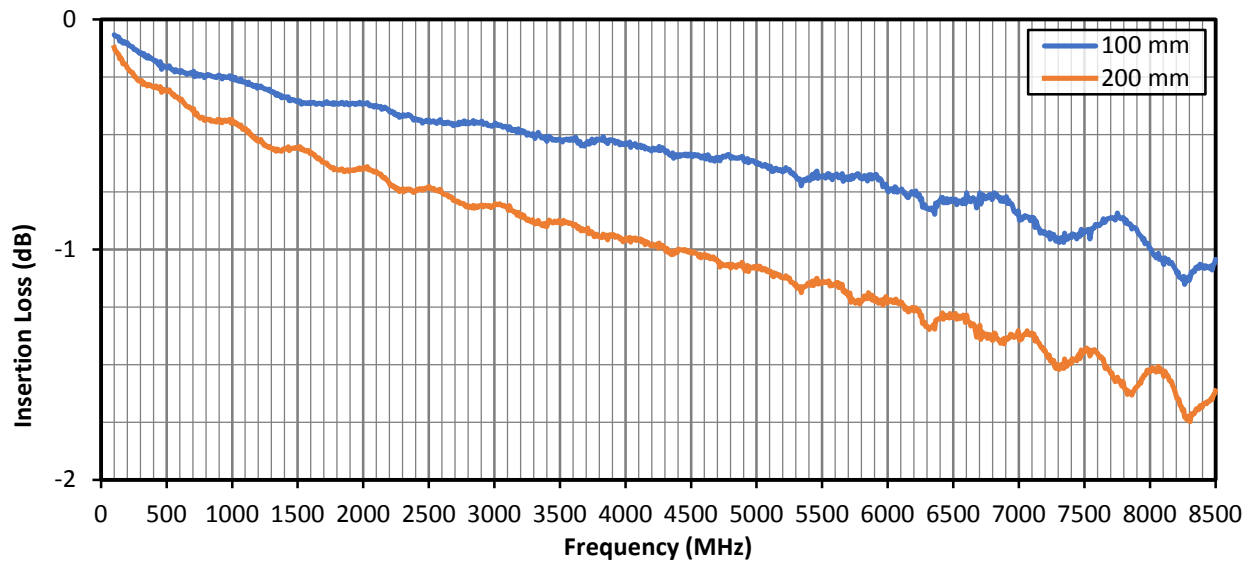

Figure 3. Insertion Loss for the CSH-SGFB-ccc-UFFR Cable Assembly

VSWR

Figure 4 provides the voltage standing wave ratio (VSWR) across the cable assembly's bandwidth for the CSH-SGFB-100-UFFR and CSH-SGFB-200-UFFR cable assemblies. VSWR describes how efficiently power is transmitted through the cable assembly. A lower VSWR value indicates better performance at a given frequency.

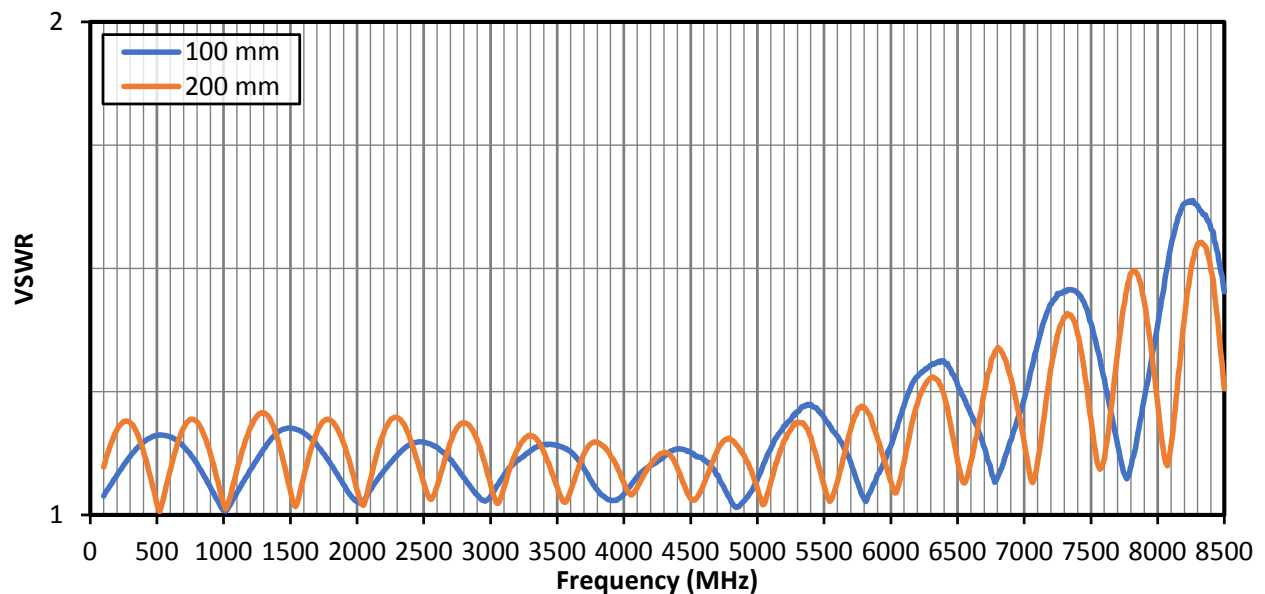

Figure 4. VSWR for the CSH-SGFB-ccc-UFFR Cable Assembly

CABLE ASSEMBLY DEFINITIONS AND USEFUL FORMULAS

VSWR - Voltage Standing Wave Ratio. VSWR is a unitless ratio that describes how efficiently power is transmitted through the cable assembly. A lower VSWR value indicates better performance at a given frequency. VSWR is easily derived from Return Loss.

$$VSWR = \frac{10^{\left[\frac{\text{Return Loss}}{20}\right]} + 1}{10^{\left[\frac{\text{Return Loss}}{20}\right]} - 1}$$

Insertion Loss - The loss of signal power (gain) resulting from the insertion of a device in a transmission line. Insertion loss can be derived from the power transmitted to the load before the insertion of the component P_T and the power transmitted to the load after the insertion of the component P_R .

$$\text{Insertion Loss (dB)} = 10 \log_{10} \frac{P_T}{P_R}$$

TE TECHNICAL SUPPORT CENTER

USA:	+1 (800) 522-6752
Canada:	+1 (905) 475-6222
Mexico:	+52 (0) 55-1106-0800
Latin/S. America:	+54 (0) 11-4733-2200
Germany:	+49 (0) 6251-133-1999
UK:	+44 (0) 800-267666
France:	+33 (0) 1-3420-8686
Netherlands:	+31 (0) 73-6246-999
China:	+86 (0) 400-820-6015

te.com

TE Connectivity, TE, TE connectivity (logo), Linx and Linx Technologies are trademarks owned or licensed by the TE Connectivity Ltd. family of companies. All other logos, products and/or company names referred to herein might be trademarks of their respective owners.

The information given herein, including drawings, illustrations and schematics which are intended for illustration purposes only, is believed to be reliable. However, TE Connectivity makes no warranties as to its accuracy or completeness and disclaims any liability in connection with its use. TE Connectivity's obligations shall only be as set forth in TE Connectivity's Standard Terms and Conditions of Sale for this product and in no case will TE Connectivity be liable for any incidental, indirect or consequential damages arising out of the sale, resale, use or misuse of the product. Users of TE Connectivity products should make their own evaluation to determine the suitability of each such product for the specific application.

TE Connectivity warrants to the original end user customer of its products that its products are free from defects in material and workmanship. Subject to conditions and limitations TE Connectivity will, at its option, either repair or replace any part of its products that prove defective because of improper workmanship or materials. This limited warranty is in force for the useful lifetime of the original end product into which the TE Connectivity product is installed. Useful lifetime of the original end product may vary but is not warranted to exceed one (1) year from the original date of the end product purchase.

©2022 TE Connectivity. All Rights Reserved.

11/22 Original

Mouser Electronics

Authorized Distributor

Click to View Pricing, Inventory, Delivery & Lifecycle Information:

[TE Connectivity:](#)

[CSH-SGFB-100-UFFR](#)