

# SNAP-ON CONTACTS

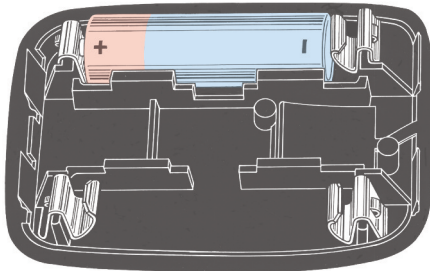

Refer to page 26  
for Battery Contact Layout & Mounting Details

- Economical and reliable contacts are ideal for molded cases with self contained battery compartments
- Single & dual contact designs available for "A" - "AA" - "AAA" - "AAAA" - "N" - "12V" size batteries
- Solder "ear" to facilitate soldering of wire lead
- Unique spring tension contact adjusts to variations in battery length
- Reliable spring tension contacts assure low contact resistance
- Clips easily onto .060 (1.52) to .070 (1.78) thick panel edge
- Sharp barbs securely anchor contact in place

### For "A" - "AA"

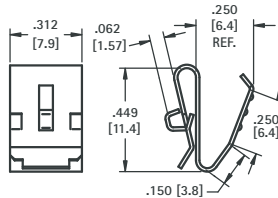

**CAT. NO. 209**

**MATERIAL:** .012 (.30) thick Spring Steel, Nickel Plate

### For "A" - "AA"

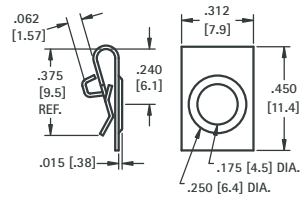

**CAT. NO. 228**

**MATERIAL:** .010 (.25) thick Spring Steel, Nickel Plate

### For "AAA" - "AAAA" - "12V" - "N"

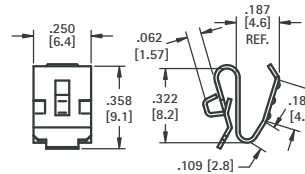

**CAT. NO. 204**

**MATERIAL:** .010 (.25) thick Spring Steel, Nickel Plate

### For "AAA" - "AAAA" - "12V" - "N"

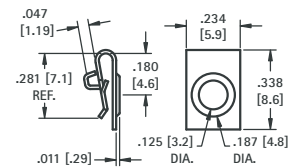

**CAT. NO. 238**

**MATERIAL:** .010 (.25) thick Spring Steel, Nickel Plate

### For "A" - "AA"

- The (2) two leaf contacts are held together by a web. This design offers greater stability.

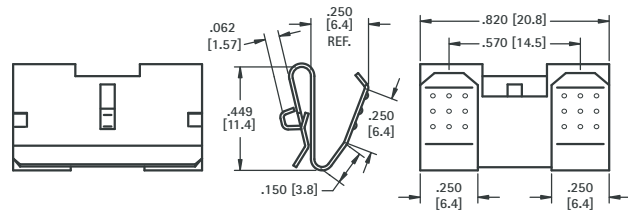

**CAT. NO. 210**

**MATERIAL:** .012 (.30) thick Spring Steel, Nickel Plate

### For "A" - "AA"

- The (2) two leaf contacts are separate, allowing a divider between the batteries.

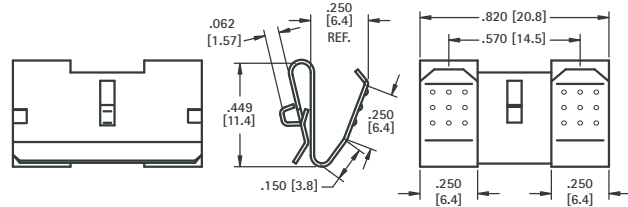

**CAT. NO. 288**

**MATERIAL:** .012 (.30) thick Spring Steel, Nickel Plate

### For "A" - "AA"

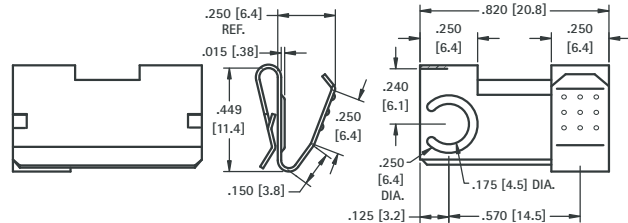

**CAT. NO. 290** Left (shown)

**CAT. NO. 291** Right

**MATERIAL:** .012 (.30) thick Spring Steel, Nickel Plate

### For "A" - "AA"

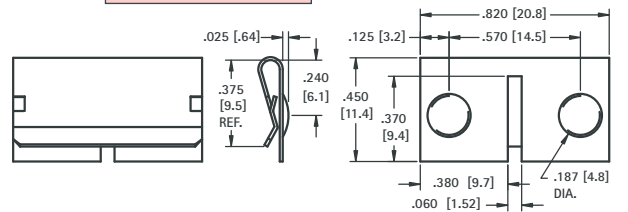
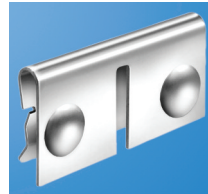

**CAT. NO. 292**

**MATERIAL:** .010 (.25) thick Spring Steel, Nickel Plate

### For "AAA" - "AAAA" - "12V" - "N"

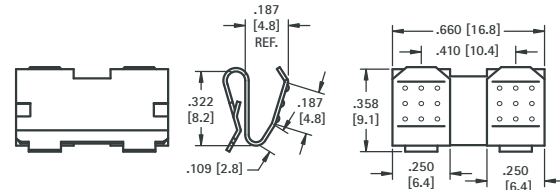

**CAT. NO. 202**

**MATERIAL:** .010 (.25) thick Spring Steel, Nickel Plate

### For "AAA" - "AAAA" - "12V" - "N"

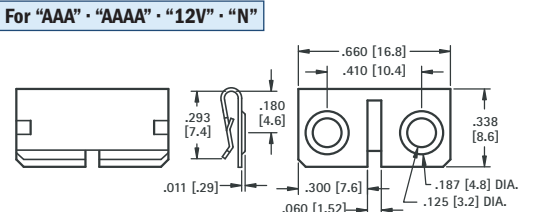

**CAT. NO. 294**

**MATERIAL:** .010 (.25) thick Spring Steel, Nickel Plate

## SPRING & BUTTON CONTACTS

For "A" - "AA"

- Economical and reliable contacts are ideal for molded cases with self contained battery compartments
- Single and dual contact designs available for "A" & "AA" size batteries
- "Solder tab" design for either wire lead or PC mounting
- Unique spring contacts adjust to variations in battery lengths
- Reliable spring contacts assure low contact resistance and a dependable connection
- Space saving, economical, excellent mechanical construction

**MATERIAL:**

**Plate:** .020 (.51) thick Steel, Nickel Plate **Spring:** Spring Steel, Nickel Plate

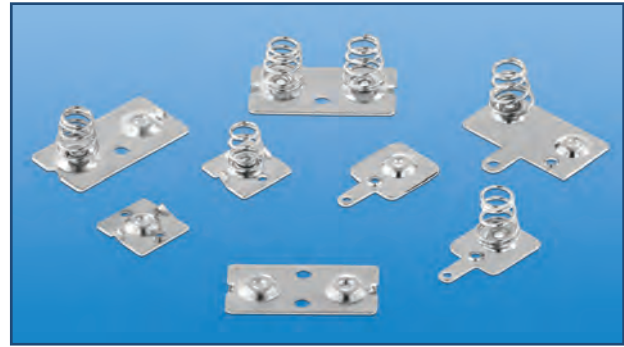

Refer to page 27 for Battery Contact Layout & Mounting Details

For "A" - "AA"

(+) POSITIVE BUTTON WITH TAB

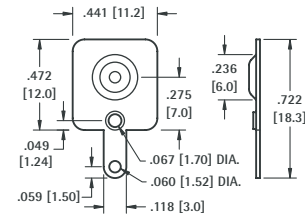

CAT. NO. 5223

(+) POSITIVE BUTTON

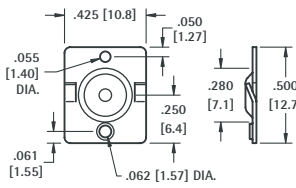

CAT. NO. 5221

(+) POSITIVE BUTTON

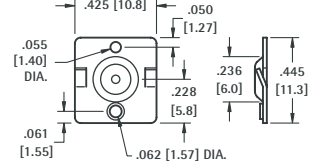

CAT. NO. 5224

(-) NEGATIVE SPRING WITH TAB

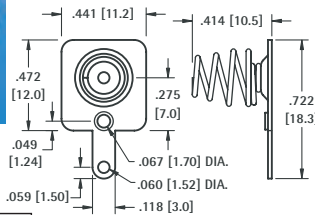

CAT. NO. 5201

(-) NEGATIVE SPRING

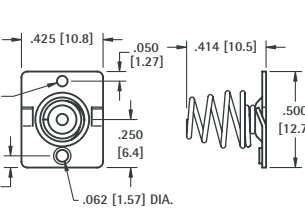

CAT. NO. 5222

(-) NEGATIVE SPRING

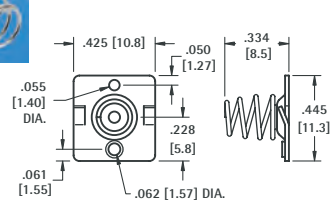

CAT. NO. 5202

DUAL CONTACTS WITH TAB

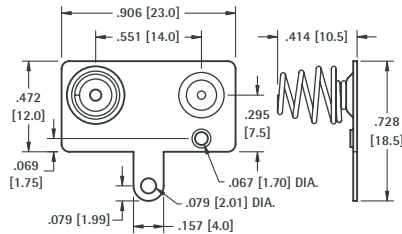

CAT. NO. 5211

DUAL CONTACTS

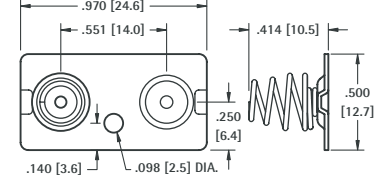

CAT. NO. 5212

DUAL BUTTON CONTACT

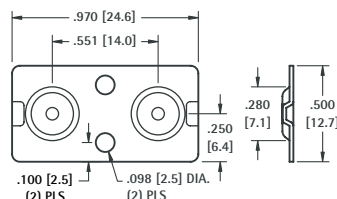

CAT. NO. 5227

DUAL SPRING CONTACT

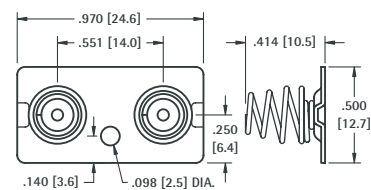

CAT. NO. 5228

BATTERY CONTACTS FOR MOLDED CASES

## SPRING & BUTTON CONTACTS

For "A" - "AA"

- Economical and reliable contacts are ideal for molded cases with self contained battery compartments
- Single and dual contact designs available for "A" & "AA" size batteries
- "Solder tab" design for either wire lead or PC mounting
- Unique spring contacts adjust to variations in battery lengths
- Reliable spring contacts assure low contact resistance and a dependable connection
- Space saving, economical, excellent mechanical construction

**MATERIAL:**

**Plate:** .020 (.51) thick Steel, Nickel Plate **Spring:** Spring Steel, Nickel Plate

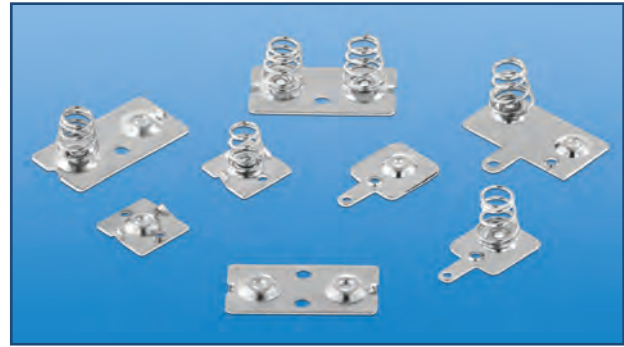

Refer to page 27 for Battery Contact Layout & Mounting Details

For "A" - "AA"

(+) POSITIVE BUTTON WITH TAB

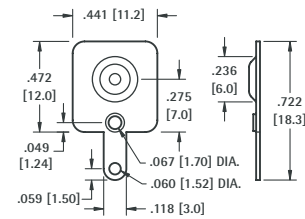

CAT. NO. 5223

(+) POSITIVE BUTTON

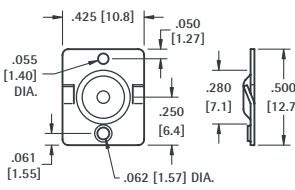

CAT. NO. 5221

(+) POSITIVE BUTTON

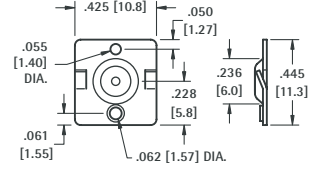

CAT. NO. 5224

(-) NEGATIVE SPRING WITH TAB

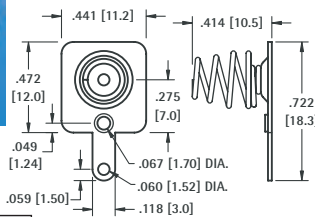

CAT. NO. 5201

(-) NEGATIVE SPRING

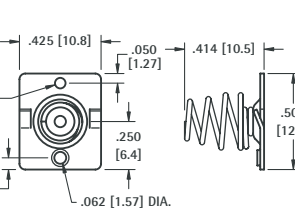

CAT. NO. 5222

(-) NEGATIVE SPRING

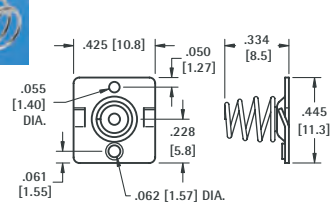

CAT. NO. 5202

DUAL CONTACTS WITH TAB

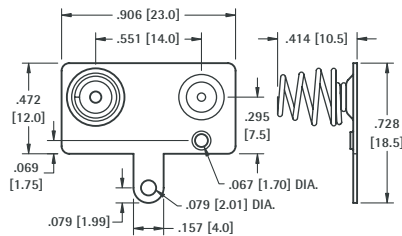

CAT. NO. 5211

DUAL CONTACTS

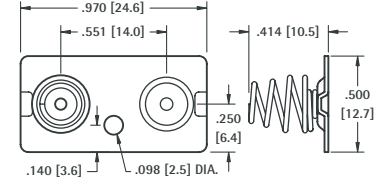

CAT. NO. 5212

DUAL BUTTON CONTACT

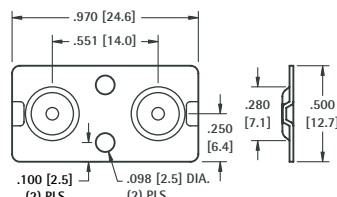

CAT. NO. 5227

DUAL SPRING CONTACT

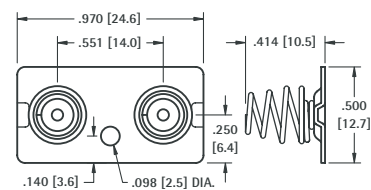

CAT. NO. 5228

BATTERY CONTACTS FOR MOLDED CASES