

REVISIONS				
REV	ECO	DESCRIPTION	DATE	BY APPR
B1	-	RELEASED DRAWING	JAN-18-2014	ARROW TOMMY

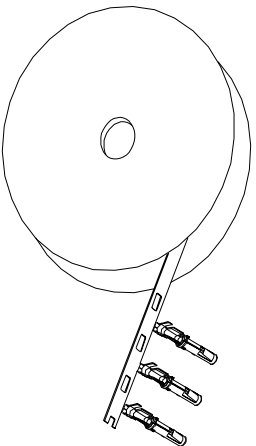

CONTACT ORIENTATION ON ROLL

NOTES : (UNLESS OTHERWISE SPECIFIED)

- MATERIAL :
 - CONTACT BODY : COPPER ALLOY.
 - OUTER SPRING : STAINLESS STEEL.
- SPECIFICATIONS :
 - CURRENT RATING : 13A MAX.
 - TERMINATION TYPE : CRIMPING.
 - WIRE RANGE : 16~18AWG.
 - WIRE INSULATION DIA(MAX) : Ø3.2mm.
- ROHS COMPLIANT.
- ALL DIMENSIONS ARE FOR REFERENCE USE ONLY.
- AVAILABLE TOOLS :
 - HAND CRIMPER : MFX-3954.
 - CRIMP APPLICATOR : MFX-3957.
 - EXTRACTION TOOL : QXRT116.

P/N	CONTACT PLATING(MATING AREA)
SS16M1T	TIN PLATING OVER NICKEL.
SS16M1F	GOLD FLASH PLATING OVER NICKEL.
SS16M1G10	10µ" GOLD PLATING OVER NICKEL.
SS16M1G15	15µ" GOLD PLATING OVER NICKEL.
SS16M1G30	30µ" GOLD PLATING OVER NICKEL.

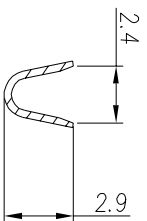

SECTION A-A

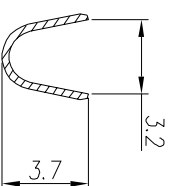

SECTION B-B

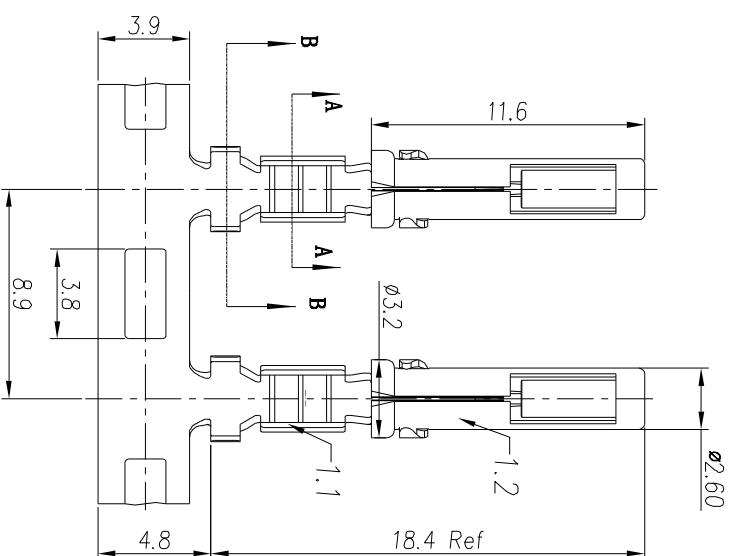

QUANTITY	PART NUMBER	DESCRIPTION	ITER
MATERIALS LIST			
UNLESS OTHERWISE SPECIFIED		DRAWN: ARW	
1) ALL DIMENSIONS ARE IN MILLIMETERS.		DATE: 1/17/2014	
2) Tolerances are as follows:		CHECKED: JWH/2014	
1 PL, DEC 20 08		ENGINEER: [Signature]	
2 PL, DEC 20 08		APPROVAL: [Signature]	
3 PL, DEC 20 08		CUSTOMER: [Signature]	
3) Note reference =		MATERIAL SPECIFICATIONS:	
PROCESS SPECIFICATIONS:		THIS DRAWING IS CONTROLLED BY THE DRAWING OFFICE. ALL REVISIONS AND PERFORMANCE DATA SPECIFICATIONS ARE THE PROPERTY OF SHINE SYSTEMS. ALL RIGHTS OF REPRODUCTION ARE RESERVED. ALL MANUFACTURING VARIATION	
NEXT ASST:		ECO-MATE SOCKET CONTACT, STAMPED, 16-18AWG, SIZE 16	

Amphenol

Shine Systems - www.amphenol-shine.com
44724 Morley Drive
Clinton Township, MI 48038

ECO-MATE SOCKET CONTACT, STAMPED, 16-18AWG, SIZE 16

SIZE	TYPE	DWG NO.	REVISION
B	C-	SS16M1XX	B1
SCALE	NONE	SHEET	1 OF 1