

FEATURES

- Moulded threads
- Resistant to most industrial chemicals, oils, grease, and adverse weather, including ultra-violet light
- Gloss Black
- Temperature rating - 30 to + 140°C
- Made to BS771 standards

RS PRO Black Ball Clamping Knob, M10

RS Stock No.: 686-058



RS Professionally Approved Products bring to you professional quality parts across all product categories. Our product range has been tested by engineers and provides a comparable quality to the leading brands without paying a premium price.

Product Description

Knobs are used in a wide variety of applications in our day-to-day lives and perform many functions, from being used as fixed handles to being used to tighten, loosen, adjust, clamp and push other components or pieces of equipment. They are used in various applications, from industrial and construction machinery to audio and visual equipment.

Female knobs: M4 (RS [686008](#)), M5 (RS [686014](#)), M6 (RS [686020](#)), M8 (RS [686036](#)), M8 (RS [686042](#)), M10 (RS [686058](#)).

General Specifications

Thread	M10
Knob Shape	Ball
Mounting Type	Threaded Hole
Body Material	Duroplast
Colour	Black
Finish	Gloss Finish
Application	Levers & handles, Furniture, Appliances, Tools, Machine jigs

Mechanical Specifications

Thread Diameter	10mm
Thread Length	43mm
Knob Diameter	44mm
Hole Length	13mm

Approvals

Compliance/Certifications	BS771
----------------------------------	-------

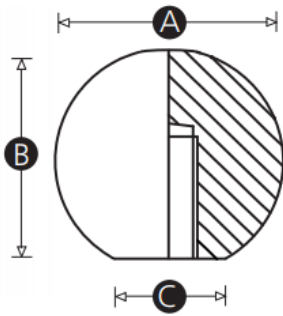

Part No.	A	B	C	Thread size
686008	16	15	8	M4
686014	19	17	12	M5
686020	25	23	14	M6
686036	32	30	15	M8
686042	38	36	17	M8
686058	44	43	13	M10