

THIS COPY IS PROVIDED ON A RESTRICTED BASIS AND IS NOT TO BE USED IN ANY WAY DETRIMENTAL TO THE INTERESTS OF PANDUIT CORP.

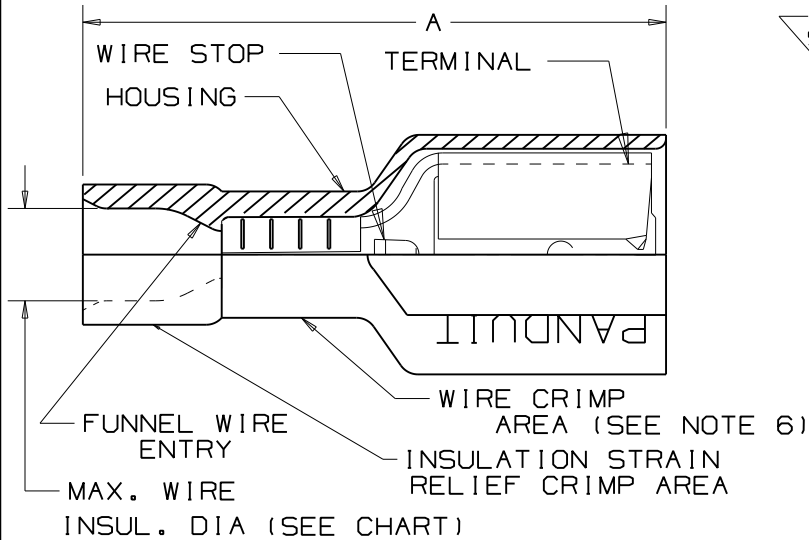

WIRE AND RECEPTACLE SIZES ARE IDENTIFIED ON HOUSING

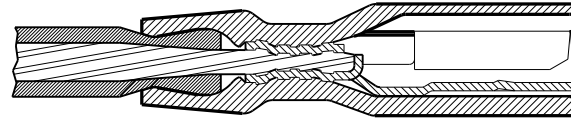
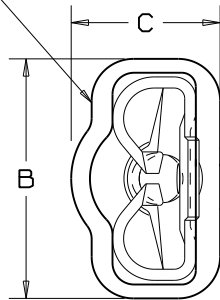

SECTION VIEW OF CRIMPED DISCONNECT

NOTES:

- USED FOR:
  - A: 600V MAX VOLTAGE RATING
  - B: 221°F (105°C) MAX TEMP RATING
  - C: STRANDED COPPER WIRE ONLY
  - D: 6-12 LBS INITIAL INSERTION/WITHDRAWAL FORCE
- SEE [www.panduit.com](http://www.panduit.com) FOR PART NUMBER SUFFIX DESIGNATION FOR PACKAGE SIZE
- MATERIAL:
  - A: STAMPING-CDA 260 BRASS, TIN PLATED
  - B: HOUSING-PREMIUM GRADE NYLON FOR SUPERIOR STRAIN RELIEF INSULATION CRIMPING
- DIMENSIONS IN BRACKETS ARE IN mm OR mm2
- NYLON HOUSING IS OPAQUE
- THE DPF10-250F1 IS CONSTRUCTED WITH AN ADDITIONAL BRASS SLEEVE IN THE CRIMP AREA
- DPF10-250F1B IS UL APPROVED FOR USE WITH THE FOLLOWING WIRE COMBINATIONS: (2) #14, (2) #16, (2) #18 TWIST WIRES TOGETHER BEFORE CRIMPING

| PART NUMBER   | TAB SIZE                        | WIRE RANGE AWG (mm) <sup>2</sup> | COLOR (note 5) | MAX. WIRE INSULATION DIAMETER | MIN. WIRE INSULATION DIAMETER | DIMENSIONS in. |             |             | WIRE STRIP LENGTH                                    | TOOL CHART                     |   |                              |
|---------------|---------------------------------|----------------------------------|----------------|-------------------------------|-------------------------------|----------------|-------------|-------------|--|--------------------------------|---|------------------------------|
|               |                                 |                                  |                |                               |                               | A ±.03 (.8)    | B ±.01 (.3) | C ±.01 (.3) |  |                                |   |                              |
| DPF18-250F1BR | .250 X .032 (6,3 X 0,8)         | 22-18 (0,5-1,0)                  | RED            | .106 (2,69)                   | .060 (1,52)                   | .84 (21,3)     | .35 (8,9)   | .22 (5,6)   | 9/32 <sup>+1/32</sup> -0<br>(7.1 <sup>+0.8</sup> -0) | CT-600-A<br>CT-1525<br>CT-2500 |   |                              |
| DPF18-205F1BR | .205/.187 X .032 (5,2/4,8 X .8) | 22-18 (0,5-1,0)                  | RED            | .106 (2,69)                   | .060 (1,52)                   | .78 (19,8)     | .31 (7,9)   | .22 (5,6)   |  |                                |   |                              |
| DPF18-206F1BR | .205/.187 X .020 (5,2/4,8 X .5) | 22-18 (0,5-1,0)                  | RED            | .106 (2,69)                   | .060 (1,52)                   | .78 (19,8)     | .31 (7,9)   | .22 (5,6)   |  |                                |   |                              |
| DPF18-250F1B  | .250 X .032 (6,3 X 0,8)         | 22-18 (0,5-1,0)                  | RED            | .133 (3,38)                   | .080 (2,03)                   | .84 (21,3)     | .35 (8,9)   | .22 (5,6)   |  |                                |   |                              |
| DPF18-205F1B  | .205/.187 X .032 (5,2/4,8 X .8) | 22-18 (0,5-1,0)                  | RED            | .133 (3,38)                   | .080 (2,03)                   | .78 (19,8)     | .31 (7,9)   | .22 (5,6)   |  |                                |   |                              |
| DPF18-206F1B  | .205/.187 X .020 (5,2/4,8 X .5) | 22-18 (0,5-1,0)                  | RED            | .133 (3,38)                   | .080 (2,03)                   | .78 (19,8)     | .31 (7,9)   | .22 (5,6)   |  |                                |   |                              |
| DPF14-250F1B  | .250 X .032 (6,3 X 0,8)         | 16-14 (1,5-2,5)                  | BLUE           | .156 (3,96)                   | .090 (2,29)                   | .84 (21,3)     | .35 (8,9)   | .22 (5,6)   |  |                                |   |                              |
| DPF14-205F1B  | .205/.187 X .032 (5,2/4,8 X .8) | 16-14 (1,5-2,5)                  | BLUE           | .156 (3,96)                   | .090 (2,29)                   | .78 (19,8)     | .31 (7,9)   | .22 (5,6)   |  |                                |   |                              |
| DPF14-206F1B  | .205/.187 X .020 (5,2/4,8 X .8) | 16-14 (1,5-2,5)                  | BLUE           | .156 (3,96)                   | .090 (2,29)                   | .78 (19,8)     | .31 (7,9)   | .22 (5,6)   |  |                                |   |                              |
| DPF10-250F1B  | .250 X .032 (6,3 X 0,8)         | 12-10 (4,0-6,0)                  | YELLOW         | .220 (5,59)                   | .140 (3,56)                   | .96 (24,4)     | .35 (8,9)   | .23 (5,8)   |  |                                | 3/8 <sup>+1/32</sup> -0<br>(9,5 <sup>+0.8</sup> -0) | CT-1550<br>CT-1551<br>CT-550 |
| DPF10-250F1*  | .250 X .032 (6,3 X 0,8)         | 12-10 (4,0-6,0)                  | YELLOW         | .218 (5,54)                   | .140 (3,56)                   | .95 (24,1)     | .36 (9,1)   | .27 (6,9)   |  |                                | 3/8 <sup>+1/32</sup> -0<br>(9,5 <sup>+0.8</sup> -0) |                              |

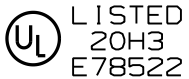

\*DPF10-250F1 IS NOT UL LISTED OR CSA CERTIFIED

Panduit part numbers shown on this drawing meet the material requirements of RoHS (EUROPEAN DIRECTIVES 2002/95/EC) as proposed by the Technical Adaptation Committee.



CORP.

TINLEY PARK, ILLINOIS

|     |      |      |                          |
|-----|------|------|--------------------------|
| 12  | 8/11 | SHOR | ADDED INSTALLATION TOOLS |
| 11  | 7/11 | SRB  | Added Note # 2           |
| REV | DATE | BY   | DESCRIPTION              |

|                 |             |               |                                    |
|-----------------|-------------|---------------|------------------------------------|
| DRAWN BY<br>KRC | CHK'D<br>LA | SCALE<br>NONE | DRAWING NO./CAD FILENAME<br>A41462 |
|-----------------|-------------|---------------|------------------------------------|

DISCOGRIP™ LOOSE PIECE  
FULLY INSULATED FEMALE DISCONNECTS  
.250 X .032, .205 X .032/.020

# Mouser Electronics

Authorized Distributor

Click to View Pricing, Inventory, Delivery & Lifecycle Information:

[Panduit:](#)

[DPF10-250FIB-L](#) [DPF14-250FIB-C](#) [DPF18-205FIB-C](#) [DPF18-206FIB-C](#) [DPF18-250FIB-M](#) [DPF10-250FI-L](#) [DPF18-206FIB-M](#) [DPF18-205FIB-M](#)