

DRAWING REVISIONS (RELEASE DATE ON FILE)			
REV	DOCUMENT	APP	APPROVAL DATE
B	CO 3274	KR	7/18/16

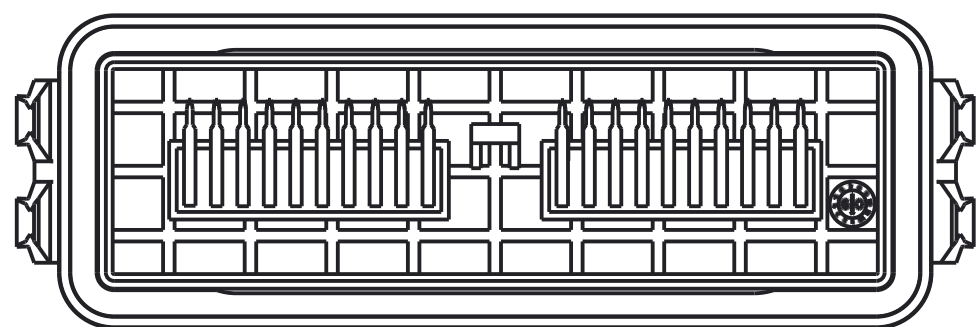

- NOTES:
- DIMENSIONS ARE IN INCHES EXCEPT DIMENSIONS INSIDE [XX] ARE IN mm. ALL DIMENSIONS ARE FOR REFERENCE ONLY.
  - MATERIALS:  
HEADER INSULATOR: 30% GLASS FILLED POLYMER, COLOR BLACK.  
TERMINAL BLADES: 1.5mm BRASS WITH TIN OVER NICKEL PLATING.
  - HEADERS ARE REFLOW OR WAVE SOLDERING PROCESS ROHS COMPLIANT.
  - SEE SHEET 2 FOR PCB DETAILS.
  - RIGHT SIDE MATES WITH MOLEX FEMALE CONNECTOR PART NUMBER 33472-2001 (COLOR BLACK).
  - LEFT SIDE MATES WITH MOLEX FEMALE CONNECTOR PART NUMBER 33472-2002 (COLOR GRAY).

UNITS <b>ENGLISH INCHES</b>		DESIGN ENGINEER K. ROSBOROUGH	DATE 07/29/14	<b>CINCH</b> 1700 FINLEY RD LOMBARD, IL 60148	
DO NOT SCALE DRAWING		PRO/E		TITLE MODICE ME-MX 40 POSITION ASSEMBLY	
UNLESS OTHERWISE SPECIFIED: ALL DIMENSIONS ARE IN INCHES		APPROVALS ON FILE		CONTROL SPEC NUMBER	
FILLET/RADII .02 MAX.	TOLERANCES .X ± .1 XX ± .01 XXX ± .005 ANGULAR ± .5°	MATERIAL NOTED		PROJECT NUMBER A15123	
CONFIDENTIAL THIS DOCUMENT IS THE PROPERTY OF CINCH. NEITHER THIS DOCUMENT NOR ANY OF THE INFORMATION CONTAINED IN IT MAY BE DUPLICATED OR DISCLOSED WITHOUT PRIOR WRITTEN CONSENT OF CINCH. ©COPYRIGHT 2014 CINCH		CAGE IDENT NO. 71785		DRAWING NUMBER <b>581 01 40 011 S</b>	
		SIZE B		SCALE 1:1	
				SHEET 1 OF 2	

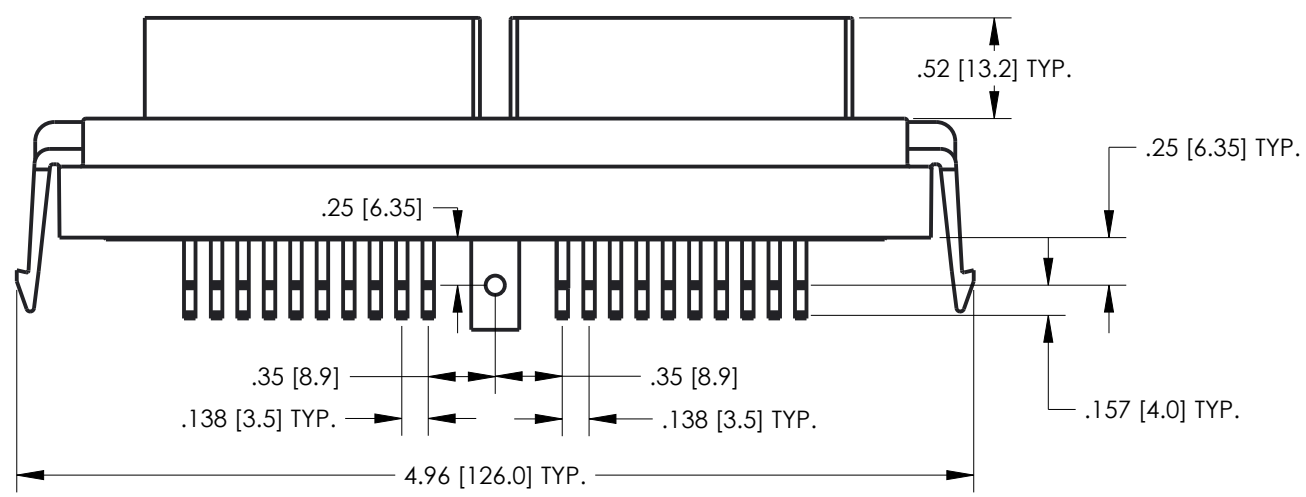
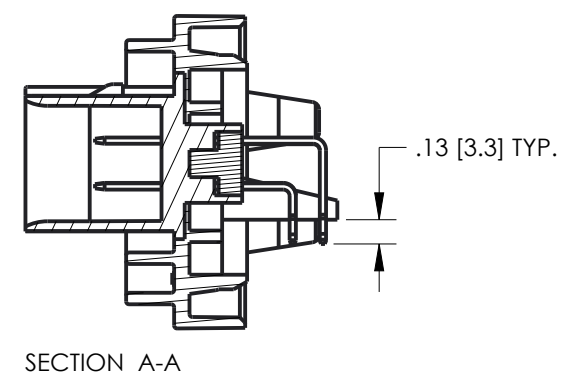
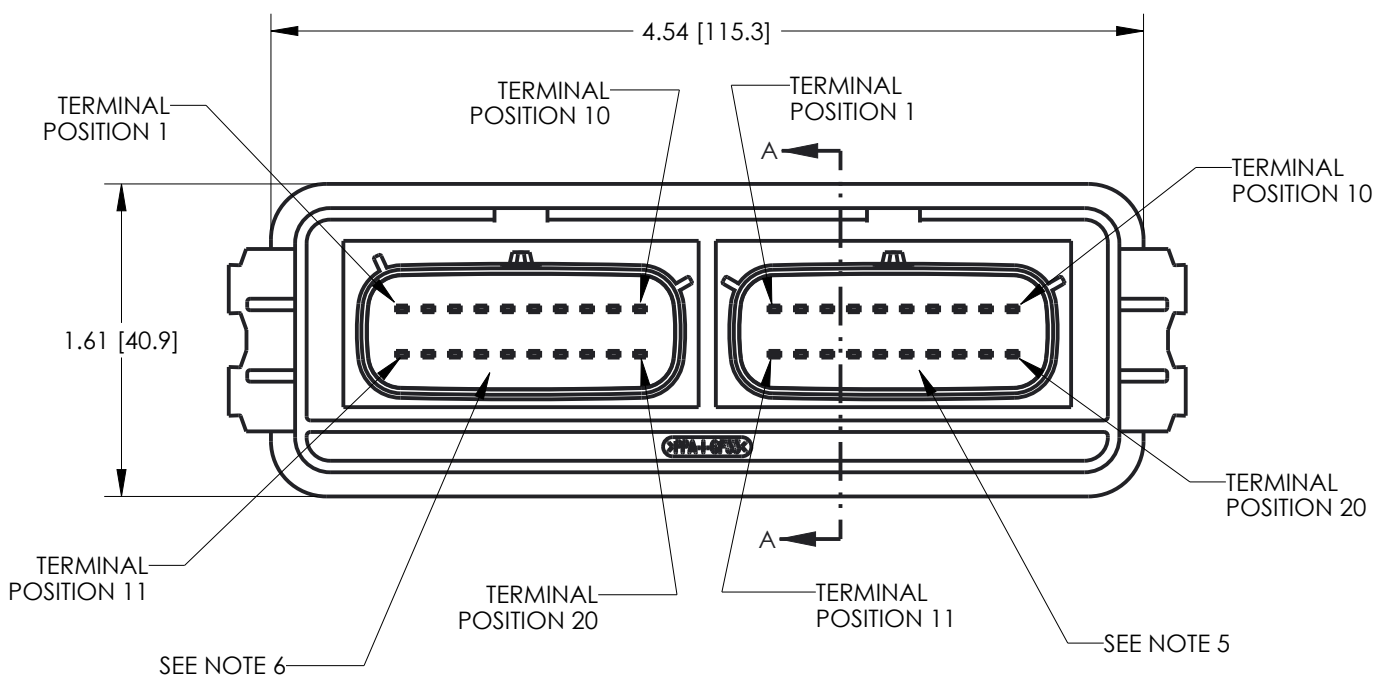