

# CR 1/3 N

Type	Order No.	A	B	C	D	E	F	G	H	I	K	L	Fig. No.	Remarks
CR 1/3 N	6131 101 501	11.6	10.8	0.4	-	7.8	-	-	-	-	-	-	1	-
CR 1/3 N PC PCBD	6131 201 501	13.0	1.0	10.0	1.0 ±0.3	11.5 ±0.5	12.0 ±0.15	-	1.0 ±0.3	3.0	-	-	3	tag 0.25 mm
CR 1/3 N BE STO	6131 301 501	-	-	-	-	11.5	12.0	-	-	-	19.0	4.0	2	tag 0.25 mm 180°

Tag material: nickel plated sheet-steel. SLF: tip tinned.  
 Custom made assemblies are available on request for large volume.

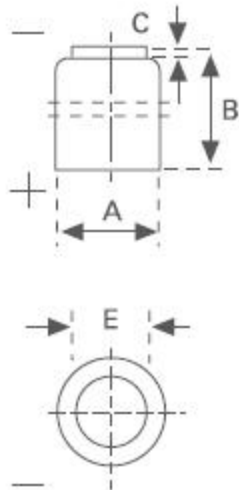

FIG. 1

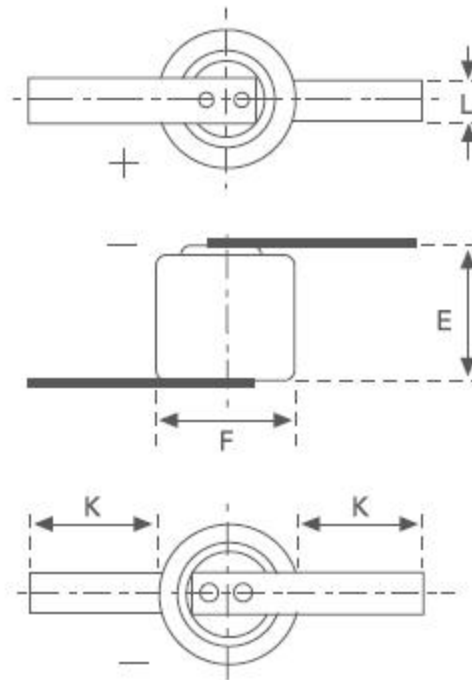

FIG. 2 LF

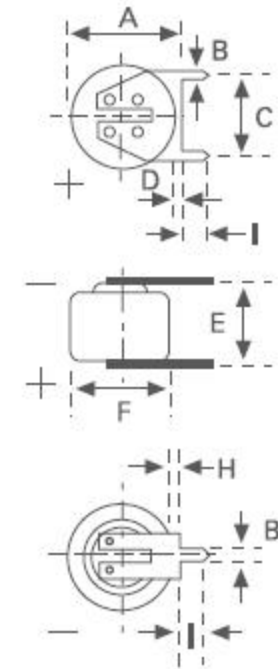

FIG. 3 SLF