

CR 2016

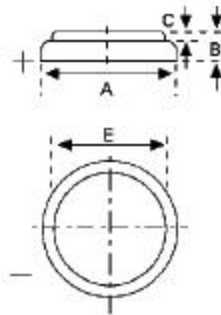

Type Number 6016
 Designation IEC CR 2016
 System Li-Manganese dioxide/
 Organic Electrolyte

UL Recognition MH 13654 (N)
 Nominal Voltage 3 V
 Typical Capacity C 90 mAh (Load 15 kOhm,
 at 20°C down to 2 V)

Weight (approx.) 1,8 g
 Volume 0,5 ccm
 Coding Date of Manufacturing
 Month/Year

Temperature Ranges min. max.
 Storage -55°C 70°C
 Discharge -20°C 70°C¹

Dimensions min. max.
 Diameter (A) 19,70 20,00
 Height (B) 1,40 1,60
 Shoulder Diameter [E] 18,40
 Shoulder Height [C] 0,10

Typical Capacities (at 20°C)

Discharge Type	Load	End Voltage: 2,0 V
Continuous 24 h/d, 7 d/w Current:	15000 Ω 200 μA	Time: 450 h Capacity: 90 mAh Energy: 270 mWh

Performance Data

Temperature Characteristics

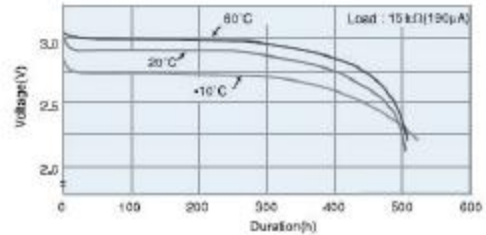

Operating Voltage vs. load resistance*

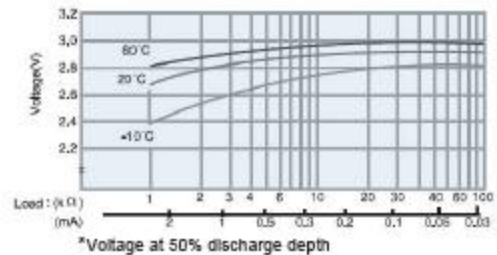

Capacity vs. load resistance

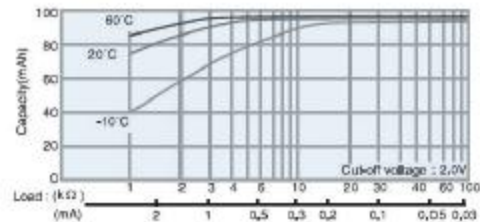

¹ Contact VARTA if the application is intended to be outside the range of -20°C to +70°C.

² depending on environmental condition and energy consumption

- Self-discharge rate < 1% at room temperature
- Storage life > 10 years
- Operating life² > 10 years