

CR 1616

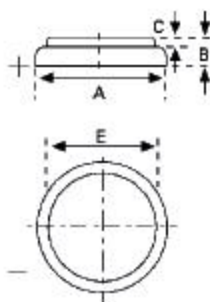

| | |
|--------------------------|---|
| Type Number | 6616 |
| Designation IEC | CR 1616 |
| System | Li-Manganese dioxide/ Organic Electrolyte |
| UL Recognition | MH 13654 (N) |
| Nominal Voltage | 3 V |
| Typical Capacity C | 55 mAh (Load 39 kOhm, at 20°C down to 2 V) |

| | |
|------------------------|-------------------------------------|
| Weight (approx.) | 1,2 g |
| Volume | 0,3 ccm |
| Coding | Date of Manufacturing Month/Year |

| | | |
|---------------------------|-------|-------------------|
| Temperature Ranges | min. | max. |
| Storage | -55°C | 70°C |
| Discharge | -20°C | 70°C ¹ |

| | | |
|-----------------------------|-------|-------|
| Dimensions | min. | max. |
| Diameter (A) | 15,70 | 16,00 |
| Height (B) | 1,40 | 1,60 |
| Shoulder Diameter [E] | 12,00 | |
| Shoulder Height [C] | 0,20 | |

Typical Capacities (at 20°C)

| Discharge Type | Load | End Voltage: 2,0 V |
|---|---------|--|
| Continuous 24 h/d, 7 d/w Current [µA] | 39000 Ω | Time: 670 h Capacity: 50 mAh Energy: 142 mWh |

Performance Data

Temperature Characteristics

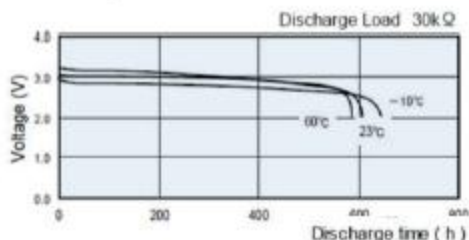

Operating Voltage vs. load resistance²

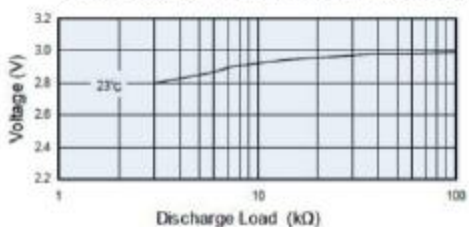

²Discharge depth 40%

Capacity vs. load resistance

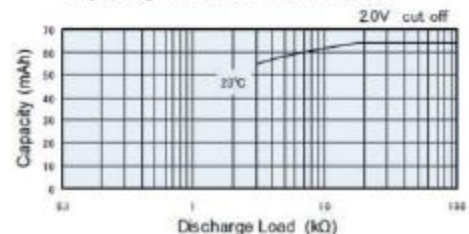

Discharge Characteristics

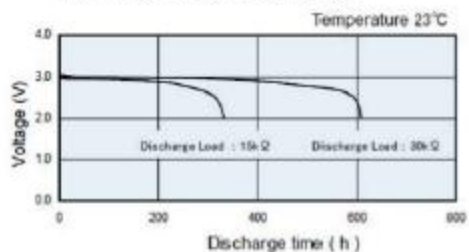

¹ Contact VARTA if the application is intended to be outside the range of -20°C to +70°C.

² depending on environmental condition and energy consumption

- Self-discharge rate < 1% at room temperature
- Storage life > 10 years
- Operating life² > 10 years