

## Hour meters / timers, electromechanical

Timers, round design

With LED run indicator (AC+DC)

HR 47



The hour meter HR 47 with run indicator feature a very high shock resistance.

These panel-mount counters for round panel cut-outs can be used in many different fields of application. These non-resettable counters are very robust and extremely tamper-proof.



### Characteristics

- 7-digit hour meter
- For voltage ranges 10...80 V DC, 100...130 V AC and 187...264 V AC
- Magnified large figures
- Protection IP65 on the front and rear sides
- Suitable for any mounting position
- Without reset, and thus tamper-proof
- High shock and impact resistance

### Benefits

- With run indicator (AC version), optional LED (DC version)
- For panel cut-out  $\varnothing$  50.5 mm with front panel dimensions  $\varnothing$  58 mm
- Simple and secure mounting with screwed clamping clip

### Applications

General time measurement, construction machinery and industrial trucks, small appliances, UV lamps, display panels in vehicles, compressors, air-conditioning equipment, etc.

### Type series

Description	Mounting	Type
Timer, round	Clamping clip fixing, screw-on	<b>HR 47</b>

Accessories	Dimensions in mm [inch]	Order-No.
<b>Counter mounting fixture</b>	For round counters with cut-out $\varnothing$ 53 [2.09"]	black <b>N510199</b>
<b>Gasket, <math>\varnothing</math> 58 [2.28"]</b>	For cut-out $\varnothing$ 50 [1.97"]	black <b>N511182</b>
<b>Adapter and anti-vibration set</b>	For HR 47, $\varnothing$ 80 [3.15"] for cut-out $\varnothing$ 71 [2.80"]	black <b>255319</b>

Suitable gaskets as well as further accessories can be found in the accessories section or in the accessories area of our website at: [www.kuebler.com/accessories](http://www.kuebler.com/accessories).

# Hour meters / timers, electromechanical

<b>Timers, round design</b>	<b>With LED run indicator (AC+DC)</b>	<b>HR 47</b>
-----------------------------	---------------------------------------	--------------

Technical data	
<b>Electrical connection</b>	screw terminal for flat pin 6.3 x 0.8 mm [0.25 x 0.031"]
<b>Power consumption</b>	10 ... 80 V DC max. 720 mW 100 ... 130 V AC, 60 Hz max. 1.1 VA 187 ... 264 V AC, 50 Hz approx. 1.2 VA
<b>Rated voltages</b>	AC (50 or 60 Hz) 100 ... 130/187 ... 264 V AC, DC 10 ... 80 V DC
<b>On time</b>	100 %
<b>Number of digits</b>	AC 7: 99999.99 h DC 7: 999999.9 h
<b>Resolution</b>	AC 0.01 h equals 36 s DC 0.1 h equals 6 min
<b>Count mode</b>	adding
<b>Height of figures</b>	4 mm [0.16"]
<b>Colour of figures</b>	hours white on black decimal position 50 Hz - red on black 60 Hz - red on white
<b>Operating temperature</b>	AC -25°C ... +80°C [-13°F ... +176°F] (non-condensing) DC -20°C ... +70°C [-4°F ... +158°F] (non-condensing)
<b>Relative humidity</b>	< 95% (non-condensing)
<b>Counter reading on delivery</b>	1,00 - 1,02

<b>Mounting position</b>	any
<b>Protection</b>	up to IP65, EN 60529 (except the connections)
<b>Housing</b>	plastic PC (Polycarbonate)
<b>Accuracy</b>	AC ± 0.02% DC ± 0.002%
<b>Weight</b>	approx. 50 g [1.76 oz]
<b>Run indicator</b>	AC fast rotating wheel in viewing window DC optional LED
<b>Test voltage</b>	2000 V AC, 50 Hz for AC version
<b>EMC</b>	Emitted interference EN 55011 class B Immunity to interference EN 61000-6-2
<b>Device safety</b>	Designed to EN 61010 part 1 Protection class 2 Application area Pollution level 2

Options
Counter for $\varnothing$ 52 mm [2.02"] with screwed clamping bracket or screw thread on request

Hour meters / Timers

## Timer, round Type HR 47

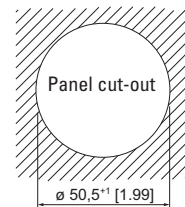
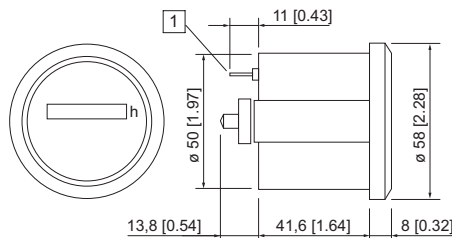

1) Electrical connection

Front bezel thickness max. 6 [0.24] without having to shorten the clamping bracket

Type	Display	Voltage	Art.-No.			further types on request
			10 ... 80 V DC	100 ... 130 V 60 Hz	187 ... 264 V 50 Hz	
<b>HR 47</b>	6 digits	V AC, with run indicator	<b>3.474.901.373</b> <sup>1)</sup>	<b>3.474.901.084</b> <sup>1)</sup>	<b>3.474.901.075</b> <sup>1)</sup>	
		V DC, without run indicator				
		V DC, with run indicator				