

MATERIAL: STEEL

FINISH: COMMERCIAL ZINC PLATING

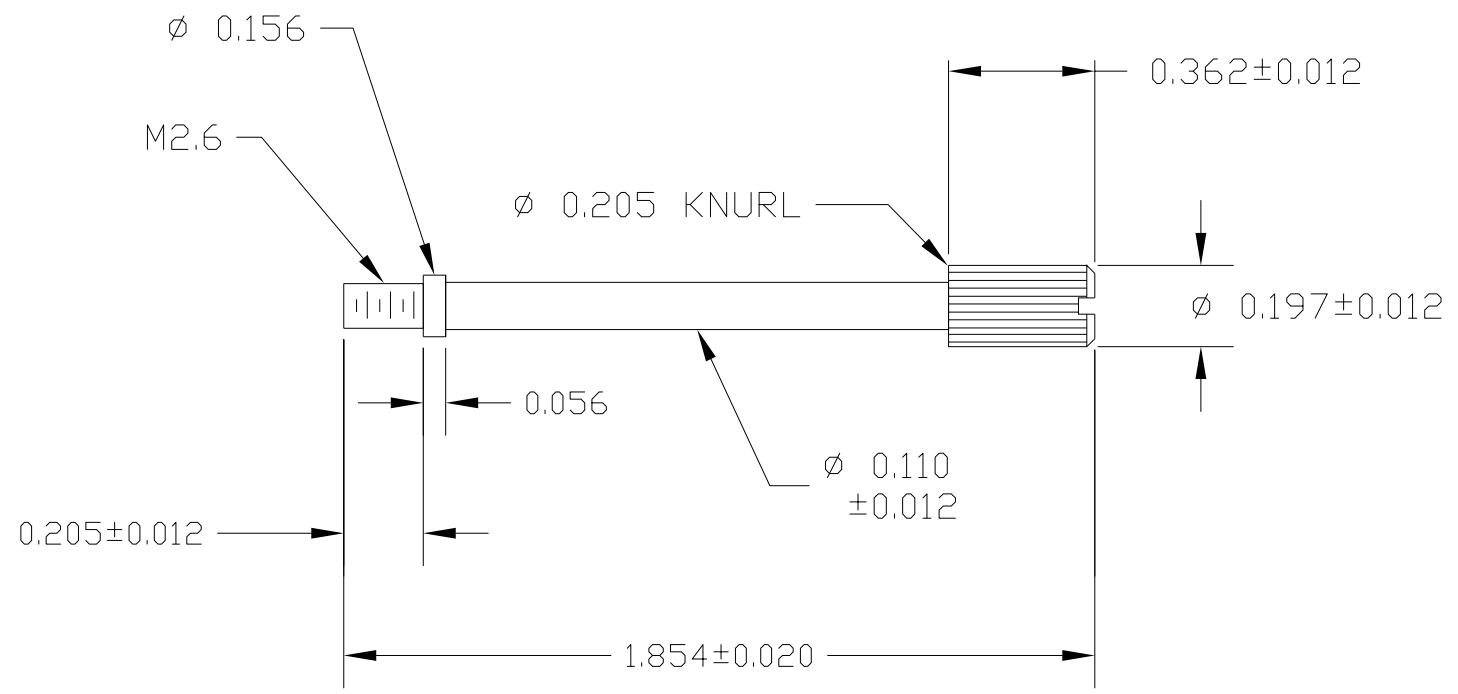

FOR USE IN SERIES** #'S: 952, 970, 971*, 972
 *FOR 971, CAN ONLY BE USED TO REPLACE (1) SCREW DUE TO INTERFERENCE
 ** PLEASE ENSURE FIT AND FUNCTION ARE SUITABLE FOR YOUR APPLICATION

RoHS COMPLIANT

UNITS = INCHES [MM] DO NOT SCALE FROM DRAWING



THESE DRAWINGS AND SPECIFICATIONS ARE THE PROPERTY OF NorComp AND SHALL NOT BE REPRODUCED, COPIED OR USED AS THE BASIS FOR THE MANUFACTURE OR SALE OF APPARATUS WITHOUT WRITTEN PERMISSION.

DRAWN: J. KADEL
 DATE: 10/29/2018

NorComp

SCALE: NTS	SHEET 1 OF 1	REV 8
DWG NO. 160-000-060R031		

Mouser Electronics

Authorized Distributor

Click to View Pricing, Inventory, Delivery & Lifecycle Information:

[NorComp:](#)

[160-000-060R031](#)