

used for:

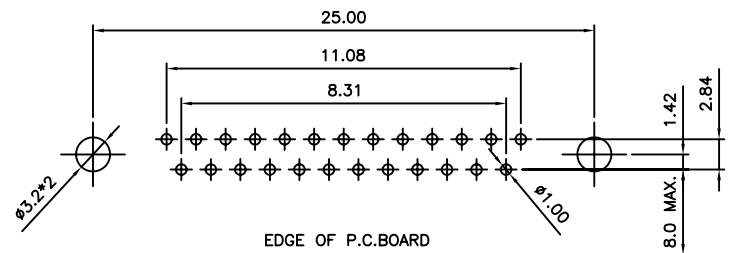
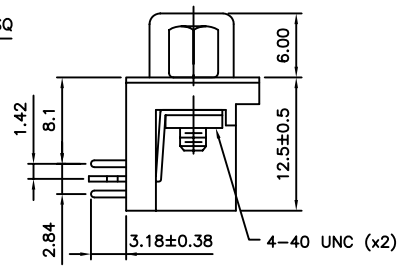
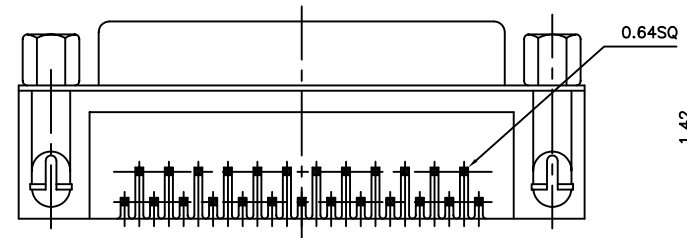
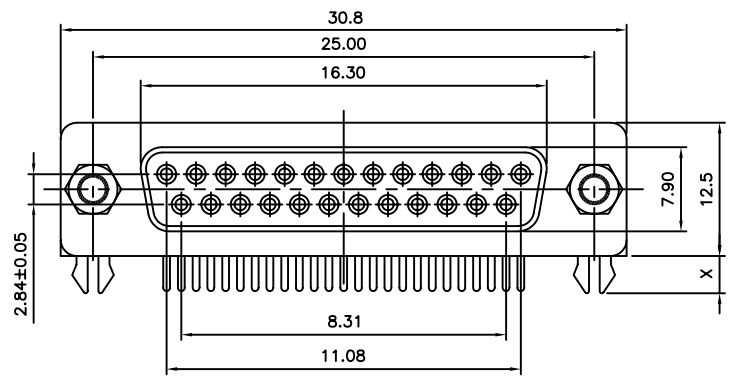

RECOMMENDED P.C.B LAYOUT (TOP VIEW)  
TOLERANCES: ±0.05mm

**SPECIFICATION**

**MATERIAL**

Insulator: Thermal Plastic UL94V-0  
Contacts: Copper Alloy  
Shell: Steel  
Rivet, Boardlock: Copper Alloy

**CONTACT PLATING**

Underplate: 50u" Nickel  
Contact Area: Selective Gold  
Solder Tails Area: 100u" Tin/Lead Free

**ELECTRICAL**

Operation Voltage: 250 VAC Max.  
Current Rating: 3 Amps Max.  
Contact Resistance: 15 mohms Max.  
Insulation Resistance: 3000 Mohms Min @ 500 VDC  
Dielectric Withstanding Voltage: 1000 VAC / Minute  
Operating Temperature: -55°C To +105°C

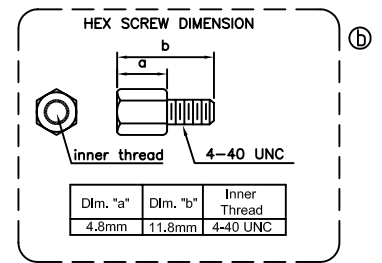

THIS DRAWING MAY NOT BE COPIED OR REPRODUCED IN ANY WAY, AND MAY NOT BE PASSED ON TO A THIRD PARTY WITHOUT WRITTEN PERMISSION. OWNERSHIP AND COPYRIGHT OF CONEC CORPORATION. DO NOT ALTER CAD DRAWING BY HAND.

| tolerance   |             | finish     |      |
|---|-------------|------------|------|
| unless otherwise specified tolerance shall be as follow |             |            |      |
| Decimal:  | x .±0.50    |            |      |
|   | .x ±0.30    |            |      |
|   | .xx ±0.20   |            |      |
| Angles: ±5°   |             | Dim. in mm |      |
| rev.  | description | date       | name |
| b   | Dec/14/07   | Vincent Ke |      |
| a   | origin      |            |      |

| 2005  | date    | name       |
|-------|---------|------------|
| draw. | Oct. 03 | Vincent Ke |
| appd. | Oct. 03 | Kathy      |
| norm  |         |            |
| d-old |         |            |

| scale:         | material:                    |
|----------------|------------------------------|
|                | SEE NOTES                    |
| title:         | D-Sub R/A 7.2mm 9pos. female |
| RoHS compliant |                              |
| drawing no.:   | AutoCAD 2005                 |
|                | C0510K01A                    |
| part no.:      | DLS1XS5AK40X                 |

DIN A3 sheet 1/1

# Mouser Electronics

Authorized Distributor

Click to View Pricing, Inventory, Delivery & Lifecycle Information:

[Amphenol:](#)

[DLS1XS5AK40X](#)