

# EPIC<sup>®</sup> CONNECTORS

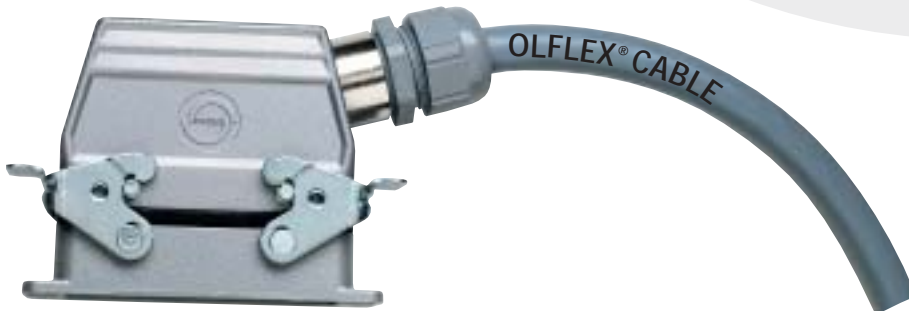

*"The Perfect  
Connection"*

800-774-3539  
[www.lappusa.com](http://www.lappusa.com)

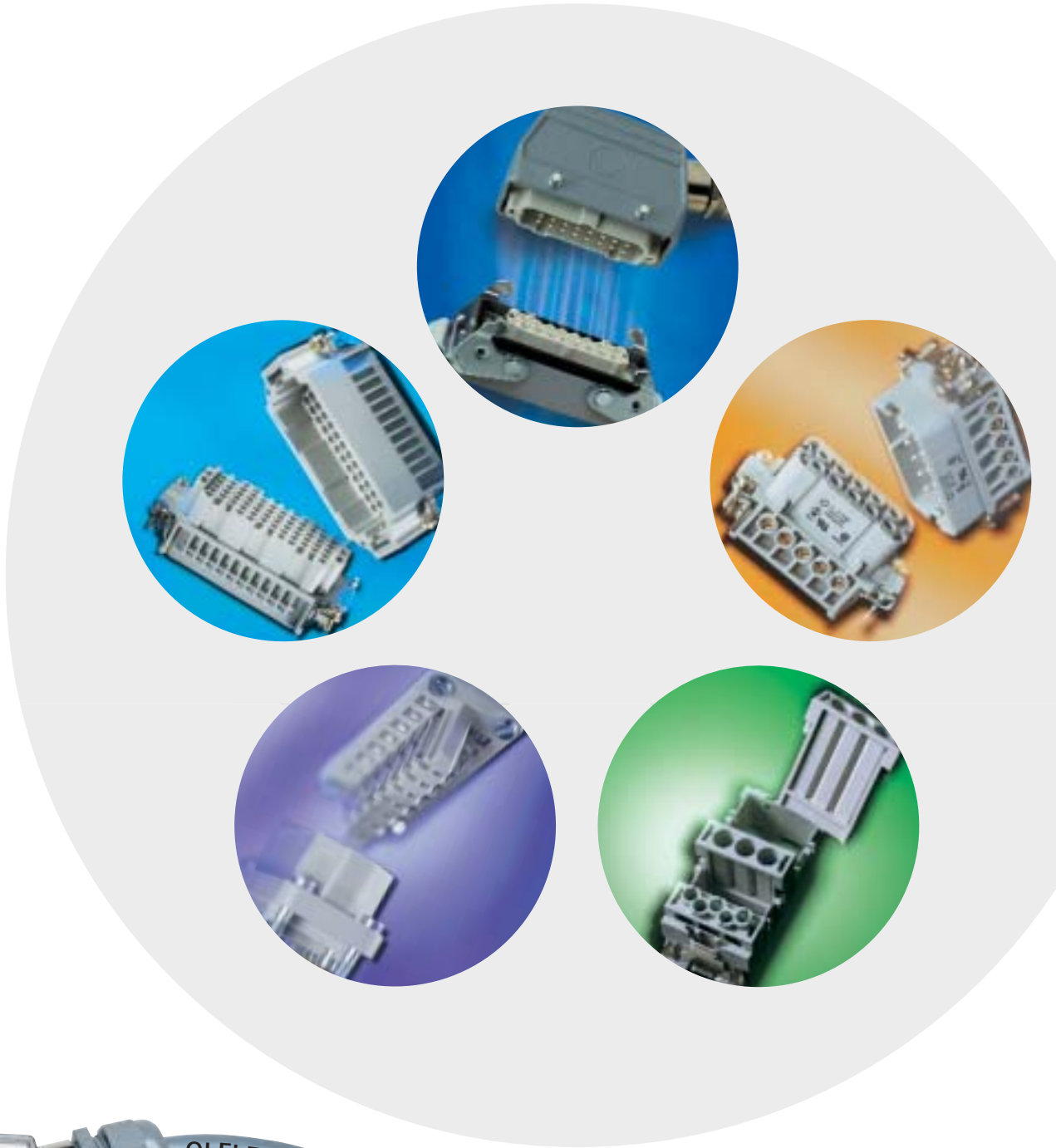

**LAPP USA**

# EPIC® CONNECTORS

## Rectangular Industrial Connectors: Technical Data Overview

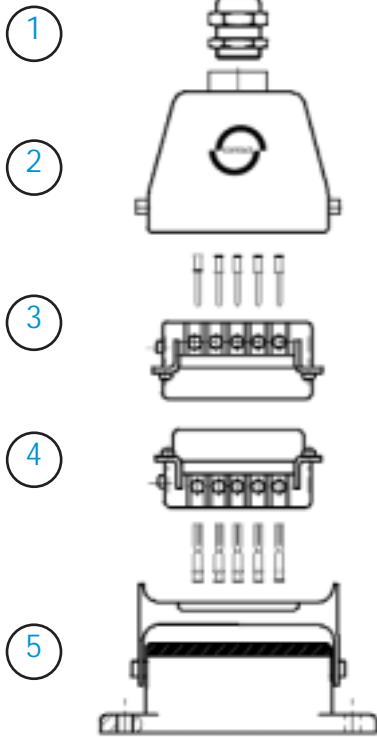

### 1. Strain Relief:

Strain Relief provides a seal between the cable and the connector housing. It may also be used to offer additional functions like strain relief and braid continuity for EMC protection.

### 2. Hood:

The connector housing allows for cable entry. Contact's hoods are available as top entry or side entry in a variety of sizes (PG, Metric, NPT)

### 3. Male Insert:

Types of contact termination

- Screw
- Crimp (Stamped & Formed or Machined) **Contacts must be purchased separately.**
- Cage Clamp
- Terminal Block

### 4. Female Insert:

Types of contact termination

- Screw
- Crimp (Stamped & Formed or Machined) **Contacts must be purchased separately.**
- Cage Clamp (Screwless Spring)
- Terminal Block Adapters (Screw Termination)

### 5. Base:

- Panel Mount: cable entry through cut out in panel
- Surface Mount: cable entry through a gland into the side of the connector base
- Cable Connector Hood: cable to cable connection. The cable connector mates with a top entry hood. This is frequently used to extend cables.

## EPIC® RECTANGULAR HOUSINGS

### Specifications:

DIN 43652

### Temperature Range:

-40°C to +125°C

### Protection class:

IP65 (Comparable to NEMA 4 & NEMA 12)

### Material:

IP 65: HBE 6 - 48, HA 10 - 64: aluminum alloy, powder coated (grey), locking levers and bolts made of zinc plated steel. HA 3/4: Die cast zinc, powder coated or thermoplastic flame retardant material rated UL 94 V-0 (Grey or Black Plastic).

IP 65 & EP: HBE 6 - 48 EP, HA 10 - 64 EP: Environmentally Protected: aluminum alloy, powder coated (black), locking levers and bolts made of stainless steel.



LR53004-1



EPIC® rectangular connectors shall comply with all applicable requirements of Underwriters Laboratory (UL) Standards 1977 and 498, VDE Standard 0110 for creepage and clearance distances and VDE Standard 0627 for the connector design. The HD and HDD series is developed according to DIN Standard 43652.

EPIC® connectors meet IP 65 standards only when in the mated condition.

Panel Mount Base	A	B	C	D	E
HA 3	30	-	21	21	3.3
HA 10	70	17.5	57.5	24	3.6
HA 16	86	17.5	73.7	24	3.6
HA 32	92	42	74.2	48.4	4.3
HA 48	110	65	85.5	71	5.5
HBE 6	70	32	52.2	35	4.3
HBE 10	83	32	65.2	35	4.3
HBE 16	103	32	85.5	35	4.3
HBE 24	130	32	112.2	35	4.3
HBE 32	110	65	85.5	71	5.5
HBE 48 & HA 64	148	70	117	82	7

## PANEL MOUNT BASE CUT-OUTS

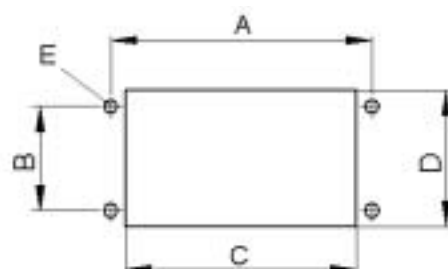

# EPIC® CONNECTORS

## Rectangular Industrial Connectors: Quick Select Chart



		HA	HQ	STA	HBE	HEE	HBS	HBVE	HD	HDD	MC	MP
# of Contacts + PE	3	X						X				
	4	X										
	5		X									
	6			X	X		X	X				
	7								X			
	8								X			
	10	X			X	X		X				
	12							X				
	14			X								
	15								X			
	16	X				X						
	18						X					
	20			X								
	24					X					X	
	25								X			
	32	X				X	X					
	40			X					X			
	42										X	
	46						X					
	48	X				X						
	50								X			
	64	X					X		X			
	72										X	
80								X				
92						X						
108										X		
128								X				
144										X		
216										X		
2-280											X	
4 Pwr / 0 Signal												X
4 Pwr / Signal												X
4 Pwr / 8 Signal												X
UL Rated Voltage	48V			X								
	600V	X	X		X	X	X	X	X	X		
	63-1000V										X	
	380- 600V											X
UL Rated Current	7A								X			
	8.5A									X		
	10A	X (3/4)		X					X			
	14 A	X										
	16A		X		X	X		X				
	35A						X					
	10 - 82A										X	
16 - 80A											X	
Termination Type	Cage Clamp				X						X	
	Crimp		X		X	X			X	X	X	
	Screw	X		X	X		X	X			X	X
	Solder			X								
	Terminal Block				X				X			
Wire Size (AWG)	20 - 16			X					X			
	22 - 14								X (Crimp)	X		
	20 - 14	X	X		X			X				
	up to 14											X (Signal)
	20 - 12				X (Crimp)	X						
	20 - 10						X					
	30 - 6										X	
up to 6											X (Power)	

# EPIC® CONNECTORS

Rectangular Industrial Connectors: Quick Select Chart

Terminate your OLFLEX® Cable with the Right Connector



Wire Gauge AWG	# Conductors with Ground	HA	STA 10A	HBE 16 A	HEE 16A	HBS 35 A	HBVE 16A	HD 10A	HDD 8.5 A	HQ 16 A	MC	MP
AWG 6	3										MC2	Power
	4										MC2	Power
	5										MC2	Power
AWG 8	3										MC2/MC3	Power
	4										MC2/MC3	Power
	5										MC3 x 2	Power
AWG 10	3					HBS6					MC2/MC3	Power
	4					HBS6					MC2/MC3	Power
	5					HBS6					MC3 x 2	Power
	7					HBS6					MC3 x 2	Power
AWG 12	2			HBE6		HBS6					MC3	
	3			HBE6		HBS6					MC3	
	4			HBE6		HBS6					MC3/MC4/MC5	
	5			HBE6		HBS6					MC4/MC5	
AWG 14	2	HA3		HBE6		HBS6	HBVE3	HD7		HQ5	MC3	Signal
	3	HA3		HBE6		HBS6	HBVE3	HD7		HQ5	MC3	Signal
	4	HA3		HBE6		HBS6	HBVE3	HD7		HQ5	MC3/MC4/MC5	Signal
	5	HA4		HBE6		HBS6	HBVE6	HD7		HQ5	MC4/MC5	Signal
	7	HA10		HBE6	HEE10	HBS6	HBVE6	HD7			MC10	Signal
	9	HA10		HBE10	HEE10	HBS12	HBVE10	HD8			MC10	Signal
	12	HA16		HBE16	HEE18	HBS12		HD15			MC10 x 2	
	18	HA32		HBE24	HEE18			HD24	HDD24		MC10 x 2	
AWG 16	2	HA3	STA6	HBE6		HBS6	HBVE3	HD7		HQ5	MC3	Signal
	3	HA3	STA6	HBE6		HBS6	HBVE3	HD7		HQ5	MC3	Signal
	4	HA3	STA6	HBE6		HBS6	HBVE3	HD7		HQ5	MC3/MC4/MC5	Signal
	5	HA4	STA6	HBE6		HBS6	HBVE6	HD7		HQ5	MC4/MC5	Signal
	7	HA10	STA6	HBE6	HEE10	HBS6	HBVE6	HD7			MC10	Signal
	9	HA10	STA14	HBE10	HEE10	HBS12	HBVE10	HD8			MC10	Signal
	12	HA16	STA14	HBE16	HEE18	HBS12		HD15			MC10 x 2	
	18	HA32	STA20	HBE24	HEE18			HD24	HDD24		MC10 x 2	
	25	HA32	STA40	HBE24	HEE32			HD24	HDD24		MC10 x 3	
	34	HA48	STA40	HBE48	HEE46			HD40	HDD42		MC10 x 4	
	41	HA48	STA40	HBE48	HEE46			HD40	HDD42		MC10 x 4	
	50	HA64			HEE64			HD50	HDD72		MC10 x 5	
AWG 18	2	HA3	STA6	HBE6		HBS6	HBVE3	HD7		HQ5	MC4	Signal
	3	HA3	STA6	HBE6		HBS6	HBVE3	HD7		HQ5	MC4	Signal
	4	HA3	STA6	HBE6		HBS6	HBVE3	HD7		HQ5	MC4/MC5	Signal
	5	HA4	STA6	HBE6		HBS6	HBVE6	HD7		HQ5	MC4/MC5	Signal
	7	HA10	STA6	HBE6	HEE10	HBS6	HBVE6	HD7			MC10	Signal
	9	HA10	STA14	HBE10	HEE10	HBS12	HBVE10	HD8			MC10	Signal
	12	HA16	STA14	HBE16	HEE18	HBS12		HD15			MC10 x 2	
	18	HA32	STA20	HBE24	HEE18			HD24	HDD24		MC10 x 2	
AWG 20	2	HA3	STA6	HBE6		HBS6	HBVE3	HD7		HQ5	MC4	Signal
	3	HA3	STA6	HBE6		HBS6	HBVE3	HD7		HQ5	MC4	Signal
	4	HA3	STA6	HBE6		HBS6	HBVE3	HD7		HQ5	MC4/MC5	Signal
	5	HA4	STA6	HBE6		HBS6	HBVE6	HD7		HQ5	MC4/MC5	Signal
	7	HA10	STA6	HBE6	HEE10	HBS6	HBVE6	HD7			MC10	Signal
	9	HA10	STA14	HBE10	HEE10	HBS12	HBVE10	HD8			MC10	Signal
	10	HA10	STA14	HBE10	HEE10	HBS12		HD15			MC10	
	12	HA16	STA14	HBE16	HEE18	HBS12		HD15			MC20	
AWG 20	18	HA32	STA20	HBE24	HEE18			HD24	HDD24		MC20	
	24	HA32	STA40	HBE24	HEE32			HD24	HDD24		MC20 x 2	
	25	HA32	STA40	HBE24	HEE32			HD24	HDD24		MC20 x 2	
	34	HA48	STA40	HBE48	HEE46			HD40	HDD42		MC20 x 2	

Please note that the amperage for all series listed in black can be found at the top of the column.

4 Amps, 10 Amps, 14 Amps, 16 Amps, 20 Amps, 25 Amps, 50 Amps, 80 Amps, 83 Amps

- Notes: 1) The above chart shows the relationship between cable wire gauge and conductor count with connector contact count. Final connector selection and application suitability will depend on voltage and current limits of the cable and connector
- 2) The MC Series modular connector offers a wide variety of mix-and-match combinations. The combinations shown in the chart are offered as suggestions based on providing a solution in the smallest housing size.

# EPIC® CONNECTORS

Rectangular Industrial Connectors: Quick Select Chart

Terminate your OLFLEX® Cable with the Right Connector



Wire Gauge AWG	# Conductors with Ground	HA	STA 10 A	HBE 16 A	HEE 16 A	HBS 35 A	HBVE 16 A	HD 10A	HDD 8.5 A	HQ 16 A	MC	MP
AWG 22 with or without ground	2							HD7				
	3							HD7				
	4							HD7				
	5							HD7			MC10	
	7							HD7			MC10	
	8							HD7			MC10	
	10							HD15			MC10	
	12							HD15			MC20	
	14							HD15			MC20	
	15							HD15			MC20	
	16							HD15			MC20	
	18							HD24	HDD24		MC20	
	20							HD24	HDD24		MC20	
	21							HD24	HDD24		MC20	
	25							HD24	HDD24		MC20 x 2	
	28							HD40	HDD42		MC20 x 2	
	30							HD40	HDD42		MC20 x 2	
	32							HD40	HDD42		MC20 x 2	
	36							HD40	HDD42		MC20 x 2	
	40							HD40	HDD42		MC20 x 2	
	44							HD50	HDD72		MC20 x 3	
50							HD50	HDD72		MC20 x 3		
61							HD64	HDD72		MC20 x 3		
AWG 24, 26 with or without ground	5										MC10	
	7										MC10	
	8										MC10	
	10										MC10	
	12										MC20	
	14										MC20	
	15										MC20	
	16										MC20	
	18										MC20	
	20										MC20	
	21										MC20	
	25										MC20 x 2	
	28										MC20 x 2	
	30										MC20 x 2	
32										MC20 x 2		
36										MC20 x 2		
40										MC20 x 2		
44										MC20 x 3		
50										MC20 x 3		
61										MC20 x 3		
AWG 28 with or without ground	10										MC20	
	12										MC20	
	14										MC20	
	15										MC20	
	16										MC20	
	18										MC20	
	20										MC20	
	21										MC20	
	25										MC20 x 2	
	28										MC20 x 2	
	30										MC20 x 2	
	32										MC20 x 2	
	36										MC20 x 2	
	40										MC20 x 2	
44										MC20 x 3		
50										MC20 x 3		
61										MC20 x 3		

Please note that the amperage for all series listed in black can be found at the top of the column.

4 Amps, 10 Amps, 14 Amps, 16 Amps, 20 Amps, 25 Amps, 50 Amps, 80 Amps, 83 Amps

- Notes: 1) The above chart shows the relationship between cable wire gauge and conductor count with connector contact count. Final connector selection and application suitability will depend on voltage and current limits of the cable and connector
- 2) The MC Series modular connector offers a wide variety of mix-and-match combinations. The combinations shown in the chart are offered as suggestions based on providing a solution in the smallest housing size.

# EPIC® CONNECTORS

## Rectangular Industrial Connectors: Plugs & Receptacles



**# of Contacts:** 3, 4, 10, 16, 32, 48, 64 (+PE)  
**Rated Voltage:** 600V  
**Rated Current:** 10A (HA 3/4),  
 14A (HA 10 - 64)

### EPIC® HA

**Termination:** Screw  
**Wire Size:** AWG 20 - 14  
 (0.5 - 2.5 mm<sup>2</sup>)

#### Mating Housings

Insert:	Housing:
HA 3/4	HA 3/4
HA 10	HA 10
HA 16	HA 16
HA 32	HA 32
HA 48	HA 48
HA 64	HA 64

EPIC® HA							
	3	4	10	16	32 *	48 *	64 *
Plug	10.4200	10.4310	10.4401	10.5300	10.5400	10.5401	10.5405
Receptacle	10.4210	10.4320	10.4411	10.5310	10.5410	10.5411	10.5415

\*HA 32 = HA 16+32, HA 48= HA 16+32+48, HA 64= HA 16+32+48+64

These inserts have wire protection. Inserts with wire protection are also available.

**# of Contacts:** 6, 10, 16, 24, 32, 48 (+PE)  
**Rated Voltage:** 600V  
**Rated Current:** 16A

**Termination:** Screw, Crimp, Cage clamp, Terminal Block  
**Wire Size:** AWG 20 - 14 (0.5 - 2.5 mm<sup>2</sup>)  
 AWG 20 - 12 (0.5 - 4 mm<sup>2</sup>)- Crimp

### EPIC® HBE



EPIC® HBE: Screw Terminated						
	6	10	16	24	32 *	48 *
Plug	10.1900	10.1920	10.1940	10.1960	10.2020	10.2040
Receptacle	10.1910	10.1930	10.1950	10.1970	10.2030	10.2050

EPIC® HBE: Crimp Terminated						
	6	10	16	24	32 *	48 *
Plug	10.1800	10.1820	10.1840	10.1860	10.1842	10.1862
Receptacle	10.1810	10.1830	10.1850	10.1870	10.1852	10.1872

\* HBE 32 = HBE 16+32, HBE 48= HBE 24 +48

These inserts have wire protection. Inserts without wire protection are also available.

#### Mating Housings

Insert:	Housing:
HBE 6	HBE 6
HBE 10	HBE 10
HBE 16	HBE 16
HBE 24	HBE 24
HBE 32	HBE 32
HBE 48	HBE 48

### EPIC® HD



**# of Contacts:** 7, 8, 15, 25, 40, 50, 64, 80, 128 (+PE)  
**Rated Voltage:** 600V  
**Rated Current:** 10A

**Termination:** Crimp, , Terminal Block  
**Wire Size:** AWG 22 - 14  
 (0.14 - 2.5 mm<sup>2</sup>)

EPIC® HD: Crimp Terminated									
	7(M)	7(S)	8 (M)	15 (M)	15 (S)	25 (M)	25 (S)	40 (M)	40(S)
Plug	11.2505	11.2500	11.2525	11.2551	11.2550	11.2602	11.2600	11.2652	11.2650
Receptacle	11.2515	11.2510	11.2535	11.2561	11.2560	11.2612	11.2610	11.2662	11.2660
			<b>50 (M) *</b>	<b>50 (S) *</b>	<b>64 (M)</b>	<b>64 (S)</b>	<b>80 (M) *</b>	<b>80 (S) *</b>	<b>128 (M) *</b>
Plug	<b>*2 sets</b>	11.2602	11.2600	11.2720	11.2700	11.2652	11.2650	11.2720	11.2700
Receptacle	<b>*2 sets</b>	11.2612	11.2610	11.2730	11.2710	11.2662	11.2660	11.2730	11.2710

Crimp Terminated- M=Machine, S= Stamped & Formed

#### Mating Housings

Insert:	Housing:
HD 7/8	HA 3/4
HD 15	HA 10
HD 25	HA 16
HD 40	HBE 16
HD 50	HA 32
HD 64	HBE 24
HD 80	HBE 32
HD 128	HBE 48

### EPIC® HEE



**# of Contacts:** 10, 18, 32, 46, 64, 92 (+PE)  
**Rated Voltage:** 600V  
**Rated Current:** 16A  
**Termination:** Crimp  
**Wire Size:** AWG 20 - 12  
 (0.5 - 4.0 mm<sup>2</sup>)

EPIC® HEE: Crimp Terminated			
	10	18	32
Plug	10.1804C0	10.1824C0	10.1844C0
Receptacle	10.1814C0	10.1834C0	10.1854C0
	<b>46</b>	<b>64 *</b>	<b>92*</b>
Plug	10.1864C0	10.1845C0	10.1865C0
Receptacle	10.1874C0	10.1855C0	10.1875C0

\* HEE 64 = HEE 32+64, HEE 92= HEE 46 +92

Mating Housings	
Insert:	Housing:
HEE 10	HBE 6
HEE 18	HBE 10
HEE 32	HBE 16
HEE 46	HBE 24
HEE 64	HBE 32
HEE 92	HBE 48

### EPIC® STA



**# of Contacts:** 6, 14, 20, 40 (+PE)  
**Rated Voltage:** 48V  
**Rated Current:** 10A  
**Termination:** Screw, Solder  
**Wire Size:** AWG 20 - 16  
 (0.5 - 1.5 mm<sup>2</sup>)

EPIC® STA: Screw Terminated			
	6	14	20
Plug	10.4881	10.4931	10.5031
Receptacle	10.4861	10.4911	10.5011

EPIC® STA: Solder Terminated			
	6	14	20
Plug	10.4872	10.4922	10.5022
Receptacle	10.4852	10.4902	10.5002

Mating Housings	
Insert:	Housing:
STA 6	HA 3/4
STA 14	HA 10
STA 20	HA 16
STA 40	HA 32

\* STA 40= 2 X STA 20

Please note that contacts must be purchased for crimp terminated connectors



# EPIC® CONNECTORS

## Rectangular Industrial Connectors: Plugs & Receptacles

### EPIC® HDD



**# of Contacts:** 24, 42, 72, 108, 144, 216, (+PE) **Termination:** Crimp  
**Rated Voltage:** 600V **Wire Size:** AWG 22 - 14  
**Rated Current:** 8.5A (0.14 - 2.5 mm<sup>2</sup>)

EPIC® HDD: Crimp Terminated						
	24	42	72	108	144 *	216 *
Plug	11.2850	11.2851	11.2852	11.2853	11.2854	11.2855
Receptacle	11.2860	11.2861	11.2862	11.2863	11.2864	11.2865

\* HDD 144= HDD 72+HDD 144, HDD 216= HDD 108+HDD 216

Mating Housings	
Insert:	Housing:
HDD 24	HBE 6
HDD 42	HBE 10
HDD 72	HBE 16
HDD 108	HBE 24
HDD 144	HBE 32
HDD 216	HBE 48

### EPIC® HBS

**# of Contacts:** 6, 12 (+PE)  
**Rated Voltage:** 600V  
**Rated Current:** 35A  
**Termination:** Screw  
**Wire Size:** AWG 20 - 10  
 (0.5 - 6.0 mm<sup>2</sup>)



EPIC® HBS		
	6	12 *
Plug	10.1700	10.1706
Receptacle	10.1710	10.1716

\* HBS 12= HBS 6+HBS 12

These inserts have wire protection.

Mating Housings	
Insert:	Housing:
HBS 6	HBE 16
HBS 12	HBE 32

### MIXED POWER

**# of Contacts:** 4 Power/0 Signal, 4 Power/2 Signal, 4 Power/8 Signal  
**Rated Voltage:** 600V  
**Rated Current:** 16 - 80A  
**Termination:** Screw  
**Wire Size:** up to AWG 6 (Power)  
 up to AWG 14 (Signal)



Mixed Power			
	4 P/ 0 S	4 P/ 2 S	4 P/ 8 S
Plug	M.PM400	M.PM402	11.2408
Receptacle	M.PF400	M.PF402	11.1408

P= Power, S=Signal

Mating Housings	
Insert:	Housing:
4P/ 0 S	HBE 16
4P/ 2 S	HBE 16
4P / 8 S	HBE 24

### EPIC® HQ5



**# of Contacts:** 5 (+PE)  
**Rated Voltage:** 600V  
**Rated Current:** 16A  
**Termination:** Crimp  
**Wire Size:** AWG 20 - 14 (0.5 - 2.5 mm<sup>2</sup>)

EPIC® HQ	
	5
Plug	10.4315
Receptacle	10.4325

Mating Housings	
Insert:	Housing:
HQ5	HA 3/4

### EPIC® HBVE

**# of Contacts:** 3, 6, 10 (+PE)  
**Rated Voltage:** 600V  
**Rated Current:** 16A  
**Termination:** Screw  
**Wire Size:** AWG 20 - 14 (0.5 - 2.5 mm<sup>2</sup>)



EPIC® HBVE: Screw Terminated			
	3	6	10
Plug	10.210010	10.239010	10.270010
Receptacle	10.211010	10.240010	10.271010

These inserts have wire protection. Inserts without wire protection are also available.

Mating Housings	
Insert:	Housing:
HBVE 3	HBE 10
HBVE 6	HBE 16
HBVE 10	HBE 24

### EPIC® MC



Note: Color of components may be different than shown.

**# of Contacts:** 2 - 280 (+PE)  
**Rated Voltage:** 63 - 1000V  
**Rated Current:** 10 - 82A  
**Termination:** Crimp/ Coax/ Fiber  
 Optic/ Screw  
**Wire Size:** AWG 30 - 6  
 (0.06 - 10 mm<sup>2</sup>)

Mating Housings	
Frames:	Housing:
2 Modules	HBE 6
3 Modules	HBE 10
5 Modules	HBE 16
7 Modules	HBE 24
10 Modules	HBE 32
14 Modules	HBE 48

EPIC® MC Series	Plug	Receptacle	Rated Voltage	Rated Current
2 Contact Module: 2 Working Contacts	10.344000	10.345000	1000V	82A
2 Contact Module: 1 Working & 1 Ground	10.344500	10.345500	1000V	82A
3 Contact Coax Module	10.3992	10.3993	250V	-
3 Contact Module	10.3820	10.3821	630V	40A
3 Contact High Voltage Module	10.3998	10.3999	1000V	50A
4 Contact Module	10.3990	10.3991	630V	25A
4+PE Contact High Voltage Module	10.3832	10.3833	1000V	16A
5 Contact Module	10.3822	10.3823	400V	20A
10 Contact Module: Stamped & Formed	10.3834	10.3835	250V	10A
10 Contact Module: Machine Crimp	10.3824	10.3825	250V	10A
20 Contact Module	10.3836	10.3837	100V	4A
Dummy Module	10.3994	10.3995	-	-
4 Contact Cage Clamp Module	10.3996	10.3997	400V	14A

Frames	For Plugs	For Receptacles	Frames	For Plugs	For Receptacles
2 modules	10.3810	10.3811	7 modules	10.3816	10.3817
3 modules	10.3812	10.3813	10 modules	10.3814(2X)	10.3815(2X)
5 modules	10.3814	10.3815	14 modules	10.3816(2X)	10.3817(2X)

Please note that contacts must be purchased for crimp terminated connectors

# EPIC® CONNECTORS

## Rectangular Industrial Connectors: Crimp Contacts for Plugs & Receptacles

### MACHINED CONTACTS: DIAMETER 2.5 MM FOR HBE CRIMP SERIES, HEE SERIES, HQ SERIES & MC PART # 10.3990 & 10.3991



Crimp Tool: 11.1470  
Crimp Die: 11.1471  
Locator: 11.1472  
Removal Tool: 11.1825

Part number= 1 contact,  
Sold in bags of 100

mm <sup>2</sup>	AWG	Silver		1 Micron Gold		2 Micron Gold	
		Pin	Socket	Pin	Socket	Pin	Socket
0.5	20	11.1900	11.1950	11.1920	11.1970	11.1940	11.1990
.75 - 1.0	18	11.1901	11.1951	11.1921	11.1971	11.1941	11.1991
1.5	16	11.1902	11.1952	11.1922	11.1972	11.1942	11.1992
2.5	14	11.1903	11.1953	NA	NA	NA	NA
4.0	12	11.1904	11.1954	NA	NA	NA	NA

### MACHINED CONTACTS: DIAMETER 1.6 MM FOR HD MACHINE, HDD SERIES INSERTS & MC PART # 10.3824, 10.3825

mm <sup>2</sup>	AWG	Silver		Gold	
		Pin	Socket	Pin	Socket
0.14 - 0.37	26 - 22	13.1620	13.1630	13.1625	13.1635
0.5	20	13.1621	13.1631	13.1626	13.1636
0.75 - 1.0	18	13.1622	13.1632	13.1627	13.1637
1.5	16	13.1623	13.1633	13.1628	13.1638
2.5	14	13.1624	13.1634	13.1629	13.1639

Crimp Tool: 11.1470  
Crimp Dies: 11.1471  
Locator: 11.1472  
Removal Tool: 11.1610



Part number= 1 contact,  
Sold in bags of 100

### STAMPED & FORMED CONTACTS: DIAMETER 1.6MM FOR HD INSERTS & MC PART # 10.3834 & 10.3835



Crimp Tool: 11.1470  
Removal Tool: 11.1610

	Crimp Dies	Locator:
0.14-0.5:	11.147170	11.1473
0.5 - 1.5:	11.147180	11.1473
1.5 - 2.5:	11.147190	11.147310



Crimp Tool for Reel:  
11.1535  
Crimp Dies for Reel:  
0.14-0.5: 11.1536  
0.5-1.5: 11.1537  
1.5-2.5: 11.1538

Part number= 1 contact (bags) or 1 reel.

mm <sup>2</sup>	AWG	Silver		Gold		Reel of 200	
		Pin	Socket	Pin	Socket	Pin	Socket
0.14 - 0.5	26 - 20	11.2411	11.2311	11.2431	11.2331	11.2407	11.2307
0.5 - 1.5	20 - 16	11.2210	11.2361	11.2213	11.2381	11.2207	11.2357
1.5 - 2.5	16 - 14	11.2235	11.2285	-	-	11.2230	11.2280

Reel of 2000: Right Hand Feed				Left Hand Feed	
mm <sup>2</sup>	AWG	Silver		Silver	
		Pin	Socket	Pin	Socket
0.14 - 0.5	26 - 20	11.2400	11.2300	-	11.2302
0.5 - 1.5	20 - 16	11.2200	11.2350	11.2201	11.2352
1.5 - 2.5	16 - 14	11.2225	11.2275	-	-

### SILVER MACHINED CONTACTS: DIAMETER 3.6 MM FOR MC PART # 10.3820 & 10.3821; 10.3998 & 10.3999

mm <sup>2</sup>	AWG	Pin	Socket
1.5	16	11.2107	11.2157
2.5	14	11.2106	11.2156
4.0	12	11.2100	11.2150
6.0	10	11.2101	11.2151
10	8	11.2102	11.2152

mm<sup>2</sup>: Tool: Die: Locator:  
1.5 - 2.5: 11.1780 11.1786 11.1782  
4.0-10: 11.1470 11.147120 11.147210

Removal Tool: 11.1711



Part number= 1 contact,  
Sold in bags of 100

### STAMPED & FORMED CONTACTS: DIAMETER 2.5 MM FOR MC PART # 10.3832 & 10.3833



Crimp Tool: 11.1470  
Removal Tool: 11.1600

Crimp Dies:  
0.5-1.5: 11.147180  
1.5-2.5: 11.147190  
Locator:  
0.5-1.5: 11.1473  
1.5-5.5: 11.147310

Crimp Tool for Reel:  
11.1535  
Crimp Dies for Reel:  
0.5-1.5: 11.1537  
1.5-2.5: 11.1538

mm <sup>2</sup>	AWG	Silver		Bags of 100		Reels of 200	
		Pin	Socket	Pin	Socket	Pin	Socket
0.5 - 1.5	20 - 16	11.2010	11.2050	11.2080	11.2090		
1.5 - 2.5	16 - 14	11.2020	11.2060	11.2085	11.2095		

### SILVER MACHINED CONTACTS: DIA. 2.5 MM FOR MC PART # 10.3822 & 10.3823



Crimp Tool: 11.1470  
Crimp Die: 11.1471  
Locator: 11.1472

mm <sup>2</sup>	AWG	Pin	Socket
0.5	20	11.2130	11.2180
0.75 - 1.0	18	11.2131	11.2181
1.5	16	11.2132	11.2182
2.5	14	11.2133	11.2183
4.0	12	11.213400	11.2184

Removal Tool: 11.1710

### STAMPED & FORMED CONTACTS: DIA. 1.0 MM FOR MC PART # 10.3836 & 10.3837



Crimp Tool: 11.1584  
Removal Tool: 11.1325

Reel of 300

mm <sup>2</sup>	AWG	Pin	Socket
.08 - 0.2	28 - 25	11.3025	11.3027
0.2 - .52	25 - 20	11.3026	11.3028

### COAX CONTACTS: FOR MC PART # 10.3992 & 10.3993



Crimp Tool: 11.1470  
Crimp Die: 11.147130  
Removal Tool: 11.1711

Pin	Socket	Gauge
11.2142	11.2192	RG 58

### FIBER OPTIC CONTACTS



Assembly Tool Set:  
11.184700

Pin
11.2141
Socket
11.2191



# EPIC® CONNECTORS

## Rectangular Industrial Connectors: Accessories

### TOOLS



### CODING PINS

Coding is used when several connectors are mounted next to one another. This helps prevent incorrect connections.

#### POLARIZING WITH KEY PIN



Insert	Part #	Standard Pack
HBE, HBVE, HA, HD, HDD, HEE, HBS	10.0190	50

- Key Pin
- ⊕ Fixing Screw

#### Key Positions for 1 insert



#### Key Positions for 2 inserts



#### POLARIZING WITH CONTACT LOSS

Insert	Part #	Standard Pack
HD 7/8 Pin	11.1620	100

#### POLARIZING WITH GUIDE PIN & SOCKET



For Screw, Crimp, Cage Clamp Termination

#### Key Positions for 1 insert

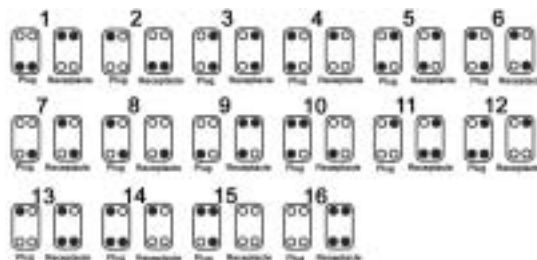

#### Key Positions for 2 inserts



Description	Part #	Standard Pack
Guide pin	11.2800	50
Guide socket	11.2810	50

For HD, HDD, HEE, HBS, HBE, HBVE, or HA Series Inserts

- Guide Pin
- ⊕ Fixing Screw
- Guide Socket

# EPIC® CONNECTORS

## Rectangular Industrial Connectors: HBE Housings

EPIC® HBE Series Rectangular Connectors: Single Lever on Bases

	PG	HBE 6	HBE 10	HBE 16	HBE 24	HBE 48	
<b>Top Entry Hood with Single Lever Bolts</b>	13.5	10.0110	-	-	-	-	
	16	10.0210	10.0409	-	-	-	
	21	-	10.0407	10.0809	10.1219	-	
	29	-	-	10.0909	10.1119	10.1550	
	36	-	-	-	-	10.1560	
	42	-	-	-	-	10.1570	
<b>Top Entry High Profile Hood with Single Lever Bolts</b>	21	70.0202	70.0442	70.0942	70.1444	-	
	29	70.0204	70.0444	70.0944	70.1446	-	
<b>Side Entry Hood with Single Lever Bolts</b>	13.5	10.0120	-	-	-	-	
	16	10.0220	10.0429	-	-	-	
	21	-	10.0428	10.0829	10.1139	-	
	29	-	-	10.0929	10.1239	10.1580	
	36	-	-	-	-	10.1590	
42	-	-	-	-	10.1600		
<b>Side Entry High Profile Hood with Single Lever Bolts</b>	21	70.0222	70.0542	70.1042	70.1544	-	
	29	70.0224	70.0544	70.1044	70.1546	-	
<b>Panel Mount Base with Single Lever</b>							
	Without dust cover	-	10.0030	10.0329	10.0729	10.1029	10.1610
	With dust cover	-	10.0040	10.0339	10.0739	10.1039	10.1525
With dust cover and no dust cover bolts	-	-	-	-	-	10.1520	
<b>Surface Mount Base with Single Lever</b>	2 Entries	16	10.0060	10.0359	-	-	-
	1 Entry	16	10.0050	10.0349	-	-	-
	2 Entries with dust cover	16	10.0090	10.0389	-	-	-
	1 Entry with dust cover	16	10.0070	10.0369	-	-	-
	2 Entries	21	-	-	10.0759	10.1059	-
	1 Entry	21	-	10.0347	10.0749	10.1049	-
	2 Entries with dust cover	21	-	-	10.0789	10.1099	-
	1 Entry with dust cover	21	-	-	10.0769	10.1079	-
<b>High Profile Surface Mount Base</b>	2 Entries	21	70.0062	70.0612	70.1112	70.1612	-
	1 Entry	21	70.0052	70.0602	70.1102	70.1602	-
	2 Entries with dust cover	21	70.0162	70.0652	70.1152	70.1652	-
	1 Entry with dust cover	21	70.0152	70.0642	70.1142	70.1642	-
	2 Entries	29	70.0064	70.0614	70.1114	70.1614	10.1660
	1 Entry	29	70.0054	70.0604	70.1104	70.1604	10.1650
	2 Entries with dust cover	29	70.0164	70.0654	70.1154	70.1654	10.1680
	1 Entry with dust cover	29	70.0154	70.0644	70.1144	70.1644	10.1670
	2 Entries	36	-	-	-	-	10.1661
	1 Entry	36	-	-	-	-	10.1651
	2 Entries with dust cover	36	-	-	-	-	10.1681
	1 Entry with dust cover	36	-	-	-	-	10.1671
	<b>Cable Coupler Hood with Single Lever</b>	13.5	10.0140	-	-	-	-
16		10.0240	10.0469	-	-	-	
21		-	70.0422	10.0869	10.1279	-	
29		-	-	10.0969	10.1179	-	
<b>High Profile Cable Coupler Hood with Single Lever</b>	21	70.0102	70.0424	70.0922	70.1424	-	
	29	70.0104	70.0426	70.0924	70.1426	-	

For NPT Parts add a space and NP at the end of the part number. Ex. 10.0110 would be 10.0110 NP  
Metric and Environmentally Protected parts are also available

Please note that the housings are grouped together by mating components.  
Choose One: Top or Side Entry and then  
Choose One: Panel or Surface Mount Base or Cable Coupler Hood

# EPIC® CONNECTORS

## Rectangular Industrial Connectors: HBE Housings

EPIC® HBE Series Rectangular Connectors: Double Levers on Bases					
	PG	HBE 10	HBE 16	HBE 24	HBE 32
Top Entry Hood with Double Lever Bolts	16	10.0400	-	-	-
	21	10.0401	10.0800	10.1210	-
	29	-	10.0900	10.1110	10.1340
	36	-	-	-	-
High Profile Top Entry Hood with Bolts	21	70.0504	70.1002	70.1504	-
	29	70.0506	70.1004	70.1506	-
Side Entry Hood with Double Lever Bolts	16	10.0420	10.0820	10.1130	-
	21	10.0421	10.0920	10.1230	10.1350
	29	-	-	-	10.1360
High Profile Side Entry Hood with Double Lever Bolts	21	70.0524	70.1022	70.1524	-
	29	70.0526	70.1024	70.1526	-
Panel Mount Base with Double Levers	-	10.0320	10.0720	10.1020	10.1320
Surface Mount Base with Double Levers					
2 Entries	16	10.0350	-	-	-
1 Entry	16	10.0340	-	-	-
2 Entries	21	-	10.0750	10.1050	-
1 Entry	21	-	10.0740	10.1040	-
2 Entries	29	-	-	-	10.1380
1 Entry	29	-	-	-	10.1370
High Profile Surface Mount Bases	21	70.0362	70.0862	70.1362	-
	21	70.0352	70.0852	70.1352	-
	29	70.0364	70.0864	70.1364	-
	29	70.0354	70.0854	70.1354	-
Cable Coupler Hood with Double Levers	16	10.0460	-	-	-
	21	70.0402	10.0860	10.1270	10.1390
	29	-	10.0960	10.1170	10.1395
High Profile Cable Coupler Hood with Double Levers	16	-	-	-	-
	21	70.0404	70.0902	70.1404	-
	29	70.0406	70.0904	70.1406	-



For NPT Parts add a space and NP at the end of the part number.  
Metric and Environmentally Protected parts are also available



EPIC® HBE Series Rectangular Connectors: Double Levers on Hoods					
	PG	HBE 10	HBE 16	HBE 24	HBE 32
Top Entry Hood with Double Levers	16	10.0410	-	-	-
	21	-	10.0810	10.1220	-
	29	-	10.0910	10.1120	-
High Profile Top Entry Hood with Double Levers	21	70.0552	70.1052	70.1554	-
	29	70.0554	70.1054	70.1556	70.2050
Side Entry Hood with Double Levers	16	10.0450	-	-	-
	21	-	10.0830	10.1140	-
	29	-	10.0930	10.1240	-
High Profile Side Entry Hood with Double Levers	21	70.0572	70.1072	70.1574	-
	29	70.0574	70.1074	70.1576	10.1366
Panel Mount Base with Dust Cover	-	10.0330	10.0730	10.1030	-
Panel Mount Base without Dust Cover	-	-	10.0731	10.1031	10.1323
Surface Mount Base with Double Lever Bolts					
2 Entries with Dust Cover	16	10.0380	-	-	-
1 Entry with Dust Cover	16	10.0360	-	-	-
2 Entries	21	-	70.0960	10.1090	-
1 Entry	21	-	10.0760	10.1070	-
High Profile Surface Mount Bases	21	70.0462	70.0962	70.1462	-
	21	70.0452	70.0952	70.1452	-
	29	70.0464	70.0964	70.1464	-
	29	70.0454	70.0954	70.1454	10.1373

For NPT Parts add a space and NP at the end of the part number.  
Metric and Environmentally Protected parts are also available

# EPIC® CONNECTORS

## Rectangular Industrial Connectors: HA Housings

### EPIC® HA 3/4 Series Rectangular Connectors: Single Lever on Bases

Material	PG	HOODS				SURFACE MOUNT BASE & CABLE COUPLER HOODS				PANEL MOUNT BASE	
		Without Cable Gland		With Cable Gland		Without Cable Gland		With Cable Gland		STANDARD	ANGLED
		TOP	SIDE	TOP	SIDE	BASE	COUPLER	BASE	COUPLER		
Zinc Die Cast	11	10.5121 NP	10.5123 NP	10.4265	10.4275	10.5127 NP	10.5129 NP	10.4245	10.4295	10.4225	10.4235
Black Plastic	11	10.4255 NP	10.4273 NP	10.4267	10.6206	10.5117 NP	10.4292 NP	10.4247	10.6203	10.4222	10.4231
Grey Plastic	11	10.4260 NP	10.4270 NP	10.4264	10.4271	10.4240 NP	10.4290 NP	10.4242	10.4291	10.4220	10.4230



### EPIC® HA Series Rectangular Connectors: Double Levers on Bases

	PG	HA 32	HA 48
Top Entry Hood with Double Lever Bolts	21	10.5820	-
	29	10.5830	10.6318
Side Entry Hood with Double Lever Bolts	21	10.5760	-
	29	10.5770	10.6308
Panel Mount Base with Double Levers	-	10.4720	10.6255
Surface Mount Bases with Double Levers			
1 Entry with Dust Cover	21	10.4740	-
2 Entries with Dust Cover	21	10.4820	-
1 Entry with Dust Cover	29	10.4741	10.6338
2 Entries with Dust Cover	29	10.4821	10.6348
Cable Coupler with Double Levers	21	10.5880	-
	29	10.5885	-

### EPIC® HA Series Rectangular Connectors: Double Levers on Hoods

	PG	HA 32
Top Entry Hood with Double Levers	21	10.5840
	29	10.5850
Side Entry Hood with Double Levers	21	10.5780
	29	10.5790
Panel Mount Base with Cover	--	70.5030
Panel Mount Base without Cover	--	10.4731
Surface Mount Base with Bolts		
1 Entry with Dust Cover	21	70.5152
2 Entries with Dust Cover	21	70.5162
1 Entry with Dust Cover	29	70.5154
2 Entries with Dust Cover	29	70.5164

### EPIC® HA Series Rectangular Connectors: Single Lever on Bases

	PG	HA 10 Standard *	HA 10 High Profile	HA 16 Standard *	HA 16 High Profile	HA 64
Top Entry Hood with Single Lever Bolts	13.5	10.446010	--	--	--	--
	16	10.446110	70.4602	10.565010	70.4902	--
	21	--	70.4604	10.565210	70.4904	--
	29	--	--	--	--	10.1550-HA
	36	--	--	--	--	10.1560-HA
	48	--	--	--	--	10.1570-HA
Side Entry Hood with Single Lever Bolts	16	10.445010	70.4622	10.564010	70.4922	--
	21	10.445510	70.4624	10.564510	70.4924	--
	29	--	--	--	--	10.1580-HA
	36	--	--	--	--	10.1590-HA
	42	--	--	--	--	10.1600-HA

	PG	HA 10 Without Cover	HA 10 With Cover	HA 16 Without Cover	HA 16 With Cover	HA 64 Without Cover	HA 64 With Cover
Panel Mount Base with Single Lever with Dust Cover and no bolts on cover	--	10.4420	70.4440	10.4620	70.4740	10.1610-HA	10.1525-HA
	--	--	--	--	--	--	10.1520-HA
Surface Mount Base with Single Lever						--	--
1 Entry	16	10.4481	70.4552	10.5671	70.4852	--	--
2 Entries	16	10.4501	70.4562	10.5681	70.4862	--	--
1 Entry	21	10.4480	70.4554	10.5670	70.4854	--	--
2 Entries	21	10.4500	70.4564	10.5680	70.4864	--	--
1 Entry	29	--	--	--	--	10.1650-HA	10.1670-HA
2 Entries	29	--	--	--	--	10.1660-HA	10.1680-HA
1 Entry	36	--	--	--	--	10.1651-HA	10.1671-HA
2 Entries	36	--	--	--	--	10.1661-HA	10.1681-HA
Cable Coupler Hood with Single Lever		Standard	High Profile	Standard	High Profile		
	13.5	10.4390	--	--	--	--	--
	16	70.4500	--	10.5630	70.4802	--	--
	21	--	70.4504	--	70.4804	--	--

For NPT Parts add a space and NP at the end of the part number. Metric and Environmentally Protected parts are also available.  
\* For NPT parts drop last 2 digits before adding the space NP. Ex 10.446010 would be 10.4460 NP

# EPIC® CONNECTORS

## Rectangular Industrial Connectors: Dust Covers

Protective covers made of impact resistant plastic which provide effective protection against environmental influences. Inserts are easily protected when they are not in use.

**Material:**  
**Temperature:**

Thermoplastic Resin/ Aluminum  
-40°C - 125°C

HA Series  
Dust Covers



HBE Series Dust  
Covers

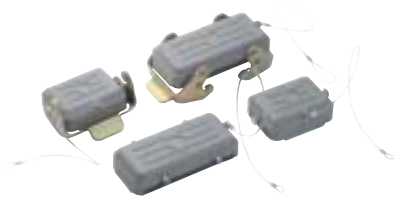

### HA 3/4 DUST COVERS

Description:	Plastic Part # with String	Metal Part # with string	Part # without string
Dust cover for HA 3/4 Bases and Cable Coupler Hoods with Male Insert	10.4304	10.5130	10.4300
Dust cover for HA 3/4 Bases and Cable Coupler Hoods with Female Insert (includes gasket)	10.4301	10.5131	10.4303

### HA 10, 16, & 32 DUST COVERS

Description:	HA 10 Part # with string	HA 10 Part # without string	HA 16 Part # with string	HA 16 Part # without string	HA 32 Part # with string	HA 32 Part # without string
Dust cover for HA Panel Mount/ Surface Mount/ Cable Coupler hoods (includes gasket)	10.4575	10.4577	10.4695	10.4697	10.4815	10.4817
Dust cover for HA Hoods	10.4576	10.4578	10.4696	10.4698	10.4816	10.4818

### HBE DUST COVERS WITH ATTACHMENT STRING

Description:	HBE 6 Part #	HBE 10 Part #:
Dust cover with single lever for HBE Hoods with bolts	10.0165	10.0486
Dust cover with single lever bolts for HBE Panel Mount or Surface Mount Base/ Cable Coupler Hood	10.0150	10.0487
Dust cover with double levers and gasket for HBE Hoods with bolts	-	10.0485
Dust cover with double lever bolts for HBE 10 Panel Mount or Surface Mount Base/ Cable Coupler Hood	-	10.0470
Dust cover with double lever bolts and gasket for HBE Hoods with levers	-	10.0471

Description:	HBE 16 Part #:	HBE 24 Part #:
Dust cover with single lever for HBE Hoods with bolts	10.0886	10.1186
Dust cover with single lever bolts for HBE Panel Mount or Surface Mount Base/ Cable Coupler Hood	10.0887	10.1187
Dust cover with double levers and gasket for HBE Hoods with bolts	10.0885	10.1195
Dust cover with double lever bolts for HBE Panel Mount or Surface Mount Base/ Cable Coupler Hood	10.0870	10.1180
Dust cover with double lever bolts and gasket for HBE Hoods with levers	10.0871	10.1181

Description:	HBE 32 Part #
Dust cover with double lever bolts for HBE 32 Panel Mount or Surface Mount Base/ Cable Coupler Hood	10.1420

Dust Cover with Bolts

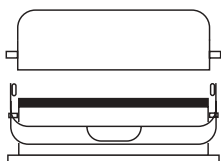

Base with gasket

Dust Cover with Lever & Gasket

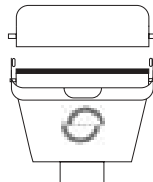

Cable Coupler with gasket



Hood with bolts

Dust Cover with Bolts & Gasket

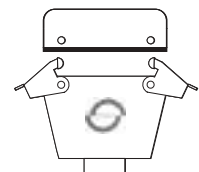

Hood with levers



# EPIC® CONNECTORS

## Rectangular Industrial Connectors: Dimensional Data

### HA 3/4

Top Entry Hood with Single Lever Bolts

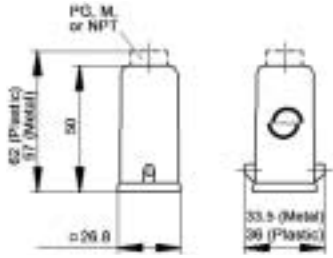

Side Entry Hood with Single Lever Bolts

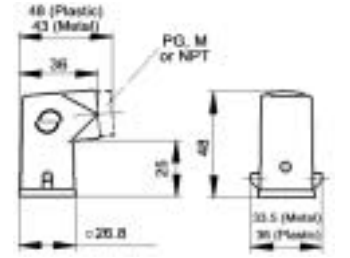

Panel Mount Base with Single Lever

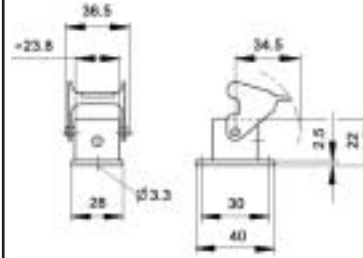

Angled Panel Mount Base with Single Lever

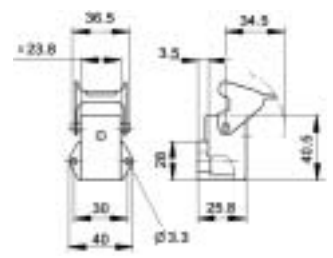

### HA 3/4

Surface Base with Single Lever

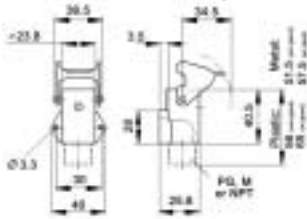

Top/ Side Entry Hood with Single Lever Bolts

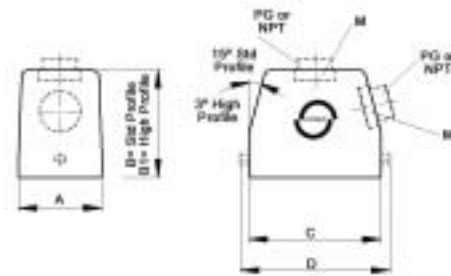

Cable Coupler Hood with Single Lever

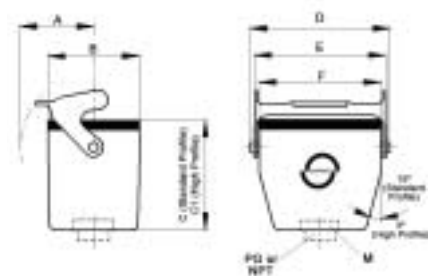

Cable Coupler Hood with Single Lever

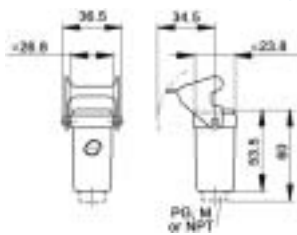

Series	A	B	B1	C	D
HA 10	29.5	53.3	67.3	63	73
HA 16	29.5	58.3	72.3	79	89
HBE 6	43	52	72	60	74.8
HBE 10	43	52	72	73	90
HBE 16	43	61	76	93.3	110
HBE 24	43	61	76	120	137
HBE 48	90	105	-	132	152

Series	A	B	C	C1	D	E	F
HA 10	36.5	29.5	48	62	74.4	71.4	63
HA 16	36.5	29.5	53	67	90.4	87.8	79
HBE 6	44	43	54.8	74.8	74.8	70	60
HBE 10	50	43	54.8	74.8	91	88.5	73
HBE 16	50	43	63.5	78.8	111	109.5	93.3
HBE 24	50	43	63.8	78.8	138	136.5	120

Panel Mount Base with Single Lever

Series	A	B	C	D	E	F	G	H	I	J	K	L	M
HA 10	36.5	17.5	29.5	25	25	42	74.4	71.4	63	70	81	3.5	3.6
HA 16	36.5	17.5	29.5	25	25	42	90.4	87.5	79	86	96	3.5	3.6
HBE 6	44	32	43	25	27.8	44.8	74.8	70	60	70	80	4	4.3
HBE 10	50	32	43	25	27.8	44.8	91	88.5	73	83	93	4	4.3
HBE 16	50	32	43	25	27.8	44.8	111	109.5	93.3	103	113	4	4.3
HBE 24	50	32	43	25	27.8	44.8	138	136.5	120	130	140	4	4.3
HBE 48	105	70	90	30	39.5	56.5	152	139.5	132	148	165	10	7

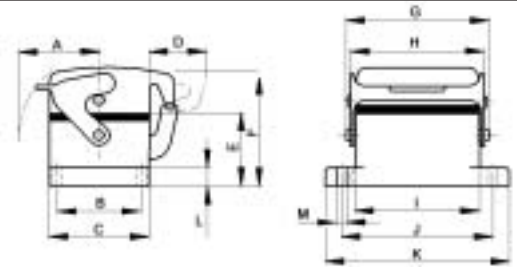

Surface Base with Single Lever

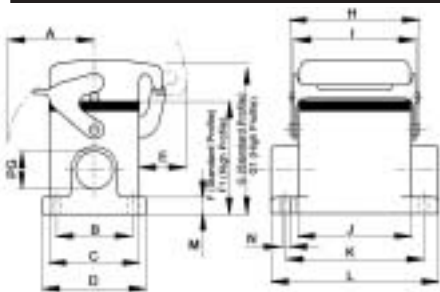

Series	A	B	C	D	E	F	F1	G	G1	H	I	J	K	L	M	N
HA 10	36.5	40	29.5	50	25	57	-	74	-	74.4	71.4	63	48	80	3.5	4.5
HA 16	36.5	40	29.5	50	25	57	-	74	-	90.4	87.8	79	64	96	3.5	4.5
HBE 6	44	40	43	52	25	54	74	71	91	74.8	70	60	70	84	4.5/6	5.5
HBE 10	50	40	43	52	25	57	74	74	91	91	88.5	73	82	94	4.5/6	5.5
HBE 16	50	45	43	57	25	64	84	81	101	111	109.5	93	105	117	4.5/6	5.5
HBE 24	50	45	43	57	25	64	84	81	101	138	136.5	120	132	144	4.5/6	5.5
HBE 48	105	106	90	120	30	100	-	117	-	152	139.5	132	111	132	12	6.5

\*M dimension (standard profile/high profile)

### Notes:

- All dimensions are in mm.
- HA 64 & HBE 48 dimensions are the same.
- Panel mount base cut-outs are on page 2.
- Additional information is available on our website.

Top/ Side Entry Hood with Double Lever Bolts

Series	A	B	C	C1	D	E
HA 32	56	67.8	75	-	49.6	82
HA 48	79	89.5	95	-	64.5	93.5
HBE 10	43	55	52	72	27	73
HBE 16	43	55	61	76	47.5	93.3
HBE 24	43	55	61	76	74	120
HBE 32	79	89.5	95	-	64.5	93.5

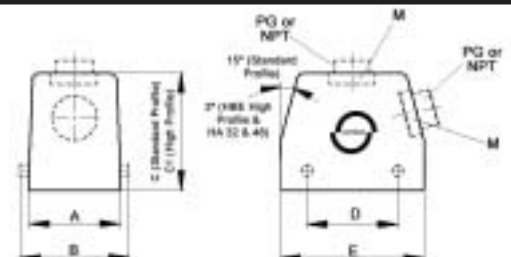

# EPIC® CONNECTORS

## Rectangular Industrial Connectors: Dimensional Data

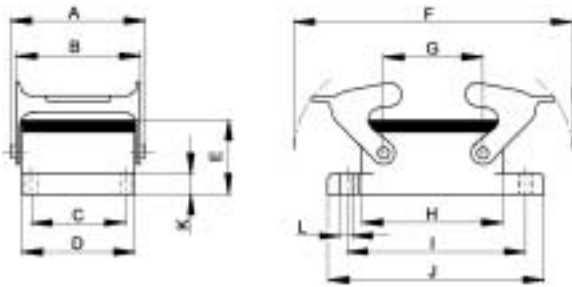

Panel Mount Base with Double Levers

Series	A	B	C	D	E	F	G	H	I	J	K	L
HA 32	67.8	66	42	56	25.4	124.5	49.6	82	92	102	4	4.3
HA 48	93.8	87.8	65	79	30.3	136.5	64.5	93.5	110	124	5	5.5
HBE 10	55	53	32	43	27.8	116	27	73	83	93	4	4.3
HBE 16	55	53	32	43	27.8	136.5	47.5	93.3	103	113	4	4.3
HBE 24	55	53	32	43	27.8	163	74	120	130	140	4	4.3
HBE 32	93.8	87.8	65	79	30.3	136.5	64.5	93.5	110	124	5	5.5

Surface Mount Base with Double Levers

Series	A	B	C	D	E	F	F1	G	H	I	J	K	L
HA 32	67.8	66	46	56	57	75	-	124.5	49.6	82	94	106	4
HA 48	93.8	87.8	67	79	81	72	-	136.5	64.5	82	94	106	5
HBE 10	55	53	40	43	54	57	74	116	27	73	82	94	4.5/6
HBE 16	55	53	45	43	57	64	84	136.5	47.5	93	105	117	4.5/6
HBE 24	55	53	45	43	57	64	84	163	74	120	132	144	4.5/6
HBE 32	93.8	87.8	67	79	81	72	-	136.5	64.5	93.5	112	124.5	5

\*L dimension (standard profile/high profile)

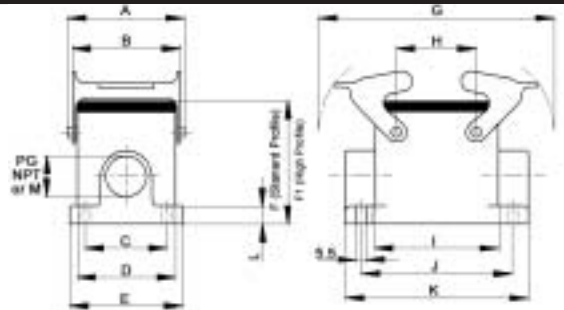

Cable Coupler Hood with Double Levers

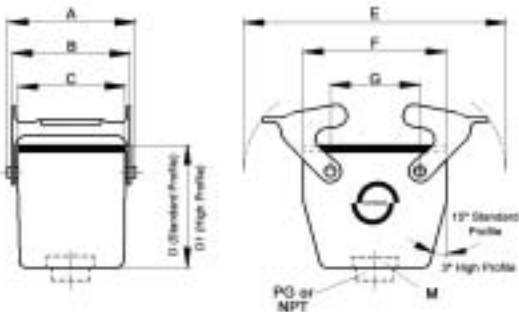

Series	A	B	C	D	D1	E	F	G
HA 32	67.8	66	56	76.5	-	124.5	82	49.6
HBE 10	55	53	43	54.8	74.8	116	73	27
HBE 16	55	53	43	63.6	78.8	136.5	93.3	47.5
HBE 24	55	53	43	63.8	78.8	163	120	74
HBE 32	93.8	87.8	79	97	-	136.5	93.5	64.5

Top/ Side Entry Hood with Double Lever Bolts

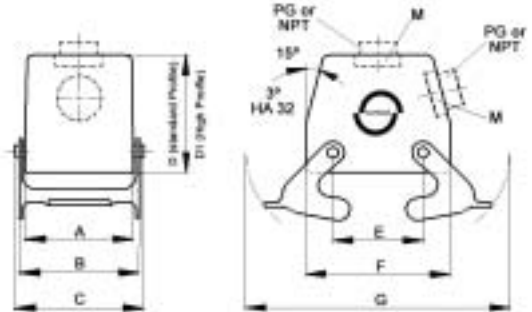

Series	A	B	C	D	D1	E	F	G
HA 32	56	66	67.8	75	-	49.6	82	124.5
HBE 10	43	53	55	52	72	27	73	116
HBE 16	43	53	55	61	76	47.5	93.3	136.5
HBE 24	43	53	55	61	76	74	120	163
HBE 32	79	87.8	93.8	95	-	64.5	93.5	136.5

Panel Mount Base with Double Lever Bolts

Series	A	B	C	D	E	F	G	H	I	J	K	L
HA 32	42	56	70.8	29	25.4	42.4	49.6	82	92	102	4	4.3
HBE 10	32	43	55	25	27.8	44.8	27	73	83	93	4	4.3
HBE 16	32	43	55	25	27.8	44.8	47.5	93.3	103	113	4.5/6	5.5
HBE 24	32	43	55	25	27.8	44.8	74	120	130	140	4	4.3
HBE 32	65	79	89.5	-	30.3	-	64.5	93.5	110	124	5	4.3

\*K dimension (standard profile/high profile)

Surface Mount Base with Double Lever Bolts

Series	A	B	C	D	E	F	F1	G	G1	H	I	J	K	L
HA 32	70.8	46	56	57	29	75	-	92	-	49.6	82	94	106	4
HBE 10	55	43	40	54	25	57	74	74	91	27	73	82	94	4.5/6
HBE 16	55	45	43	57	25	64	84	81	101	47.5	93*	105	117	4.5/6
HBE 24	55	45	43	57	25	64	84	81	101	74	120	132	144	4.5/6
HBE 32	89.5	67	79	81	-	72	-	-	-	64.5	93.5	112	124.5	5

\*L dimension (standard profile/high profile)

\*\* I dimension for HBE 24 High Profile is 93.3.

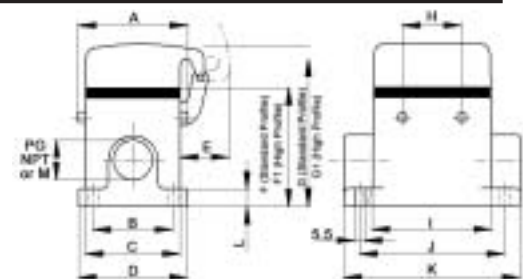

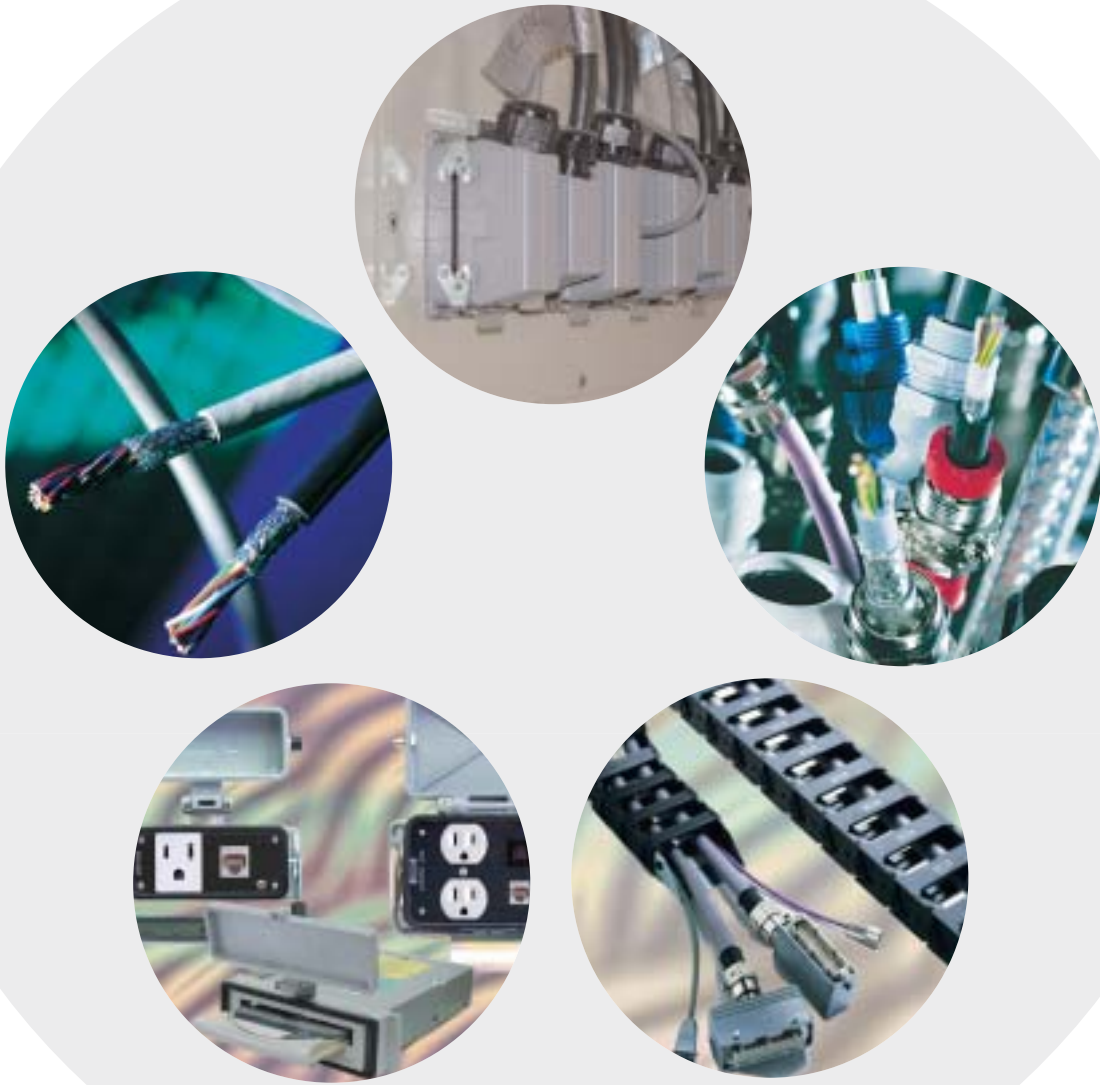

# LAPP USA

29 Hanover Road  
Florham Park, NJ 07932

Tel: 800-774-3539  
Fax: 973-660-9330

[www.lappusa.com](http://www.lappusa.com)  
[sales@lappusa.com](mailto:sales@lappusa.com)

**Lapp Canada**  
250 Chrysler Drive  
Unit 6  
Brampton, Ontario L6S 6B6  
Tel: 905-799-3636  
Fax: 905-799-4710

[www.lappcanada.com](http://www.lappcanada.com)  
[info@lappcanada.com](mailto:info@lappcanada.com)

**Lapp Mexico**  
Metalurgia 2730  
Alamo Industrial, C.P. 44490  
Tlaquepaque, Jalisco  
Tel: 52 (3) 666-0250  
Fax: 52 (3) 666-0075

[www.lappmexico.com](http://www.lappmexico.com)  
[ventas@lappmexico.com](mailto:ventas@lappmexico.com)