

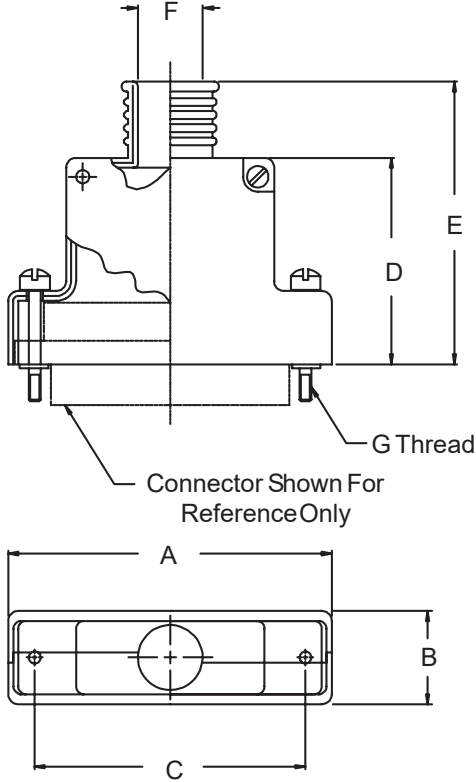

# 507-145 EMI/RFI Split Micro-D Banding Backshell



HOW TO ORDER				
Basic Part Number	Shell Plating *	Shell Size (Table I)	Hardware Options *	Band Option
507-145	C - Black Anodize	09	Omit for (2) male fillister head	B
	E - Chem. Film	15		
	J - Gold Iridite Over	21	E - (2) extended jackscrew	600-057 Band Supplied - (Omit if Not Required)
	Cadmium Over	25		
	Electroless Nickel	31		
	M - Electroless Nickel	37	H - (2) male hex socket	
	NF - Cadmium, Olive Drab Over Electroless Nickel	51	F - (2) female jackpost	
Z2 - Gold	100			
<b>Sample Part Number:</b>				
507-145	M	21	H	B

\* SEE PAGE C-4 FOR COMPLETE INFORMATION

TABLE I: DIMENSIONS

SHELL SIZE	A Max	B Max	C ±.005 (0.1)	D ±.010 (0.3)	E ±.020 (.5)	F ±.005 (0.1)	G THREAD
09	.915 (23.2)	.450 (11.4)	.565 (14.4)	.656 (16.7)	.968 (24.6)	.160 (4.1)	2-56 UNC-2
15	1.065 (27.1)	.450 (11.4)	.715 (18.2)	.718 (18.2)	1.031 (26.2)	.190 (4.8)	2-56 UNC-2
21	1.215 (30.9)	.450 (11.4)	.865 (22.0)	.750 (19.1)	1.062 (27.0)	.220 (5.6)	2-56 UNC-2
25	1.315 (33.4)	.450 (11.4)	.965 (24.5)	.812 (20.6)	1.125 (28.6)	.260 (6.6)	2-56 UNC-2
31	1.465 (37.2)	.450 (11.4)	1.115 (28.3)	.843 (21.4)	1.156 (29.4)	.275 (7.0)	2-56 UNC-2
37	1.615 (41.0)	.450 (11.4)	1.265 (32.1)	.906 (23.0)	1.218 (30.9)	.285 (7.2)	2-56 UNC-2
51	1.565 (39.8)	.495 (12.6)	1.215 (30.9)	.968 (24.6)	1.281 (32.5)	.350 (8.9)	2-56 UNC-2
100	2.305 (58.5)	.540 (13.7)	1.800 (45.7)	1.031 (26.2)	1.343 (34.1)	.490 (12.4)	4-40 UNC-2

Metric dimensions (mm) are indicated in parentheses.

# Mouser Electronics

Authorized Distributor

Click to View Pricing, Inventory, Delivery & Lifecycle Information:

## Glenair:

[507-145C37E](#) [507-145M09](#) [507-145M09E](#) [507-145M09HB](#) [507-145M21B](#) [507-145M25EB](#) [507-145M25HB](#) [507-145M31](#) [507-145M31HB](#) [507-145M37E](#) [507-145M37EB](#) [507-145M51HB](#) [507-145NF25EB](#) [507-145NF51EB](#) [507-145M25FB](#) [507-145M31EB](#) [507-145NF09EB](#) [507-145M15-58-9](#) [507-145M09H](#) [507-145M100H](#) [507-145M25H](#) [507-145M37H](#) [507-145M51H](#) [507-145M09B](#) [507-145M37B](#) [507-145M37HB](#) [507-145M21H](#) [507-145M51B](#) [507-145J100E](#) [507-145M09-58-9](#) [507-145M09F](#) [507-145M100E](#) [507-145M15](#) [507-145M15HB](#) [507-145M25-58-9](#) [507-145M31-58-9](#) [507-145MT37](#) [507-145M15FB](#) [507-145M25HK](#) [507-145M21E](#) [507-145M100EB](#) [507-145M51E](#) [507-145M37](#) [507-145M15EB](#) [507-145M15B](#) [507-145M15E](#) [507-145NF09E](#) [507-145M31E](#) [507-145M31HK](#) [507-145NF15E](#) [507-145M25](#) [507-145M15H](#) [507-145M31H](#)