

# Connector

## SMA 50 Ω, straight



### FEATURES:

- Crimp Ferrule - Brass, Gold-plated
- Gasket – Silicone, Red
- Washer - Stainless Steel

### SPECIFICATION:

Housing Material	Brass (CuZn)/Gold-plated
Series	SMA
Center contact	Male
Insulation material	Teflon
Impedance	50 Ω
Connector Design	straight
Cable type	RG-142U
Contacts	gold-plated

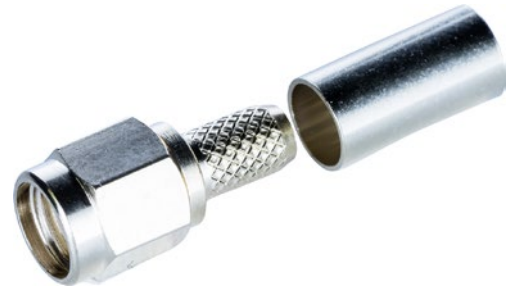

### Art. Nr.

**RND 205-00491**

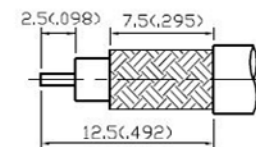
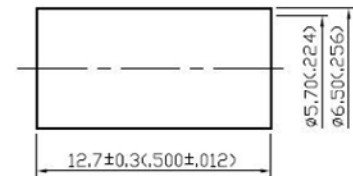
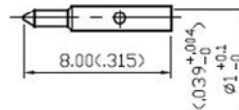
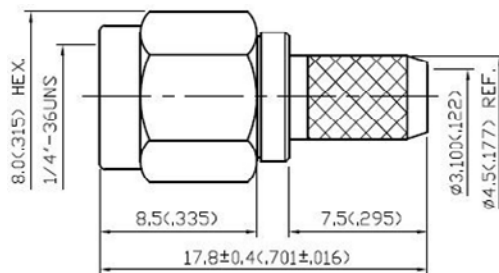

STRIPPING DIMENSION  
SCALE 3:1