

THIS DRAWING IS UNPUBLISHED.

RELEASED FOR PUBLICATION

© COPYRIGHT

ALL RIGHTS RESERVED.

LOC DIST

REVISIONS

P	LTR	DESCRIPTION	DATE	DWN	APVD
		AB6 REVISED PER ECO-11-005140	01APR11	RK	HMR

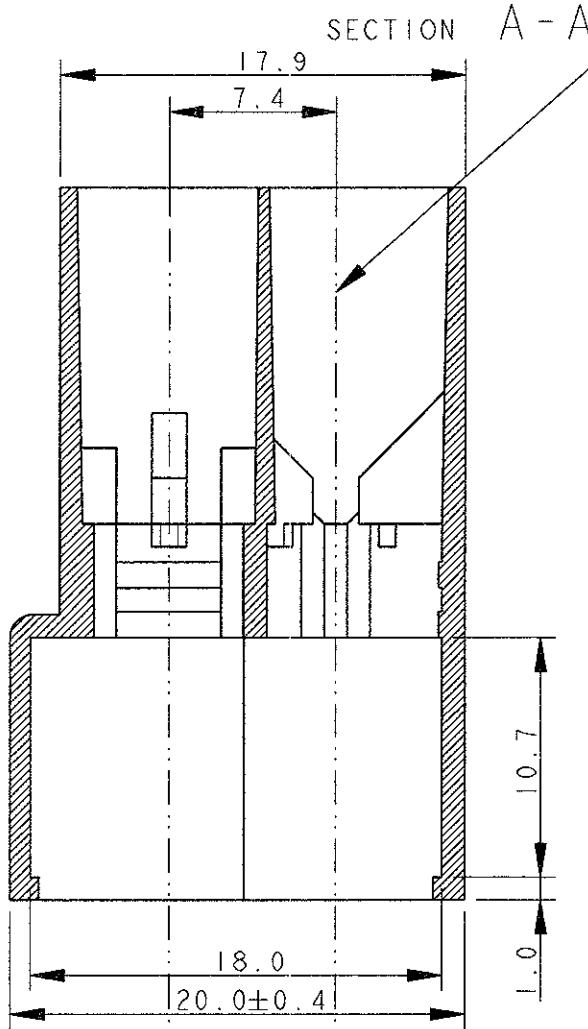
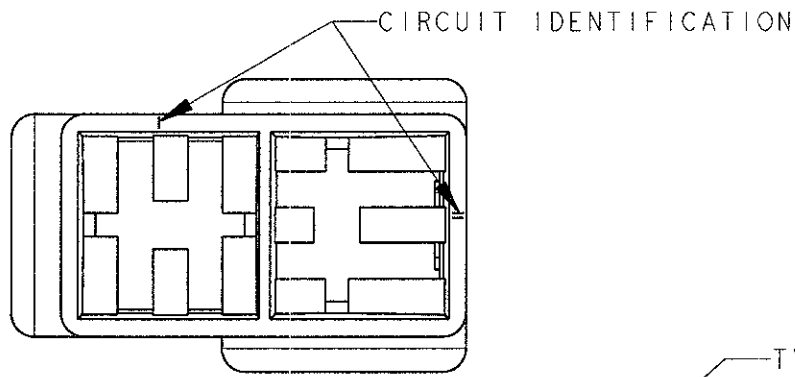

TYPICAL CAVITY FOR FASTIN-FASTON CONN. .250" SR. TAB CTC

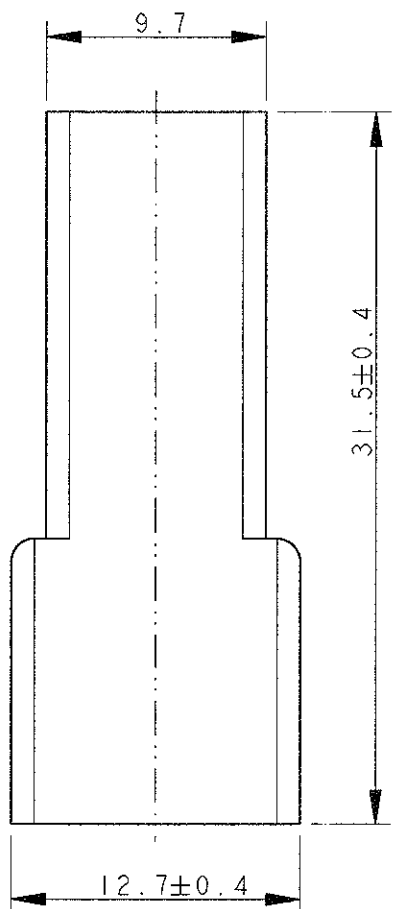

ALTERNATIVE SHAPE : ACCEPTED ONE RETENTION RIB FOR THE TOTAL LENGTH OF THE HSG.

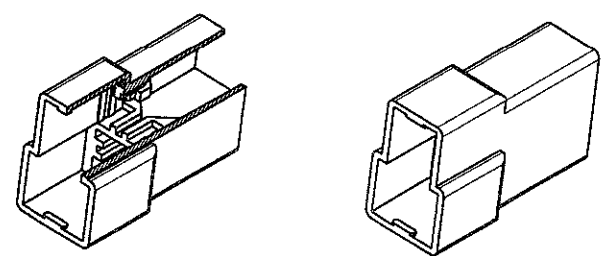

SCALE 1:1

2 OBSOLETE PARTS: OBSOLETE CIS STREAMLINING PER D.RENAUD/D.SINISI

2 OBSOLETE

OBSOLETE

NOTES	COLOUR	MATERIAL	PART NUMBER	REV
	BLACK	POLYAMIDE 6.6	0-180908-5	AB
	YELLOW		0-180908-4	AB
	BLUE		0-180908-3	AB
	GREEN		0-180908-2	AB
	RED		0-180908-1	AB
	NATURAL	NYLON 606 ZYTEL 101L	0-180908-0	AB
UL APPROVED	BLACK		1-180908-5	O
	YELLOW		1-180908-4	AB
	GREEN		1-180908-2	AB
	NATURAL		1-180908-0	AB

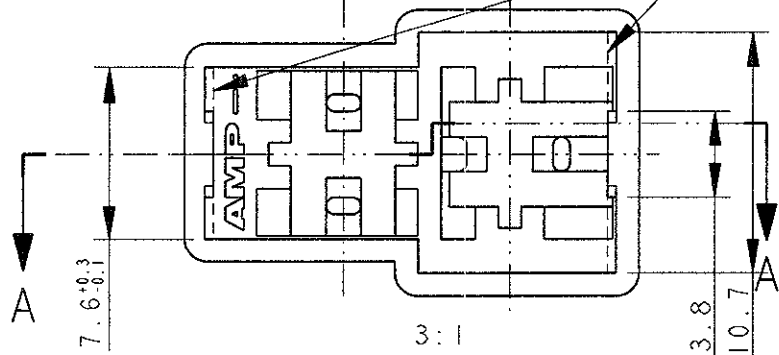

DWN H. YAALI 08JUL2002		TE Connectivity	
CHK C. TARTARI			
APVD -		NAME	
PRODUCT SPEC 108-20020		FASTIN-FASTON* Connector, .250" sr. TAB HOUSING 2 WAY	
APPLICATION SPEC -		SIZE	RESTRICTED TO
MATERIAL SEE TABLE		CAGE CODE	
TOLERANCES UNLESS OTHERWISE SPECIFIED:		DRAWING NO	
0 PLC ±-		WEIGHT	
1 PLC ±0.3		2.3 g	
2 PLC ±-		A3	
3 PLC ±-		00779	
4 PLC ±-		C-180908	
ANGLES ±2°		SCALE 3:1	
FINISH SEE TABLE		SHEET 1 OF 1	
CUSTOMER DRAWING		REV AB6	

Mouser Electronics

Authorized Distributor

Click to View Pricing, Inventory, Delivery & Lifecycle Information:

[TE Connectivity:](#)

[180908](#)