

D-SUB STANDARD

Solder pin – Angled – .318" / 7.19 mm – Precision machined contacts – Plastic bracket

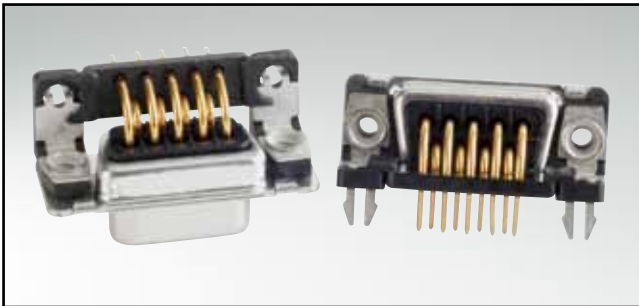

RoHS compliant – CSA listed, File No.: LR 115000-1 – UL listed, File No.: E202784

DESCRIPTION

- Mounting styles:
 - with mounting bracket, PCB clip and 4-40 UNC or M3 threaded insert
 - with mounting bracket, PCB clip and 4-40 UNC or M3 front spacer
- Quality class 3 (also available in quality class 1)
- Shell: Steel tin plated (brass tin plated or stainless steel available on request)

SOCKET CONNECTOR

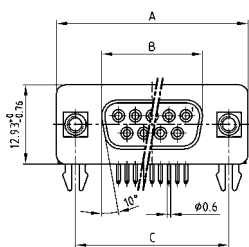

| No. of pos. | A -0.76 | B -0.25 | C |
|-------------|---------|---------|-------------------|
| 09 | 31.19 | 16.46 | 25.00 ±0.12 |
| 15 | 39.52 | 24.79 | 33.30 ±0.15 ±0.10 |
| 25 | 53.42 | 38.50 | 47.04 ±0.13 |
| 37 | 69.70 | 54.96 | 63.50 ±0.13 |

PCB layout: Kat1kGEA

Mounting style: PCB clip, threaded insert

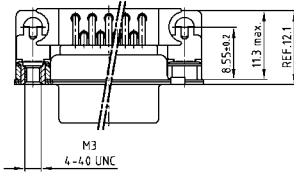

Mounting style: PCB clip, front spacer

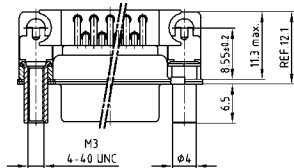

PLUG CONNECTOR

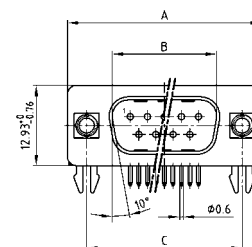

| No. of pos. | A -0.76 | B +0.25 | C | D -0.3 |
|-------------|---------|---------|-------------------|--------|
| 09 | 31.19 | 16.79 | 25.00 ±0.12 | 6.12 |
| 15 | 39.52 | 25.12 | 33.30 ±0.15 ±0.10 | 6.12 |
| 25 | 53.42 | 38.84 | 47.04 ±0.13 | 5.99 |
| 37 | 69.70 | 55.30 | 63.50 ±0.13 | 5.99 |

PCB layout: Kat1kGFA

Mounting style: PCB clip, threaded insert

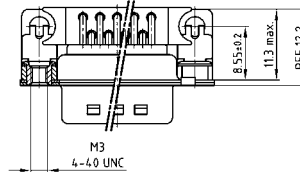

Mounting style: PCB clip, front spacer

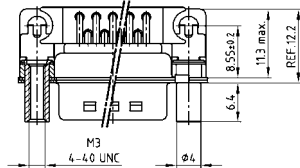

ORDER DATA

| SOCKET CONNECTOR | | |
|------------------|-------------------------------------|---------------|
| No. of pos. | Mounting style | Part Number |
| 09 | PCB clip / 4-40 UNC Threaded insert | 164 A 18809 X |
| 15 | PCB clip / 4-40 UNC Threaded insert | 164 A 18819 X |
| 25 | PCB clip / 4-40 UNC Threaded insert | 164 A 18829 X |
| 37 | PCB clip / 4-40 UNC Threaded insert | 164 A 18839 X |
| 09 | PCB clip / M3 Threaded insert | 164 A 18849 X |
| 15 | PCB clip / M3 Threaded insert | 164 A 18859 X |
| 25 | PCB clip / M3 Threaded insert | 164 A 18869 X |
| 37 | PCB clip / M3 Threaded insert | 164 A 18879 X |
| 09 | PCB clip / 4-40 UNC Front spacer | 164 A 18889 X |
| 15 | PCB clip / 4-40 UNC Front spacer | 164 A 18899 X |
| 25 | PCB clip / 4-40 UNC Front spacer | 164 A 18909 X |
| 37 | PCB clip / 4-40 UNC Front spacer | 164 A 18919 X |
| 09 | PCB clip / M3 Front spacer | 164 A 18929 X |
| 15 | PCB clip / M3 Front spacer | 164 A 18939 X |
| 25 | PCB clip / M3 Front spacer | 164 A 18949 X |
| 37 | PCB clip / M3 Front spacer | 164 A 18959 X |

| PLUG CONNECTOR | | |
|----------------|-------------------------------------|---------------|
| No. of pos. | Mounting style | Part Number |
| 09 | PCB clip / 4-40 UNC Threaded insert | 163 A 18389 X |
| 15 | PCB clip / 4-40 UNC Threaded insert | 163 A 18399 X |
| 25 | PCB clip / 4-40 UNC Threaded insert | 163 A 18409 X |
| 37 | PCB clip / 4-40 UNC Threaded insert | 163 A 18419 X |
| 09 | PCB clip / M3 Threaded insert | 163 A 18429 X |
| 15 | PCB clip / M3 Threaded insert | 163 A 18439 X |
| 25 | PCB clip / M3 Threaded insert | 163 A 18449 X |
| 37 | PCB clip / M3 Threaded insert | 163 A 18459 X |
| 09 | PCB clip / 4-40 UNC Front spacer | 163 A 18469 X |
| 15 | PCB clip / 4-40 UNC Front spacer | 163 A 18479 X |
| 25 | PCB clip / 4-40 UNC Front spacer | 163 A 18489 X |
| 37 | PCB clip / 4-40 UNC Front spacer | 163 A 18499 X |
| 09 | PCB clip / M3 Front spacer | 163 A 18509 X |
| 15 | PCB clip / M3 Front spacer | 163 A 18519 X |
| 25 | PCB clip / M3 Front spacer | 163 A 18529 X |
| 37 | PCB clip / M3 Front spacer | 163 A 18539 X |

PCB clip .122" / 3.1 ± .004" / 0.10 mm hole diameter and .063" / 1.6 mm circuit board thickness

Mouser Electronics

Authorized Distributor

Click to View Pricing, Inventory, Delivery & Lifecycle Information:

[Amphenol:](#)

[163A18399X](#) [163A18389X](#) [164A18829X](#) [164A18909X](#) [164A18839X](#) [164A18889X](#) [164A18809X](#) [164A18819X](#)
[163A18429X](#) [164A18899X](#) [163A18449X](#) [163A18409X](#) [163A18419X](#) [163A18479X](#)