

REV.	DATE	ECR NO.	DESCRIPTION
A	01/03/04	XXXXXX	UPDATE DRAWING FORMAT
B	10/20/11	2244	CHANGE THE TOTAL LENGTH TO 22.13MM FROM 21.13MM

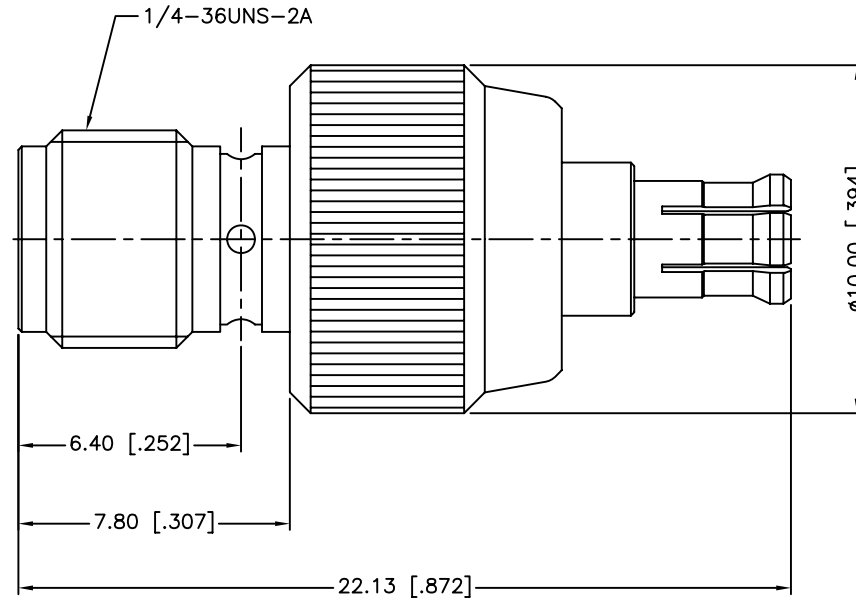

1. SEALING REQUIREMENT: IP-68 MUST WITHSTAND 3' DEPTH OF WATER FOR ONE HOUR WITHOUT ANY SIGNS OF LEAKAGE
2. MAX. PANEL THICKNESS= 6.8mm

UNLESS OTHERWISE SPECIFIED DIMENSIONS ARE IN MILLIMETERS. DIMENSIONS IN [ ] ARE IN INCHES AND FOR CUSTOMER REFERENCE ONLY.				APPROVALS	DATE	<b>Amphenol Connex</b>
4	CONTACT PIN	BER. COPPER	GOLD	1	DRAWN M.ZHANG	
3	INSULATOR	PTFE	NATURAL	1	CHECKED	
2	BODY	BER. COPPER	GOLD	1	ISSUED	
1	HOUSING	BRASS	GOLD	1	SHEET 1 OF 1	
UNLESS OTHERWISE SPECIFIED TOLERANCES FOR MILLIMETERS ARE: 0.5 - 8mm ± 0.20mm 8 - 30mm ± 0.40mm 30 - 120mm ± 0.50mm				CAD FILE		PART DESCRIPTION <b>SMA FEMALE TO MCX MALE ADAPTER BULKHEAD ADAPTOR (IP 68)</b>
UNLESS OTHERWISE SPECIFIED TOLERANCES FOR INCHES ARE: .020 - .315 = ± 0.007" .315 - 1.180 = ± 0.015" 1.180 - 4.724 = ± 0.020"				C:/CONNEX/242127.DWG		
DO NOT SCALE DRAWING				DWG. NO. 242127.DWG		PART NO. <b>242127</b>
DESCRIPTION	MATERIAL	FINISH	QTY	REV. B	SIZE A	SCALE NA

# Mouser Electronics

Authorized Distributor

Click to View Pricing, Inventory, Delivery & Lifecycle Information:

[Amphenol:](#)

[242127](#)