



Series 800 Mighty Mouse UN Mating Thread PC Tail or Solder Cup PCB Receptacle

800-012 and 800-040 Ordering Information



Printed Circuit Board/ Solder Cup Receptacles feature low profile shells for minimum protrusion inside enclosures and integral board standoffs. Contacts are non-removable.

Water Immersion, Unmated Specify **800-012** connectors for applications where open face water immersion is not a requirement. For MIL-STD-810 Method 512G immersion requirements, specify **800-040** watertight connectors. These 800-040 connectors are specially sealed ("MOD-518") and are 100% tested to maintain a helium leak rate of 1×10^{-4} cc/second at one atmosphere pressure differential from -40C to +70C.

How To Order

Sample Part Number	800-012	-07	M	7-10	P	Z
Series	800-012 = Receptacle for Solder Cup or PCB Termination, with Standard Epoxy Potting 800-040 = Receptacle for Solder Cup or PCB Termination, With Special "MOD-518" Sealing For Open Face (Unmated) Water Immersion Requirements. 100% Leak Tested.					
Shell Style (See Table I)	-02 = Square Flange -07 = Jam Nut (See <i>Jam Nut Panel Cutout Dimensions Page C-3</i>)					
Shell Material and Finish	C = Aluminum / Black Anodize (Non-Conductive) RoHS Compliant M = Aluminum / Electroless Nickel RoHS Compliant NF = Aluminum / Cadmium with Olive Drab Chromate ZNU = Aluminum / Zinc-Nickel with Black Chromate MT = Aluminum / Nickel-PTFE RoHS Compliant Z1 = Stainless Steel / Passivated RoHS Compliant					
Shell Size - Insert Arrangement	See Contact Arrangements page C-2					
Contact Type	P = Pin, PC Tail S = Socket, PC Tail		E = Pin, Solder Cup F = Socket, Solder Cup			
Shell Key Position (See Table II)	N = Normal X = Pos. X Y = Pos. Y Z = Pos. Z					

Table I: Shell Style

-02 Square Flange Front Mount	-07 Jam Nut for Rear Panel Mounting

Recommended Panel Cut Out

Shell Size	Ø M		N Flat ± .002		
	in	mm	in	mm	
5	.318	8.08	.297/.292	7.54/7.42	
6	.386	9.80	.365/.360	9.27/9.14	
7	.449	11.40	.429/.424	10.90/10.77	
8	.510	12.95	.483	12.67	
9	.574	14.58	.540	13.71	
10	.635	16.13	.614	15.60	
11	.700	17.78	.672	17.18	
12	.760	19.30	.722	18.34	

Dimensions in Inches (millimeters) are subject to change without notice.

Series 800 Mighty Mouse UN Mating Thread
PC Tail or Solder Cup PCB Receptacle
800-012 and 800-040 Dimensions



Series 800

Jam nut mount receptacle - shell style 07

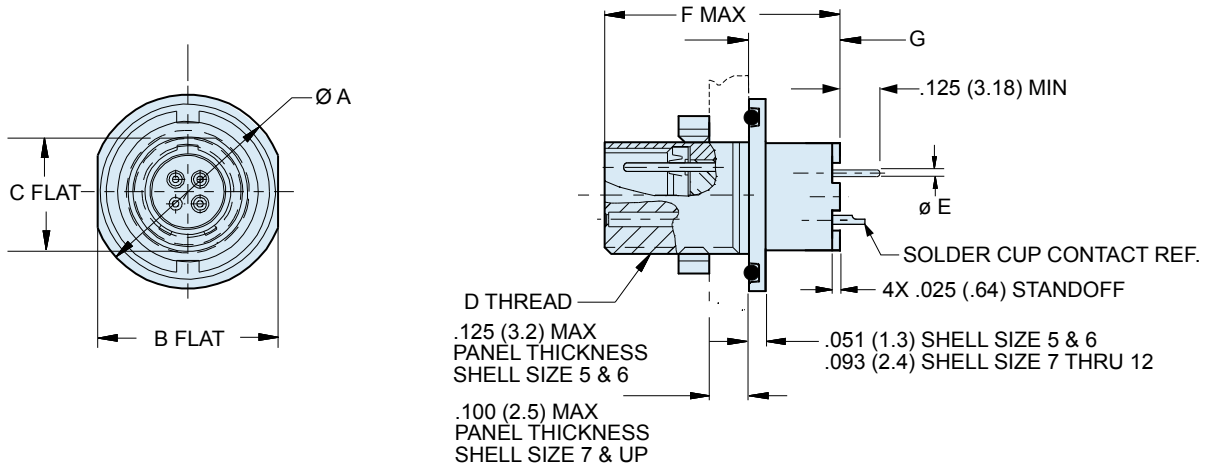

Dimensions												
Shell Size	Ø A		B Flat		C Flat		D Threads Mating	Ø E Tail Dia.	F Max		G	
	In.	Mm.	In.	Mm.	In.	Mm.			In.	Mm.	In.	Mm.
5	.541	13.74	.500	12.70	.285	7.24	.3125-28 Un-2A	#23 .018/.022 (0.46/0.56)	.725	18.42	.247	6.27
6	.610	15.49	.562	14.27	.352	8.94	.3750-28 Un-2A		.725	18.42	.247	6.27
7	.670	17.02	.635	16.13	.411	10.44	.4375-28 Unef-2A	#20 .024/.028 (0.61/0.71)	.700	17.78	.205	5.21
8	.775	19.69	.735	18.67	.473	12.01	.5000-32 Un-2A		.700	17.78	.205	5.21
9	.875	22.23	.806	20.47	.530	13.46	.5625-32 Un-2A	#16 .060/.064 (1.52/1.63)	.700	17.78	.205	5.21
10	.980	24.89	.940	23.88	.604	15.34	.6250-32 Un-2A		.700	17.78	.205	5.21
12	1.062	26.97	.986	25.04	.712	18.08	.7500-28 Un-2A	#12 .092/.096 (2.34/2.44)	.700	17.78	.205	5.21

Table II: Shell Key Positions			
Key Position	Key Rotation	Shell Size 5 and 6 Key Positions	Shell Size 7 thru 12 Key Positions
N Normal	150°		
X	140°		
Y	130°		
Z	120°		
<p>Shell size 5 and 6: master key is located at top dead center for normal (N) position.</p> <p>Shell size 7 thru 12: master key is rotated 90° from TDC for normal position.</p>			

Dimensions in Inches (millimeters) are subject to change without notice.



Series 800 Mighty Mouse UN Mating Thread PC Tail or Solder Cup PCB Receptacle 800-012 and 800-040 Dimensions

Square flange mount receptacle - shell style 02

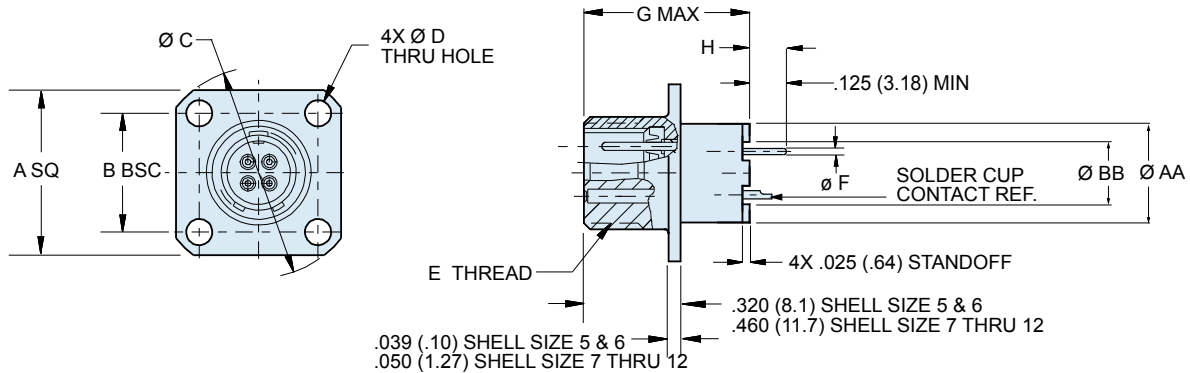

Dimensions

Shell Size	A SQ		B		Ø C		Ø D		E Threads Mating	Ø F Tail Dia.	G Max		H			
	In.	mm.	In.	mm.	In.	mm.	± .005	± 0.13			In.	mm.	In.	mm.	In.	mm.
5	.527	13.39	.363	9.22	.680	17.27	.096/	2.44/	.3125-28 UN-2A	#23 .018/.022 (0.46/0.56)	.725	18.42	.426	10.82		
6	.588	14.92	.423	10.74	.750	19.05	.091	2.31	.3750-28 UN-2A		.725	18.42	.426	10.82		
7	.650	16.51	.483	12.27	.830	21.08	.128	3.25	.4375-28 UNEF-2A	#20 .024/.028 (0.61/0.71)	.700	17.78	.255	6.48		
8	.710	18.03	.542	13.77	.938	23.83	.128	3.25	.5000-32 UN-2A		.700	17.78	.255	6.48		
9	.938	23.83	.719	18.26	1.250	31.75	.128	3.25	.5625-32 UN-2A	#16 .060/.064 (1.52/1.63)	.700	17.78	.255	6.48		
10	.938	23.83	.719	18.26	1.250	31.75	.128	3.25	.6250-32 UN-2A		.700	17.78	.255	6.48		
12	1.031	26.19	.812	20.62	1.375	34.93	.128	3.25	.7500-28 UN-2A	#12 .092/.096 (2.34/2.44)	.700	17.78	.255	6.48		

Dimensions (Continued)

Shell Size	Ø AA O.D.		Ø BB I.D.	
	In.	mm.	In.	mm.
	5	.265	6.73	.186
6	.330	8.38	.238	6.05
7	.424	10.77	.327	8.31
8	.448	11.38	.388	9.86
9	.500	12.70	.446	11.33
10	.575	14.61	.515	13.08
12	.660	16.76	.599	15.21

Dimensions in Inches (millimeters) are subject to change without notice.



Series 800 Mighty Mouse with UN Mating Thread Contact Arrangements, Keyway Positions and Jam Nut Panel Cutout Dimensions

C

Contact Arrangements					
Contact Arr.	No. of Contacts				
	#23	#20	#20HD	#16	#12*
5-3	3				
6-1				1	
6-23			3		
6-4	4				
6-6	6				
6-7	7				
7-1					1
7-25			5		
7-10	10				
8-2				2	
8-13	13				
8-28			8		
8-200	4	2			
9-4				4	
9-210			10		
9-19	19				
9-200	4			2	
9-201	8	2			
10-2					2
10-5				5	
10-26	26				
10-200	12				1
10-201	4				2
10-202	8			2	
12-2					2
12-3					3
12-7				7	
12-220			20		
12-37	37				
12-200	6				2
12-201	10				2
12-202	20				
12-203	12				
12-204	12				2
12-205	4				4

*Arrangements with #12 contacts available with keyed Twinax contacts. Use mode code -688

Mating Face View of Pin Connector (socket connector numbers are reversed)

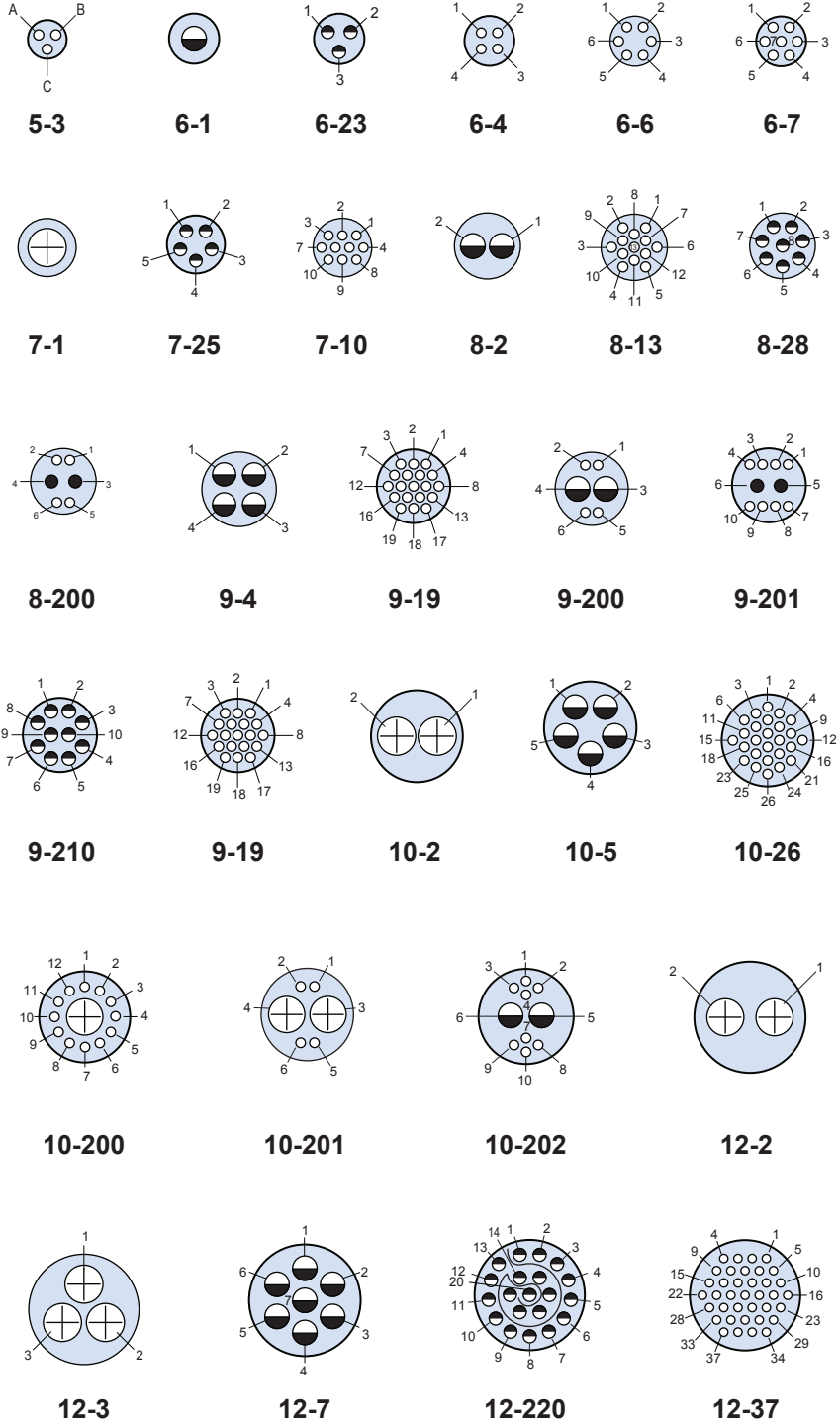

Contact Legend

#23◐ #20HD◐ #20● #16◑ #12⊕

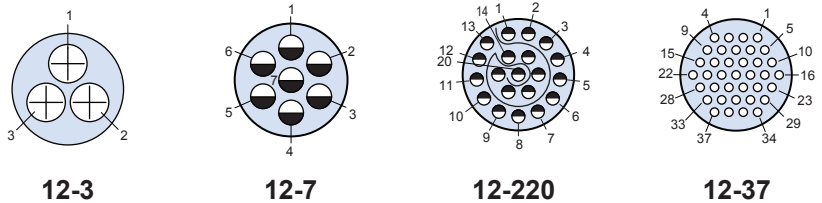

Dimensions in Inches (millimeters) are subject to change without notice.

Series 800 Mighty Mouse with UN Mating Thread Contact Arrangements, Keyway Positions and Jam Nut Panel Cutout Dimensions



Series 800

Mating Face View of Pin Connector (socket connector numbers are reversed)

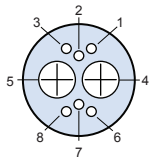

12-200

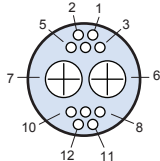

12-201

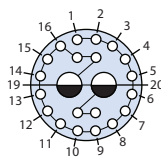

12-202

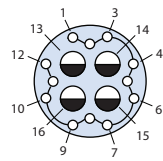

12-203

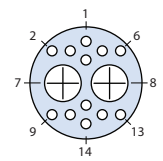

12-204

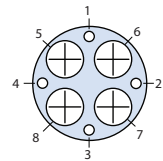

12-205

					Series 800 Key Positions	
Shell Size	N	X	Y	Z		
5	150°	140°	130°	120°		
6						
7						
8						
9						
10						
12						
<p>Shell size 5 and 6: master key is located at top dead center for normal (N) position.</p> <p>Shell size 7 thru 12: master key is rotated 90° from TDC for normal position.</p>					Shell Size 5 and 6 Key Position	Shell Size 7 thru 12 Key Position

C

Jam Nut Panel Cut Out					
Shell Size	Ø M		N Flat		
	in	mm	in	mm	
5	.318	8.08	.302/.298	7.67/7.56	
6	.386	9.80	.365/.361	9.27/9.17	
7	.449	11.40	.429/.424	10.90/10.77	
8	.510	12.95	.486/.482	12.34/12.24	
9	.574	14.58	.543/.539	13.79/13.69	
10	.635	16.13	.617/.613	15.67/15.57	
12	.760	19.30	.725/.721	18.41/18.31	

Dimensions in Inches (millimeters) are subject to change without notice.