

AS85049/46 and MS27663-2 90° Non-Self-Locking Composite Strain Relief

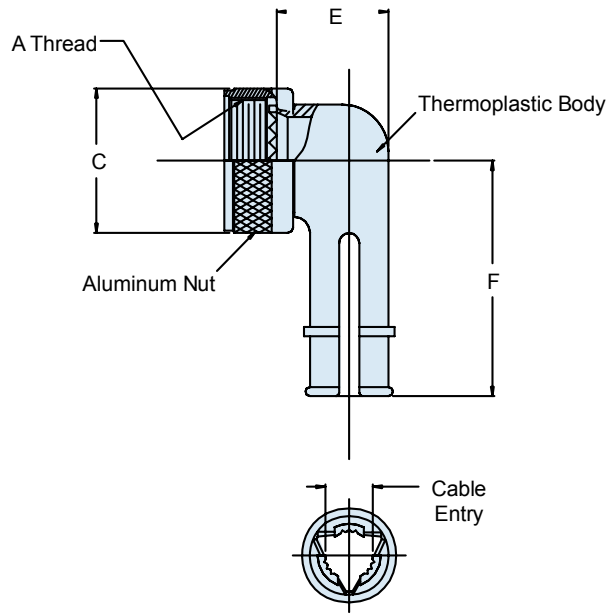

CONNECTOR DESIGNATOR:	
F	MIL-DTL-27599, MIL-DTL-38999 Series Series I & II

Basic Part Number	Dash No.
M85049/46	W 10



Finish
<i>A</i> = Anodize, Black
<i>N</i> = Electroless Nickel
<i>W</i> = 1,000 Hour Cadmium Olive Drab over Electroless Nickel
<i>X</i> = Pure Dense Electrodeposited Aluminum
<i>Y</i> = Passivated
<i>Z</i> = Zinc-Nickel, Black

Superseded PART NUMBER

MS27663-2

Basic Part No.	Dash No.
----------------	----------

TABLE I: Shell Size, Cable Entry and Backshell Dimensions											
Dash No.	Shell Size Ref.	A Thread Class 2B	Ø C Max	E Max		F Max		Cable Entry			
								Min	Max	Min	Max
8	8/9	.438 - 28 UNEF	.578 (14.7)	.656 (16.7)	1.015 (25.8)	.094 (2.4)	.203 (5.2)	.094 (2.4)	.203 (5.2)	.094 (2.4)	.203 (5.2)
10	10/11	.562 - 24 UNEF	.703 (17.9)	.688 (17.5)	1.062 (27.0)	.141 (3.6)	.250 (6.4)	.141 (3.6)	.250 (6.4)	.141 (3.6)	.250 (6.4)
12	12/13	.688 - 24 UNEF	.828 (21.0)	.750 (19.1)	1.125 (28.6)	.172 (4.4)	.323 (8.2)	.172 (4.4)	.323 (8.2)	.172 (4.4)	.323 (8.2)
14	14/15	.813 - 20 UNEF	.953 (24.2)	.859 (21.8)	1.328 (33.7)	.203 (5.2)	.422 (10.7)	.203 (5.2)	.422 (10.7)	.203 (5.2)	.422 (10.7)
16	16/17	.938 - 20 UNEF	1.078 (27.4)	.937 (23.8)	1.392 (35.4)	.234 (5.9)	.500 (12.7)	.234 (5.9)	.500 (12.7)	.234 (5.9)	.500 (12.7)
18	18/19	1.063 - 18 UNEF	1.203 (30.6)	1.000 (25.4)	1.453 (36.9)	.265 (6.7)	.562 (14.3)	.265 (6.7)	.562 (14.3)	.265 (6.7)	.562 (14.3)
20	20/21	1.188 - 18 UNEF	1.328 (33.7)	1.062 (27.0)	1.609 (40.9)	.297 (7.5)	.625 (15.9)	.297 (7.5)	.625 (15.9)	.297 (7.5)	.625 (15.9)
22	22/23	1.313 - 18 UNEF	1.453 (36.9)	1.141 (29.0)	1.656 (42.1)	.328 (8.3)	.703 (17.9)	.328 (8.3)	.703 (17.9)	.328 (8.3)	.703 (17.9)
24	24/25	1.438 - 18 UNEF	1.578 (40.1)	1.203 (30.6)	1.719 (43.7)	.359 (9.1)	.765 (19.4)	.359 (9.1)	.765 (19.4)	.359 (9.1)	.765 (19.4)

- APPLICATION NOTES**
1. Assembly to be identified with manufacturer's name and part number, space permitting.
 2. Cable Entry is defined as the accommodation entry for the wire bundle or cable. Dimensions are not intended for inspection criteria.
 3. For complete dimensions, see the applicable Military Specification.
 4. Metric dimensions (mm) are in parentheses.

Downloaded from Arrow.com