

Sensor/actuator terminal block - PTIO-IN 2,5/3 OG



3244559

<https://www.phoenixcontact.com/us/products/3244559>

Please be informed that the data shown in this PDF document is generated from our Online Catalog. Please find the complete data in the user documentation. Our General Terms of Use for Downloads are valid.



Sensor/actuator terminal block, Power terminal, nom. voltage: 250 V, nominal current: 20 A, connection method: Push-in connection, Rated cross section: 2.5 mm², cross section: 0.2 mm² - 4 mm², mounting type: NS 35/7,5, NS 35/15, color: orange

Your advantages

- The compact design and front connection enable wiring in a confined space
- The Push-in connection terminal blocks are characterized by the system features of the CLIPLINE complete system and by easy and tool-free wiring of conductors with ferrules or solid conductors
- In addition to the testing facility in the double function shaft, all terminal blocks provide an additional test connection

Commercial Data

| | |
|--------------------------------------|--------------------|
| Item number | 3244559 |
| Packing unit | 1 pc |
| Minimum order quantity | 50 pc |
| Sales Key | B02 |
| Product Key | BE2217 |
| Catalog Page | Page 41 (C-1-2019) |
| GTIN | 4046356735902 |
| Weight per Piece (including packing) | 11.5 g |
| Weight per Piece (excluding packing) | 11.5 g |
| Customs tariff number | 85369010 |
| Country of origin | PL |

Sensor/actuator terminal block - PTIO-IN 2,5/3 OG



3244559

<https://www.phoenixcontact.com/us/products/3244559>

Technical Data

Product properties

| | |
|-----------------------|--------------------------------|
| Product type | Sensor/actuator terminal block |
| Number of connections | 2 |
| Number of rows | 2 |
| Potentials | 2 |

Insulation characteristics

| | |
|----------------------|-----|
| Overvoltage category | III |
| Degree of pollution | 3 |

Electrical properties

| | |
|---|--------|
| Rated surge voltage | 4 kV |
| Maximum power dissipation for nominal condition | 0.77 W |

Connection data

| | |
|---|--|
| Service Entrance | yes |
| Number of connections per level | 1 |
| Nominal cross section | 2.5 mm ² |
| Note | Please observe the current carrying capacity of the DIN rails. |
| Stripping length | 8 mm ... 10 mm |
| Internal cylindrical gage | A3 |
| Conductor cross section solid | 0.2 mm ² ... 4 mm ² |
| Cross section AWG | 24 ... 12 |
| Conductor cross section flexible | 0.2 mm ² ... 2.5 mm ² |
| Conductor cross section, flexible [AWG] | 24 ... 14 |
| Flexible conductor cross section flexible (ferrule, w/o plastic sleeve) | 0.2 mm ² ... 2.5 mm ² |
| Flexible conductor cross section (ferrule with plastic sleeve) | 0.2 mm ² ... 2.5 mm ² |
| 2 conductors with the same cross section, flexible, with TWIN ferrule with plastic sleeve | 0.5 mm ² |
| Nominal current | 20 A |
| Maximum load current | 20 A |
| Nominal voltage | 250 V |
| Nominal cross section | 2.5 mm ² |

Connection cross sections directly pluggable

| | |
|---|--|
| Conductor cross section solid | 0.34 mm ² ... 4 mm ² |
| Flexible conductor cross section flexible (ferrule, w/o plastic sleeve) | 0.34 mm ² ... 2.5 mm ² |
| Flexible conductor cross section (ferrule with plastic sleeve) | 0.34 mm ² ... 2.5 mm ² |

Dimensions

| | |
|-------|------|
| Width | 7 mm |
|-------|------|

Sensor/actuator terminal block - PTIO-IN 2,5/3 OG



3244559

<https://www.phoenixcontact.com/us/products/3244559>

| | |
|------------------|---------|
| End cover width | 2.2 mm |
| Height NS 35/15 | 49 mm |
| Height NS 35/7,5 | 41.5 mm |
| Length | 74.4 mm |

Material specifications

| | |
|---|--------|
| Color | orange |
| Flammability rating according to UL 94 | V0 |
| Insulating material group | I |
| Insulating material | PA |
| Static insulating material application in cold | -60 °C |
| Temperature index of insulation material (DIN EN 60216-1 (VDE 0304-21)) | 130 °C |
| Relative insulation material temperature index (Elec., UL 746 B) | 130 °C |

Electrical tests

Surge voltage test

| | |
|-----------------------|-------------|
| Test voltage setpoint | 4.8 kV |
| Result | Test passed |

Temperature-rise test

| | |
|--|-------------------------------------|
| Requirement temperature-rise test | Increase in temperature ≤ 45 K |
| Result | Test passed |
| Short-time withstand current 4 mm ² | 0.36 kA |
| Result | Test passed |

Power-frequency withstand voltage

| | |
|-----------------------|-------------|
| Test voltage setpoint | 1.5 kV |
| Result | Test passed |

Mechanical properties

Mechanical data

| | |
|-----------------|-----|
| Open side panel | Yes |
|-----------------|-----|

Mechanical tests

Mechanical strength

| | |
|--------|-------------|
| Result | Test passed |
|--------|-------------|

Attachment on the carrier

| | |
|-------------------------|-------------|
| DIN rail/fixing support | NS 35 |
| Test force setpoint | 1 N |
| Result | Test passed |

Test for conductor damage and slackening

| | |
|----------------|--------|
| Rotation speed | 10 rpm |
|----------------|--------|

Sensor/actuator terminal block - PTIO-IN 2,5/3 OG



3244559

<https://www.phoenixcontact.com/us/products/3244559>

| | |
|--------------------------------|------------------------------|
| Revolutions | 135 |
| Conductor cross section/weight | 0.2 mm ² / 0.2 kg |
| | 2.5 mm ² / 0.7 kg |
| | 4 mm ² / 0.9 kg |
| Result | Test passed |

Environmental and real-life conditions

Aging

| | |
|--------------------|-------------|
| Temperature cycles | 192 |
| Result | Test passed |

Needle-flame test

| | |
|------------------|-------------|
| Time of exposure | 10 s |
| Result | Test passed |

Oscillation/broadband noise

| | |
|------------------------|--|
| Specification | DIN EN 50155 (VDE 0115-200):2008-03 |
| Spectrum | Service life test category 2, bogie-mounted |
| Frequency | f ₁ = 5 Hz to f ₂ = 250 Hz |
| ASD level | 6.12 (m/s ²) ² /Hz |
| Acceleration | 3.12g |
| Test duration per axis | 5 h |
| Test directions | X-, Y- and Z-axis |
| Result | Test passed |

Shocks

| | |
|--------------------------------|-------------------------------------|
| Specification | DIN EN 50155 (VDE 0115-200):2008-03 |
| Pulse shape | Half-sine |
| Acceleration | 30g |
| Shock duration | 18 ms |
| Number of shocks per direction | 3 |
| Test directions | X-, Y- and Z-axis (pos. and neg.) |
| Result | Test passed |

Ambient conditions

| | |
|--|---|
| Ambient temperature (operation) | -60 °C ... 105 °C (max. short-term operating temperature RTI Elec.) |
| Ambient temperature (storage/transport) | -25 °C ... 60 °C (for a short time, not exceeding 24 h, -60 °C to +70 °C) |
| Ambient temperature (assembly) | -5 °C ... 70 °C |
| Ambient temperature (actuation) | -5 °C ... 70 °C |
| Permissible humidity (storage/transport) | 30 % ... 70 % |

Standards and regulations

| | |
|----------------------------------|---------------|
| Connection in acc. with standard | IEC 60947-7-1 |
|----------------------------------|---------------|

Sensor/actuator terminal block - PTIO-IN 2,5/3 OG



3244559

<https://www.phoenixcontact.com/us/products/3244559>

Mounting

| | |
|---------------|-----------|
| Mounting type | NS 35/7,5 |
| | NS 35/15 |

Sensor/actuator terminal block - PTIO-IN 2,5/3 OG

3244559

<https://www.phoenixcontact.com/us/products/3244559>



Drawings

Circuit diagram



Sensor/actuator terminal block - PTIO-IN 2,5/3 OG





3244559

<https://www.phoenixcontact.com/us/products/3244559>

Approvals

|  CSA Approval ID: 13631 | | | | |
|--|-----------------------|-----------------------|-------------------|-----------------------------|
| | Nominal Voltage U_N | Nominal Current I_N | Cross Section AWG | Cross Section mm^2 |
| Use group B | 300 V | 10 A | 24 - 12 | - |
| Use group C | 150 V | 16 A | 24 - 12 | - |
| Use group D | 300 V | 10 A | 24 - 12 | - |

|  EAC Approval ID: RU C-DE.BL08.B.00644 | | | | |
|---|--|--|--|--|
|---|--|--|--|--|

|  cULus Recognized Approval ID: E60425 | | | | |
|--|-----------------------|-----------------------|-------------------|-----------------------------|
| | Nominal Voltage U_N | Nominal Current I_N | Cross Section AWG | Cross Section mm^2 |
| Use group B | 300 V | 10 A | 24 - 12 | - |
| Use group C | 150 V | 16 A | 24 - 12 | - |
| Use group D | 300 V | 10 A | 24 - 12 | - |

Sensor/actuator terminal block - PTIO-IN 2,5/3 OG



3244559

<https://www.phoenixcontact.com/us/products/3244559>

Classifications

ECLASS

| | |
|---------------|----------|
| ECLASS-9.0 | 27141128 |
| ECLASS-10.0.1 | 27141128 |
| ECLASS-11.0 | 27141128 |

ETIM

| | |
|----------|----------|
| ETIM 8.0 | EC000900 |
|----------|----------|

UNSPSC

| | |
|-------------|----------|
| UNSPSC 21.0 | 39121400 |
|-------------|----------|

Sensor/actuator terminal block - PTIO-IN 2,5/3 OG



3244559

<https://www.phoenixcontact.com/us/products/3244559>

Environmental Product Compliance

| | |
|------------|---|
| China RoHS | Environmentally friendly use period: unlimited = EFUP-e |
| | No hazardous substances above threshold values |

Sensor/actuator terminal block - PTIO-IN 2,5/3 OG

3244559

<https://www.phoenixcontact.com/us/products/3244559>

Accessories

 Note: Applying some accessories below might limit this product.

Plug-in bridge

Plug-in bridge - FBS 2-3,5 - 3213014

<https://www.phoenixcontact.com/us/products/3213014>



Plug-in bridge, pitch: 3.5 mm, color: red

 Max. current carrying capacity: 17.5 A

Plug-in bridge

Plug-in bridge - FBS 3-3,5 - 3213027

<https://www.phoenixcontact.com/us/products/3213027>



Plug-in bridge, pitch: 3.5 mm, color: red

 Max. current carrying capacity: 17.5 A

Sensor/actuator terminal block - PTIO-IN 2,5/3 OG

3244559

<https://www.phoenixcontact.com/us/products/3244559>

Plug-in bridge

Plug-in bridge - FBS 4-3,5 - 3213030

<https://www.phoenixcontact.com/us/products/3213030>



Plug-in bridge, pitch: 3.5 mm, color: red

 Max. current carrying capacity: 17.5 A

Plug-in bridge

Plug-in bridge - FBS 5-3,5 - 3213043

<https://www.phoenixcontact.com/us/products/3213043>



Plug-in bridge, pitch: 3.5 mm, color: red

 Max. current carrying capacity: 17.5 A

Sensor/actuator terminal block - PTIO-IN 2,5/3 OG

3244559

<https://www.phoenixcontact.com/us/products/3244559>

Plug-in bridge

Plug-in bridge - FBS 10-3,5 - 3213056

<https://www.phoenixcontact.com/us/products/3213056>



Plug-in bridge, pitch: 3.5 mm, color: red

 Max. current carrying capacity: 17.5 A

Plug-in bridge

Plug-in bridge - FBS 20-3,5 - 3213069

<https://www.phoenixcontact.com/us/products/3213069>



Plug-in bridge, pitch: 3.5 mm, color: red

 Max. current carrying capacity: 17.5 A

Sensor/actuator terminal block - PTIO-IN 2,5/3 OG

3244559

<https://www.phoenixcontact.com/us/products/3244559>

Plug-in bridge

Plug-in bridge - FBS 50-3,5 - 3000706

<https://www.phoenixcontact.com/us/products/3000706>



Plug-in bridge, Version with single- or double-sided cutting edge. Please keep in mind the possible impact on touch protection as well as air clearances and creepage distances., pitch: 3.5 mm, color: red

 Max. current carrying capacity: 17.5 A

Plug-in bridge

Plug-in bridge - FBS 2-3,5 BU - 3213086

<https://www.phoenixcontact.com/us/products/3213086>



Plug-in bridge, pitch: 3.5 mm, color: blue

 Max. current carrying capacity: 17.5 A

Sensor/actuator terminal block - PTIO-IN 2,5/3 OG

3244559

<https://www.phoenixcontact.com/us/products/3244559>

Plug-in bridge

Plug-in bridge - FBS 3-3,5 BU - 3213099

<https://www.phoenixcontact.com/us/products/3213099>



Plug-in bridge, pitch: 3.5 mm, color: blue

 Max. current carrying capacity: 17.5 A

Plug-in bridge

Plug-in bridge - FBS 4-3,5 BU - 3213109

<https://www.phoenixcontact.com/us/products/3213109>



Plug-in bridge, pitch: 3.5 mm, color: blue

 Max. current carrying capacity: 17.5 A

Sensor/actuator terminal block - PTIO-IN 2,5/3 OG

3244559

<https://www.phoenixcontact.com/us/products/3244559>

Plug-in bridge

Plug-in bridge - FBS 5-3,5 BU - 3213112

<https://www.phoenixcontact.com/us/products/3213112>



Plug-in bridge, pitch: 3.5 mm, color: blue

 Max. current carrying capacity: 17.5 A

Plug-in bridge

Plug-in bridge - FBS 10-3,5 BU - 3213125

<https://www.phoenixcontact.com/us/products/3213125>



Plug-in bridge, pitch: 3.5 mm, color: blue

 Max. current carrying capacity: 17.5 A

Sensor/actuator terminal block - PTIO-IN 2,5/3 OG

3244559

<https://www.phoenixcontact.com/us/products/3244559>

Plug-in bridge

Plug-in bridge - FBS 20-3,5 BU - 3213138

<https://www.phoenixcontact.com/us/products/3213138>



Plug-in bridge, pitch: 3.5 mm, color: blue

 Max. current carrying capacity: 17.5 A

Plug-in bridge

Plug-in bridge - FBS 50-3,5 BU - 3000708

<https://www.phoenixcontact.com/us/products/3000708>



Plug-in bridge, Version with single- or double-sided cutting edge. Please keep in mind the possible impact on touch protection as well as air clearances and creepage distances., pitch: 3.5 mm, color: blue

 Max. current carrying capacity: 17.5 A

Sensor/actuator terminal block - PTIO-IN 2,5/3 OG

3244559

<https://www.phoenixcontact.com/us/products/3244559>

Plug-in bridge

Plug-in bridge - FBS 2-3,5 GY - 3213153

<https://www.phoenixcontact.com/us/products/3213153>



Plug-in bridge, pitch: 3.5 mm, color: gray

 Max. current carrying capacity: 17.5 A

Plug-in bridge

Plug-in bridge - FBS 3-3,5 GY - 3213167

<https://www.phoenixcontact.com/us/products/3213167>



Plug-in bridge, pitch: 3.5 mm, color: gray

 Max. current carrying capacity: 17.5 A

Sensor/actuator terminal block - PTIO-IN 2,5/3 OG

3244559

<https://www.phoenixcontact.com/us/products/3244559>



Plug-in bridge

Plug-in bridge - FBS 4-3,5 GY - 3213180

<https://www.phoenixcontact.com/us/products/3213180>



Plug-in bridge, pitch: 3.5 mm, color: gray

 Max. current carrying capacity: 17.5 A

Plug-in bridge

Plug-in bridge - FBS 5-3,5 GY - 3213183

<https://www.phoenixcontact.com/us/products/3213183>



Plug-in bridge, pitch: 3.5 mm, color: gray

 Max. current carrying capacity: 17.5 A

Sensor/actuator terminal block - PTIO-IN 2,5/3 OG

3244559

<https://www.phoenixcontact.com/us/products/3244559>

Plug-in bridge

Plug-in bridge - FBS 10-3,5 GY - 3213196

<https://www.phoenixcontact.com/us/products/3213196>

Plug-in bridge, pitch: 3.5 mm, color: gray



 Max. current carrying capacity: 17.5 A

Plug-in bridge

Plug-in bridge - FBS 20-3,5 GY - 3213206

<https://www.phoenixcontact.com/us/products/3213206>

Plug-in bridge, pitch: 3.5 mm, color: gray



 Max. current carrying capacity: 17.5 A

Sensor/actuator terminal block - PTIO-IN 2,5/3 OG



3244559

<https://www.phoenixcontact.com/us/products/3244559>

Plug-in bridge

Plug-in bridge - FBS 50-3,5 GY - 3000707

<https://www.phoenixcontact.com/us/products/3000707>



Plug-in bridge, Version with single- or double-sided cutting edge. Please keep in mind the possible impact on touch protection as well as air clearances and creepage distances., pitch: 3.5 mm, color: gray

 Max. current carrying capacity: 17.5 A

End cover

End cover - D-PTIO 1,5/S/3 - 3244575

<https://www.phoenixcontact.com/us/products/3244575>



End cover, length: 74.4 mm, width: 2.2 mm, height: 33.8 mm, color: gray

Sensor/actuator terminal block - PTIO-IN 2,5/3 OG



3244559

<https://www.phoenixcontact.com/us/products/3244559>

DIN rail perforated

DIN rail perforated - NS 35/ 7,5 PERF 2000MM - 0801733

<https://www.phoenixcontact.com/us/products/0801733>



DIN rail perforated, acc. to EN 60715, material: Steel, galvanized, passivated with a thick layer, Standard profile, color: silver, Pack of 25 (50 m)

Mounting material

Mounting material - PT-IL - 3208090

<https://www.phoenixcontact.com/us/products/3208090>

Operating decal for the push-in Technology



Sensor/actuator terminal block - PTIO-IN 2,5/3 OG



3244559

<https://www.phoenixcontact.com/us/products/3244559>

DIN rail, unperforated

DIN rail, unperforated - NS 35/ 7,5 UNPERF 2000MM - 0801681

<https://www.phoenixcontact.com/us/products/0801681>



DIN rail, unperforated, acc. to EN 60715, material: Steel, galvanized, passivated with a thick layer, Standard profile, color: silver, Pack of 25 (50 m)

Actuation tool

Actuation tool - ST-BW - 1207608

<https://www.phoenixcontact.com/us/products/1207608>



Actuation tool, for all 2.5 mm² - 4.0 mm² spring-cages

Sensor/actuator terminal block - PTIO-IN 2,5/3 OG



3244559

<https://www.phoenixcontact.com/us/products/3244559>

DIN rail perforated

DIN rail perforated - NS 35/ 7,5 WH PERF 2000MM - 1204119

<https://www.phoenixcontact.com/us/products/1204119>



DIN rail perforated, acc. to EN 60715, material: Steel, Galvanized, white passivated, Standard profile, color: silver, Pack of 25 (50 m)

Filler plugs

Filler plugs - CEC 2,5 - 3062757

<https://www.phoenixcontact.com/us/products/3062757>

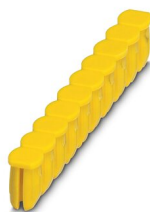

Cover for conductor shaft, 10-pos., for spring cage terminal blocks (ST) and terminal blocks with push-in technology (PT) with a width of 5.2 mm

Sensor/actuator terminal block - PTIO-IN 2,5/3 OG



3244559

<https://www.phoenixcontact.com/us/products/3244559>

DIN rail, unperforated

DIN rail, unperforated - NS 35/ 7,5 WH UNPERF 2000MM-VPE 10 - 1204122

<https://www.phoenixcontact.com/us/products/1204122>



DIN rail, unperforated, acc. to EN 60715, material: Steel, Galvanized, white passivated, Standard profile, color: silver, Pack of 10 (20 m)

DIN rail, unperforated

DIN rail, unperforated - NS 35/ 7,5 AL UNPERF 2000MM - 0801704

<https://www.phoenixcontact.com/us/products/0801704>



DIN rail, unperforated, acc. to EN 60715, material: Aluminum, uncoated, Standard profile, color: silver, Pack of 25 (50 m)

Sensor/actuator terminal block - PTIO-IN 2,5/3 OG



3244559

<https://www.phoenixcontact.com/us/products/3244559>

DIN rail perforated

DIN rail perforated - NS 35/ 7,5 ZN PERF 2000MM - 1206421

<https://www.phoenixcontact.com/us/products/1206421>



DIN rail perforated, acc. to EN 60715, material: Steel, galvanized, Standard profile, color: silver, Pack of 25 (50 m)

DIN rail, unperforated

DIN rail, unperforated - NS 35/ 7,5 ZN UNPERF 2000MM - 1206434

<https://www.phoenixcontact.com/us/products/1206434>



DIN rail, unperforated, acc. to EN 60715, material: Steel, galvanized, Standard profile, color: silver, Pack of 25 (50 m)

Sensor/actuator terminal block - PTIO-IN 2,5/3 OG



3244559

<https://www.phoenixcontact.com/us/products/3244559>

DIN rail, unperforated

DIN rail, unperforated - NS 35/ 7,5 CU UNPERF 2000MM-VPE 10 - 0801762

<https://www.phoenixcontact.com/us/products/0801762>



DIN rail, unperforated, acc. to EN 60715, material: Copper, uncoated, Standard profile, color: copper-colored, Pack of 10 (20 m)

End cap

End cap - NS 35/ 7,5 CAP - 1206560

<https://www.phoenixcontact.com/us/products/1206560>

DIN rail end piece, for DIN rail NS 35/7.5



Sensor/actuator terminal block - PTIO-IN 2,5/3 OG



3244559

<https://www.phoenixcontact.com/us/products/3244559>

DIN rail perforated

DIN rail perforated - NS 35/15 PERF 2000MM - 1201730

<https://www.phoenixcontact.com/us/products/1201730>



DIN rail perforated, similar to EN 60715, material: Steel, galvanized, passivated with a thick layer, Standard profile, color: silver, Pack of 25 (50 m)

DIN rail, unperforated

DIN rail, unperforated - NS 35/15 UNPERF 2000MM - 1201714

<https://www.phoenixcontact.com/us/products/1201714>



DIN rail, unperforated, similar to EN 60715, material: Steel, galvanized, passivated with a thick layer, Standard profile, color: silver, Pack of 25 (50 m)

Sensor/actuator terminal block - PTIO-IN 2,5/3 OG



3244559

<https://www.phoenixcontact.com/us/products/3244559>

DIN rail perforated

DIN rail perforated - NS 35/15 WH PERF 2000MM - 0806602

<https://www.phoenixcontact.com/us/products/0806602>



DIN rail perforated, similar to EN 60715, material: Steel, Galvanized, white passivated, Standard profile, color: white, Pack of 25 (50 m)

DIN rail, unperforated

DIN rail, unperforated - NS 35/15 WH UNPERF 2000MM-VPE 10 - 1204135

<https://www.phoenixcontact.com/us/products/1204135>



DIN rail, unperforated, similar to EN 60715, material: Steel, Galvanized, white passivated, Standard profile, color: silver, Pack of 10 (20 m)

Sensor/actuator terminal block - PTIO-IN 2,5/3 OG



3244559

<https://www.phoenixcontact.com/us/products/3244559>

DIN rail, unperforated

DIN rail, unperforated - NS 35/15 AL UNPERF 2000MM - 1201756

<https://www.phoenixcontact.com/us/products/1201756>



DIN rail, unperforated, similar to EN 60715, material: Aluminum, uncoated, Standard profile, color: silver

DIN rail perforated

DIN rail perforated - NS 35/15 ZN PERF 2000MM - 1206599

<https://www.phoenixcontact.com/us/products/1206599>



DIN rail perforated, similar to EN 60715, material: Steel, galvanized, Standard profile, color: silver, Pack of 25 (50 m)

Sensor/actuator terminal block - PTIO-IN 2,5/3 OG

3244559

<https://www.phoenixcontact.com/us/products/3244559>

DIN rail, unperforated

DIN rail, unperforated - NS 35/15 ZN UNPERF 2000MM - 1206586

<https://www.phoenixcontact.com/us/products/1206586>



DIN rail, unperforated, similar to EN 60715, material: Steel, galvanized, Standard profile, color: silver, Pack of 25 (50 m)

DIN rail, unperforated

DIN rail, unperforated - NS 35/15 CU UNPERF 2000MM-VPE 10 - 1201895

<https://www.phoenixcontact.com/us/products/1201895>



DIN rail, unperforated, similar to EN 60715, material: Copper, uncoated, Standard profile, color: copper-colored, Pack of 10 (20 m)

Sensor/actuator terminal block - PTIO-IN 2,5/3 OG



3244559

<https://www.phoenixcontact.com/us/products/3244559>

End cap

End cap - NS 35/15 CAP - 1206573

<https://www.phoenixcontact.com/us/products/1206573>

DIN rail end piece, for DIN rail NS 35/15



DIN rail, unperforated

DIN rail, unperforated - NS 35/15-2,3 UNPERF 2000MM-VPE 10 - 1201798

<https://www.phoenixcontact.com/us/products/1201798>



DIN rail, unperforated, acc. to EN 60715, material: Steel, galvanized, passivated with a thick layer, Standard profile 2.3 mm, color: silver, Pack of 10 (20 m)

Sensor/actuator terminal block - PTIO-IN 2,5/3 OG



3244559

<https://www.phoenixcontact.com/us/products/3244559>

Zack Marker strip, flat

Zack Marker strip, flat - ZBF 5:UNBEDRUCKT - 0808642

<https://www.phoenixcontact.com/us/products/0808642>



Zack Marker strip, flat, Strip, white, unlabeled, can be labeled with: PLOTMARK, CMS-P1-PLOTTER, mounting type: snapped, for terminal block width: 5 mm, lettering field size: 5.1 x 5.2 mm, Number of individual labels: 10

Zack Marker strip, flat

Zack Marker strip, flat - ZBF 5 CUS - 0825025

<https://www.phoenixcontact.com/us/products/0825025>



Zack Marker strip, flat, can be ordered: Strip, white, labeled according to customer specifications, mounting type: snap into flat marker groove, for terminal block width: 5 mm, lettering field size: 5.15 x 5.15 mm, Number of individual labels: 10

Sensor/actuator terminal block - PTIO-IN 2,5/3 OG



3244559

<https://www.phoenixcontact.com/us/products/3244559>

Zack Marker strip, flat

Zack Marker strip, flat - ZBF 5,LGS:FORTL.ZAHLEN - 0808671

<https://www.phoenixcontact.com/us/products/0808671>



Zack Marker strip, flat, Strip, white, labeled, printed horizontally: consecutive numbers 1 ... 10, 11 ... 20, etc. up to 491 ... 500, mounting type: snapped, for terminal block width: 5 mm, lettering field size: 5.15 x 5.15 mm, Number of individual labels: 10

Zack Marker strip, flat

Zack Marker strip, flat - ZBF 5,QR:FORTL.ZAHLEN - 0808697

<https://www.phoenixcontact.com/us/products/0808697>



Zack Marker strip, flat, Strip, white, labeled, Printed vertically: consecutive numbers 1 ... 10, 11 ... 20, etc. up to 91 ... 100, mounting type: snapped, for terminal block width: 5 mm, lettering field size: 5.15 x 5.15 mm, Number of individual labels: 10

Sensor/actuator terminal block - PTIO-IN 2,5/3 OG



3244559

<https://www.phoenixcontact.com/us/products/3244559>

Zack Marker strip, flat

Zack Marker strip, flat - ZBF 5,LGS:GERADE ZAHLEN - 0810821

<https://www.phoenixcontact.com/us/products/0810821>



Zack Marker strip, flat, Strip, white, labeled, printed horizontally: consecutive even numbers 2 ... 20, 22 ... 40, etc. up to 82 ... 100, mounting type: snapped, for terminal block width: 5 mm, lettering field size: 5.15 x 5.15 mm, Number of individual labels: 10

Zack Marker strip, flat

Zack Marker strip, flat - ZBF 5,LGS:UNGERADE ZAHLEN - 0810863

<https://www.phoenixcontact.com/us/products/0810863>



Zack Marker strip, flat, Strip, white, labeled, printed horizontally: Odd numbers 1 - 19, 21 - 39, etc. up to 81 - 99, mounting type: snapped, for terminal block width: 5 mm, lettering field size: 5.15 x 5.15 mm, Number of individual labels: 10

Sensor/actuator terminal block - PTIO-IN 2,5/3 OG



3244559

<https://www.phoenixcontact.com/us/products/3244559>

Marker for terminal blocks

Marker for terminal blocks - UC-TMF 5 - 0818153

<https://www.phoenixcontact.com/us/products/0818153>



Marker for terminal blocks, Sheet, white, unlabeled, can be labeled with: BLUEMARK ID COLOR, BLUEMARK ID, BLUEMARK CLED, PLOTMARK, CMS-P1-PLOTTER, mounting type: snapped, for terminal block width: 5.2 mm, lettering field size: 4.6 x 5.1 mm, Number of individual labels: 96

Marker for terminal blocks

Marker for terminal blocks - UC-TMF 5 CUS - 0824638

<https://www.phoenixcontact.com/us/products/0824638>



Marker for terminal blocks, can be ordered: by sheet, white, labeled according to customer specifications, mounting type: snap into flat marker groove, for terminal block width: 5.2 mm, lettering field size: 4.6 x 5.1 mm, Number of individual labels: 96

Sensor/actuator terminal block - PTIO-IN 2,5/3 OG



3244559

<https://www.phoenixcontact.com/us/products/3244559>

Marker for terminal blocks

Marker for terminal blocks - UCT-TMF 5 - 0828744

<https://www.phoenixcontact.com/us/products/0828744>



Marker for terminal blocks, Sheet, white, unlabeled, can be labeled with: TOPMARK NEO, TOPMARK LASER, BLUEMARK ID COLOR, BLUEMARK ID, BLUEMARK CLED, THERMOMARK PRIME, THERMOMARK CARD 2.0, THERMOMARK CARD, mounting type: snapped, for terminal block width: 5.2 mm, lettering field size: 4.4 x 4.7 mm, Number of individual labels: 72

Marker for terminal blocks

Marker for terminal blocks - UCT-TMF 5 CUS - 0829658

<https://www.phoenixcontact.com/us/products/0829658>



Marker for terminal blocks, can be ordered: by sheet, white, labeled according to customer specifications, mounting type: snap into flat marker groove, for terminal block width: 5.2 mm, lettering field size: 4.4 x 4.7 mm, Number of individual labels: 72

Sensor/actuator terminal block - PTIO-IN 2,5/3 OG



3244559

<https://www.phoenixcontact.com/us/products/3244559>

Zack marker strip

Zack marker strip - ZB 5 :UNBEDRUCKT - 1050004

<https://www.phoenixcontact.com/us/products/1050004>

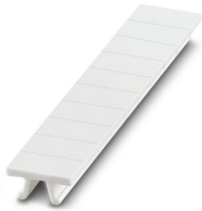

Zack marker strip, Strip, white, unlabeled, can be labeled with: PLOTMARK, CMS-P1-PLOTTER, mounting type: snapped, for terminal block width: 5.2 mm, lettering field size: 5.1 x 10.5 mm, Number of individual labels: 10

Zack marker strip

Zack marker strip - ZB 5 CUS - 0824962

<https://www.phoenixcontact.com/us/products/0824962>



Zack marker strip, can be ordered: Strip, white, labeled according to customer specifications, mounting type: snap into tall marker groove, for terminal block width: 5.2 mm, lettering field size: 5.15 x 10.5 mm, Number of individual labels: 10

Sensor/actuator terminal block - PTIO-IN 2,5/3 OG



3244559

<https://www.phoenixcontact.com/us/products/3244559>

Zack marker strip

Zack marker strip - ZB 5,LGS:FORTL.ZAHLEN - 1050017

<https://www.phoenixcontact.com/us/products/1050017>



Zack marker strip, Strip, white, labeled, printed horizontally: consecutive numbers 1 ... 10, 11 ... 20, etc. up to 491 ... 500, mounting type: snapped, for terminal block width: 5.2 mm, lettering field size: 5.15 x 10.5 mm, Number of individual labels: 10

Zack marker strip

Zack marker strip - ZB 5,QR:FORTL.ZAHLEN - 1050020

<https://www.phoenixcontact.com/us/products/1050020>

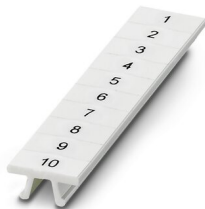

Zack marker strip, white, Printed vertically: consecutive numbers 1 ... 10, 11 ... 20, etc. up to 491 ... 500, mounting type: snapped, for terminal block width: 5.2 mm, lettering field size: 5.15 x 10.5 mm

Sensor/actuator terminal block - PTIO-IN 2,5/3 OG



3244559

<https://www.phoenixcontact.com/us/products/3244559>

Zack marker strip

Zack marker strip - ZB 5,LGS:GLEICHE ZAHLEN - 1050033

<https://www.phoenixcontact.com/us/products/1050033>



Zack marker strip, Strip, white, labeled, can be labeled with: CMS-P1-PLOTTER, printed horizontally: Identical numbers 1 or 2, etc. up to 100, mounting type: snapped, for terminal block width: 5.2 mm, lettering field size: 5.15 x 10.5 mm, Number of individual labels: 10

Zack marker strip

Zack marker strip - ZB 5,LGS:L1-N,PE - 1050415

<https://www.phoenixcontact.com/us/products/1050415>

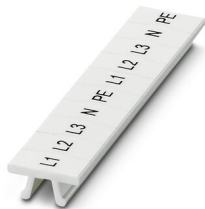

Zack marker strip, Strip, white, labeled, horizontal: L1, L2, L3, N, PE, L1, L2, L3, N, PE, mounting type: snapped, for terminal block width: 5.2 mm, lettering field size: 5.15 x 10.5 mm, Number of individual labels: 10

Sensor/actuator terminal block - PTIO-IN 2,5/3 OG



3244559

<https://www.phoenixcontact.com/us/products/3244559>

Marker for terminal blocks

Marker for terminal blocks - UC-TM 5 - 0818108

<https://www.phoenixcontact.com/us/products/0818108>



Marker for terminal blocks, Sheet, white, unlabeled, can be labeled with: BLUEMARK ID COLOR, BLUEMARK ID, BLUEMARK CLED, PLOTMARK, CMS-P1-PLOTTER, mounting type: snapped, for terminal block width: 5.2 mm, lettering field size: 10.5 x 4.6 mm, Number of individual labels: 96

Marker for terminal blocks

Marker for terminal blocks - UC-TM 5 CUS - 0824581

<https://www.phoenixcontact.com/us/products/0824581>



Marker for terminal blocks, can be ordered: by sheet, white, labeled according to customer specifications, mounting type: snap into tall marker groove, for terminal block width: 5.2 mm, lettering field size: 10.5 x 4.6 mm, Number of individual labels: 96

Sensor/actuator terminal block - PTIO-IN 2,5/3 OG



3244559

<https://www.phoenixcontact.com/us/products/3244559>

Marker for terminal blocks

Marker for terminal blocks - UCT-TM 5 - 0828734

<https://www.phoenixcontact.com/us/products/0828734>



Marker for terminal blocks, Sheet, white, unlabeled, can be labeled with: TOPMARK NEO, TOPMARK LASER, BLUEMARK ID COLOR, BLUEMARK ID, BLUEMARK CLED, THERMOMARK PRIME, THERMOMARK CARD 2.0, THERMOMARK CARD, mounting type: snapped, for terminal block width: 5.2 mm, lettering field size: 4.6 x 10.5 mm, Number of individual labels: 72

Marker for terminal blocks

Marker for terminal blocks - UCT-TM 5 CUS - 0829595

<https://www.phoenixcontact.com/us/products/0829595>



Marker for terminal blocks, can be ordered: by sheet, white, labeled according to customer specifications, mounting type: snap into tall marker groove, for terminal block width: 5.2 mm, lettering field size: 4.6 x 10.5 mm, Number of individual labels: 72

Sensor/actuator terminal block - PTIO-IN 2,5/3 OG



3244559

<https://www.phoenixcontact.com/us/products/3244559>

Test plugs

Test plugs - MPS-MT - 0201744

<https://www.phoenixcontact.com/us/products/0201744>



Test plugs, with solder connection up to 1 mm² conductor cross section, color: gray

Insulating sleeve

Insulating sleeve - MPS-IH WH - 0201663

<https://www.phoenixcontact.com/us/products/0201663>

Insulating sleeve, color: white



Sensor/actuator terminal block - PTIO-IN 2,5/3 OG



3244559

<https://www.phoenixcontact.com/us/products/3244559>

Insulating sleeve

Insulating sleeve - MPS-IH RD - 0201676

<https://www.phoenixcontact.com/us/products/0201676>

Insulating sleeve, color: red



Insulating sleeve

Insulating sleeve - MPS-IH BU - 0201689

<https://www.phoenixcontact.com/us/products/0201689>

Insulating sleeve, color: blue

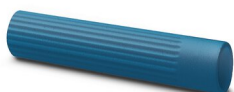

Sensor/actuator terminal block - PTIO-IN 2,5/3 OG



3244559

<https://www.phoenixcontact.com/us/products/3244559>

Insulating sleeve

Insulating sleeve - MPS-IH YE - 0201692

<https://www.phoenixcontact.com/us/products/0201692>

Insulating sleeve, color: yellow



Insulating sleeve

Insulating sleeve - MPS-IH GN - 0201702

<https://www.phoenixcontact.com/us/products/0201702>

Insulating sleeve, color: green



Sensor/actuator terminal block - PTIO-IN 2,5/3 OG



3244559

<https://www.phoenixcontact.com/us/products/3244559>

Insulating sleeve

Insulating sleeve - MPS-IH GY - 0201728

<https://www.phoenixcontact.com/us/products/0201728>

Insulating sleeve, color: gray



Insulating sleeve

Insulating sleeve - MPS-IH BK - 0201731

<https://www.phoenixcontact.com/us/products/0201731>

Insulating sleeve, color: black



Sensor/actuator terminal block - PTIO-IN 2,5/3 OG



3244559

<https://www.phoenixcontact.com/us/products/3244559>

Software

Software - PROJECT COMPLETE - 1050453

<https://www.phoenixcontact.com/us/products/1050453>



Intuitive planning and marking software for configuring terminal strips and for professional marking of marking materials for terminal blocks, conductors, cables, devices, and systems. The software is available for download

End clamp

End clamp - CLIPFIX 35 - 3022218

<https://www.phoenixcontact.com/us/products/3022218>



Quick mounting end clamp for NS 35/7,5 DIN rail or NS 35/15 DIN rail, with marking option, width: 9.5 mm, color: gray

Sensor/actuator terminal block - PTIO-IN 2,5/3 OG



3244559

<https://www.phoenixcontact.com/us/products/3244559>

End clamp

End clamp - CLIPFIX 35-5 - 3022276

<https://www.phoenixcontact.com/us/products/3022276>



Quick mounting end clamp for NS 35/7,5 DIN rail or NS 35/15 DIN rail, with marking option, with parking option for FBS...5, FBS...6, KSS 5, KSS 6, width: 5.15 mm, color: gray

End clamp

End clamp - E/NS 35 N - 0800886

<https://www.phoenixcontact.com/us/products/0800886>

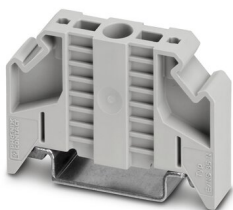

End clamp, width: 9.5 mm, color: gray

Sensor/actuator terminal block - PTIO-IN 2,5/3 OG



3244559

<https://www.phoenixcontact.com/us/products/3244559>

Test plugs

Test plugs - PS-3,5 - 3031010

<https://www.phoenixcontact.com/us/products/3031010>



Test plugs, Modular test plug, color: red

Spacer plate

Spacer plate - DP PS-3,5 - 3031011

<https://www.phoenixcontact.com/us/products/3031011>



Spacer plate, length: 15.9 mm, width: 3.5 mm, height: 33.5 mm, number of positions: 1, color: red

Sensor/actuator terminal block - PTIO-IN 2,5/3 OG

3244559

<https://www.phoenixcontact.com/us/products/3244559>

Test plugs

Test plugs - PS-3,5/E - 3031012

<https://www.phoenixcontact.com/us/products/3031012>



Test plugs, Individual test plug, color: red

Crimping pliers

Crimping pliers - CRIMPFOX CENTRUS 6S - 1213144

<https://www.phoenixcontact.com/us/products/1213144>



Crimping pliers, for uninsulated and insulated ferrules, DIN 46228 Part 1 and 4, from 0.14 mm² ... 6 mm², also for TWIN ferrules up to 2 x 4 mm², automatic cross section adjustment, lateral insertion, equipped with fall protection

Sensor/actuator terminal block - PTIO-IN 2,5/3 OG



3244559

<https://www.phoenixcontact.com/us/products/3244559>

Crimping pliers

Crimping pliers - CRIMPFOX CENTRUS 10S - 1213154

<https://www.phoenixcontact.com/us/products/1213154>



Crimping pliers, for uninsulated and insulated ferrules, DIN 46228 Part 1 and 4, from 0.14 mm² ... 10 mm², also for TWIN ferrules up to 2 x 4 mm², automatic cross section adjustment, lateral insertion, equipped with fall protection

Crimping pliers

Crimping pliers - CRIMPFOX CENTRUS 6H - 1213146

<https://www.phoenixcontact.com/us/products/1213146>



Crimping pliers, for uninsulated and insulated ferrules, DIN 46228 Part 1 and 4, from 0.14 mm² ... 6 mm², also for TWIN ferrules up to 2 x 4 mm², automatic cross section adjustment, lateral insertion, equipped with fall protection

Sensor/actuator terminal block - PTIO-IN 2,5/3 OG



3244559

<https://www.phoenixcontact.com/us/products/3244559>

Crimping pliers

Crimping pliers - CRIMPFOX CENTRUS 10H - 1213156

<https://www.phoenixcontact.com/us/products/1213156>



Crimping pliers, for uninsulated and insulated ferrules, DIN 46228 Part 1 and 4, from 0.14 mm² ... 10 mm², also for TWIN ferrules up to 2 x 4 mm², automatic cross section adjustment, lateral insertion, equipped with fall protection

Crimping pliers

Crimping pliers - CRIMPFOX 10S - 1212045

<https://www.phoenixcontact.com/us/products/1212045>



Crimping pliers, for ferrules without insulating collar according to DIN 46228 Part 1 and ferrules with insulating collar according to DIN 46228 Part 4, 0.14 mm² ... 10 mm², unlockable pressure lock, lateral entry

Sensor/actuator terminal block - PTIO-IN 2,5/3 OG

3244559

<https://www.phoenixcontact.com/us/products/3244559>

Crimping pliers

Crimping pliers - CRIMPFOX 6H - 1212046

<https://www.phoenixcontact.com/us/products/1212046>



Crimping pliers, for ferrules without insulating collar according to DIN 46228 Part 1 and ferrules with insulating collar according to DIN 46228 Part 4, 0.14 mm² ... 6 mm², unlockable pressure lock, lateral entry

Crimping pliers

Crimping pliers - CRIMPFOX 2,5-M - 1212719

<https://www.phoenixcontact.com/us/products/1212719>



Crimping pliers, for ferrules without insulating collar according to DIN 46228 Part 1 and ferrules with insulating collar according to DIN 46228 Part 4, 0.25 mm² ... 2.5 mm², lateral entry, trapezoidal crimp

Sensor/actuator terminal block - PTIO-IN 2,5/3 OG



3244559

<https://www.phoenixcontact.com/us/products/3244559>

Crimping pliers

Crimping pliers - CRIMPFOX 6-M - 1212720

<https://www.phoenixcontact.com/us/products/1212720>



Crimping pliers, for ferrules without insulating collar according to DIN 46228 Part 1 and ferrules with insulating collar according to DIN 46228 Part 4, 0.25 mm² ... 6.0 mm², lateral entry, trapezoidal crimp

Crimping pliers

Crimping pliers - CRIMPFOX 6 - 1212034

<https://www.phoenixcontact.com/us/products/1212034>



Crimping pliers, for ferrules without insulating collar according to DIN 46228 Part 1 and ferrules with insulating collar according to DIN 46228 Part 4, 0.25 mm² ... 6.0 mm², lateral entry, trapezoidal crimp

Sensor/actuator terminal block - PTIO-IN 2,5/3 OG



3244559

<https://www.phoenixcontact.com/us/products/3244559>

Crimping pliers

Crimping pliers - CRIMPFOX 6T - 1212037

<https://www.phoenixcontact.com/us/products/1212037>



Crimping pliers, for ferrules without insulating collar according to DIN 46228 Part 1 and ferrules with insulating collar according to DIN 46228 Part 4, 0.25 mm² ... 6 mm², lateral entry, trapezoidal crimp

Crimping pliers

Crimping pliers - CRIMPFOX 6T-F - 1212038

<https://www.phoenixcontact.com/us/products/1212038>



Crimping pliers, for ferrules without insulating collar according to DIN 46228 Part 1 and ferrules with insulating collar according to DIN 46228 Part 4, 0.25 mm² ... 6 mm², front entry, trapezoidal crimp

Sensor/actuator terminal block - PTIO-IN 2,5/3 OG



3244559

<https://www.phoenixcontact.com/us/products/3244559>

Crimping pliers

Crimping pliers - CRIMPFOX 6S-F - 1212043

<https://www.phoenixcontact.com/us/products/1212043>



Crimping pliers, for ferrules without insulating collar according to DIN 46228 Part 1 and ferrules with insulating collar according to DIN 46228 Part 4, 0.5 mm² ... 6 mm², front entry, square crimp

Crimping pliers

Crimping pliers - CRIMPFOX-M - 1212072

<https://www.phoenixcontact.com/us/products/1212072>



Basic pliers, for accommodating dies for a wide range of type of contacts

Sensor/actuator terminal block - PTIO-IN 2,5/3 OG



3244559

<https://www.phoenixcontact.com/us/products/3244559>

Sensor/actuator terminal block

Sensor/actuator terminal block - PTIO 1,5/S/3 - 3244410

<https://www.phoenixcontact.com/us/products/3244410>

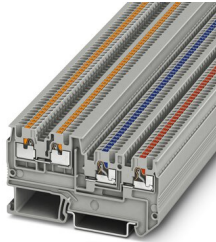

Sensor/actuator terminal block, nom. voltage: 250 V, nominal current: 13.5 A, connection method: Push-in connection, Rated cross section: 1.5 mm², cross section: 0.14 mm² - 1.5 mm², mounting type: NS 35/7,5, NS 35/15, color: gray

Sensor/actuator terminal block

Sensor/actuator terminal block - PTIO 1,5/S/3-LED 24 GN - 3244436

<https://www.phoenixcontact.com/us/products/3244436>

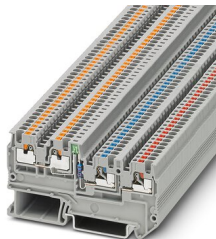

Sensor/actuator terminal block, with green light indicator, nom. voltage: 250 V, nominal current: 13.5 A, connection method: Push-in connection, Rated cross section: 1.5 mm², cross section: 0.14 mm² - 1.5 mm², mounting type: NS 35/7,5, NS 35/15, color: gray

Sensor/actuator terminal block - PTIO-IN 2,5/3 OG



3244559

<https://www.phoenixcontact.com/us/products/3244559>

Sensor/actuator terminal block

Sensor/actuator terminal block - PTIO-IN 2,5/3-LED 24 GN - 3244561

<https://www.phoenixcontact.com/us/products/3244561>



Sensor/actuator terminal block, Power terminal, nom. voltage: 24 V, nominal current: 13.5 A, connection method: Push-in connection, Rated cross section: 2.5 mm², cross section: 0.2 mm² - 4 mm², mounting type: NS 35/7,5, NS 35/15, color: orange

Sensor/actuator terminal block

Sensor/actuator terminal block - PTIO 1,5/S/3-LED 24 RD - 3244423

<https://www.phoenixcontact.com/us/products/3244423>



Sensor/actuator terminal block, with red light indicator, nom. voltage: 250 V, nominal current: 13.5 A, connection method: Push-in connection, Rated cross section: 1.5 mm², cross section: 0.14 mm² - 1.5 mm², mounting type: NS 35/7,5, NS 35/15, color: gray

Phoenix Contact 2022 © - all rights reserved
<https://www.phoenixcontact.com>

Phoenix Contact USA
586 Fulling Mill Road
Middletown, PA 17057, United States
(+717) 944-1300
info@phoenixcon.com