

LOC		DIST		REVISIONS			
P	LTR	DESCRIPTION	DATE	DWN	APVD		
	V	INITIAL RELEASE	03APR2018	JA	DM		
	VI	ADD NOTE 15	11APR2018	JA	DM		

SOLID CONT. SIZE	SOLID CONTACT PART NO's (PARTIAL LIST)		WIRE SIZE AWG [mm ²]	RECOMMENDED STRIP LENGTH INCHES [mm]	MIN CONT. RETENTION LBS [N]	REF CRIMP TENSILE LBS [N]	MAX RATED AMPS@125°C CONTINUOUS
	PIN	SOCKET					
4	5960-203-04XX	5962-203-04XX	4 [25.0-21.0]	.430-.492 [10.92-12.50]	35 [156]	300 [1334]	100
4	0460-204-04XX	0462-203-04XX	6 [16.0-13.0]	.430-.492 [10.92-12.50]	35 [156]	300 [1334]	100
8	0460-204-08XX	0462-203-08XX	8-10 [10.0-5.0]	.430-.492 [10.92-12.50]	35 [156]	125-90 [556-400]	60
12	0460-204-12XX	0462-203-12XX	12-14 [3.0-2.0]	.222-.284 [5.64-7.21]	30 [134]	75-70 [334-311]	25
16	0460-002-16XX	0462-004-16XX	16-20 [1.5-0.5]	.250-.312 [6.35-7.92]	25 [111]	35-20 [156-89]	13
16	0460-215-16XX	0462-209-16XX	14 [2.0]	.250-.312 [6.35-7.92]	25 [111]	70 [311]	13
16	0460-202-16XX	0462-201-16XX	16-20 [1.5-0.5]	.250-.312 [6.35-7.92]	25 [111]	35-20 [156-89]	13
16	2325529-1	2325584-1	16-20 [1.5-0.5]	.250-.312 [6.35-7.92]	25 [111]	35-20 [156-89]	13
20	0460-010-20XX	0462-005-20XX	16-18 [1.0-0.75]	.156-.218 [3.96-5.54]	20 [89]	20 [89]	7.5
20	0460-202-20XX	0462-201-20XX	20 [0.5]	.156-.218 [3.96-5.54]	20 [89]	20 [89]	7.5
20	2325531-1	2325530-1	20 [0.5]	.156-.218 [3.96-5.54]	20 [89]	20 [89]	7.5

CONTACT RESISTANCE STRENGTH			
WIRE AWG	TEST CURRENT	MILLIVOLT DROP SOLID	MILLIVOLT DROP S & F
4	100	60	N/A
8	60	60	N/A
10	40	60	N/A
10	25	N/A	100
12	25	60	100
14	18	60	100
16	13	60	100
18	10	60	100
20	7.5	60	100

LESS REFERENCE(DROP-THRU) WIRE

MATERIAL SPECIFICATION AND PLATING XX CODES

PIN: COPPER ALLOY
 SOCKET: COPPER ALLOY with STAINLESS STEEL SLEEVE

SOLID PLATING OPTIONS:

31=GOLD
 90 OR 141=NICKEL SIZE 4 [6 AWG] PIN ONLY
 141=NICKEL
 309=TIN

S & F PLATING OPTIONS:

22=NICKEL
 44=GOLD
 66=TIN/NICKEL
 77=TIN
 88=SELECTIVE GOLD

GOLD PLATING IS RECOMMENDED FOR DRY CIRCUIT APPLICATION = (<5V & <50mA)

MATERIALS AND PLATINGS ARE RoHS COMPLIANT

- 0460-204-12XX COMES IN NICKEL PLATE ONLY. USE 0460-220-12XX FOR GOLD PLATE.
 - DEUTSCH PERFORMANCE SPECIFICATIONS REQUIRE THE USE OF DEUTSCH APPROVED TOOLING.
 - 8. SEE SHEET 2 FOR STAMPED AND FORMED CONTACTS.
 - CONTACT FACTORY FOR AVAILABLE PLATING FOR SPECIFIC CONTACTS.
 - NOTED MAXIMUM RATED CURRENT DEPENDS ON CONTACT SIZE. ACTUAL RATED CURRENT DEPENDS ON WIRE SIZE.
 - WIRE AND INSULATION RANGES ARE FOR REFERENCE ONLY. ACTUAL INSULATION RANGE DEPENDS ON CONNECTOR GROMMET. THE FOLLOWING CRIMP INFORMATION DRAWINGS ARE THE CONTROLLING DOCUMENTS:

"SOLID" CONTACTS:	SIZE	"STAMPED" CONTACTS:	SIZE
	0425-205-0000 4-20		114-151006 12
			114-151002 12
			114-151000 OR 114-151001 16
			114-151003 20
 - PULL RATE OF 1.0 INCH [25.4] PER MINUTE MAXIMUM. ACTUAL STRENGTH DEPENDS ON WIRE SIZE.
 - THIS CONTACT IS A SLEEVELESS SOCKET DESIGN.
 - 2. FORCES ARE IN "LBS" (POUNDS) AND "[N]" (NEWTONS).
 - CONSULT FACTORY FOR MORE INFORMATION. SEE CRIMP INFORMATION DRAWINGS FOR MORE PART NUMBERS.
- UNLESS OTHERWISE SPECIFIED N/A: Not Applicable

- 15. INSERTION TOOL MAY BE NEEDED ON DEUTSCH CONNECTORS THAT HAVE SIZE 16 & 20 CONTACTS WITH ≤ 20AWG WIRE. INSERTION TOOL PN MI5570-16 (SIZE 16) OR MI5570-20 (SIZE 20).
- PN 2325529-1 (PIN) IS GOLD PLATED AND IDENTIFIED BY BROWN, BROWN, BROWN STRIPES. PN 2325584-1 (SOCKET) IS GOLD PLATED AND IDENTIFIED BY BROWN, BROWN, BLUE STRIPES. PN 2325531-1 (PIN) IS GOLD PLATED AND IDENTIFIED BY BROWN, BROWN, BLACK STRIPES. PN 2325530-1 (SOCKET) IS GOLD PLATED AND IDENTIFIED BY BROWN, BROWN, GREEN STRIPES.
- THIS CONTACT IS IDENTIFIED BY ONE PURPLE STRIPE.
- THIS CONTACT IS USED FOR HIGH DURABILITY APPLICATIONS. IDENTIFIED BY ONE BLUE STRIPE.
- THIS CONTACT IS AN ULTRASONIC DESIGN.

THIS DRAWING IS A CONTROLLED DOCUMENT.		DWN B. BYFORD 26MAY2000	TE Connectivity													
DIMENSIONS: INCHES [mm]		CHK D. MEYER 25JUN2012														
TOLERANCES UNLESS OTHERWISE SPECIFIED:		APVD R. REED 02JUL2012	NAME PERFORMANCE AND APPLICATION CHAR OF SOLID OR STAMPED AND FORMED CONT AND APPLICABLE WIRE RANGES													
<table border="0"> <tr><td>0 PLC</td><td>±</td></tr> <tr><td>1 PLC</td><td>±</td></tr> <tr><td>2 PLC</td><td>±</td></tr> <tr><td>3 PLC</td><td>±</td></tr> <tr><td>4 PLC</td><td>±</td></tr> <tr><td>ANGLES</td><td>±</td></tr> </table>		0 PLC	±	1 PLC	±	2 PLC	±	3 PLC	±	4 PLC	±	ANGLES	±	PRODUCT SPEC	SIZE A3	CAGE CODE 4AFU8
0 PLC	±															
1 PLC	±															
2 PLC	±															
3 PLC	±															
4 PLC	±															
ANGLES	±															
MATERIAL		FINISH	DRAWING NO C=0425-015-0000	RESTRICTED TO -												
		WEIGHT	SCALE NONE	SHEET 1 OF 2												
		STANDARD SPECIFICATION	REV VI													

THIS DRAWING IS UNPUBLISHED.

RELEASED FOR PUBLICATION

2018

LOC

DIST

REVISIONS

© COPYRIGHT 2000 BY TE CONNECTIVITY

ALL RIGHTS RESERVED.

P	LTR	DESCRIPTION	DATE	DWN	APVD
	-	SEE SHEET 1	-	-	-

S & F CONT. SIZE	STAMPED CONTACT PART NO's (PARTIAL LIST)		WIRE SIZE AWG [mm ²]	WIRE INSULATION O.D. RANGE	RECOMMENDED STRIP LENGTH INCHES [mm]	MIN CONT. RETENTION LBS [N]	REF CRIMP TENSILE LBS [N]	MAX RATED AMPS@125°C CONTINUOUS
	PIN	SOCKET						
12	1060-12-01XX	1062-12-01XX	12-14 [4.0-2.0]	.113-.176 [2.87-4.47]	.250-.300 [6.35-7.62]	30 [134]	70 [311]	25
12	1060-12-02XX	1062-12-02XX	10 [6.0-4.0]	.140-.204 [3.56-5.18]	.250-.300 [6.35-7.62]	30 [134]	70 [311]	25
16	1060-14-01XX	1062-14-01XX	14-18 [2.0-0.75]	.095-.150 [2.41-3.81]	.150-.200 [3.81-5.08]	25 [111]	25 [111]	13
16	1060-14-10XX	1062-14-10XX	14-18 [2.0-0.75]	.095-.150 [2.41-3.81]	.150-.200 [3.81-5.08]	25 [111]	25 [111]	13
16	1060-16-01XX	1062-16-01XX	14-18 [2.0-0.75]	.075-.140 [1.90-3.55]	.150-.200 [3.81-5.08]	25 [111]	25 [111]	13
16	1060-16-06XX	1062-16-06XX	16-20 [1.0-0.5]	.055-.100 [1.40-2.54]	.150-.200 [3.81-5.08]	25 [111]	25-15 [111-67]	13
16	1060-16-07XX	1062-16-07XX	14-18 [2.0-0.75]	.075-.140 [1.90-3.55]	.150-.200 [3.81-5.08]	25 [111]	25 [111]	13
16	1060-16-09XX	1062-16-09XX	14-18 [2.0-0.75]	.075-.140 [1.90-3.55]	.150-.200 [3.81-5.08]	25 [111]	25 [111]	13
16	1060-16-12XX	1062-16-12XX	12-16 [2.5-1.0]	.075-.140 [1.90-3.55]	.175-.225 [4.45-5.72]	25 [111]	25 [111]	13
16	1060-16-13XX	1062-16-13XX	14-18 [2.0-1.0]	.085-.150 [2.16-3.81]	.210-.230 [5.33-5.84]	25 [111]	25 [111]	13
16	N/A	1062-16-14XX	12-16 [2.5-1.0]	.075-.140 [1.90-3.55]	.175-.225 [4.45-5.72]	25 [111]	25 [111]	13
20	1060-20-01XX	1062-20-01XX	16-22 [1.5-0.35]	.075-.125 [1.91-3.18]	.150-.200 [3.81-5.08]	20 [89]	20-10 [89-45]	7.5
20	1060-20-02XX	1062-20-02XX	16-22 [1.5-0.35]	.051-.085 [1.30-2.16]	.150-.200 [3.81-5.08]	20 [89]	20-10 [89-45]	7.5
20	N/A	1062-20-03XX	16-22 [1.5-0.35]	.075-.125 [1.91-3.18]	.150-.200 [3.81-5.08]	20 [89]	20-10 [89-45]	7.5
20	1060-20-06XX	1062-20-06XX	14-16 [2.5-1.0]	.075-.125 [1.91-3.18]	.150-.200 [3.81-5.08]	20 [89]	20 [89]	7.5



THIS DRAWING IS A CONTROLLED DOCUMENT.

DWN B. BYFORD 26MAY2000

CHK D. MEYER 25JUN2012

APVD R. REED 02JUL2012

PRODUCT SPEC

APPLICATION SPEC

WEIGHT

STANDARD SPECIFICATION

DIMENSIONS:

INCHES [mm]

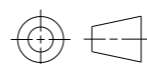

TOLERANCES UNLESS OTHERWISE SPECIFIED:

- 0 PLC ±
- 1 PLC ±
- 2 PLC ±
- 3 PLC ±
- 4 PLC ±
- ANGLES ±

MATERIAL

FINISH



TE Connectivity

NAME PERFORMANCE AND APPLICATION CHAR OF SOLID OR STAMPED AND FORMED CONT AND APPLICABLE WIRE RANGES

SIZE CAGE CODE DRAWING NO RESTRICTED TO

A3 4AFU8 C=0425-015-0000 -

SCALE NONE SHEET 2 OF 2 REV VI

SEE SHEET 1 FOR SOLID CONTACTS.