

PRODUCT NUMBER
71600-YXXXXLF

LEAD FREE, SEE NOTE 6
 COLOR OPTION, SEE NOTE 1
 TOTAL NB OF POSITION 04 TO 64
 SEE SHEET 2
 OPTIONAL STRAIN RELIEF
 SEE SHEET 2

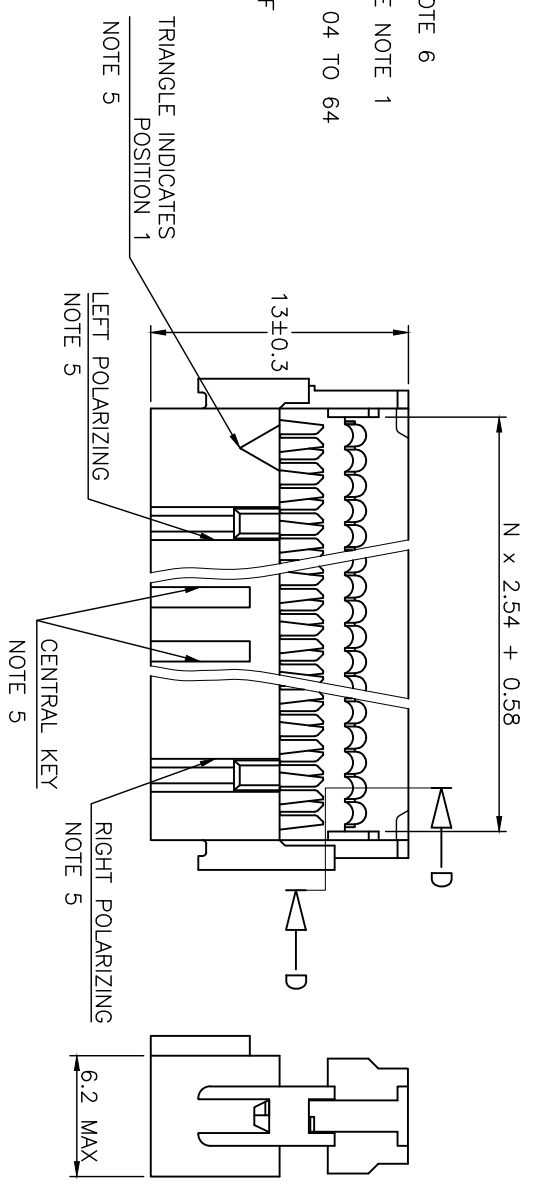

- NOTES:
- HOUSING MATERIAL : GLASS FILLED THERMOPLASTIC. UL94V-0 COLOR: GREY
 = STANDARD COLOR GREY
 B = OPTION COLOR BLACK
 - PIN MATERIAL : PHOSPHOR BRONZE
 - PRODUCT PACKAGED IN TUBES.
 - TO DETERMINE DIMENSIONS :
 N = NUMBER OF POSITIONS PER ROW
 EXAMPLE : 8 POS N x 2.54 = 20.32mm
 - 2x5, 2x6, 2x7 HAVE NO LEFT POLARIZING SLOT.
 2x2, 2x3 WITH CENTRAL KEY HAVE NO TRIANGLE, NO LEFT AND RIGHT POLARIZING SLOT.
 2x2 WITHOUT CENTRAL KEY HAS NO LEFT AND RIGHT POLARIZING SLOT.
 2x3, 2x4 WITHOUT CENTRAL KEY HAVE NO LEFT POLARIZING SLOT
 2x4 WITH CENTRAL KEY HAVE NO LEFT AND RIGHT POLARIZING SLOT
 - THIS PRODUCT MEETS EUROPEAN UNION DIRECTIVES AND OTHER COUNTRY REGULATIONS AS PER GS-22-008.
 PACKAGING SPECIFICATION AS PER GS-14-920.

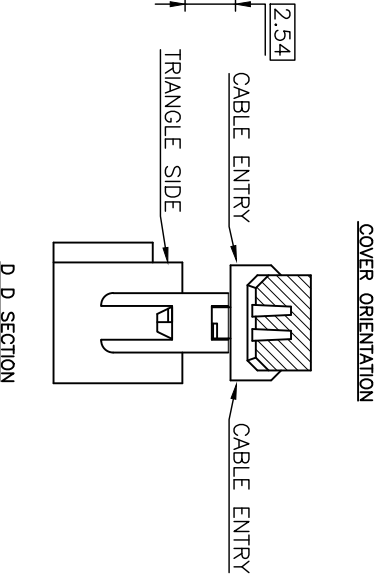
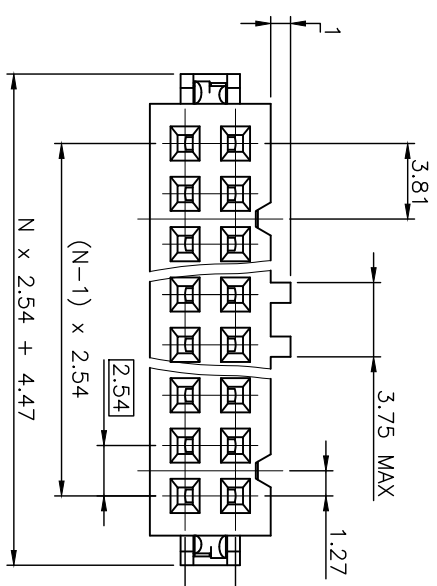

mat'l. code	surface	tolerance	projection	product family
SEE NOTES	ISO 1302	ISO 406 ISO 1101	mm	2.54MM IDC
trf ecn no	trf dr date	tolerances unless otherwise specified	mm	title
AP F12-0048LMU	12.04.25	XXX ±0.3	mm	QUICKIE III FEM
AR B-17851LMU	14.06.05	linear XXX ±0.13	mm	0.76µm Au
AS F-26816 LMU	17.06.06	XXXX ±0.05	scale 5:1	dwg no
AL F06-0274LMU	06.09.12	DLE	01.01.24	71600
AM F06-0274LMU	06.09.25	JFN	01.01.24	sheet 1 of 2
AN F09-0233LMU	09.12.15	P.NZ	01.01.24	A3
Sheet revision	AS AG			CUSTOMER Drawing
Index Sheet	1 2			

STRAIN RELIEF OPTION AVAILABILITY	Nbr OF POSITIONS
1/6	04
0/1/2/3/6	06
0/1/2/3/6	08
0/1/2/3/6	10
0/1/2/3/6	14
0/1/2/3/6	16
0/1/2/3/6	18
0/1/2/3/6	20
0/1/3	24
0/1/2/3/6	26
0/1/2/3/6	30
0/1/2/3/6	34
0/1/2/3/6	40
0/1/2/3/6	50
0/1/2/3/6	60
0/1/2/3/6	64

624
304
204 / 224
004

DASHES NOT AVAILABLE

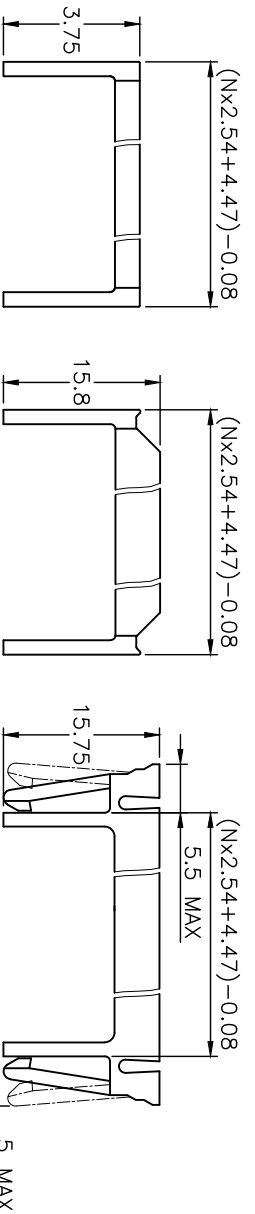

LOW PROFILE STRAIN RELIEF

STANDARD STRAIN RELIEF

LATCHING STRAIN RELIEF FOR SLIM HEADER

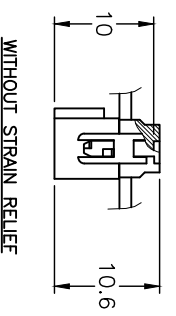

WITHOUT STRAIN RELIEF

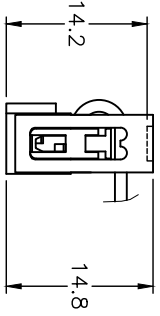

WITH LOW PROFILE STRAIN RELIEF

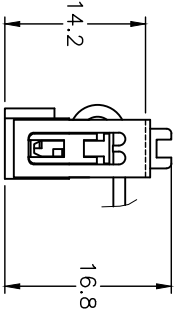

WITH STANDARD STRAIN RELIEF

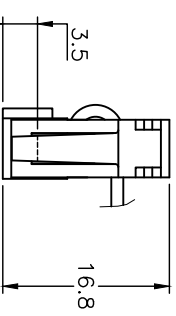

WITH LATCHING STRAIN RELIEF

PRODUCT NUMBER	WITH CENTRAL KEY	WITHOUT CENTRAL KEY	STANDARD	WITHOUT STANDARD	LOW PROFILE	LATCHING
71600-6YY(B)LF	●					●
71600-3YY(B)LF		●	●			
71600-2YY(B)LF	●					
71600-1YY(B)LF	●				●	
71600-0YY(B)LF	●		●			

mat'l. code	ISO 1302	tolerance	ISO 406	ISO 1101	projection	product family
lfr ecn no lfr date	tolerances unless otherwise specified	linear	mm	mm	QUICKIE	
AF B-17851 LMU 14.06.05	angles	linear	mm	mm	IDC RECEIPT	
AG F-26816 LMU 17.06.06	linear	linear	mm	mm	DR	
AB F03019 DLE 03.01.23 lfr	DLE	01.01.24			sheet 2 of - size	
AD F06-0180 LMU 05.04.22 leng	P.NZ	01.01.24			71600	
AD F06-0270 LMU 06.09.12 chr	JFN	01.01.24			CUSTOMER Drawing	
AE F06-0274 LMU 06.09.25 lappd	P.NZ	01.01.24				
Sheet revision						
Index sheet						