

RoHS
Compliant
Drawing For
Reference Only

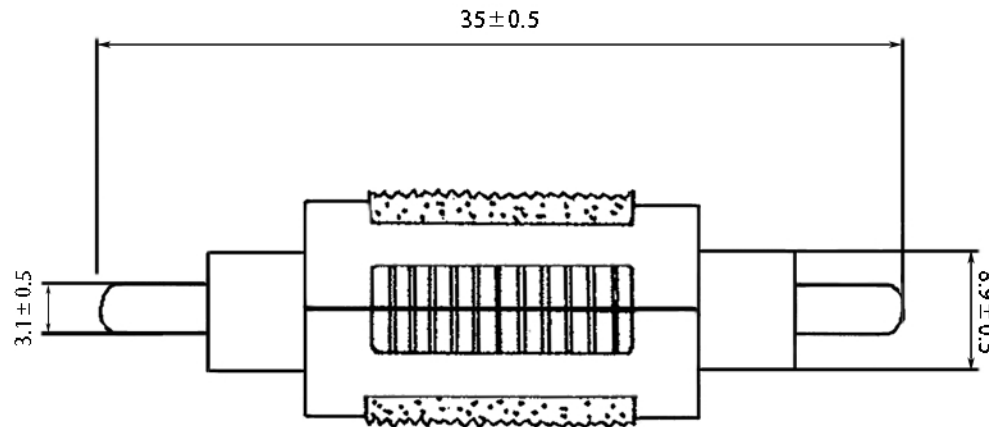

Technical requirement :

1. This product should meet EU RoHS related requirement.
2. The surface of plastic part should be without any crackle such as burr,lack,and so on phenomenon.
3. The surface of metal part should be without any defect such as scaur,nick,oxidation and plating problem.
4. The electronic performance should be the same as spec.
5. The un-specified tolerance is : <math><6\pm 0.1</math>
 $6\sim 20\pm 0.2$
 $>20\pm 0.3$

Specification :

Contact Resistance : 30m ohm max.
 Insulation Resistance : 100M ohm min. at DC 500V
 Dielectric Strength : AC 500V for 1 minute.

DCI DRAGON CITY INDUSTRIES LIMITED

			Design	K.W Law	Remark		Scale	
			Drawing	S.M Hung	Remark		Material	
Item Name	RCA Plug To RCA Plug	Tolerance :	Check	K.L Wong	Remark		Drawing No.	110131-1347
Item No.	NP-597	Unit : mm	Approval	K.W Chan	Remark		Sheet	