

1

2

3

4

5

6

7

Male

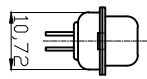
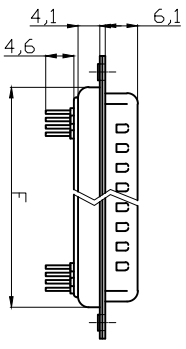
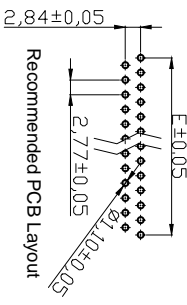
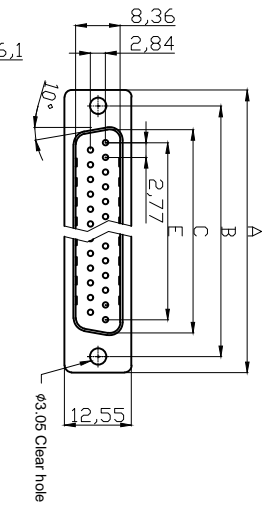

- NOTES:**
- MATERIAL**
1. Insulator Material: Glass-filled thermoplastic PBT, UL94V-0, Gray
 2. Contact Material: Brass or Phosphor Bronze
 3. Shell : Steel, 100 μ" Tin Over 50μ" min Copper
 4. Clinch Nut : Brass, Nickel Plated
 5. Contact plating : Gold flash full gold & selective 15u" Au ELECTRICAL
1. Current Rating : 3AMP
 2. Voltage Rating : 250V AC/rms 60Hz
 3. Contact Resistance: 20mΩ
 4. Insulation Resistance: 1000MΩ min at 500 VDC
 5. Withstand Voltage: 1000V AC/rms 60Hz for 1 minute ENVIRONMENTAL
1. Temperature Range: -55°C~+105°C
 - UL No. E 198287
 - Order Code:
- A-Dx xx PP/Z-x
- Contact style:
 F - Female
 S - Male
- No. of Contacts
 09 / 15 / 25 / 37 / 50
- Empty: Gold flash (quality class III)
 2: Selective 15u" Au on contact area (quality class II)
 Standard: Quality class III

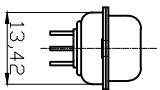
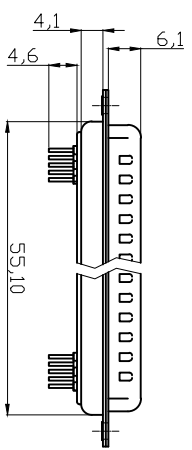
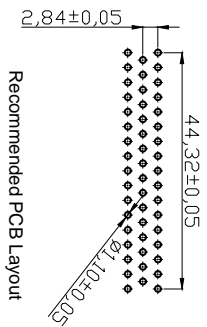
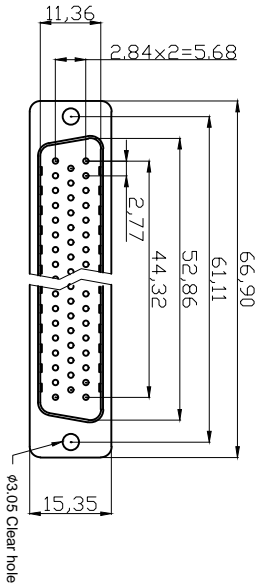

Dimensions

Positions	A	B	C	E	F
09	30.81	24.99	16.92	11.08	19.20
15	39.20	33.30	25.25	19.39	27.70
25	53.04	47.04	38.96	33.24	41.10
37	69.40	63.50	55.42	49.86	57.30
50	66.90	61.11	52.86	44.32	55.10

50 Positions

RoHS compliant

Unit:mm

Scale	Free	⑦	Update temperature range
TOLERANCE			
X.	±0.38	⑥	Update
X.X	±0.25	⑤	Add the contact plating 15u" Au
X.XX	±0.13	④	Add the detail contact plating
DIM	TOL	③	Update the dimension
X.°	±3°	②	Update the operating temperature&UL No.
X.X°	±1.0°	①	
Angle	TOL	Id.	Modification

Date	Name
11.07.2019	Xavier
18.12.2018	Xavier
01.09.2017	Winnie
23.12.2016	Winnie
27.02.2015	Winnie
04.08.2014	Winnie

Customer-No.	Drawing-No.
	ASSMANN WSW-No. A-DX XX PP/Z-X
	ASS 4885 CO
	rev07



1

2

3

4

5

6

7

Female

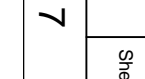
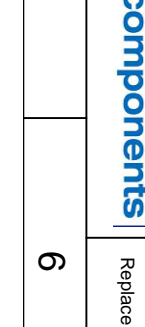
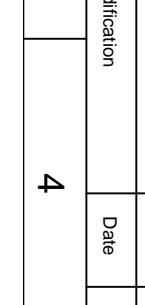
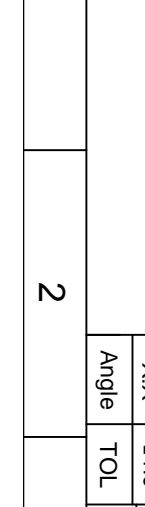

- NOTES:**
- MATERIAL**
1. Insulator Material: Glass-filled thermoplastic PBT, UL94V-0, Gray
 2. Contact Material: Brass or Phosphor Bronze
 3. Shell : Steel, 100 μ" Tin Over 50μ" min Copper
 4. Clinch Nut : Brass, Nickel Plated
 5. Contact plating : Gold flash full gold & selective 15u" Au ELECTRICAL
1. Current Rating : 3AMP
 2. Voltage Rating : 250V AC/rms 60Hz
 3. Contact Resistance: 20mΩ
 4. Insulation Resistance: 1000MΩ min at 500 VDC
 5. Withstand Voltage: 1000V AC/rms 60Hz for 1 minute ENVIRONMENTAL
1. Temperature Range: -55°C~+105°C
 - UL No. E 198287
 - Order Code:
- A-Dx xx PP/Z-x
- Contact style:
 F - Female
 S - Male
- No. of Contacts
 09 / 15 / 25 / 37 / 50
- Empty: Gold flash (quality class III)
 2: Selective 15u" Au on contact area (quality class II)
 Standard: Quality class III

Dimensions

Positions	A	B	C	E	F
09	30.81	24.99	16.92	11.08	19.20
15	39.20	33.30	25.25	19.39	27.70
25	53.04	47.04	38.96	33.24	41.10
37	69.40	63.50	55.42	49.86	57.30
50	66.90	61.11	52.86	44.32	55.10

50 Positions

RoHS compliant

Unit:mm

Scale	Free	⑦	Update temperature range
TOLERANCE			
X.	±0.38	⑥	Update
X.X	±0.25	⑤	Add the contact plating 15u" Au
X.XX	±0.13	④	Add the detail contact plating
DIM	TOL	③	Update the dimension
X.°	±3°	②	Update the operating temperature&UL No.
X.X°	±1.0°	①	
Angle	TOL	Id.	Modification

Date	Name
11.07.2019	Xavier
18.12.2018	Xavier
01.09.2017	Winnie
23.12.2016	Winnie
27.02.2015	Winnie
04.08.2014	Winnie

Customer-No.	Drawing-No.
	ASSMANN WSW-No. A-DX XX PP/Z-X
	ASS 4885 CO
	rev07

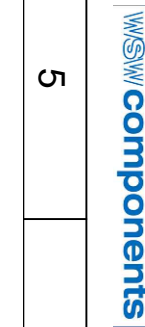

1

2

3

4

5

6

7

Female

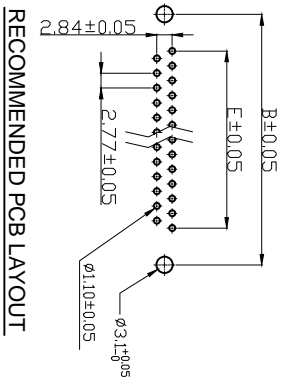
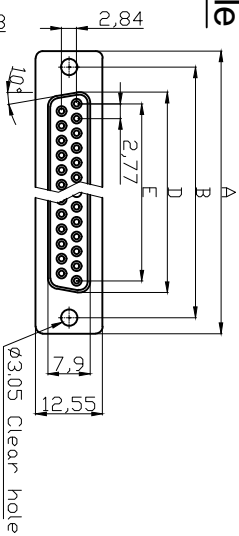

RECOMMENDED PCB LAYOUT

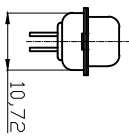
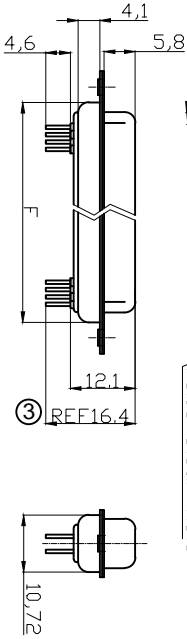

- NOTES:**
- MATERIAL**
1. Insulator Material: Glass-filled thermoplastic PBT, UL94V-0, Gray
 2. Contact Material: Copper alloy
 3. Shell : Steel, 100 μ" Tin Over 50μ" min Copper
 4. Clinch Nut : Brass, Nickel Plated
 5. Contact plating : Gold flash full gold
- ELECTRICAL**
1. Current Rating : 3AMP
 2. Voltage Rating : 250V AC/rms 60Hz
 3. Contact Resistance: 20mΩ Max at 1 AMP DC
 4. Insulation Resistance: 1000MΩ at 500 VDC
 5. Withstand Voltage: 1000V AC/rms 60Hz for 1 minute
 6. OPERATING TEMPERATURE: -55°C+105°C
- UL No. E198287

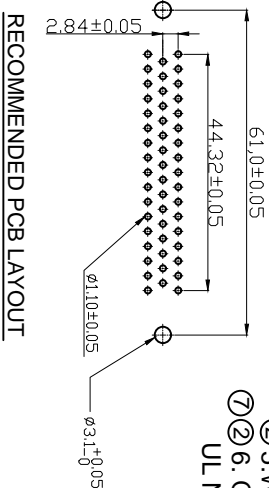
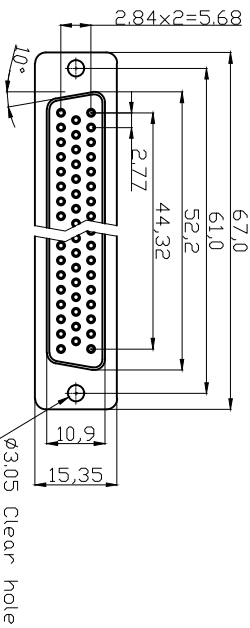

RECOMMENDED PCB LAYOUT

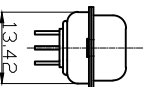
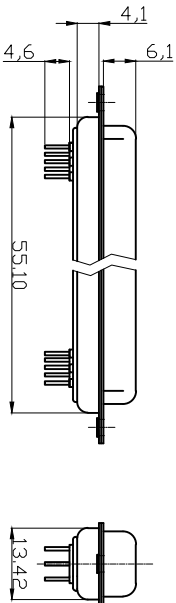

50 POSITIONS

Positions	A±0.15	B±0.10	D±0.13	E±0.08	F±0.10
09	30.81	24.99	16.33	11.08	19.20
15	39.20	33.30	24.70	19.39	27.70
25	53.05	47.04	38.40	33.24	41.10
37	69.40	63.50	54.80	49.86	57.30
50	67.0	61.0	52.2	44.32	55.10

ROHS compliant

Unit:mm

Scale	Free	Update temperature range		Date	Name	Customer-No.
TOLERANCE		⑦	Update temperature range	11.07.2019	Xavier	
X.	±0.38	⑥	Update	18.12.2018	Xavier	Drawn Lucas
X.X	±0.25	⑤	Add the contact plating 15u Au	01.09.2017	Winnie	Approved 01.09.2017 Winnie
X.XX	±0.13	④	Add the detail contact plating	23.12.2016	Winnie	
DIM	TOL	③	Update the dimension	27.02.2015	Winnie	
X.°	±3°	②	Update the operating temperature&UL No.	04.08.2014	Winnie	
X.X°	±1.0°	①	Update the operating temperature&UL No.	04.08.2014	Winnie	
Angle	TOL	Id.	Modification	Date	Name	



ASSMANN WSW-NO. A-DX XX PP/Z-X

ASS 4885 CO rev07

Replace Sheet 2/2

1

2

3

4

5

6

7

H

G

F

E

D

C

B

A

H

G

F

E

D

C

B

A