

PG 9

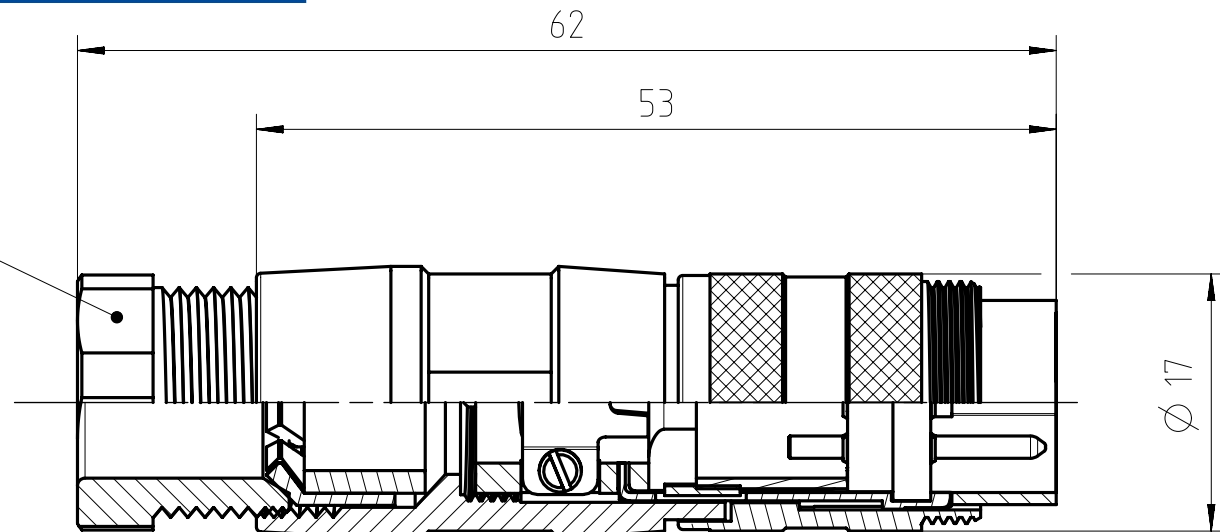

| | | | | | | | | | | | | | | |
|---|---------------------------|--|------|-------------------|----------|--------------------|------|-------------------------------|------|-----------------|----------|-----------------|------|--|
| Number of contacts | Standard | 3 | 4 | 5 | 5 | 6 | 7 | 7 | 8 | 12 | 14 | 14 | 19 | |
| Contact arrangement | IEC 61076-2-106 | 03-a | 04-a | 05-a | 05-b | 06-a | 07-a | 07-b | 08-a | 12-a | 14-a | 14-b | 19-a | |
| Contact arrangement | IEC 60130-9 ¹⁾ | yes | | no | | yes | | no | | no | | | | |
| Rated voltage ²⁾ | IEC 60664-1 | 300 V (100 V) | | 300 V (63 V) | | 100 V (32 V) | | 300 V (63 V) | | 100 V (32 V) | | 150 V (32 V) | | |
| Rated voltage | UL 1977 | 250V | | | | | | | | 60V | | | | |
| Rated impulse withstand voltage ²⁾ | IEC 60664-1 | 1500 V (1500 V) | | 1200 V (800 V) | | 1500 V (1500 V) | | 1200 V (800 V) | | | | | | |
| Pollution degree ²⁾ | IEC 60664-1 | 1 (2) | | | | | | | | | | | | |
| Installation category | IEC 60664-1 | I | | | | | | | | | | | | |
| Insulation group | IEC 60664-1 | II, 400 ≤ CTI < 600 | | | | | | | | | | | | |
| Current rating | IEC 60512-5-2 UL 1977 | 10A/+40°C | | | 7A/+40°C | | | | | | 3A/+40°C | | | |
| Insulation resistance | IEC 60512-3-1 | >10 ¹⁰ Ohm ³⁾ | | | | | | | | | | | | |
| Contact resistance | IEC 60512-2-1 | <5mOhm | | | | | | | | | | | | |
| Climatic category | IEC 60668-1 | 40 / 100 / 56 | | | | | | | | | | | | |
| Temperatur range | IEC 60668-1 | -40°C...+100°C / -40°F...+212°F | | | | | | | | | | | | |
| IP degree | IEC 60529 | IP 40 | | | | | | | | | | | | |
| Insertion and withdrawal force | IEC 60512-13-2 | 25N | 30N | 35N | 35N | 50N | 55N | 55N | 60N | 50N | 50N | 50N | 60N | |
| mechanical operation | IEC 60512-9-1 | Silver ≥500 mating cycles / Gold ≥1000 mating cycles | | | | | | | | | | | | |
| housing material | | brass and / or zinc die cast, nickel plated or thermoplast | | | | | | | | | | | | |
| dielectric material | | thermoplastic | | | | | | | | | | | | |
| contacts | | silver or gold plated | | | | | | | | | | | | |
| termination technique | | solder | | | | | | | | | | | | |
| wire gauge | | ≤0,5mm ² / 20 AWG | | | | | | ≤0,35mm ² / 22 AWG | | | | | | |
| flamability | | UL 94 VO | | | | | | | | | | | | |
| locking system | | metal screw coupling; tightening torque 0,7 - 1,5 Nm | | | | | | | | | | | | |

Gewicht (errechnet) / Calc WT: 0,027 kg

Zul. Abw./Tolerances:

Prüfmaß / Testdimension

ISO 2768-c

Teileindex / Partindexnumber:

DIN / ISO 13715

Bagatelle change:

Gez. 05.02.2021

Drawn MCARLE

Status Released

Gepr. 23.02.2021

Checked MBERTSCH

Amphenol Tuchel Industrial GmbH

Maßstab / Scale: 2:1

A3

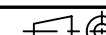

CUSTOMER DRAWING

Male cable connector
PG9, cable diameter 6-8mm

M HA T 3XXX 002+020+028

Blatt / Sheet
1
1 Bl.

Ers. f. / Replacement for:

01 202000083 05.02.2021 MCARLE

Index Änderung / Description Datum / Date Name

Weitergabe sowie Vervielfältigung dieser Unterlage, Verwertung und Mitteilung ihres Inhalts nicht gestattet, soweit nicht ausdrücklich zugestanden. Zuwiderhandlungen verpflichten zu Schadenersatz. Alle Rechte für den Fall der Patenterteilung oder Gebrauchsmuster-Eintragung vorbehalten.

¹⁾ Edition 2000-05
²⁾ values in brackets are according to DIN EN 61076-2-106
³⁾ under operating conditions >10⁹ Ohm
 Do not connect or disconnect under load Metal housing parts shall be securely incorporated to protected ground
 Remark for gold plated contacts:
 In order to avoid brittle inter-metallic connections, gold plated terminals have to be tin-plated in the solder area.
 All technical data have been measured in a laboratory environment and can be different during practical usage of the product. Any product information is for descriptive usage only and not legally binding, particularly the information does not constitute or provide any legal guaranties ("Beschaffenheitsgarantie" or "Haltbarkeitsgarantie").

FAI2021-000620
NXM-V05

Mouser Electronics

Authorized Distributor

Click to View Pricing, Inventory, Delivery & Lifecycle Information:

[Amphenol:](#)

[T3260-028](#)