

PRODUCT NO.  
SEE TABLE

68685 - XXX LF  
 LEAD FREE OPTION  
 PACKAGING OPTIONS OMIT IF NOT REQUIRED.  
 NO. OF POSITIONS PER ROW  
 PLATING CODE  
 BASE PART NUMBER

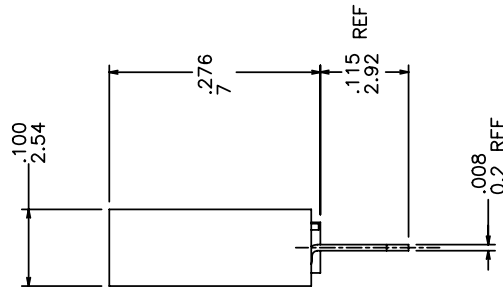
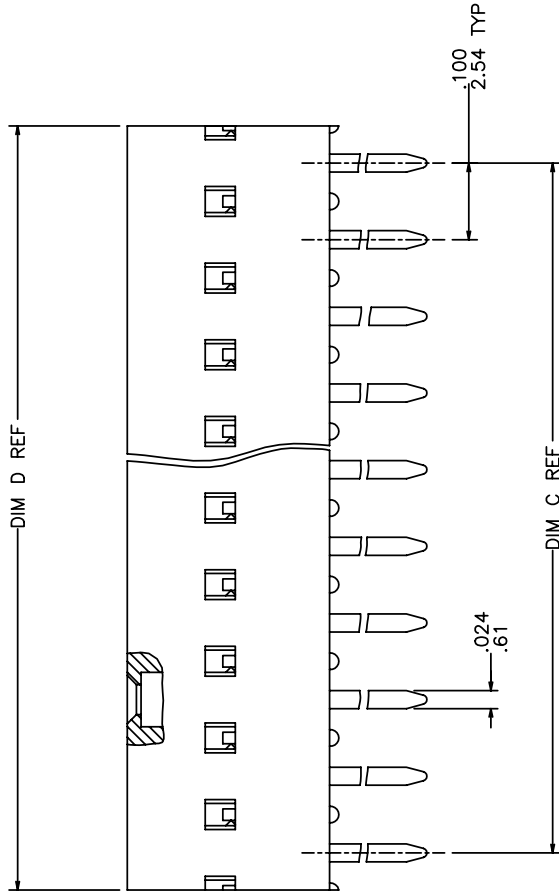
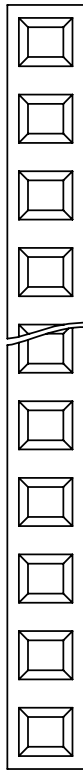

mat'l. code		surface		tolerance		projection		product family	
ISD 1302		ISD 406		ISD 1101		ISD 1101		DUBOX	
titles		tolerances unless otherwise specified		angles		INCH/MM		title	
W N-005262 SH 2011-8-22		.XX ±.01/.3		linea		scale 4:1		DUBOX SING. ROW VERT.	
P W03-0309 HTB 04/30/03		.XXX ±.005/.13		S. RAMP		sheet 1 of 3		CARD CONN. ASSEMBLY	
R W04-0002 HTB 01/06/04		.000 ±.0020/.001		M. HAHN		68685		dwg no	
S W05-0463 DPU 06/27/05		br		M. HAHN		Product Customer Drawing		type	
T M06-0237 MN 06/19/06		engr		M. HAHN		A3		size	
U M06-0433 AGS 10/31/06		Chr		M. HAHN					
V M07-0203 MHT 5/01/07		appd		M. HAHN					
sheet		revisi		W					
index		sheet		1		2		3	

PRODUCT NO NOTE 8	PLATING CONTACT AREA MIN	PLATING SOLDER TAIL
68685-2XX	15u"/.38u Au OR GXT, OVER 50u"/1.27u NI	100u"/160u" SN 2.54u/4.06u
68685-3XX	30u"/.76u Au OR GXT, OVER 50u"/1.27u NI	100u"/160u" SN 2.54u/4.06u
68685-4XX	100u"/160u" SN 2.54u/4.06u	100u"/160u" SN 2.54u/4.06u
68685-5XX	50u"/1.27u Au OVER 50u"/1.27u NI	100u"/160u" SN 2.54u/4.06u
68685-6XX	30u"/.76u Au OR GXT, OVER 50u"/1.27u NI	100u"/160u" SN 2.54u/4.06u
68685-8XX	30u"/.76u Au OVER 50u"/1.27u NI	100u"/160u" SN 2.54u/4.06u

A

NOTES:

- MATERIAL HOUSING: PPS, COLOR - BLACK, FLAME RETARDANT PER UL-94V-0. THIS PART WILL WITHSTAND EXPOSURES TO 260°C PEAK TEMPERATURE FOR 20 SECONDS IN WAVE SOLDER, INFRA-RED OR VAPOR PHASE SOLDER PROCESS.
- MATERIAL TERMINAL: PHOSPHOR BRONZE.
- RECOMMENDED APPLICATION DATA:
  - RECOMMENDED HOLE PATTERN IS SHOWN IN FIGURE A.
  - ALL MATING PINS TO BE .025/.64 SQUARE ON TRUE CENTER OF GIVEN TERMINAL SPACINGS WITHIN .015/.38 DIA
  - SUGGESTED MATING PIN LENGTH .210±.020/5.33±.51
  - RECOMMENDED PC BOARD THICKNESS: .062/1.58
- FCI, FCI FINAL PART NUMBER AND DATE CODE TO BE MARKED ON TUBE LABEL.
- PREPLATED STAMPED TERMINALS.
- STANDARD TUBE PACKAGE PER BUS-14-097/3.
- PART NUMBER WITH SUFFIX "U" FOR SAWING ONLY.
- ADD LF SUFFIX AT THE END OF PART NUMBER FOR LEAD FREE OPTION.
- THIS PRODUCT MEETS EUROPEAN UNION DIRECTIVES AND OTHER COUNTRY REGULATION AS DESCRIBED IN GS-22-008.
- THIS PRODUCT HAS 100% TIN PLATING IN THE INTERFACE AND HAS NOT BEEN TESTED FOR WHISKER GROWTH IN ALL INTERCONNECT ENVIRONMENTS".

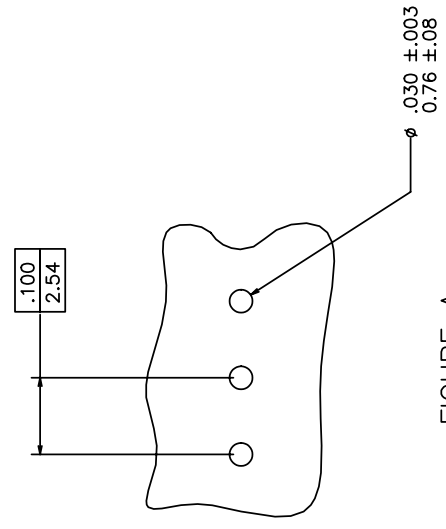

FIGURE A

mat'l. code		surface / tolerance		projection		product family	
ISD 1302	ISD 406	ISD 1101	ISD 1101	ISD 1101	ISD 1101	ISD 1101	DUBOX
W	date	date	date	date	date	date	title
							DUBOX SING. ROW VERT. CARD CONN. ASSEMBLY
							dwg no 68685 sheet 2 of 3 size A3
							type Product Customer Drawing
sheet index	revision						

PRODUCT NUMBER	NO. OF POSITION	DIM C	DIM D	LF OPTION	PRODUCT NO	NO. OF POSITION	DIM C	DIM D	LF OPTION
68685-Y02	1 X 2	.100/2.54	.217/5.51		68685-Y36	1 X 36	3.500/88.90	3.617/91.87	
-Y03	1 X 3	.200/5.08	.317/8.05		-Y37	1 X 37	3.600/91.44	3.717/94.41	
-Y04	1 X 4	.300/7.62	.417/10.59		-Y38	1 X 38	3.700/93.98	3.817/96.95	
-Y05	1 X 5	.400/10.16	.517/13.13		-Y39	1 X 39	3.800/96.52	3.917/99.49	
-Y06	1 X 6	.500/12.70	.617/15.67		-Y40	1 X 40	3.900/99.06	4.017/102.03	
-Y07	1 X 7	.600/15.24	.717/18.21		-Y41	1 X 41	4.000/101.60	4.117/104.57	
-Y08	1 X 8	.700/17.78	.817/20.75		-Y42	1 X 42	4.100/104.14	4.217/107.11	
-Y09	1 X 9	.800/20.32	.917/23.29		-Y43	1 X 43	4.200/106.68	4.317/109.65	
-Y10	1 X 10	.900/22.86	1.017/25.83		-Y44	1 X 44	4.300/109.22	4.417/112.19	
-Y11	1 X 11	1.000/25.40	1.117/28.37		-Y45	1 X 45	4.400/111.76	4.517/114.73	
-Y12	1 X 12	1.100/27.94	1.217/30.91		-Y46	1 X 46	4.500/114.30	4.617/117.27	
-Y13	1 X 13	1.200/30.48	1.317/33.45		-Y47	1 X 47	4.600/116.84	4.717/119.81	
-Y14	1 X 14	1.300/33.02	1.417/35.99		-Y48	1 X 48	4.700/119.38	4.817/122.35	
-Y15	1 X 15	1.400/35.56	1.517/38.53		-Y49	1 X 49	4.800/121.92	4.917/124.89	
-Y16	1 X 16	1.500/38.10	1.617/41.07		68685-Y50	1 X 50	4.900/124.46	5.017/127.43	
-Y17	1 X 17	1.600/40.64	1.717/43.61		68685-Y50U	1 X 50	4.900/124.46	5.017/127.43	
-Y18	1 X 18	1.700/43.18	1.817/46.15						
-Y19	1 X 19	1.800/45.72	1.917/48.69						
-Y20	1 X 20	1.900/48.26	2.017/51.23						
-Y21	1 X 21	2.000/50.80	2.117/53.77						
-Y22	1 X 22	2.100/53.34	2.217/56.31						
-Y23	1 X 23	2.200/55.88	2.317/58.85						
-Y24	1 X 24	2.300/58.42	2.417/61.39						
-Y25	1 X 25	2.400/60.96	2.517/63.93						
-Y26	1 X 26	2.500/63.50	2.617/66.47						
-Y27	1 X 27	2.600/66.04	2.717/69.01						
-Y28	1 X 28	2.700/68.58	2.817/71.55						
-Y29	1 X 29	2.800/71.12	2.917/74.09						
-Y30	1 X 30	2.900/73.66	3.017/76.63						
-Y31	1 X 31	3.000/76.20	3.117/79.17						
-Y32	1 X 32	3.100/78.74	3.217/81.71						
-Y33	1 X 33	3.200/81.28	3.317/84.25						
-Y34	1 X 34	3.300/83.82	3.417/86.79						
68685-Y35	1 X 35	3.400/86.36	3.517/89.33						

NOTE 7

NOTE 8

mat'l. code		surface / tolerance		projection		product family	
ISD 1302		ISO 406		FIRST ANGLE		DUBOX	
date		tolerances unless otherwise specified		title		DUBOX SING. ROW VERT. CARD CONN. ASSEMBLY	
dr		.XX ±.01/.3		INCH/MM		dwg no 68685	
engr		.XXX ±.0020/.001		scale 4:1		sheet of 3 size A3	
chr		S. RAMP 02/25/91		FCI		Product Customer Drawing	
appd		M. HAHN 02/25/91					
sheet index		revision					
sheet							

