



Designers' Choice

# PLUGS & JACKS

## PANEL MOUNT PHONO JACKS

- Mats with 1/8" diameter pin
- Mounts to panel in .296 Dia. Hole
- Color coded for ease of identification
- Complete with nut and soldering lug

**MATERIAL:** Brass, Nickel Plate

### ROUND BASE

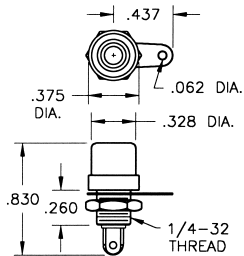

**CAT. NO. 580 (RED INSULATOR)**  
**CAT. NO. 574 (BLACK INSULATOR)**

### HEX BASE

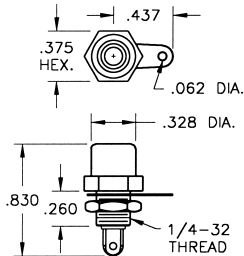

**CAT. NO. 576 (BLACK INSULATOR)**

## RIVET TYPE PHOTO JACKS

- Mates with 1/8" diameter pin
- Rivet type-mounts in .296 Dia. Hole
- Available for 1/16" 3/32" 1/8" thick

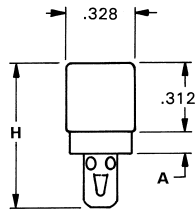

**MATERIAL**  
**Shell:** Steel  
**Contract:** Brass  
**Plating:** Tin

CAT. NO.	A	H	INSULATOR THICKNESS
568	.078	.656	1/16"
569	.109	.812	3/32"
570	.140	.812	1/8"

## BNC TO DUAL BANANA PLUGS

### BNC MALE TO DUAL BANANA PLUGS

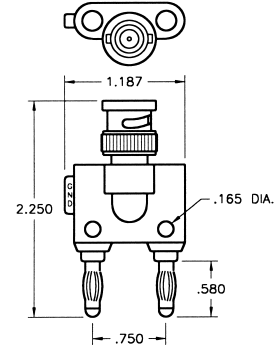

**MATERIAL**  
**Body:** Molded Plastic  
**Connector:** Brass, Nickel Plate  
**Center Contract:** Brass, Gold Plate  
**Banana Plug:** Beryllium Copper, Nickel Plate

**CAT. NO. 7020**

### BNC FEMALE TO DUAL BANANA PLUGS

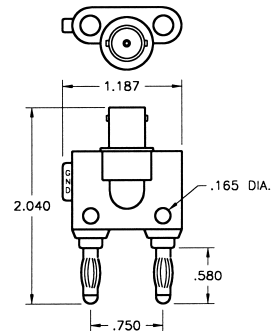

**MATERIAL**  
**Body:** Molded Plastic  
**Connector:** Brass, Nickel Plate  
**Center Contract:** Brass, Gold Plate  
**Banana Plug:** Beryllium Copper, Nickel Plate

**CAT. NO. 7021**

### BNC MALE TO DUAL BINDING POSTS (BLACK & RED)

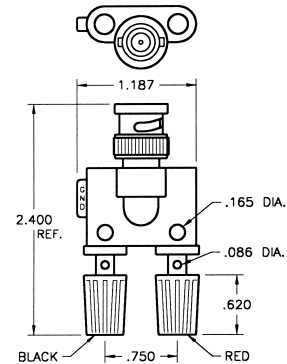

**MATERIAL**  
**Body:** Molded Plastic  
**Connector:** Brass, Nickel Plate  
**Center Contract:** Brass, Gold Plate  
**Banana Plug:** Brass, Nickel Plate

**CAT. NO. 7022**

## PHONO PLUGS

Mates with 1/8" diameter jacks

**MATERIAL:** Shell: Steel, Tin Plate Pins: Brass, Nickel Plate

### Longer Skirt for Better Grip

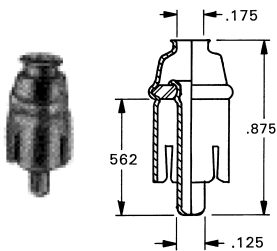

**CAT. NO. 566**

### Strain Relief Lug Crimps to Wire Insulation

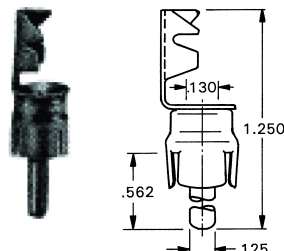

**CAT. NO. 565**

### Conventional Type

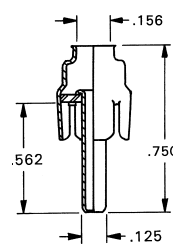

**CAT. NO. 561**

### Crimp or Solder Type Extra Long Handle

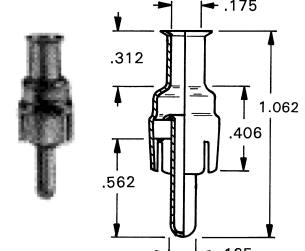

**CAT. NO. 567**

# Mouser Electronics

Authorized Distributor

Click to View Pricing, Inventory, Delivery & Lifecycle Information:

[Keystone Electronics:](#)

[568](#) [566](#) [569](#) [7020](#) [7021](#) [7022](#) [570](#)