

### Cubic connector

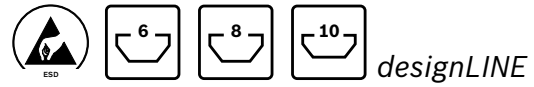

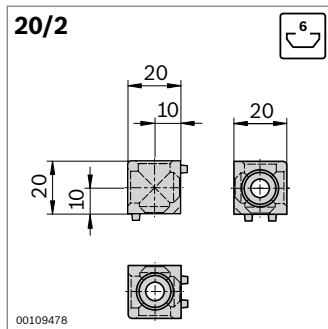



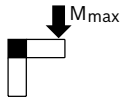

- ▶ For torsion-resistant corner connection of profiles with equal cross-sections
- ▶ *designLINE* version with special silver paint (RAL 9006) for an attractive, high-quality design
- ▶ Cover caps to cover the openings
- ▶ Screw fitting on profile with self-tapping screws
- ▶ Profile finishing: not required

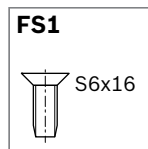
Technical data (p. 19-8)



Type	
20/2	18 Nm



Cubic connector 20/2	Slot	ESD		No.	FS
Set (standard), signal gray	6		1	<b>3 842 549 858</b>	2xFS1
Set <i>designLINE</i> , signal gray	6		1	<b>3 842 549 859</b>	2xFS1
Cubic connector	6		20	<b>3 842 523 875</b>	
Cover cap	signal gray (PP)		100	<b>3 842 548 700</b>	
D12	black (PP)		100	<b>3 842 548 704</b>	
Countersunk screw S6x16	6		100	<b>3 842 517 132</b>	

Material: Cubic connector: Die-cast aluminum  
*designLINE* cubic connector: painted (RAL 9006)  
 Fastening material: steel; galvanized

Scope of delivery: set incl. fastening material (FS), caps

Cubic connector creates conductive connection, but the cover caps included in the set are not ESD-compatible.