

**Power metal film resistors**

**PR01/02/03**

**FEATURES**

- High power in small packages
- Available wide range to automatic insertion machine.

**APPLICATIONS**

- All general purpose power applications.

**DESCRIPTION**

A homogeneous film of metal alloy is deposited on a high grade ceramic body. After a laser groove has been cut in the resistive layer, tinned connecting leads of electrolytic copper are welded to the end-caps.

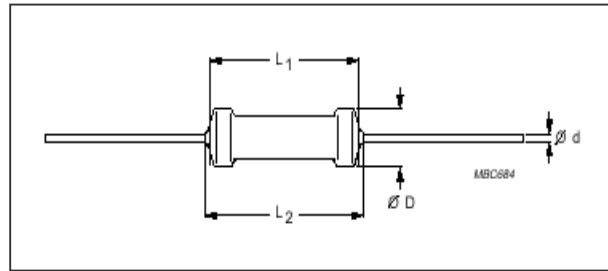

TYPE	Dimensions (mm)			
	D max.	L1 max.	L 2 max.	d (±0.05)
PR01	2.5	6.5	8.5	0.55
PR02	3.9	9.0	12.0	0.8
PR03	6.0	15.5	18.0	0.8

**QUICK REFERENCE DATA**

DESCRIPTION	VALUE		
	PR01	PR02	PR03
resistance range	0.22 to 1 MΩ	0.1 to 1 MΩ	0.47 to 470 kΩ
resistance tolerance	±5%, ±2% (E24), ±1% (E48, E96 series)		
temperature coefficient :	± 250 ppm /	± 250 ppm /	± 350 ppm /
rated dissipation at Tamb = 70	1 W	2 W	3W
max. permissible voltage	350 V	500 V	750 V
max. overload voltage	700 V	1000 V	1000 V
basic specifications	IEC 60 115-1 and 60 115-2		
climatic category (IEC60)	55 / 155 / 56		
stability, ΔR/R max. after load : 1000 hours	± 5% +0.1	± 5% +0.1	± 5% +0.1
Damp heat steady state	± 3% +0.1	± 3% +0.1	± 3% +0.1
climatic tests :	± 3% +0.1	± 3% +0.1	± 3% +0.1
soldering	± 1% +0.05	± 1% +0.05	± 1% +0.05