

STRIPPING DIMENSIONS FOR 4855R CABLE

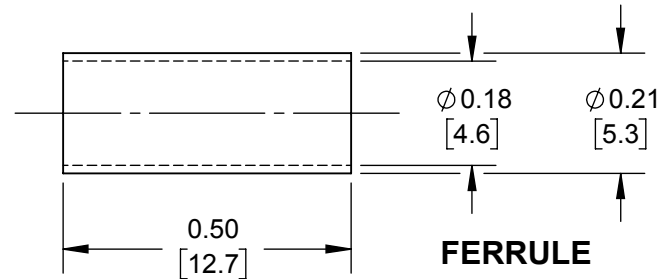
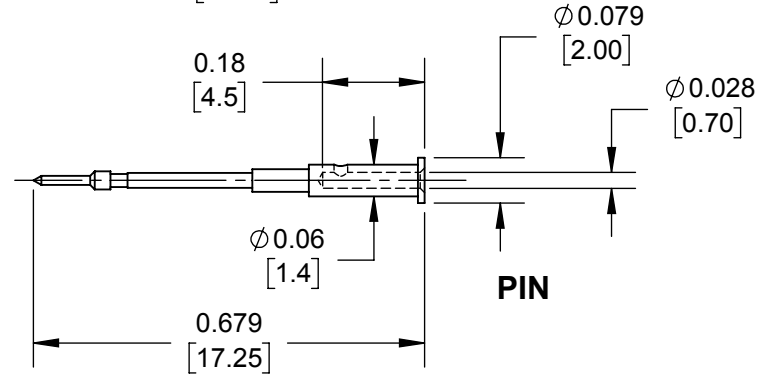
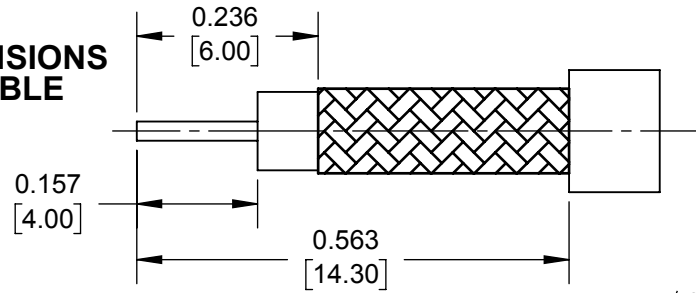
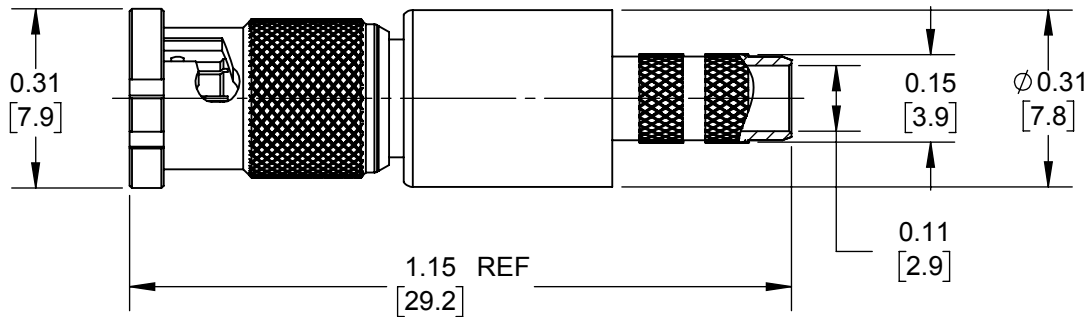

NOTES:

1. MUST BE ROHS COMPLIANT.
2. MUST BE USEABLE TO 12GHZ.
3. ALL DIMENSIONS ARE REF.
4. CRIMP CONTACT PIN WITH 0.042 SQUARE.
5. CRIMP FERRULE WITH 0.180 HEX.

CUSTOMER DRAWING

					THIS DRAWING DESCRIBES A DESIGN CONSIDERED PROPRIETARY IN NATURE, DEVELOPED AND MANUFACTURED BY SWITCHCRAFT INC. AND IS RELEASED ON A CONFIDENTIAL BASIS FOR IDENTIFICATION PURPOSES ONLY.					
					UNLESS OTHERWISE SPECIFIED	SIZE	WIDTH	MULT	LBS/M	TEMPER
					1. ALL DIMENSIONS IN INCHES [mm]	FINISH			MATERIAL	
					- TWO PLACE DECIMALS ±0.02 [0.5]	SPEC No.			SPEC No.	
					- THREE PLACE DECIMALS ±0.005 [0.13]	FIRST USED ON		SCALE 1:1		
A	28255	2/21/20	TJK	TJK	DATE DRAWN	BY	CHKD	APVD	Switchcraft®	
REV	ECO NUMBER	DATE	BY	APVD	10/7/19	SRC	TJK	TJK		
REVISIONS					DO NOT SCALE DRAWING	NAME			PART No.	
						PLUG, MICRO BNC FOR 4855R CABLE			UHDMB55	
									REV A	

Mouser Electronics

Authorized Distributor

Click to View Pricing, Inventory, Delivery & Lifecycle Information:

[Switchcraft:](#)

[UHDMB55](#)