

160038

Terminals and Splices
Ring and Spade Tongue Terminals

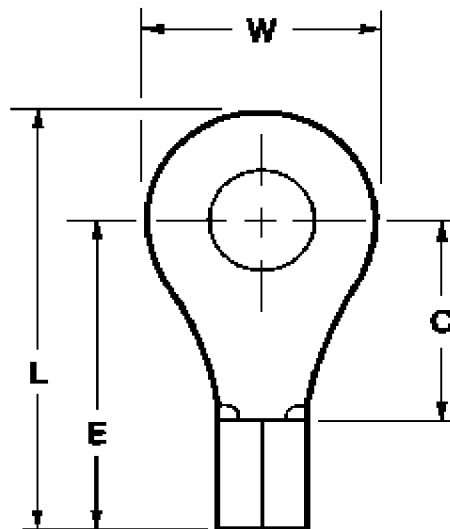

Line art represents typical product only.

| <i>Searchable Features:</i> | |
|---|--|
| Terminal Shape | Ring Tongue |
| Body Style | SOLISTRAND |
| Receptacle Style | Straight |
| Barrel Type | Closed Barrel |
| Wire/Cable Type | Regular Wire |
| Wire Range | 12-10 [2.70-6.60 ²] AWG [mm] |
| Insulation | No |
| Insulation Support | Non-Insulation Support |
| Stud Size | .394 [10.00] |
| Stud Diameter | .406 [10.30] in. [mm] |
| Shape | RING-048 |
| Heavy Duty | Standard |
| Packaging Method | Loose Piece |
| Material | Copper |
| Finish | Tin |
| <i>Other Properties:</i> | |
| Dim. C | .625 [15.90] Min. in. [mm] |
| Dim. E | .874 [22.20] in. [mm] |
| Dim. L | 1.272 [32.30] in. [mm] |
| Dim. W | .752 [19.10] in. [mm] |
| Stock Thickness | .039 [1.00] in. [mm] |
| CERTI-CRIMP Hand Tool | 49935, 525693-0 (Great Britain Tool) |
| CERTI-LOK Hand Tool Frame Assembly | 169400 |
| CERTI-LOK Die Assembly | 169409 |