

# Spring-loaded test probe

## GKS-002 206 191 A 1000

Item GKS-002-0008



**ingun**<sup>®</sup>

Partner for Future Technology

- Robust, compact design for harsh ICT/FCT applications with limited space
- For optimum contact at the test points (e.g. pads, vias, and pins), various tip styles in different diameters and finishes, as well as various spring forces are available. spring forces.

### INGUN SELECTION

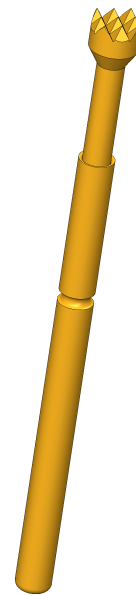

1:1

# Spring-loaded test probe

## GKS-002 206 191 A 1000

Item GKS-002-0008



GO TO PRODUCT

ingun®

Partner for Future Technology

### General data

|                                |   |
|--------------------------------|---|
| Product group                  | ICT / FCT (in-circuit test and function test) |
| Sub-product group              | Short/robust GKS                              |
| Series                         | GKS-002                                       |
| Grid                           | 2.54 mm [100 mil]                             |
| Contacting from                | Pin, Post, Flat contact                       |
| Magnetic                       | Yes   |
| Installation type              | Plug-in                                       |
| Quick-exchange system          | Yes   |
| Adjustable installation height | No  |
| Non-rotating                   | No  |
| Compatible receptacle(s)       | KS-002  |
| Min. temperature               | - 40 °C [- 104 °F]                            |
| Max. temperature               | + 80 °C [+ 176 °F]                            |
| RoHS-compliant                 | Yes   |

### Electrical data

|                                       |          |
|---------------------------------------|----------|
| Current load capacity / rated current | 5 A      |
| Typical resistance (Ri)               | <20 mOhm |

### Mechanical data

|                                |                   |
|--------------------------------|-------------------|
| Total length                   | 24.6 mm [.968 in] |
| Barrel diameter                | 1.37 mm [.053 in] |
| Maximum stroke                 | 4.1 mm [.161 in]  |
| Spring pre-load                | 0.49 N [1.76 ozf] |
| Collar height                  | 00                |
| Spring force at working stroke | 1 N [3.59 ozf]    |
| Recommended working stroke     | 2.7 mm [.106 in]  |

### Tip style data

|                    |                   |
|--------------------|-------------------|
| Tip style          | 06 serrated       |
| Tip diameter       | 1.91 mm [.075 in] |
| Tip style surface  | A gold            |
| Tip style material | 2 steel           |

### INGUN SELECTION

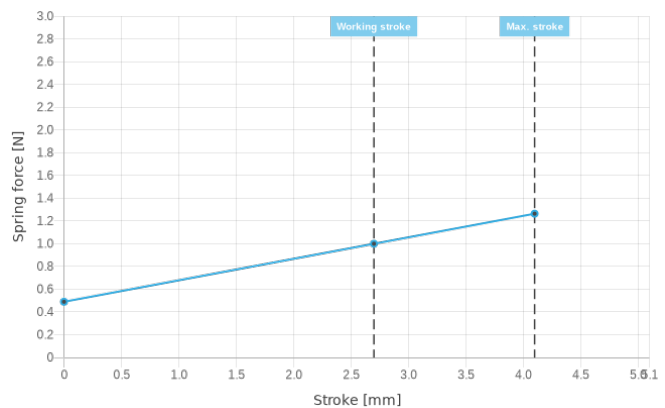
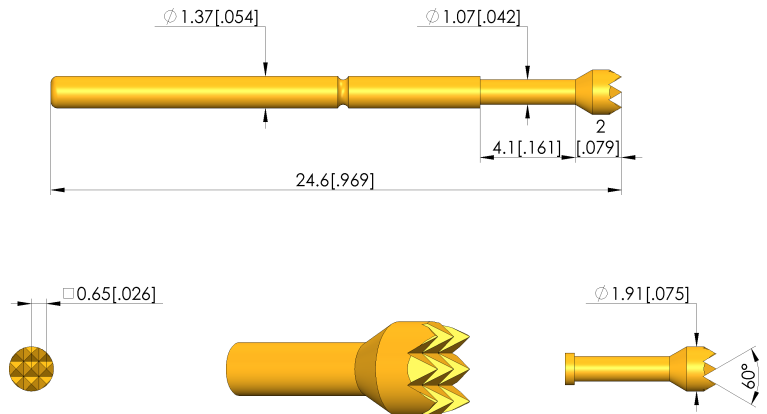

### INGUN Prüfmittelbau GmbH

Max-Stromeyer-Straße 162  
78467, Constance, Germany  
Phone +49 7531 8105-0  
Customer hotline +49 7531 8105-888  
Fax +49 7531 8105-65  
info@ingun.com



Prices and delivery times on request.  
Technical changes reserved. 11/22 EN

Weitere Informationen zum Thema  
ICT/FCT Test probes

