



Main

Range of Product	Telemecanique Cabling components
Accessory / separate part category	Cabling accessories
Accessory / Separate Part Type	Connector
Electrical connection	Elbowed female connector DIN 43650 A, 4 pins
Status LED	Without
Cable connection	Screw terminal 0.00 in ² (1.5 mm ²) 0.28...0.39 in (7...10 mm)

Complementary

Cable gland type	Pg 11
Cable connector fixing	Locking screw
[Ue] rated operational voltage	250 V AC
Line Rated Current	16 A
Enclosure Material	Plastic
Minimum insulating resistance	0.1 GΩ
Contact resistance	4000 μOhm
Net Weight	0.08 lb(US) (0.035 kg)

Environment

IP Degree of Protection	IP65
Ambient Air Temperature for Operation	-40...257 °F (-40...125 °C)

Ordering and shipping details

Category	22483-MACHINE CABLES
Discount Schedule	DS3
GTIN	3389110833959
Returnability	Yes
Country of origin	DE

Packing Units

Unit Type of Package 1	PCE
Number of Units in Package 1	1
Package 1 Height	1.18 in (3 cm)
Package 1 Width	3.94 in (10 cm)
Package 1 Length	3.94 in (10 cm)
Package 1 Weight	1.16 oz (33 g)
Unit Type of Package 2	S02
Number of Units in Package 2	50
Package 2 Height	5.91 in (15 cm)
Package 2 Width	11.81 in (30 cm)
Package 2 Length	15.75 in (40 cm)
Package 2 Weight	4.33 lb(US) (1.962 kg)

Offer Sustainability

California proposition 65	WARNING: This product can expose you to chemicals including: Diisononyl phthalate (DINP), which is known to the State of California to cause cancer, and Di-isodecyl phthalate (DIDP), which is known to the State of California to cause birth defects or other reproductive harm. For more information go to www.P65Warnings.ca.gov
REACH Regulation	REACH Declaration
EU RoHS Directive	Pro-active compliance (Product out of EU RoHS legal scope) EU RoHS Declaration
Mercury free	Yes
RoHS exemption information	Yes

Contractual warranty

Warranty	18 months
----------	-----------

Dimensions

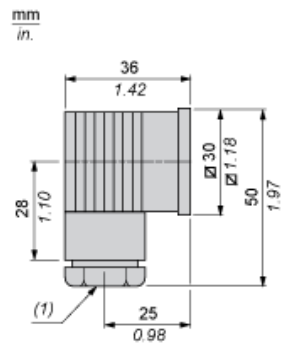

(1) Pg 11 cable gland

Connections and Schemes

