

**NOTES**

1. ALL DIMENSIONS ARE IN INCHES  
[MILLIMETERS]
2. DIMENSIONS APPEARING IN TABLE ARE AS FOLLOWS:  
a - AS SUPPLIED  
b - AFTER UNRESTRICTED RECOVERY
3. COATING IS OPTIONAL. AS SUPPLIED DIMENSIONS APPEARING IN TABLE ARE FOR UNCOATED PARTS WHEN COATING IS ADDED, ENTRY DIAMETERS WILL BE REDUCED BY 0.06 MAX.

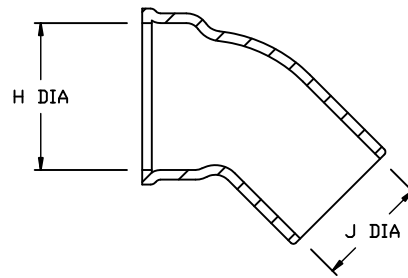

AS SUPPLIED

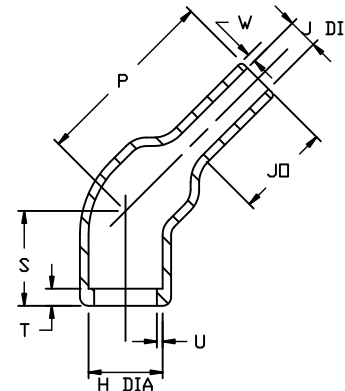

AFTER UNRESTRICTED RECOVERY

REVISIONS		
LTR	DESCRIPTION	DATE
A1	REVISED PER ECO-13-016159	10/11/2013

**ORDERING INFORMATION**

BASE PART NUMBER 245W0XX -X /XX -0  
 MATERIAL DASH NUMBER \_\_\_\_\_  
 -3 POLYOLEFIN, SEMI RIGID (RT-301)  
 -4 POLYOLEFIN, FLEXIBLE (RT-1304)  
 -12 FLUORO ELASTOMER, FLEXIBLE (RT-1312)  
 -25 ELASTOMER, FLUID RESISTANT (RW-2070)  
 ADHESIVE SLASH NUMBER \_\_\_\_\_  
 SEE COMPATIBILITY CHART BELOW  
 COLOR DESIGNATOR \_\_\_\_\_

PART DESCRIPTION	H		J		P	S	T	U	JO	W
	MIN	MAX	MIN	MAX	±10%	±10%	±10%	±10%	±10%	±20%
	a	b	a	b	b	b	b	b	b	b
245W032	.60 [15,4]	.55 [14,0]	.35 [8,8]	.23 [5,8]	1.15 [29,2]	.50 [12,7]	.12 [3,0]	.04 [1,0]	.67 [17,0]	.06 [1,5]
245W042	.88 [22,4]	.68 [17,3]	.61 [15,6]	.28 [7,1]	1.50 [38,1]	.50 [12,7]	.12 [3,0]	.04 [1,0]	.88 [22,4]	.07 [1,7]
245W053	1.16 [29,5]	.90 [22,8]	.89 [22,7]	.33 [8,5]	1.65 [41,9]	.50 [12,7]	.12 [3,0]	.05 [1,3]	.86 [21,8]	.08 [2,0]
245W063	1.44 [36,6]	1.11 [28,3]	1.17 [29,7]	.40 [10,1]	1.93 [49,0]	.50 [12,7]	.12 [3,0]	.07 [1,8]	.96 [24,4]	.09 [2,3]
245W074	1.72 [43,6]	1.35 [34,4]	1.45 [36,8]	.61 [15,6]	2.25 [57,2]	.50 [12,7]	.12 [3,0]	.07 [1,8]	1.00 [25,4]	.12 [3,0]

Raychem Molded Parts  
CUSTOMER DRAWING

**COMPATIBILITY CHART**

MATERIAL DASH NO.	ADHESIVE (COATING) SLASH NUMBER	ADHESIVE (COATING) S NUMBER
-3	/42; /86	S-1017; S-1048
-4	/42; /86	S-1017; S-1048
-12	N/A	N/A
-25	/86; /225	S-1048; S-1206

UNLESS OTHERWISE SPECIFIED DIMENSIONS ARE METRIC AND INCHES ARE IN BRACKETS.  
 DECIMAL TOLERANCES  
 XXX ± 0.13 (.005)  
 XX ± 0.25 (.01)  
 X ± 0.50 (.10)  
 ANGLE TOLERANCE  
 .X ± 1 DEG.

DRAWN  
M Mazariegos  
10/17/11  
RPN

APPROVED  
D.Hurrell  
10/17/11

CAD FILE:  
245W0XX\_CD

**STE** TE Connectivity

TITLE  
45° BOOT (SPIN LOCK BOOT)

THIRD ANGLE PROJECTION

SIZE B CODE IDENT. NO. 06090 DWG. NO. 245W0XX

© 2011-2013 Tyco Electronics Corporation. All rights reserved. DO NOT SCALE THIS DRAWING SHEET 1 OF 1

# Mouser Electronics

Authorized Distributor

Click to View Pricing, Inventory, Delivery & Lifecycle Information:

[TE Connectivity:](#)

[CX4132-000](#)