

Verpackt im Gurt in Anlehnung an DIN IEC 60286-3
 tape on reel packaging according to DIN IEC 60286-3
 Verpackungseinheit: 720 Stück
 packaging unit: 720 pcs

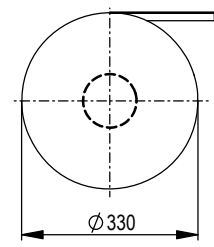

Abspulrichtung - reel off direction

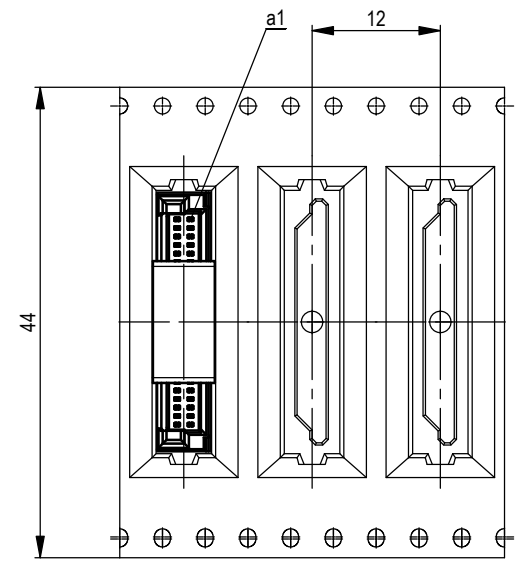
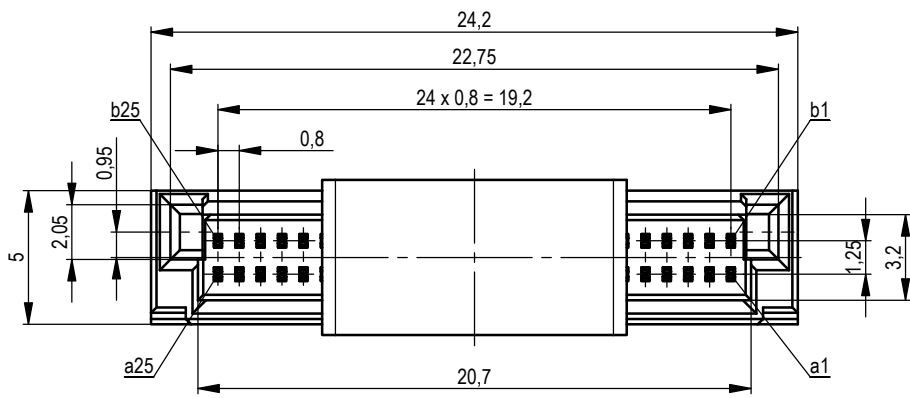

ohne Ansaughaube - without hood

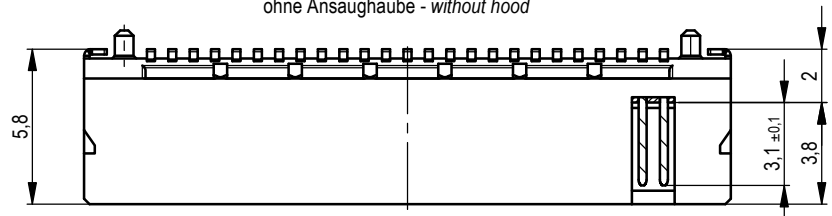

Leiterplatten-Layout Vorschlag für SMT
 PCB-Layout Proposal for SMT

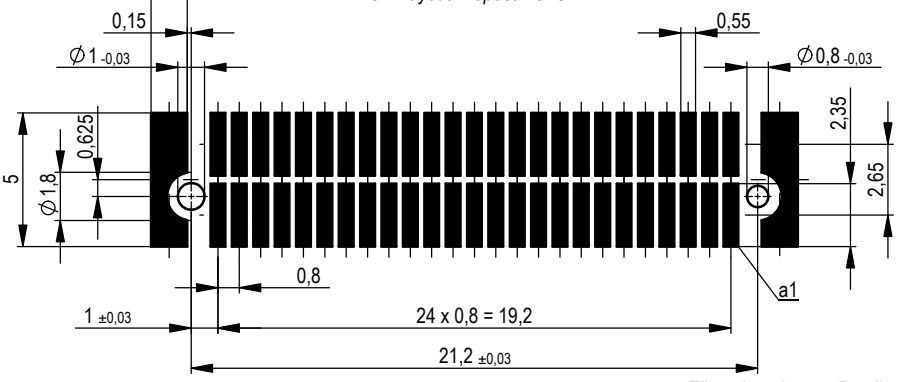

Anforderungsstufe 1
 performance level 1

Kontaktbereich vergoldet
 mating area gold plating

Anschlussbereich verzinkt 4-6 µm
 terminal area 4-6 µm tin plating

Koplanarität der Anschlüsse ≤ 0,1 mm
 coplanarity area of termination ≤ 0,1 mm

Die Abbildung ist eine Zeichnung eines Erzeugnisses, das als Erfindung oder als Erfindung im Sinne des Patentrechts geschützt ist. Alle Rechte für den Fall der Patent-, Gebrauchsmuster- oder Geschmacksmustereintragung vorbehalten.
 This drawing is a technical drawing of a product which is protected by patent law. All rights reserved in the event of the grant of a patent, utility model or design.
 This drawing is a technical drawing of a product which is protected by patent law. All rights reserved in the event of the grant of a patent, utility model or design.

Für weitere Layout Details siehe Zeichnung: 494901
 For further layout details see drawing: 494901

Dimension no.	Tolerances	Scale 5:1
	ISO 8015	All Dimensions in mm
Customer drawing:	Subject to modification without prior notice. Drawing will not be updated.	
All rights reserved. Only for Information. To ensure that this is the latest version of this drawing, please contact one of the ERNI companies before using.		MicroCon Male 2mm 50 pin 0,8 DRC-Q Type2 294151
e	11.02.2019	I
Index	Date	A3
ERNI International AG Zürichstrasse 72 8306 Brüttisellen - Zürich Switzerland		Class DRCC

Mouser Electronics

Authorized Distributor

Click to View Pricing, Inventory, Delivery & Lifecycle Information:

[TE Connectivity:](#)

[294151](#) [294151-E](#)