

PART NUMBER	LED COLOR (nm)
5988B10102F	RED (623)
5988B10107F	ORANGE (605)
5988B30102F	YELLOW (590)
5988B40107F	YELLOW GREEN (570)
5988B60102F	GREEN (525)
5988B80107F	BLUE (470)

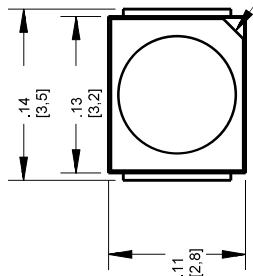

POLARITY MARK

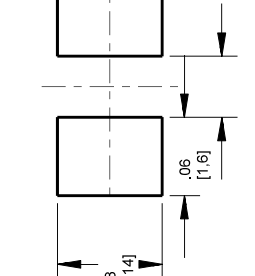
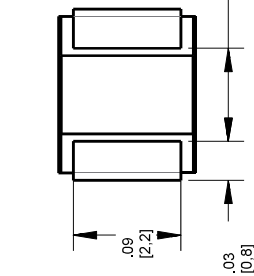
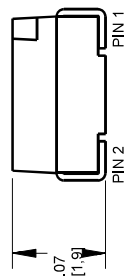

RECOMMENDED SOLDER PAD LAYOUT

NOTES:

- PIN NUMBERS ARE FOR REFERENCE ONLY, DESIGNATION NON-EXISTENT ON PART.
- LABELING FOR REEL AND OUTSIDE OF ALUMINUM BAG, DIALIGHT PIN, QUANTITY PER REEL, DATE CODE, INTENSITY BIN CODE, LOT NUMBER AND COUNTRY OF ORIGIN
- THIS PRODUCT IS RoHS COMPLIANT. EACH BAG IS TO BE MARKED WITH RoHS COMPLIANT LABEL OR EQUIVALENT MARKINGS. LED MUST BE Pb FREE.
- MOISTURE SENSITIVITY LEVEL 3
- QUANTITY IS 2000 PCS/REEL

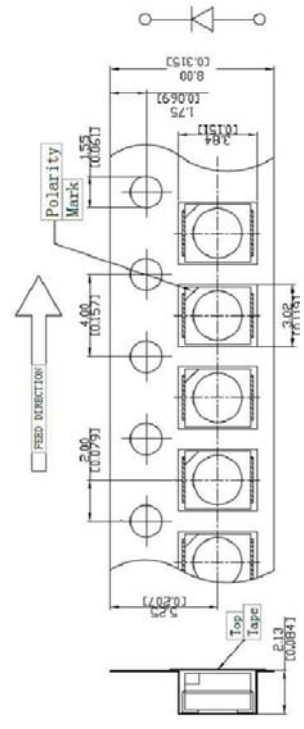

UNITS: mm  
TOLERANCE (UNLESS OTHERWISE SPECIFIED): ±0.2mm

TAPING SPECIFICATIONS

LED COLOR	ABSOLUTE MAXIMUM RATINGS AT 25 °C						
	POWER DISSIPATION (mW)	FORWARD CURRENT (mA)	PEAK FORWARD CURRENT (mA)	REVERSE VOLTAGE (V)	OPERATING TEMPERATURE (°C)	STORAGE TEMPERATURE (°C)	DERATING CURVE FROM 25 °C (mA/°C)
RED	72	30	100	5	-40 TO +85	-40 TO +100	.56
ORANGE	72	30	100	5	-40 TO +85	-40 TO +100	.56
YELLOW	72	30	100	5	-40 TO +85	-40 TO +100	.56
YELLOW GREEN	72	30	100	5	-40 TO +85	-40 TO +100	.56
GREEN	100	30	100	5	-40 TO +85	-40 TO +100	.56
BLUE	100	30	100	5	-40 TO +85	-40 TO +100	.56

LED COLOR	OPERATING CHARACTERISTICS AT 25 °C									
	IF (mA)	MIN.	TYP.	MAX.	LUMINOUS INTENSITY (mcd)	DOMINANT WAVELENGTH (nm)	REVERSE CURRENT (µA)	MAX.	FORWARD VOLTAGE (V)	VIEWING ANGLE (DEG)
RED	20	200	380	560	615	623	630	1.8	2.4	120
ORANGE	20	250	345	430	600	605	610	1.8	2.4	120
YELLOW	20	200	315	430	585	590	595	1.8	2.4	120
YELLOW GREEN	20	40	80	120	565	570	575	1.8	2.4	120
GREEN	20	1200	1750	2300	520	525	530	2.8	3.5	120
BLUE	20	230	395	560	465	470	475	2.8	3.5	120



LED SCHEMATIC

REV	REVISIONS	DRN APP	DATE
A	NEW RELEASE	LD NO	1-9-19
B	ADDED VIEWING ANGLE	LD NO	4-25-19

RECOMMENDED RoHS SOLDER PROFILE

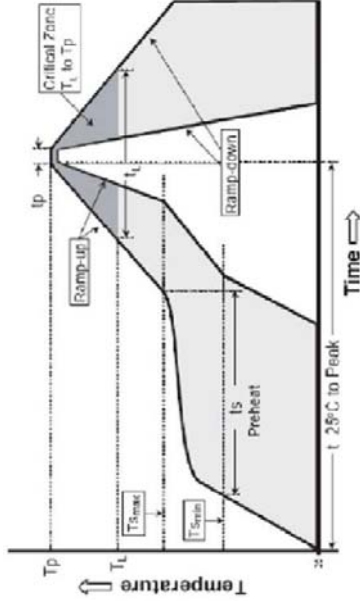

MARK	DEFINITION	CONDITION
TS <sub>max</sub>	Maximum of pre-heating temperature	200 °C
TS <sub>min</sub>	Minimum of pre-heating temperature	150 °C
T <sub>s</sub>	Time form T <sub>sm</sub> to T <sub>smax</sub>	60-120 sec
T <sub>L</sub>	Reference temperature	217 °C
t <sub>L</sub>	Retention time for TL	within 60s
T <sub>P</sub>	Peak Temperature	260 °C
t <sub>P</sub>	Time for peak temperature	within 10s
D <sub>T</sub> /D <sub>t</sub>	Temperature rising rate	under 3 °C/sec
D <sub>T</sub> /D <sub>t</sub>	Temperature decreasing rate	under -3 °C/sec



ATTENTION:  
OBSERVE PRECAUTIONS FOR  
HANDLING ELECTROSTATIC  
SENSITIVE DEVICES

THIS DRAWING AND THE CONTENTS HEREIN ARE CONFIDENTIAL AND THE SOLE PROPERTY OF DIALIGHT CORP. REPRODUCTION OF THIS DRAWING OR CONSTRUCTION OF ANY PARTS WITHIN THIS DRAWING ARE FORBIDDEN WITHOUT THE WRITTEN CONSENT OF DIALIGHT CORP.

SCALE: 10:00  
ALL DIMS INCH (mm)  
TOLERANCES: UNLESS OTHERWISE SPECIFIED  
FRACTIONS: ±1/64  
DECIMALS (X.X): ±.01  
DECIMALS (X.XX): ±.008  
ANGLES: ±1°

DRAWING NUMBER: C-18404  
TITLE: 3528 PACKAGE  
MATERIAL:

FSCM 83330  
SHEET 1 OF 1 FAMILY TABLE

Dialight  
1501 ROUTE 54 SOUTH  
FARMINGDALE, NJ 07427  
(732) 9343119  
www.dialight.com