

Closed End AD H / AD SB / AK H Series

Aluminium / Steel



English	Français	Deutsch	Italiano	Español
Body: Aluminium* Natural	Corps: Aluminium* Brut	Hülse: Aluminium* Blank	Corpo: Alluminio* Nessuna finitura	Cuerpo: Aluminio* Natural
Stem: Steel	Tige: Acier	Dorn: Stahl	Gambo: Acciaio	Vástago: Acero

* 5056 / 5% Magnesium Alloy

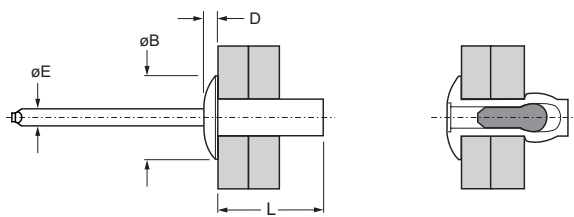

AD H / AD SB
Dome head
Tête bombée / Flachrundkopf /
Testa tonda / Cabeza alomada

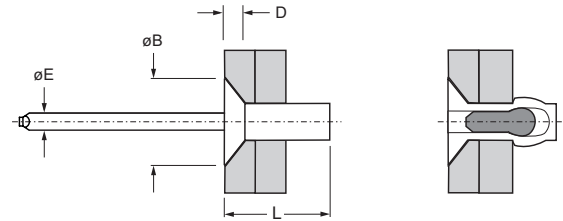

AK H
Countersunk
Tête fraisée / Senkkopf /
Testa svasata / Cabeza avellanada

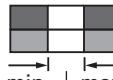
Ø nom.					ØE ref.	AD H / AD SB				AK H				
	min.	max.	min.	max.		L ref.	ØB max.	D max.	Part No.	L ref.	ØB max.	D max.	Part No.	
3.2 (1/8")	0.8	1.6	3.3	3.4	1.6	6.0	6.3	1.3	AD 42 SB	7.0	6.3	1.4	AK 41 H	
	1.6	3.2				7.6			AD 44 SB	8.7			AK 42 H	
	3.2	4.8				9.2			AD 46 SB	10.2			AK 43 H	
	4.8	6.4				10.8			AD 48 SB	11.8			AK 44 H	
	6.4	7.9				12.4	AD 45 H	13.4	AK 45 H					
	7.9	9.5				14.0	AD 46 H							
	9.5	12.7				17.1	AD 48 H							
4.0 (5/32")	1.6	3.2	4.1	4.2	2.2	8.0	8.3	1.7	AD 54 SB	9.4	8.3	1.7	AK 52 H	
	3.2	4.8				9.6			AD 56 SB	11.0			AK 53 H	
	4.8	6.4				11.2			AD 58 SB	12.6			AK 54 H	
	6.4	7.9				12.8			AD 510 SB	14.2			AK 55 H	
4.8 (3/16")	1.6	3.2	4.9	5.0	2.6	8.4	10.0	2.1	AD 64 SB	10.0	10.1	1.9	AK 62 H	
	3.2	4.8				9.9			AD 66 SB					
	3.2	6.4								13.2				AK 64 H
	4.8	6.4				11.6			AD 68 SB					
	6.4	7.9				13.1			AD 610 SB					
	6.4	9.5								16.4				AK 66 H
	7.9	9.5				14.7			AD 612 SB					
	9.5	12.7				17.9			AD 616 SB	19.6				AK 68 H
	12.7	15.9				22.0			AD 620 SB					
6.4 (1/4")	3.2	6.4	6.5	6.6	3.7	12.3	13.4	2.6	AD 84 H					
	6.4	9.5				15.5			AD 86 H					

all dimensions in mm / en millimètre / alle Maße in mm / in millimetri / en milímetros

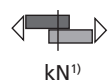
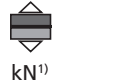
Ø nom.	 kN ¹⁾	 kN ¹⁾
3.2 (1/8")	1.36	1.71
4.0 (5/32")	1.91	2.69
4.8 (3/16")	2.56	3.74
6.4 (1/4")	4.00	4.89

1) typical values / valeurs moyennes / typische Werte / Valori tipici / valores típicos