

PCB DRILLING DETAILS

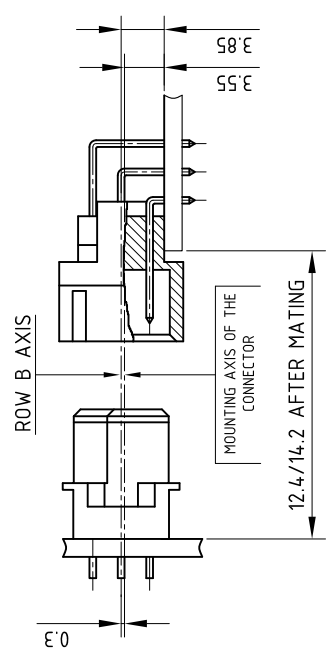
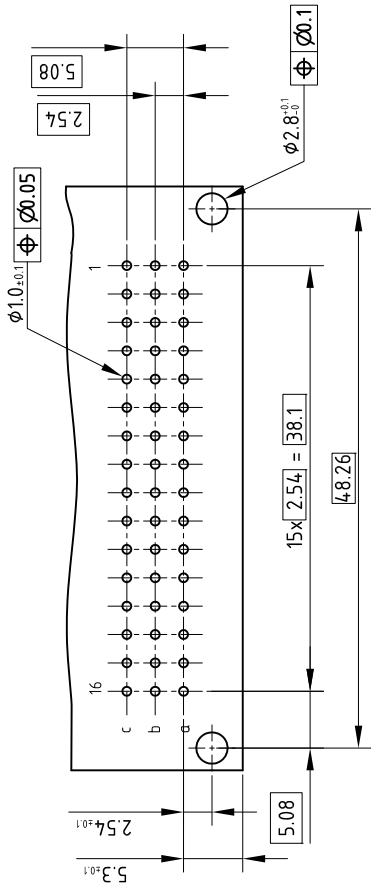

TECHNICAL SPECIFICATION

HOUSING MATERIAL : HIGH TEMPERATURE THERMOPLASTIC POLYESTER UL94V-0, NATURAL
 HOUSING CAN WITHSTAND EXPOSURE 260°C PEAK TEMPERATURE FOR 30 SECONDS IN A CONVECTION, INFRARED OR VAPOUR REFLOW SOLDER APPLICATION.
 CONTACT / HARPOON MATERIAL : COPPER ALLOY
 CONTACT ZONE - Au / GXT™ OVER Ni
 TERMINATION ZONE - Sn (MATT) OVER Ni
 HARPOON PLATING : Sn (MATT) OVER Ni

ELECTRICAL DATA

CURRENT RATING AT 20°C : 1.5 A
 CURRENT (I MAX) : 2 A
 TEMPERATURE RANGE : -55°C TO +125°C
 CONTACT RESISTANCE : ≤20 mΩ
 INSULATION RESISTANCE : ≥10⁶ MΩ
 TEST VOLTAGE (rms) : 1000 V

MECHANICAL DATA

INSERTION FORCE PER CONTACT : ≤ 0.94 N
 EXTRACTION FORCE PER CONTACT : ≥ 0.15 N

REFERENCE SPECIFICATION : DIN 41612 / IEC 603-2

SERIES	8609	3	48	7	3	13	B	5	5	F1LF
ROWS FITTED WITH CONTACTS										
Rows a b c			3	48						
Rows a - c			4	32						
NUMBER OF CONTACTS										
TYPE OF INSULATOR										
3 ROW MALE INSULATOR										7
METHOD OF MOUNTING										
STANDARD MOUNTING - STYLE C/2										1
TERMINATION										
ANGLED SPILL SHORT (L = 2.6 ^{+0.3})										13
ANGLED SPILL LONG (L = 4.0 ^{-0.3})										23
OPTIONS										
HIGH TEMPERATURE HOUSING (NATURAL)										B
HIGH TEMPERATURE HOUSING (NATURAL) WITH HARPOONS										T
PERFORMANCE CLASS										
DIN 41612 CLASS 3										4
DIN 41612 CLASS 2										5
DIN 41612 CLASS 1										6
AS PER MIL C 55302/ JSS 50808										8
PITCH PER ROW										
2.54										5

SPECIAL CODE : F1LF ----- HIGH TEMPERATURE INSULATOR, LEADFREE VERSION

Copyright AFCI

- NOTES:
1. THE "LF" PRODUCTS MEET EUROPEAN UNION DIRECTIVES AND OTHER COUNTRY REGULATIONS AS DESCRIBED IN GS-47-0004.
 2. LEAD FREE OR ROHS DIRECTIVE LABELING TO BE PROVIDED AS PER GS-14-920 FOR LEAD FREE VERSION.
 3. FOR GENERAL CHARACTERISTICS AND ROHS INFORMATION, REFER DRAWING C-8609-0000A.

mat'l. code	surface	tolerance	projection	product family
SEE TECH. SPEC.	ISO 1302	ISO 406 ISO 1101		8609
itr	tolerances unless otherwise specified			title
A	angles	.0±.1	mm	DIN STANDARD HEADER
B	Linear			ANGLED SPILL DIN 41612 STYLE-C/2
	0°±1°		scale 3:2	(HIGH TEMPERATURE VERSION)
	dr	M JACOB	2016-11-29	dwg no
	enr	M JACOB	2016-11-29	sheet 1 of 1 size
	chr	STALIN ALOSIUS	2016-11-29	C-8609-2364
	appd	BIJU K PAUL	2016-11-29	Product Customer Drawing
sheet index	revision			
	sheet	1		