

**Features:**

- Handles 2W of power
- Resistances from 0.1Ω to 1MΩ
- TCR of ± 100 ppm/°C
- 1% and 5% tolerances
- Runs significantly cooler than standard thick film 2512 chip
- RoHS compliant and halogen free
- REACH compliant

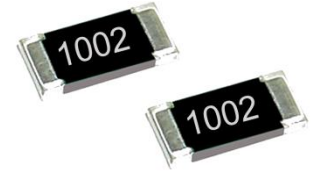

Electrical Specifications						
Type/Code	Package Type	Power Rating (W) @ 70°C	Maximum Working Voltage (V) <sup>(1)</sup>	Maximum Overload Voltage (V)	TCR (ppm/°C)	Ohmic Range (Ω) and Tolerance
RHC2512	2512	2	200	400	±100	1%, 5% 0.1 - 1M

Note: (1) Lesser of  $\sqrt{P \cdot R}$  or maximum working voltage

Please refer to the High-Power Resistor Application Note (page 5) for more information on designing and implementing high power resistor types.

**Mechanical Specifications**

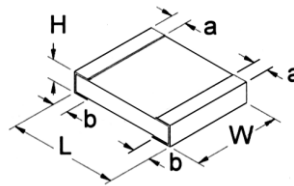

Type/Code	L Body Length	W Body Width	H Body Height	a Top Termination	b Bottom Termination	Unit
RHC2512	0.248 ± 0.008	0.126 ± 0.008	0.024 ± 0.004	0.028 ± 0.008	0.087 ± 0.008	inches
	6.30 ± 0.20	3.20 ± 0.20	0.60 ± 0.10	0.70 ± 0.20	2.20 ± 0.20	mm

**Performance Characteristics**

Test	Typical
Moisture Resistance	±1% + 0.05Ω for <10Ω and ±1% for ≥10Ω
Load Life	
Resistance to Soldering	
Temperature Cycling	
Thermal Shock	
Short Time Overload	
Insulation Resistance	≥1MΩ

Operating temperature range is -55°C to +155°C

**Power Derating Curve:**

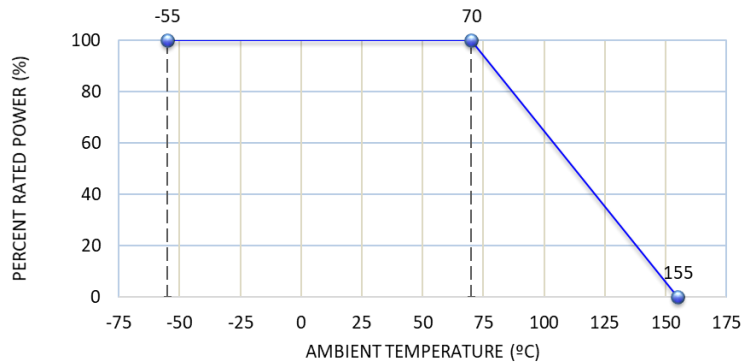

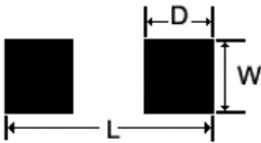
Recommended Pad Layout				
				
Type/Code	L Total Length	W Total Width	D Pad Depth	Unit
RHC2512	0.315	0.138	0.118	inches
	8.00	3.50	3.00	mm

### Recommended Solder Profile

This information is intended as a reference for solder profiles for Stackpole resistive components. These profiles should be compatible with most soldering processes. These are only recommendations. Actual numbers will depend on board density, geometry, packages used, etc., especially those cells labeled with “\*\*”.

### 100% Matte Tin / RoHS Compliant Terminations

Soldering iron recommended temperatures: 330°C to 350°C with minimum duration.  
Maximum number of reflow cycles: 3.

Wave Soldering			
Description	Maximum	Recommended	Minimum
Preheat Time	80 seconds	70 seconds	60 seconds
Temperature Diff.	140°C	120°C	100°C
Solder Temp.	260°C	250°C	240°C
Dwell Time at Max.	10 seconds	5 seconds	*
Ramp DN (°C/sec)	N/A	N/A	N/A

Temperature Diff. = Difference between final preheat stage and soldering stage.

Convection IR Reflow			
Description	Maximum	Recommended	Minimum
Ramp Up (°C/sec)	3°C/sec	2°C/sec	*
Dwell Time > 217°C	150 seconds	90 seconds	60 seconds
Solder Temp.	260°C	245°C	*
Dwell Time at Max.	30 seconds	15 seconds	10 seconds
Ramp DN (°C/sec)	6°C/sec	3°C/sec	*

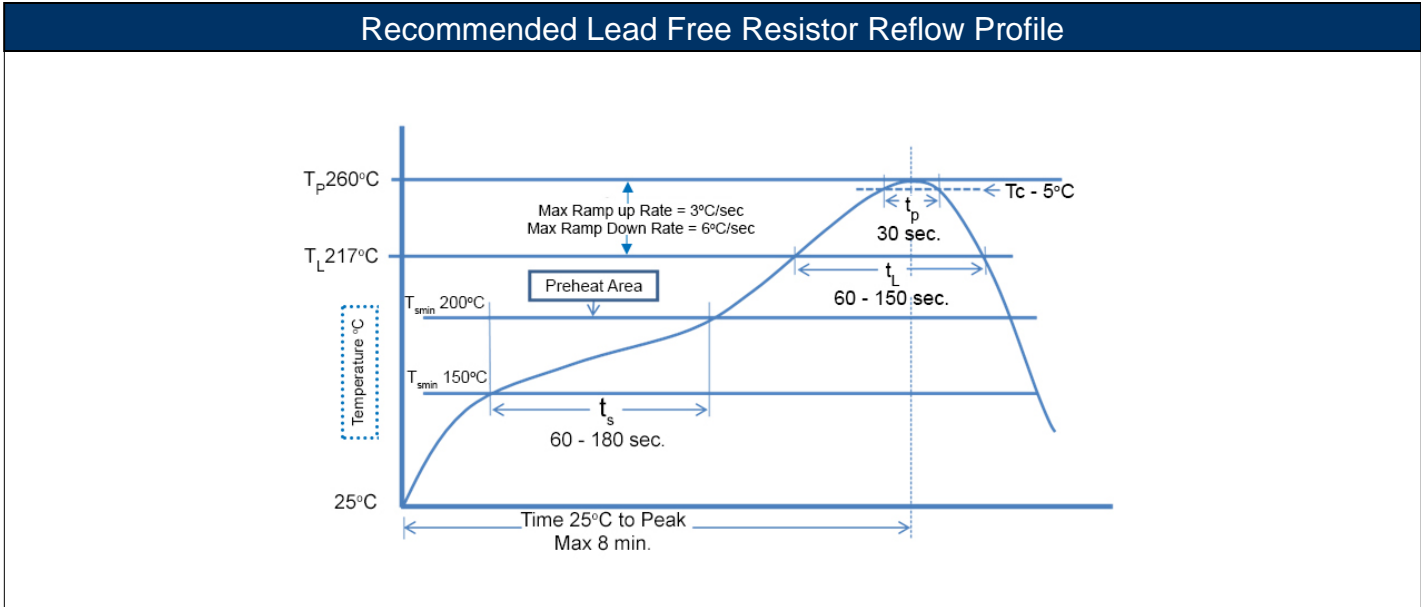

Heat Rise and Terminal Temperature:

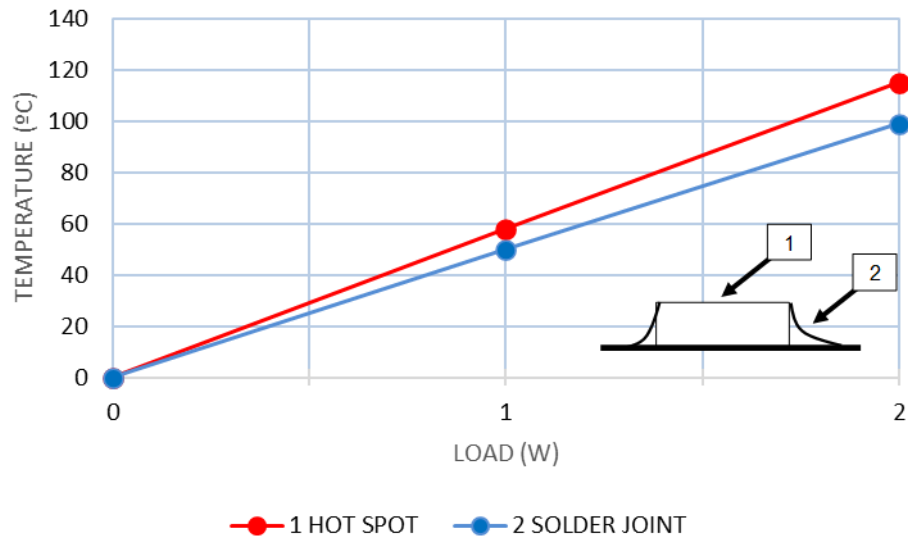

Repeated Overload:

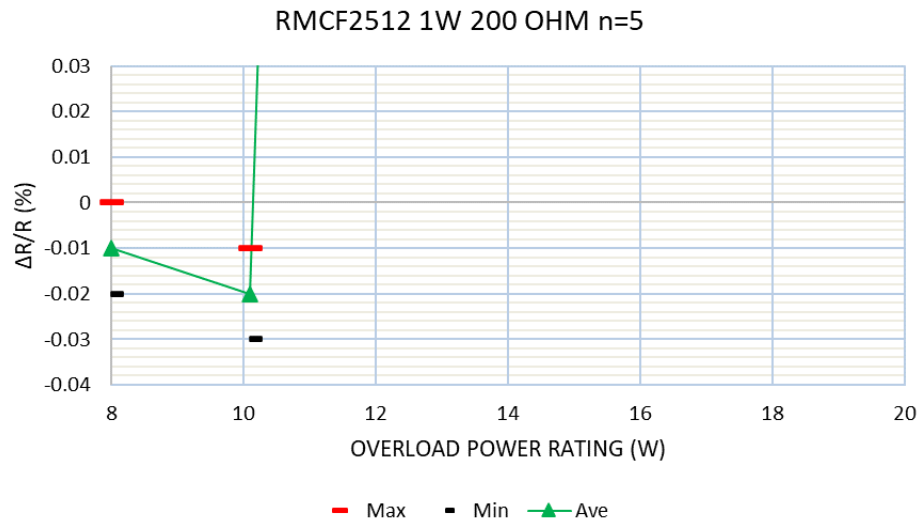
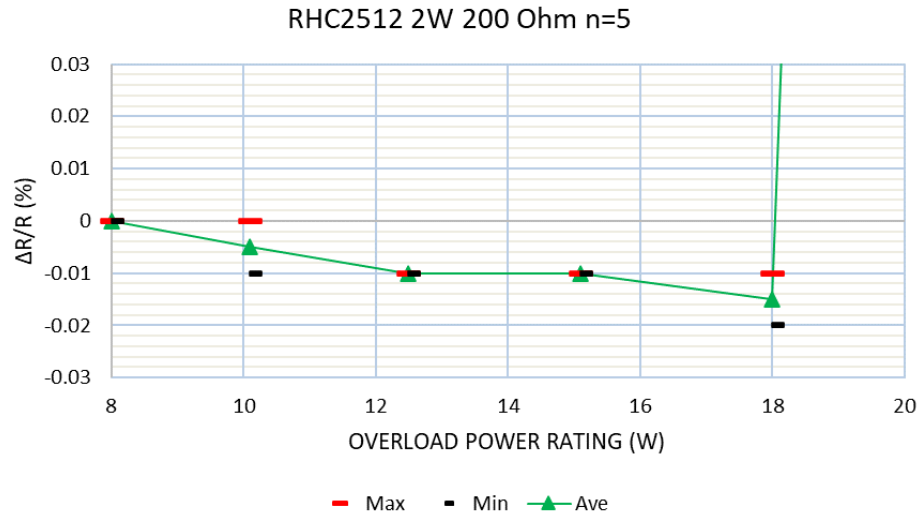

Test condition:

Voltage (Power): 2.0, 2.25, 2.5, 2.75, 3.0, 3.25 times of rated voltage. (8W, 10.1W, 12.5W, 15.1W, 18W, 21.1W)

Applied time:

Each voltage 5 seconds.

As a reference test, the RMCF was tested with the same rated voltage and testing substrate.

**Packaging Specifications – Embossed Plastic Tape**

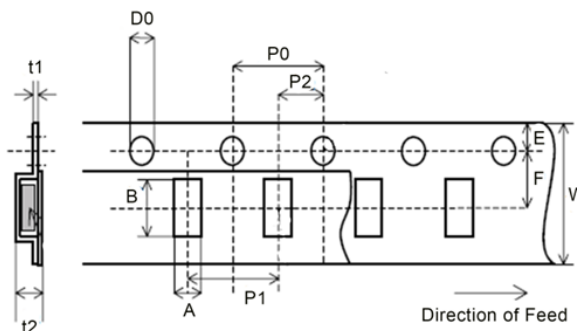

Type	A	B	W	F	E	P1	Unit
RHC2512	0.134 ± 0.004 3.40 ± 0.10	0.260 ± 0.004 6.60 ± 0.10	0.472 ± 0.008 12.00 ± 0.20	0.217 ± 0.002 5.50 ± 0.05	0.069 ± 0.004 1.75 ± 0.10	0.157 ± 0.004 4.00 ± 0.10	Inches mm
Type	P2	P0	D0	t1	t2	Unit	
RHC2512	0.079 ± 0.002 2.00 ± 0.05	0.157 ± 0.004 4.00 ± 0.10	0.061 ± 0.002 1.55 ± 0.05	0.010 ± 0.002 0.25 ± 0.05	0.039 ± 0.004 1.00 ± 0.10	Inches mm	

**Reel Specifications**

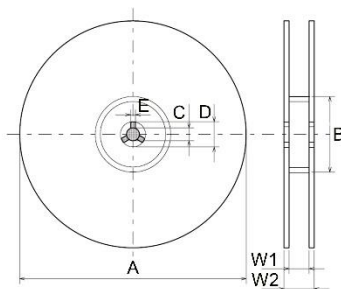

Type	A	B	C	D	E	W1	W2	Unit
RHC2512	7.087 ± 0.118 180.00 ± 3.00	2.362 ± 0.039 60.00 ± 1.00	0.512 ± 0.008 13.00 ± 0.20	0.827 ± 0.031 21.00 ± 0.80	0.079 ± 0.020 2.00 ± 0.50	0.512 ± 0.012 13.00 ± 0.30	0.606 ± 0.039 15.40 ± 1.00	Inches mm

**High Power Chip Resistors and Thermal Management**

Stackpole has developed several surface mount resistor series in addition to our current sense resistors, which have had higher power ratings than standard resistor chips. This has caused some uncertainty and even confusion by users as to how to reliably use these resistors at the higher power ratings in their designs.

The data sheets for the RHC, RMCP, RNCP, CSR, CSRN, CSRF, CSS, and CSSH state that the rated power assumes an ambient temperature of no more than 100°C for the CSS / CSSH series and 70°C for all other high power resistor series. In addition, IPC and UL best practices dictate that the combined temperature on any resistor due to power dissipated and ambient air shall be no more than 105°C. At first glance this wouldn't seem too difficult, however the graph below shows typical heat rise for the CSR1206 100 milliohm at full rated power. The heat rise for the RMCP and RNCP would be similar. The RHC with its unique materials, design, and processes would have less heat rise and therefore would be easier to implement for any given customer.

CSR1206 100mΩ Surface Temperature Rise

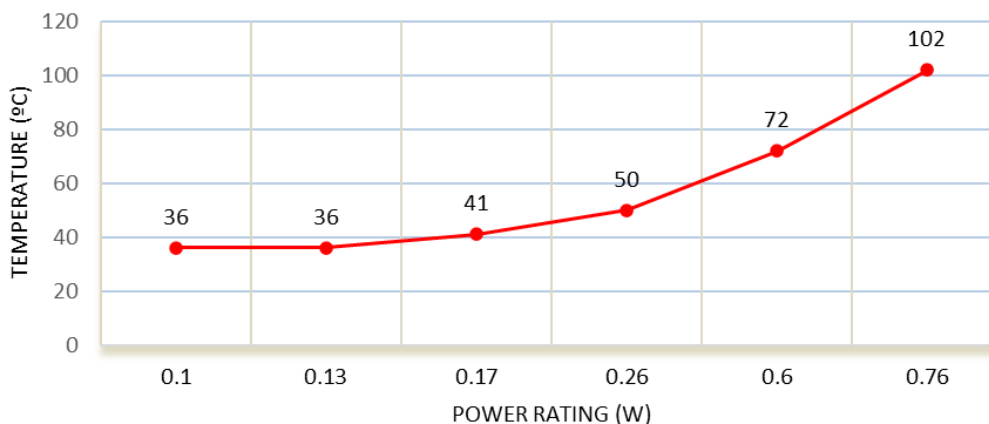

The 102°C heat rise shown here would indicate there will be additional thermal reduction techniques needed to keep this part under 105°C total hot spot temperature if this part is to be used at 0.75 watts of power. However, this same part at the usual power rating for this size would have a heat rise of around 72°C. This additional heat rise may be dealt with using wider conductor traces, larger solder pads and land patterns under the solder mask, heavier copper in the conductors, via through PCB, air movement, and heat sinks, among many other techniques. Because of the variety of methods customers can use to lower the effective heat rise of the circuit, resistor manufacturers simply specify power ratings with the limitations on ambient air temperature and total hot spot temperatures and leave the details of how to best accomplish this to the design engineers. Design guidelines for products in various market segments can vary widely so it would be unnecessarily constraining for a resistor manufacturer to recommend the use of any of these methods over another.

Note: The final resistance value can be affected by the board layout and assembly process, especially the size of the mounting pads and the amount of solder used. This is especially notable for resistance values ≤ 50mΩ. This should be taken into account when designing.

**RoHS Compliance**

Stackpole Electronics has joined the worldwide effort to reduce the amount of lead in electronic components and to meet the various regulatory requirements now prevalent, such as the European Union’s directive regarding “Restrictions on Hazardous Substances” (RoHS 3). As part of this ongoing program, we periodically update this document with the status regarding the availability of our compliant components. All our standard part numbers are compliant to EU Directive 2011/65/EU of the European Parliament as amended by Directive (EU) 2015/863/EU as regards the list of restricted substances.

RoHS Compliance Status						
Standard Product Series	Description	Package / Termination Type	Standard Series RoHS Compliant	Lead-Free Termination Composition	Lead-Free Mfg. Effective Date (Std Product Series)	Lead-Free Effective Date Code (YY/WW)
RHC	High Power Thick Film Surface Mount Chip Resistor	SMD	YES(1)	100% Matte Sn over Ni	Jul-04	04/27

Note (1): RoHS Compliant by means of exemption 7c-l.

**“Conflict Metals” Commitment**

We at Stackpole Electronics, Inc. are joined with our industry in opposing the use of metals mined in the “conflict region” of the eastern Democratic Republic of the Congo (DRC) in our products. Recognizing that the supply chain for metals used in the electronics industry is very complex, we work closely with our own suppliers to verify to the extent possible that the materials and products we supply do not contain metals sourced from this conflict region. As such, we are in compliance with the requirements of Dodd-Frank Act regarding Conflict Minerals.

**Compliance to “REACH”**

We certify that all passive components supplied by Stackpole Electronics, Inc. are SVHC (Substances of Very High Concern) free and compliant with the requirements of EU Directive 1907/2006/EC, “The Registration, Evaluation, Authorization and Restriction of Chemicals”, otherwise referred to as REACH. Contact us for complete list of REACH Substance Candidate List.

**Environmental Policy**

It is the policy of Stackpole Electronics, Inc. (SEI) to protect the environment in all localities in which we operate. We continually strive to improve our effect on the environment. We observe all applicable laws and regulations regarding the protection of our environment and all requests related to the environment to which we have agreed. We are committed to the prevention of all forms of pollution.

**How to Order**

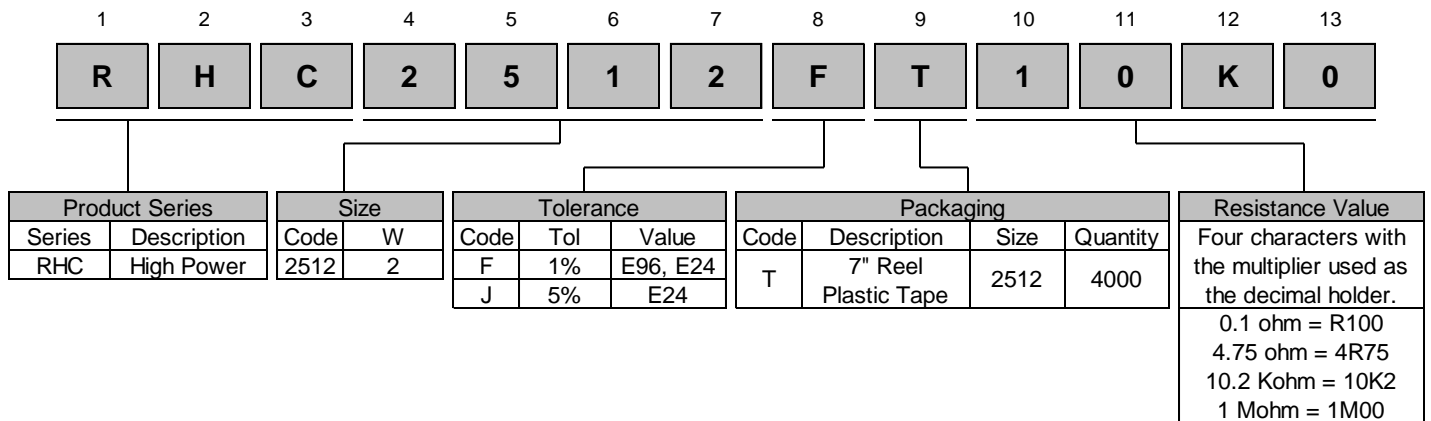

# Mouser Electronics

Authorized Distributor

Click to View Pricing, Inventory, Delivery & Lifecycle Information:

## SEI Stackpole:

[RHC2512FT15R0](#) [RHC2512FT150R](#) [RHC2512FT68R0](#) [RHC2512FT7R50](#) [RHC2512FT22K0](#) [RHC2512JT270R](#)  
[RHC2512FT470R](#) [RHC2512FT15K0](#) [RHC2512FT680R](#) [RHC2512FT68K0](#) [RHC2512FT100R](#) [RHC2512FTR100](#)  
[RHC2512FT604R](#) [RHC2512FT47K0](#) [RHC2512FT1K00](#) [RHC2512FT10R0](#) [RHC2512FT1K50](#) [RHC2512FT100K](#)  
[RHC2512FT220R](#) [RHC2512FT10K0](#) [RHC2512FT4R99](#) [RHC2512FT47R5](#) [RHC2512FT2R49](#) [RHC2512FT3K30](#)  
[RHC2512FT2K20](#) [RHC2512FT33K0](#) [RHC2512FT47R0](#) [RHC2512FT1R00](#) [RHC2512FT330R](#) [RHC2512FT4K70](#)  
[RHC2512FT22R0](#) [RHC2512FT33R0](#) [RHC2512FT105R](#) [RHC2512FT13R7](#) [RHC2512FT140R](#) [RHC2512FT1R58](#)  
[RHC2512FT1R69](#) [RHC2512FT210R](#) [RHC2512FT249R](#) [RHC2512FT2R20](#) [RHC2512FT309R](#) [RHC2512FT39R2](#)  
[RHC2512FT44R2](#) [RHC2512FT4R53](#) [RHC2512FT549R](#) [RHC2512FT5R10](#) [RHC2512FT5R11](#) [RHC2512FT62R0](#)  
[RHC2512FT649R](#) [RHC2512FT6R49](#) [RHC2512FT7R15](#) [RHC2512FT866R](#) [RHC2512FT91K0](#) [RHC2512FTR620](#)  
[RHC2512FTR820](#) [RHC2512JT12R0](#) [RHC2512JT1K10](#) [RHC2512JT2K70](#) [RHC2512JT390K](#) [RHC2512JT47K0](#)  
[RHC2512JT5K60](#) [RHC2512JT750R](#) [RHC2512JT9K10](#) [RHC2512JTR430](#) [RHC2512FT110R](#) [RHC2512FT15R4](#)  
[RHC2512FT1R37](#) [RHC2512FT232R](#) [RHC2512FT26R1](#) [RHC2512FT38R3](#) [RHC2512FT3R32](#) [RHC2512FT430K](#)  
[RHC2512FT510R](#) [RHC2512FT51K0](#) [RHC2512FT5R90](#) [RHC2512FT732R](#) [RHC2512FTR330](#) [RHC2512FTR390](#)  
[RHC2512JT110K](#) [RHC2512JT33K0](#) [RHC2512JT3R00](#) [RHC2512JT510R](#) [RHC2512JT680R](#) [RHC2512JT8K20](#)  
[RHC2512JTR200](#) [RHC2512JTR240](#) [RHC2512JTR910](#) [RHC2512FT10R2](#) [RHC2512FT12K0](#) [RHC2512FT14R7](#)  
[RHC2512FT160R](#) [RHC2512FT19R6](#) [RHC2512FT1R27](#) [RHC2512FT270R](#) [RHC2512FT28R0](#) [RHC2512FT31R6](#)  
[RHC2512FT412R](#) [RHC2512FT45R3](#) [RHC2512FT51R0](#) [RHC2512FT5R23](#)