

THIS DRAWING IS UNPUBLISHED. RELEASED FOR PUBLICATION  
 © COPYRIGHT - By - TE CONNECTIVITY ALL RIGHTS RESERVED.

LOC		DIST		REVISIONS			
P	LTR	DESCRIPTION		DATE	DWN	APVD	
HB	-	C2	CAHNGE LOGO&ADD LINE IDENTIFICATION	ECO-12-001771	21Aug2012	YS.H	BH.Y

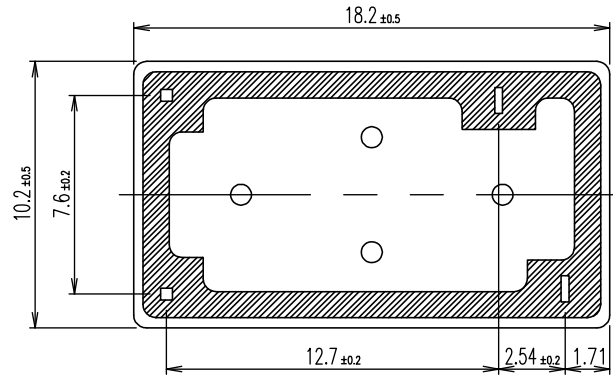
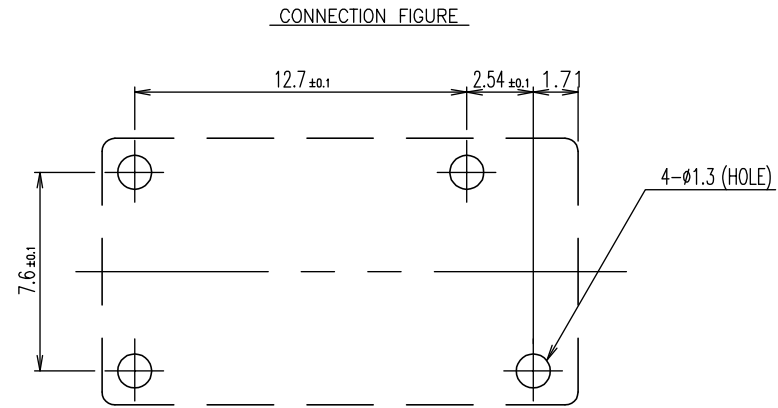
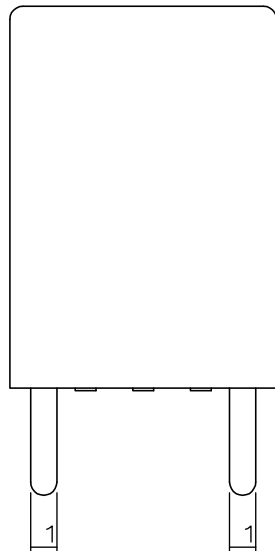
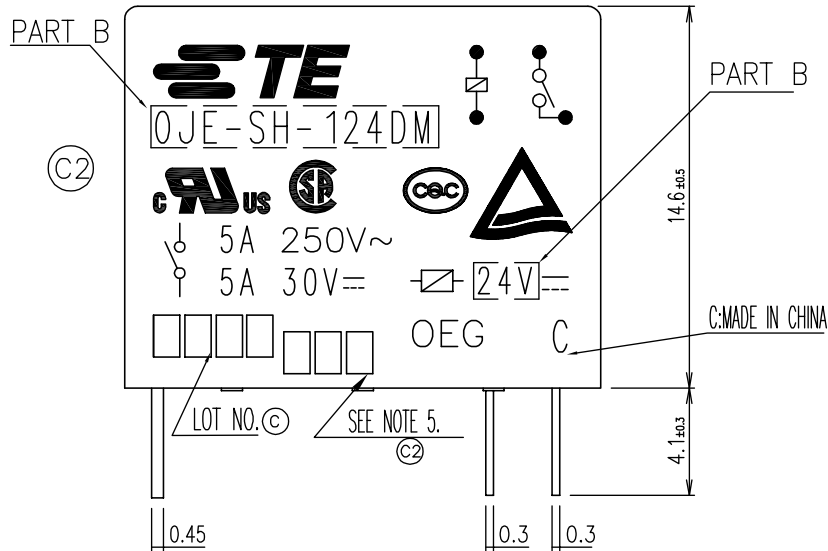
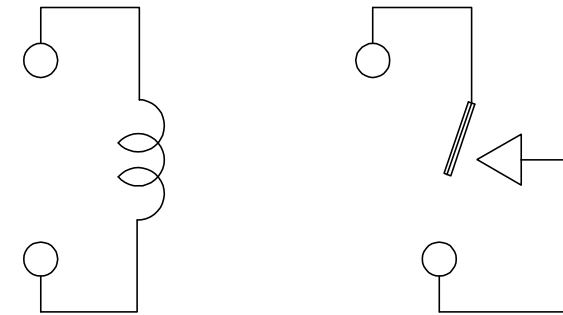
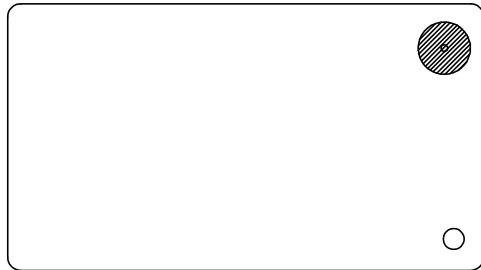

THIS DRAWING IS A CONTROLLED DOCUMENT.		DWN	H.Sasaki		<b>TE</b> TE Connectivity			
DIMENSIONS: mm		CHK	Y.Oikawa					
TOLERANCES UNLESS OTHERWISE SPECIFIED:		APVD	A.Nagai		NAME			
0 PLC ± -		PRODUCT SPEC	-		OJE-SH-DM SPEC CUSTOMER DRAWING			
1 PLC ± -		APPLICATION SPEC	-		SIZE	CAGE CODE	DRAWING NO	RESTRICTED TO
2 PLC ± -		WEIGHT	-		A3	00779	C= 1461400	-
3 PLC ± -		MATERIAL		FINISH		CUSTOMER DRAWING		SCALE
4 PLC ± -		-		-		-		5:1
ANGLES ± -		-		-		-		SHEET
-		-		-		-		1 of 2
-		-		-		-		REV
-		-		-		-		C2

THIS DRAWING IS UNPUBLISHED. RELEASED FOR PUBLICATION -,-  
 © COPYRIGHT - By - TE CONNECTIVITY ALL RIGHTS RESERVED.

LOC	DIST	REVISIONS					
HB	-	P	LTR	DESCRIPTION	DATE	DWN	APVD
		-	-	SEE SHEET 1	-	-	-

PART STATUS	PART NO	DESCRIPTION	PACKAGE SPEC.	PART B	PART A	TYPE
Ⓒ2 OBSOLETE	1461400-6	OJE-SH-148DM, 000	107-79010	48V	OJE-SH-148DM	h
ACTIVE	1461400-5	OJE-SH-124DM, 000	107-79010	24V	OJE-SH-124DM	g
ACTIVE	4-1419144-9	OJE-SH-118DM, 000	107-79010	18V	OJE-SH-118DM	f Ⓑ
ACTIVE	1461400-4	OJE-SH-112DM, 000	107-79010	12V	OJE-SH-112DM	e
Ⓒ2 OBSOLETE	1461400-3	OJE-SH-109DM, 000	107-79010	9V	OJE-SH-109DM	d
Ⓒ2 OBSOLETE	1461400-2	OJE-SH-106DM, 000	107-79010	6V	OJE-SH-106DM	c
ACTIVE	1461400-1	OJE-SH-105DM, 000	107-79010	5V	OJE-SH-105DM	b
Ⓒ2 OBSOLETE	1461400-7	OJE-SH-103DM, 000	107-79010	3V	OJE-SH-103DM	a

RELAY TYPE

ⒸⒷ NOTES:  
 1.LOT NO. SYSTEM AS FOLLOWING:

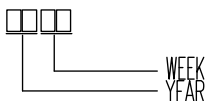

- Ⓒ2 2.TERMINAL DIMENSION IS BEFORE SOLDER DIP;
- Ⓒ2 3.FOR THE TIN-PLATING OF THE PINS:  
 +0.1mm FOR WIDTH,THICKENSS AND DIAMETER.  
 +0.5mm FOR LENGTH.
- Ⓒ2 4.MARKING FROM INK TO LASER.

Ⓒ2 5.ADD LOT NO. SYSTEM AS FOLLOWING;



- I, DIGITS FOR DAY OF THE WEEK  
 1...MONDAY IN THIS WEEK;  
 2...TUESDAY IN THIS WEEK;  
 .....  
 7...SUNDAY IN THIS WEEK
- II, DIGITS FOR SHIFT OF THE DAY  
 1...DAY SHIFT IN THIS DAY;  
 2...NIGHT SHIFT IN THIS DAY;
- III, ONE CHARACTER DISTINGUISH THE LINE  
 IDENTITY, SUCH AS:  
 A,B,.....Z

		UV RESIN	SEEL (VENT HOLE)	16
		EPOXY RESIN	SEEL (BASE & BOBBIN)	15
		3UEW	MAGNETIC WIRE	14
94V-0		P.B.T	CASE	13
94V-0		P.B.T	BASE	12
94V-0		P.B.T	BOBBIN	11
	SOLDER DIP	C.P WIRE	COIL TERMINAL	10
94V-0		P.P.S	CARD	9
		Ag ALLOY	MOVABLE CONTACT	8
		Ag	NO.CONTACT	7
		STEEL	HINGE SPRING	6
	SOLDER DIP	PBP	NO.TERMINAL	5
	SOLDER DIP	PBS	MOVABLE SPRING	4
	NIP	STEEL	CORE	3
	NIP	STEEL	ARMATURE	2
	NIP	STEEL	YOKE	1
INCOMBUSTIBILITY	TREATMENT	MATERIAL	DESCRIPTION	ITEM

THIS DRAWING IS A CONTROLLED DOCUMENT.		DWN	-	
		CHK	H.Sasaki	
		APVD	Y.Oikawa	
DIMENSIONS: mm		PRODUCT SPEC	A.Nagai	
TOLERANCES UNLESS OTHERWISE SPECIFIED:		APPLICATION SPEC	-	
0 PLC ± -		WEIGHT	-	
1 PLC ± -		SIZE	A3	
2 PLC ± -		CAGE CODE	00779	
3 PLC ± -		DRAWING NO	G= 1461400	
4 PLC ± -		RESTRICTED TO	-	
ANGLES ± -		SCALE	5:1	
FINISH -		SHEET	2 of 2	
MATERIAL -		REV	C2	
CUSTOMER DRAWING				



OJE-SH-DM SPEC CUSTOMER DRAWING