

PC BOARD VERSIONS		
PRODUCTNR:	PCB THICKNESS	DIM"A"
89035-X01LF	1.6	2.90
89035-X11LF	2.4	3.53

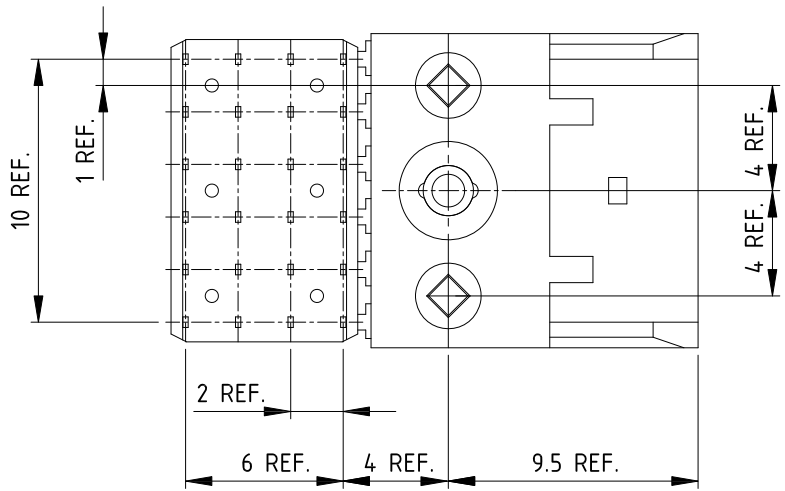

PRODUCT AFTER PC BOARD APPLICATION.

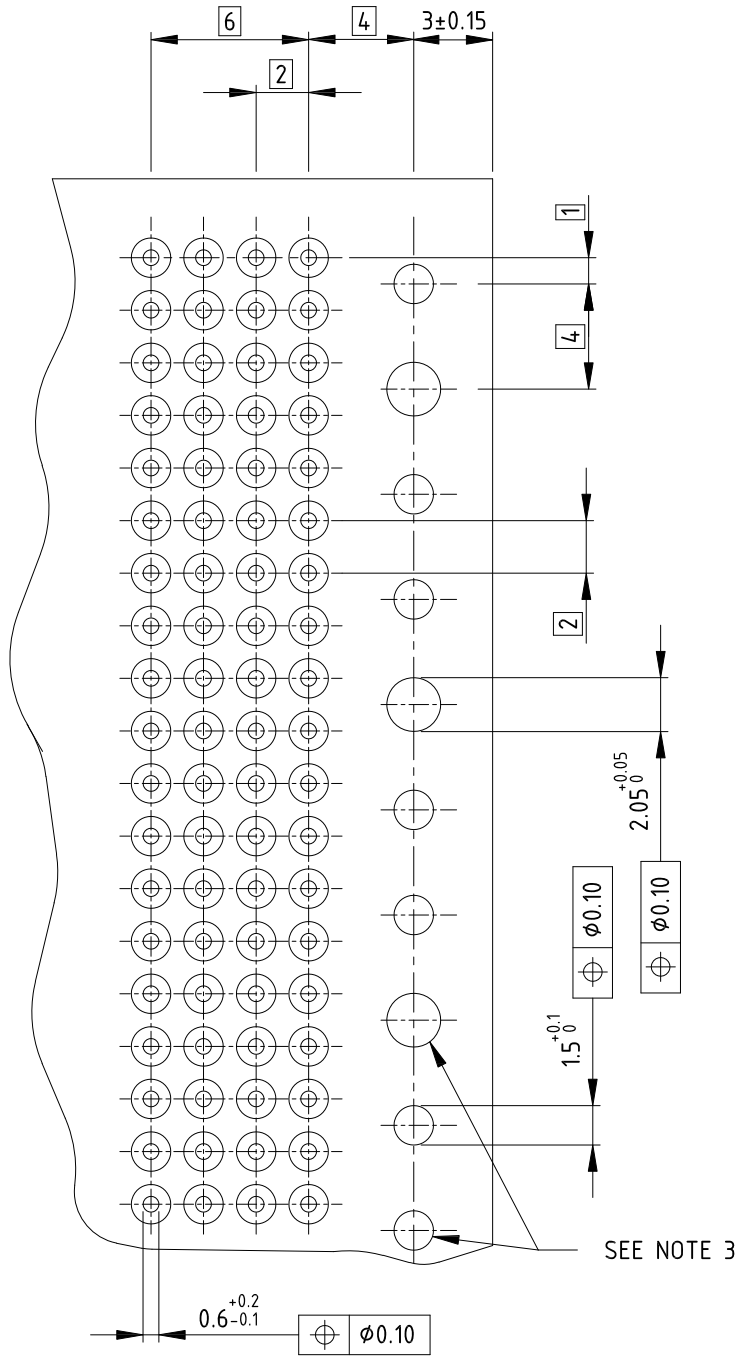
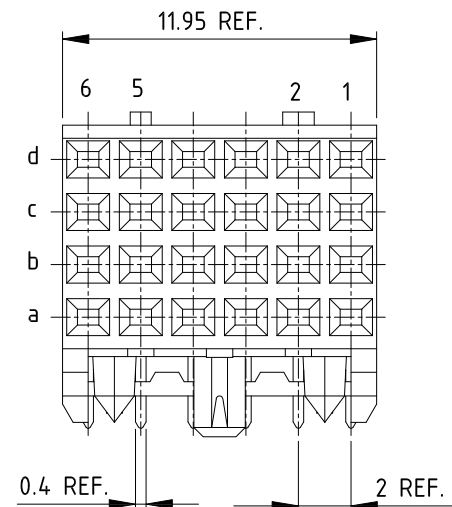
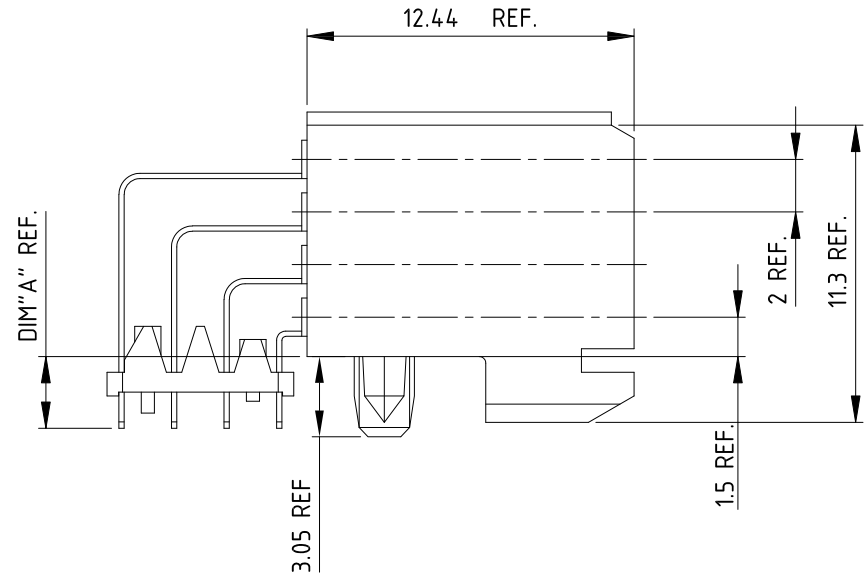
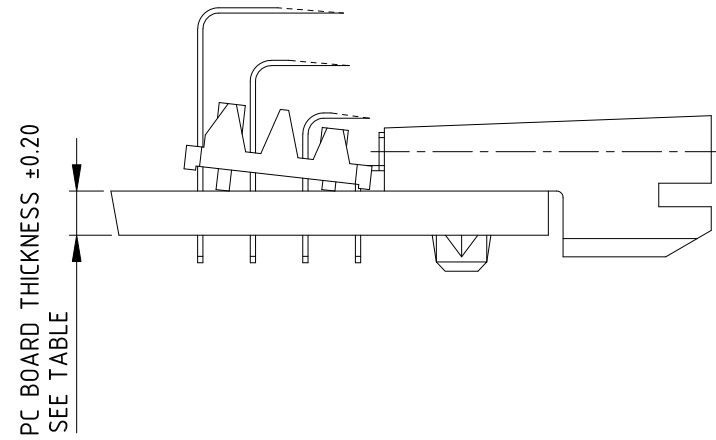

RECOMMENDED HOLE PATTERN, COMPONENT SIDE.

NOTES:

- MATERIAL : BODY : LCP UL94-V0
: CONTACT : COPPER ALLOY.
- FOR PLATING PERFORMANCE REFER DRAWING # 10159408. \triangle
- INDICATED HOLES ARE UNPLATED.
- THIS PRODUCT MEETS EUROPEAN UNION DIRECTIVES AND OTHER COUNTRY REGULATIONS AS DESCRIBED IN GS-47-0004.
- THE HOUSING WILL WITHSTAND EXPOSURE TO 260° PEAK TEMPERATURE FOR 10 SECONDS IN A WAVE SOLDER APPLICATION.
- A \triangle SYMBOL WILL BE NEXT TO ANY DIMENSION, VIEW, OR NOTE WHICH HAS BEEN MODIFIED WITH THE CURRENT DRAWING REVISION.

PART NUMBER : 89035-XY1LF

NOTE 2 \triangle

mat'l. code		surface		tolerance		projection		product family	
		ISO 1302 <input checked="" type="checkbox"/>		ISO 406 ISO 1101				METRAL	
ltr		ecn no		dr		date		title	
M		SG09-0068		CENH		2009-06-06		RA FEMALE SIGNAL	
N		ELX-I-30829		SA		2018-04-28		12mm PRESS PEG	
P		ELX-I-35736		MINI		2020-09-15		0°±2°	
								angles linear	
								0±0.3	
								.00±0.13	
								000±0.050	
								mm	
								scale -	
								dwg no	
								sheet 1 of 3	
								size	
								A2	
								type	
								Product Customer Drawing	
sheet index		revision sheet		P		P		P	
				1		2		3	

PC BOARD VERSIONS		
PRODUCTNR:	PCB THICKNESS	DIM"A"
89035-X02LF	1.6	2.90
89035-X12LF	2.4	3.53
89035-X04LF	1.6	2.90
89035-X05LF	1.6	2.90

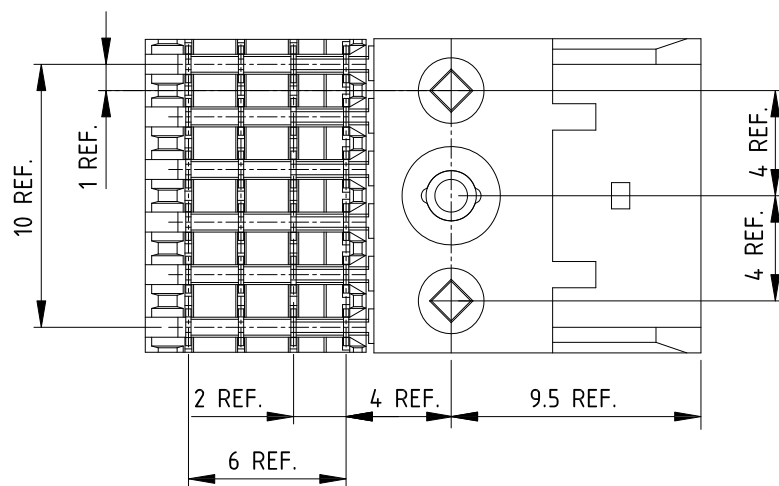
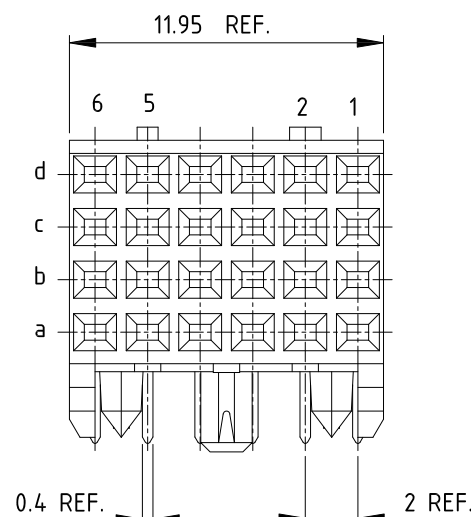
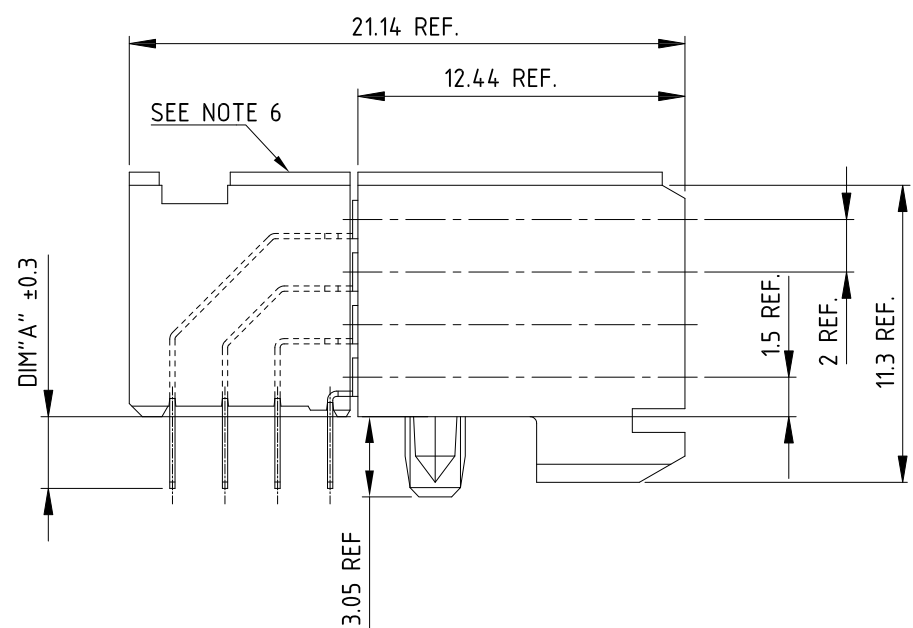
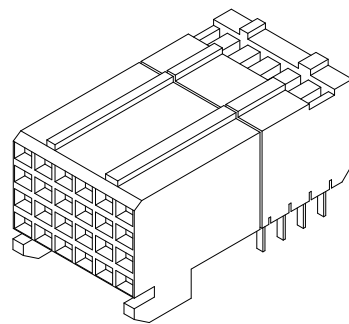

PRODUCT AFTER PC BOARD APPLICATION.

PC BOARD THICKNESS ±0.20
SEE TABLE

LOADING LAYOUTS

'X' Denotes contact loaded position.

89035-X04LF						
ROW	6	5	4	3	2	1
D	X	-	X	X	X	X
C	X	-	X	X	X	X
B	-	-	X	X	-	-
A	X	-	X	X	-	X

89035-X05LF						
ROW	6	5	4	3	2	1
D	X	-	X	-	X	-
C	-	X	-	X	-	X
B	X	-	X	-	X	-
A		X	-	X	-	X

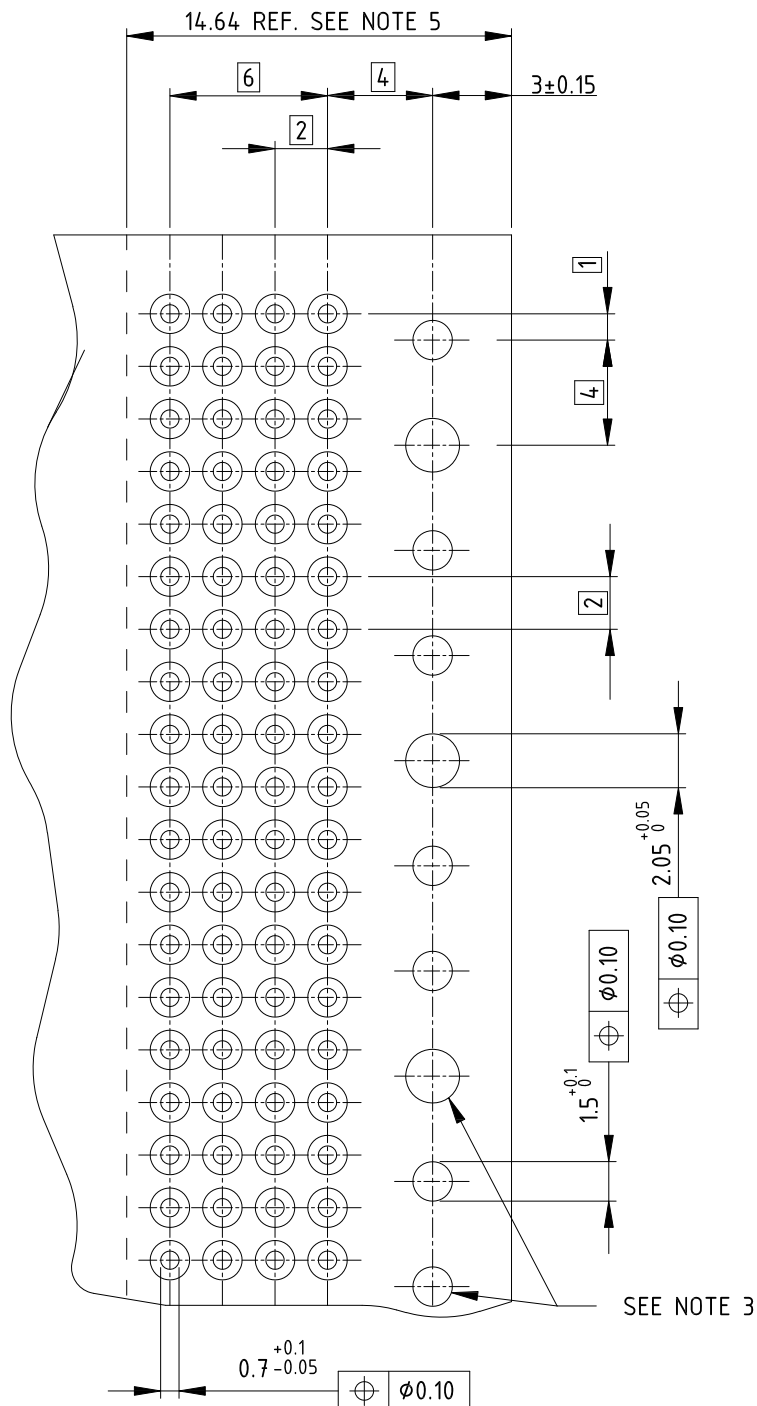

RECOMMENDED HOLE PATTERN,
COMPONENT SIDE.

NOTE 2 \triangle P

PART NUMBER : 89035-XYLFF

NOTES:

- MATERIAL : BODY : LCP UL94-V0
: CONTACT : COPPER ALLOY.
- FOR PLATING PERFORMANCE REFER DRAWING # 10159408. \triangle P
- INDICATED HOLES ARE UNPLATED.
- THIS PRODUCT MEETS EUROPEAN UNION DIRECTIVES AND OTHER COUNTRY REGULATIONS AS DESCRIBED IN GS-47-0004.
- SET BACK FOR PRESS BLOCK.
- TOP SURFACE OF PRESS BLOCK MAY EXTEND UP TO 0.4MM HIGHER THAN HOUSING. THIS MAY AFFECT THE TAIL LENGTH BEFORE APPLICATION TO A BOARD.
- THE HOUSING WILL WITHSTAND EXPOSURE TO 260° PEAK TEMPERATURE FOR 10 SECONDS IN A WAVE SOLDER APPLICATION.
- A \triangle P SYMBOL WILL BE NEXT TO ANY DIMENSION, VIEW, OR NOTE WHICH HAS BEEN MODIFIED WITH THE CURRENT DRAWING REVISION.

mat'l. code		surface ISO 1302 <input checked="" type="checkbox"/> ISO 406 ISO 1101		tolerance ISO 1302 <input checked="" type="checkbox"/> ISO 406 ISO 1101		projection mm		product family METRAL	
ltr	ecn no	dr	date	angles	linear	tolerances unless otherwise specified		title RA FEMALE SIGNAL 12mm PRESS PEG	
M	SG09-0068	CENH	2009-06-06			0±0.3		file	
N	ELX-I-30829	SA	2018-04-28			.00±0.13		dwg no 89035	
P	ELX-I-35736	MINI	2020-09-15	0°±2		000±0.050		sheet 2 of 3 size A2	
sheet index		revision		P		P		type Product Customer Drawing	
1		2		3		3			

PC BOARD VERSIONS		
PRODUCTNR:	PCB THICKNESS	DIM "A"
89035-X03LF	1.6	2.90
89035-X13LF	2.4	3.53

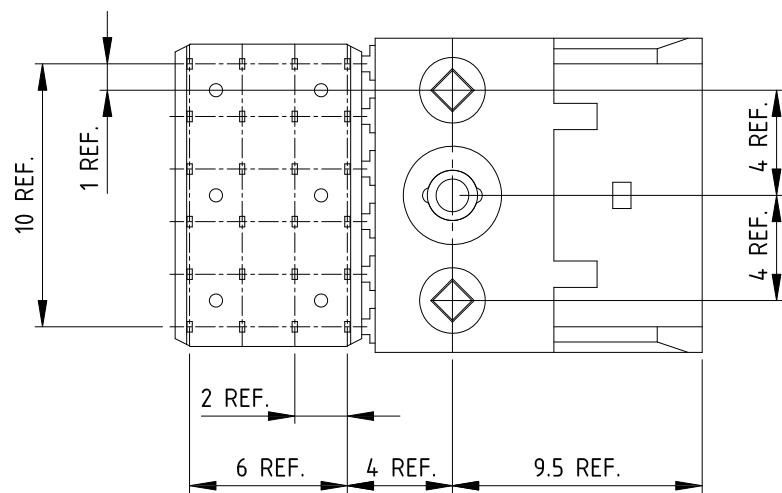
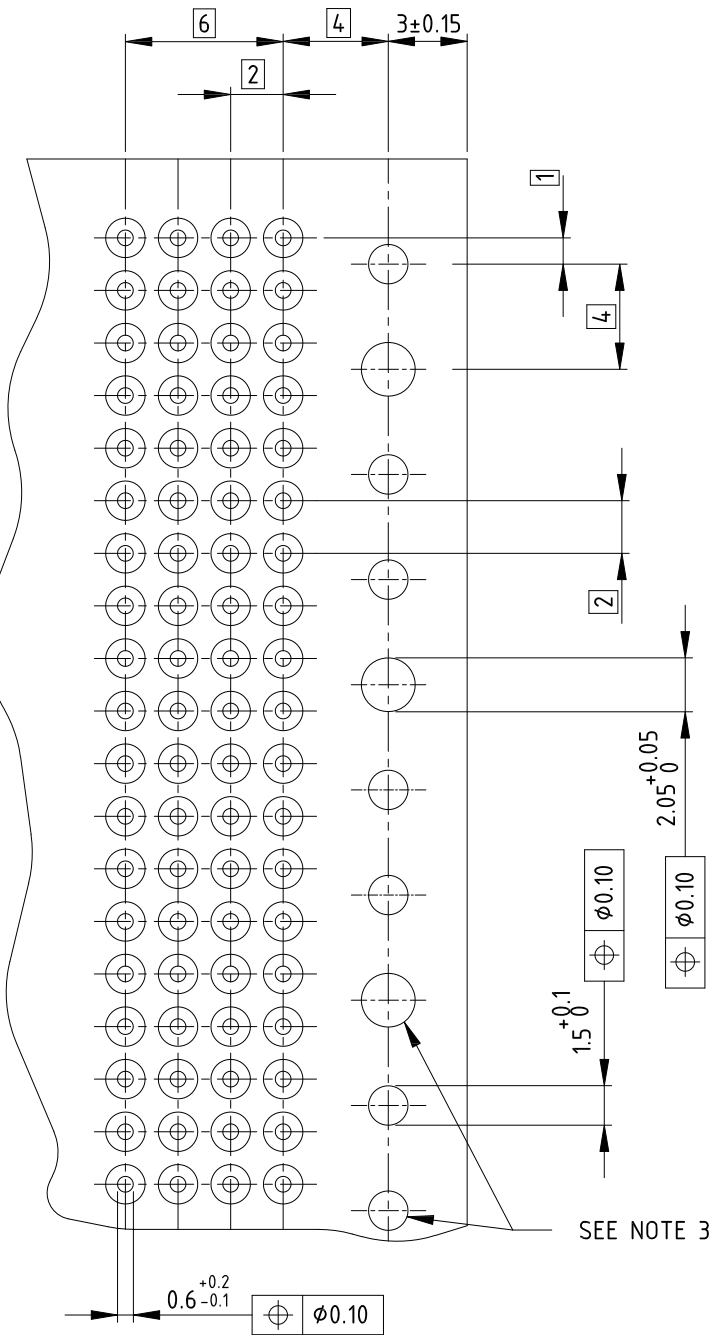
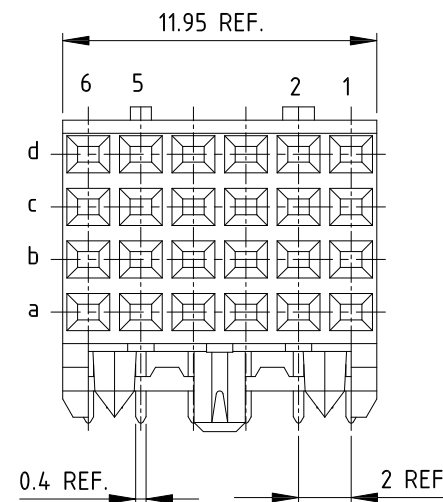
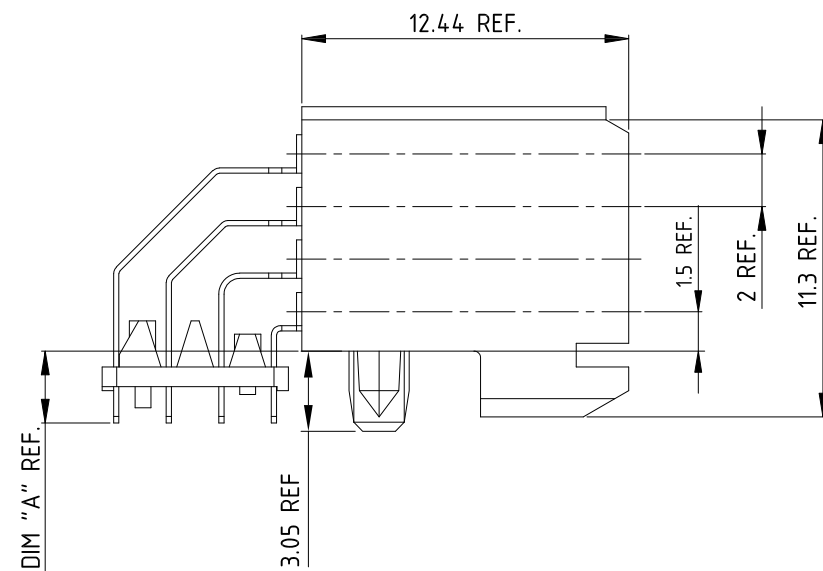

PRODUCT AFTER PC BOARD APPLICATION.

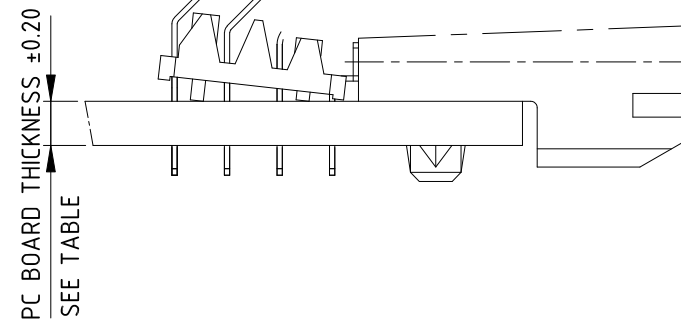

RECOMMENDED HOLE PATTERN, COMPONENT SIDE.

NOTES:

- MATERIAL : BODY : LCP UL94-V0
: CONTACT : COPPER ALLOY.
- FOR PLATING PERFORMANCE REFER DRAWING # 10159408. \triangle
- INDICATED HOLES ARE UNPLATED.
- THIS PRODUCT MEETS EUROPEAN UNION DIRECTIVES AND OTHER COUNTRY REGULATIONS AS DESCRIBED IN GS-47-0004.
- THE HOUSING WILL WITHSTAND EXPOSURE TO 260° PEAK TEMPERATURE FOR 10 SECONDS IN A WAVE SOLDER APPLICATION.
- A \triangle SYMBOL WILL BE NEXT TO ANY DIMENSION, VIEW, OR NOTE WHICH HAS BEEN MODIFIED WITH THE CURRENT DRAWING REVISION.

NOTE 2 \triangle

PART NUMBER : 89035-XYLLF

mat'l. code		surface		tolerance		projection		product family	
		ISO 1302		ISO 406 ISO 1101		mm		METRAL	
ltr		ecn no		dr		date		title	
M		SG09-0068		CENH		2009-06-06		RA FEMALE SIGNAL	
N		ELX-1-30829		SA		2018-04-28		12mm PRESS PEG	
P		ELX-1-35736		MINI		2020-09-15		dwg no	
								sheet 3 of 3	
								size	
								A2	
sheet index		revision		P		P		type	
1		2		3				Product Customer Drawing	
								89035	