

NON-SHIELDED
(8 POSITION, 8 CONTACTS SHOWN)

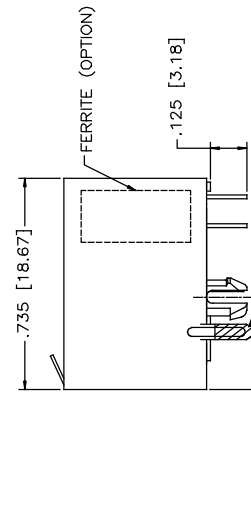

RECOMMENDED PANEL CUTOUT
SHIELDED

RECOMMENDED PANEL CUTOUT
NON-SHIELD

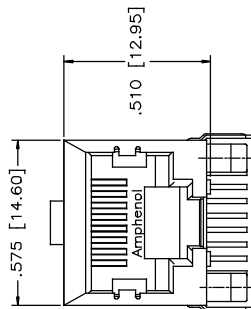
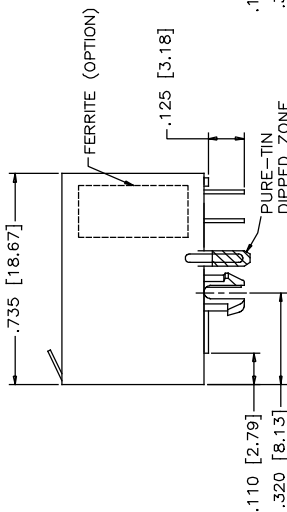
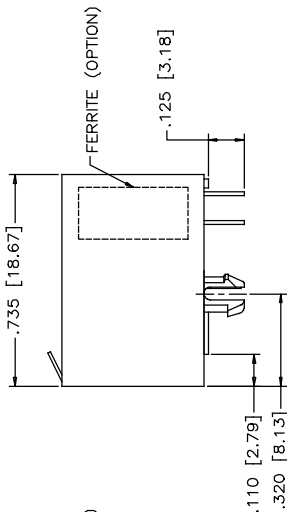
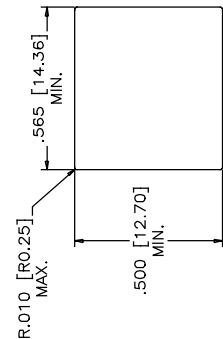

SHIELDED

(8 POSITION, 8 CONTACTS SHOWN)

FRJAE CONNECTOR NUMBER SYSTEM

EXAMPLE: F R J A E - X X X

SERIES _____

CONNECTOR STYLE & POSITIONS

4=RV45 OR 8 POSITIONS
6=RV11 OR 6 POSITIONS

OPTIONS

- 0=NON FILTERED, NON SHIELDED
- 1=FILTERED WITH FRONT TAIL SHIELD
- 3=SHIELD (FRONT TAIL)
- 4=FILTERED
- 6=FILTERED WITH REAR TAIL SHIELD
- 7=FILTERED WITH NON-TAIL SHIELD
- 8=SHIELD (REAR TAIL)
- 9=SHIELD (NON-TAIL)

NO. OF CONTACTS

- 8 - 8 POSITIONS
- 6 - 6 POSITIONS
- 4 - 4 POSITIONS
- 2 - 2 POSITIONS
- C - 2 POSITIONS

-(POS. 2 & 5, IN 6 POS.)
-(POS. 3 & 6, IN 8 POS.)

MATERIALS:

PLASTIC HOUSING: HIGH TEMPERATURE THERMOPLASTIC
FLAMMABILITY RATING UL 94V-0

CONTACTS:

PHOSPHOR BRONZE
PLATING: 50 μ" [1.27 MICRONS]
MIN. GOLD ON MATING SURFACES.
50 μ" [1.27 MICRONS]
MIN. NICKEL UNDERPLATE
GOLD FLASH ON CONTACT TAILS.

SHIELD:

COPPER ALLOY
PLATING: NICKEL WITH PURE-TIN DIPPED PCB TAIL.

ELECTRICAL CHARACTERISTICS:

VOLTAGE RATING: 125 VOLTS AC.
CURRENT RATING: 1.5 AMPS.



UNLESS SPECIFIED OTHERWISE	DRAWN PAUL/W	DATE DEC 25/05	Amphenol Canada Corp.
PRIMARY UNITS INCH	CHECKED CHIGOW	DEC 25/05	www.amphenolcanada.com
SECONDARY MILLIMETER	M.E. APP'D		TITLE
REFERENCE IN PARENTHESES	O.A. APP'D		FRJAE ASSEMBLY, 6 POSITION &
GENERAL TOLERANCES	DWG APP'R		8 POSITION, WITH OR WITHOUT FERRITES,
1 DECIMAL PLACE ±0.025	ENG. REL. NO.		SINGLE PORT, HIGH TEMP. MATERIAL
2 DECIMAL PLACES ±0.020	REF.		SHIELDED OR UNSHIELDED- RoHS COMPLIANT
3 DECIMAL PLACES ±0.015	THIRD ANGLE PROJECTION		DWG. NO.
ANGULAR DEGREES ±1.0°	DO NOT SCALE DRAWING		P-FRJAE-XXX
			REV B
			CODE ID NO. 03554 DWG. SIZE: C SCALE: N/A SHEET 1 OF 1