

stud couplings

1805 male stud coupling, BSP taper

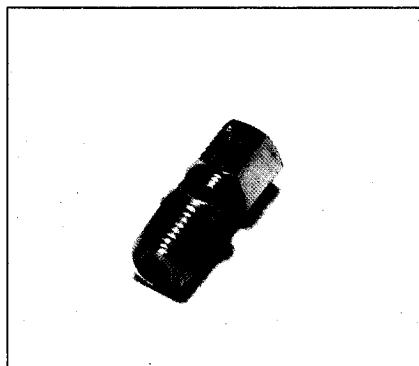

stainless steel

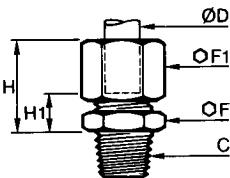

Ø D	C		F	F1	H maxi	H1	Δkg
6	1/8	1805 06 10	12	13	19,5	7,5	0,018
6	1/4	1805 06 13	14	13	19,5	7,5	0,026
8	1/8	1805 08 10	13	14	21	7	0,020
8	1/4	1805 08 13	14	14	21	7	0,025
10	1/4	1805 10 13	17	19	25,5	9	0,044
10	3/8	1805 10 17	17	19	25,5	9	0,050
10	1/2	1805 10 21	22	19	26,5	10	0,078
12	1/4	1805 12 13	19	22	26	9	0,056
12	3/8	1805 12 17	19	22	26	9	0,058
12	1/2	1805 12 21	22	22	27	10	0,082
16	3/8	1805 16 17	24	27	28,5	9,5	0,066
16	1/2	1805 16 21	24	27	28,5	9,5	0,092

1805 male stud coupling, NPT

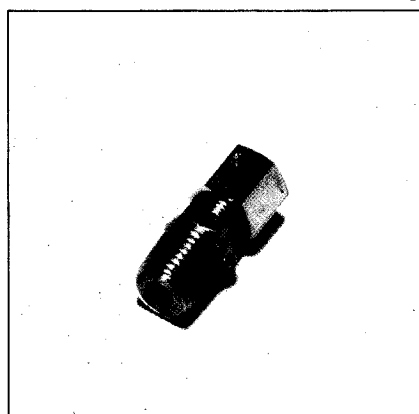

stainless steel

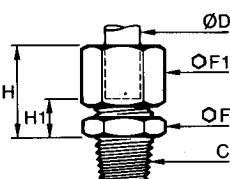

Ø D	C		F	F1	H maxi	H1	Δkg
6	1/8	1805 06 11	12	13	19,5	7,5	0,020
6	1/4	1805 06 14	14	13	19,5	7,5	0,028
6	3/8	1805 06 18	19	13	20,5	8,5	0,034
6	1/2	1805 06 22	22	13	21,5	9,5	0,050
8	1/8	1805 08 11	13	14	21	7	0,022
8	1/4	1805 08 14	14	14	21	7	0,028
10	1/4	1805 10 14	17	19	25,5	9	0,048
10	3/8	1805 10 18	19	19	25,5	9	0,056
10	1/2	1805 10 22	22	19	26,5	10	0,084
12	1/4	1805 12 14	19	22	26	9	0,058
12	3/8	1805 12 18	19	22	26	9	0,062
12	1/2	1805 12 22	22	22	27	10	0,088
16	3/8	1805 16 18	24	27	28,5	9,5	0,068
16	1/2	1805 16 22	24	27	28,5	9,5	0,094

1814 female stud coupling, BSP parallel

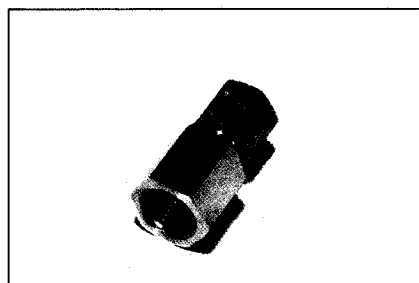

stainless steel

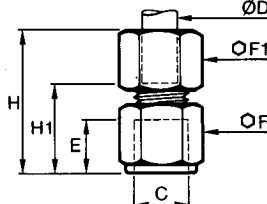

Ø D	C		E	F	F1	H maxi	H1	Δkg
6	1/8	1814 06 10	7,5	14	13	29	17	0,025
6	1/4	1814 06 13	11	17	13	29	21	0,034
8	1/4	1814 08 13	11	17	14	34,5	20,5	0,035
10	3/8	1814 10 17	11,5	22	19	38,5	22	0,069
10	1/2	1814 10 21	15	27	19	43	26,5	0,100
12	3/8	1814 12 17	11,5	22	22	39	22	0,077
12	1/2	1814 12 21	15	27	22	43,5	26,5	0,109
16	1/2	1814 16 21	15	27	27	45	26	0,129

Legris stainless steel products

Included in this catalogue is the full Legris range of stainless steel products:

- LF 3800 Stainless steel push-in fittings
- Stainless steel compression fittings
- Ball Valves 4812 one piece stainless steel
4832 3-piece stainless steel

Page D2 to D12

Page F2 to F10

Page R27

Page R28

stud couplings

1809 male stud elbow, BSP taper

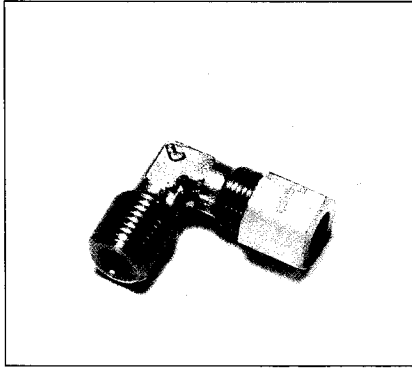

stainless steel

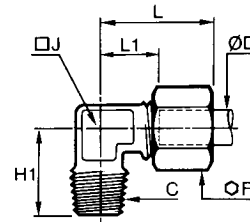

ØD	C		F	H1	J	L maxi	L1	Δkg
6	1/8	1809 06 10	13	18	8	25,5	13,5	0,020
6	1/4	1809 06 13	13	23	10	25,5	13,5	0,030
8	1/8	1809 08 10	14	20,5	10	28,5	14,5	0,026
8	1/4	1809 08 13	14	23	10	28,5	14,5	0,030
10	1/4	1809 10 13	19	25	12	32,5	16	0,049
10	3/8	1809 10 17	19	25,5	12	32,5	16	0,055
10	1/2	1809 10 21	19	32	18	36,5	20	0,094
12	1/4	1809 12 13	22	26	14	34	17	0,066
12	3/8	1809 12 17	22	27	14	34	17	0,070
12	1/2	1809 12 21	22	32	18	37	20	0,100
16	3/8	1809 16 17	27	28,5	18	39,5	21	0,085
16	1/2	1809 16 21	27	31,5	18	39,5	21	0,105

1809 male stud elbow, NPT

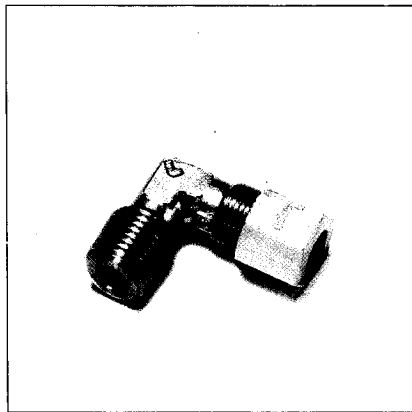

stainless steel

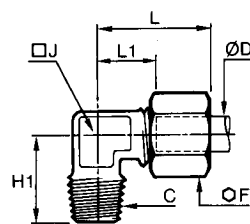

ØD	C		F	H1	J	L maxi	L1	Δkg
6	1/8	1809 06 11	13	19,5	8	25,5	13,5	0,022
6	1/4	1809 06 14	13	25,5	10	25,5	13,5	0,032
6	3/8	1809 06 18	13	28	12	27	15	0,048
6	1/2	1809 06 22	13	34	12	29	17	0,072
8	1/8	1809 08 11	14	22	10	28,5	14,5	0,027
8	1/4	1809 08 14	14	25,5	10	28,5	14,5	0,033
10	1/4	1809 10 14	19	27,5	12	32,5	16	0,051
10	3/8	1809 10 18	19	28	12	32,5	16	0,056
10	1/2	1809 10 22	19	35	18	36,5	20	0,098
12	1/4	1809 12 14	22	28,5	14	34	17	0,068
12	3/8	1809 12 18	22	29,5	14	34	17	0,078
12	1/2	1809 12 22	22	35	18	37	20	0,104
16	3/8	1809 16 18	27	31	18	39,5	21	0,090
16	1/2	1809 16 22	27	34,5	18	39,5	21	0,115

1820 straight stem adaptor BSP taper

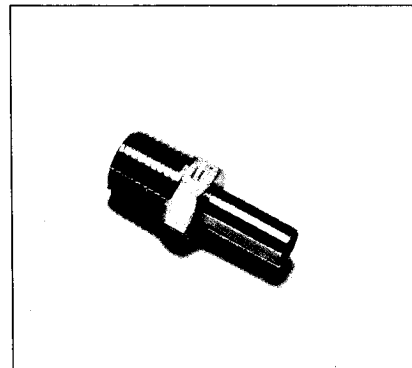

stainless steel

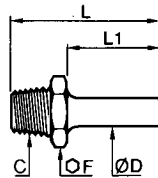

ØD	C		F	L	L1	Δkg	
6	1/8	1820 06 10		12	26,5	15	0,010
6	1/4	1820 06 13		14	31	15	0,018
8	1/8	1820 08 10		12	28,5	17	0,008
8	1/4	1820 08 13		14	33	17	0,016
10	1/4	1820 10 13		14	36	20	0,018
10	3/8	1820 10 17		17	36,5	20	0,026
10	1/2	1820 10 21		22	41	20	0,054
12	1/4	1820 12 13		14	36	20	0,018
12	3/8	1820 12 17		17	36,5	20	0,024
12	1/2	1820 12 21		22	41	20	0,050
16	3/8	1820 16 17		17	39,5	23	0,028
16	1/2	1820 16 21		22	44	23	0,056

1820 straight stem adaptor, NPT

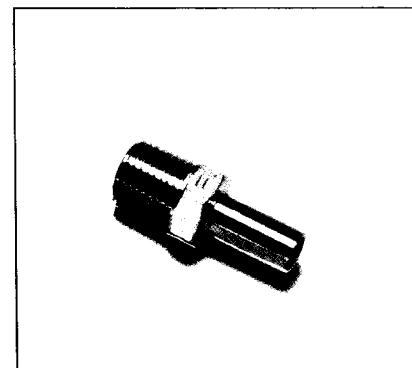

stainless steel

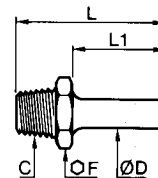

ØD	C		F	L	L1	Δkg	
6	1/8	1820 06 11		12	26,5	15	0,010
6	1/4	1820 06 14		14	31	15	0,020
8	1/8	1820 08 11		12	28,5	17	0,010
8	1/4	1820 08 14		14	33	17	0,020
10	1/4	1820 10 14		14	36	20	0,020
10	3/8	1820 10 18		19	36,5	20	0,032
10	1/2	1820 10 22		22	41	20	0,060
12	1/4	1820 12 14		14	36	20	0,020
12	3/8	1820 12 18		19	36,5	20	0,028
12	1/2	1820 12 22		22	41	20	0,054
16	3/8	1820 16 18		19	39,5	23	0,032
16	1/2	1820 16 22		22	44	23	0,064

orientable elbow

assembly

equal elbow
1802

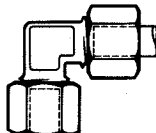

+

straight stem adaptor
1820



=

